



bestchoiceproducts



INSTRUCTION MANUAL

Inflatable Gym Mat

! NOTICE

Please retain these instructions for future reference.

- If any parts are missing, broken, damaged, or worn, stop using this product until repairs are made and/or factory replacement parts are installed.
- Do not use this item in a way inconsistent with the manufacturer's instructions as this could void the product warranty.

! WARNING

- Only use on firm ground surrounded by appropriate matting.
- Mat is intended for use by properly trained and qualified persons under supervised conditions.
- Do not use equipment without proper instruction and supervision.
- Long hair should be tied back when using mat.
- It is recommended that you wear gymnastics clothing and shoes while using equipment.
- Avoid wearing only socks or jewelry when using equipment.
- Be aware that mat can move during use. Always confirm that mat is properly positioned.
- Check pressure periodically to ensure proper inflation. Be aware that temperature changes affect internal pressure of the mat.
- Do not leave mat partially inflated in an area where it can be used without supervision.
- Do not use or store this item in a wet or humid environment.

TOOLS REQUIRED



PLASTIC WRENCH
(PROVIDED)



1 PERSON
ASSEMBLY



APPROXIMATELY
15 MIN.
ASSEMBLY

PARTS

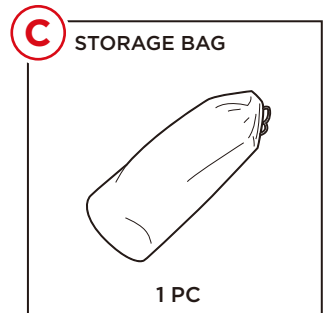
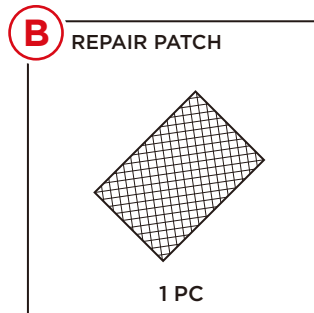
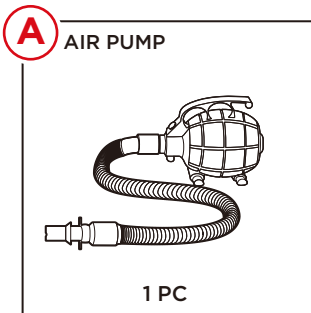

BEFORE USE

- Inspect for loose fittings and damage.
- Test stability and firmness of the mat.
- Ensure mat is dry and in good condition.
- Make sure air pressure meets minimum requirement of 15 PSI (1 bar).
- Make sure mat is properly positioned.

PRODUCT ASSEMBLY

1

Unroll the mat on flat ground. Rotate the valve cover counterclockwise to remove.

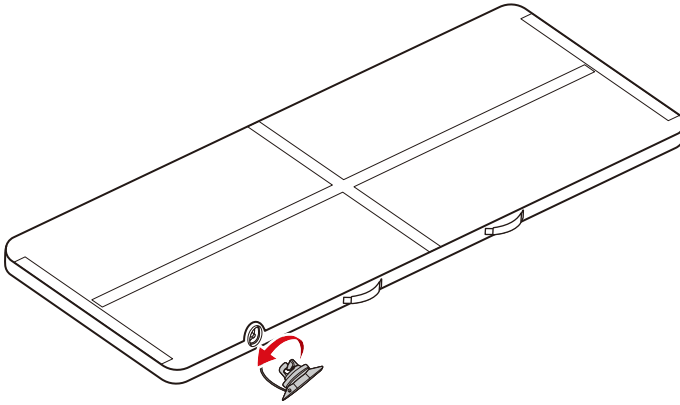

2

Press the valve in to open it.

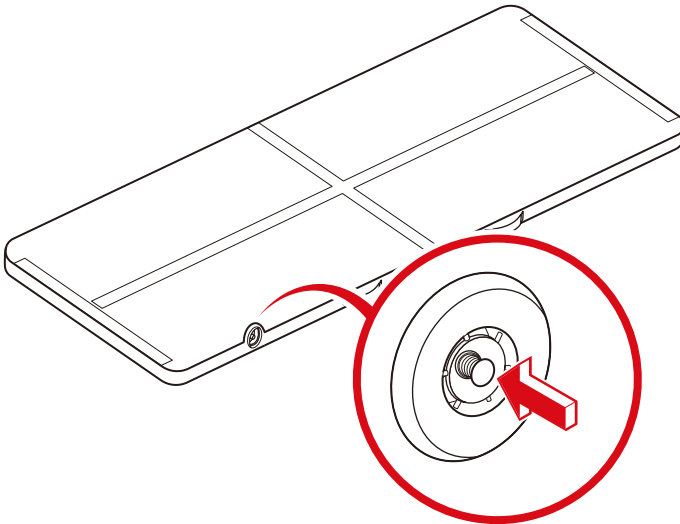

PRODUCT ASSEMBLY

3

Insert the hose on the part A air pump into the open valve. Make sure the connection is secure. Plug the air pump into a wall outlet and turn it on to inflate the mat. Stop the air pump when the mat is fully inflated.

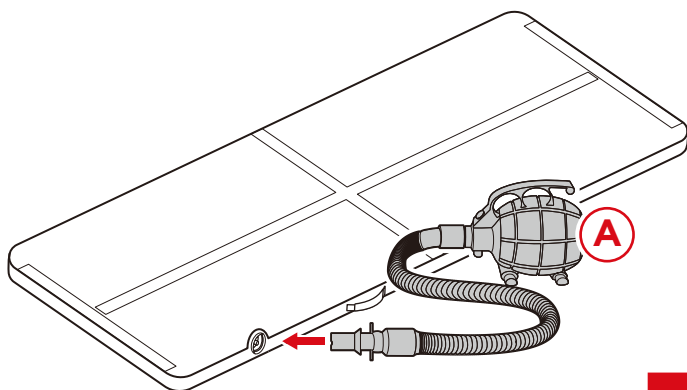

Recommended air pressure:
15 PSI or 1 bar

4

Remove the air pump from the valve. Pull the valve out to close it.

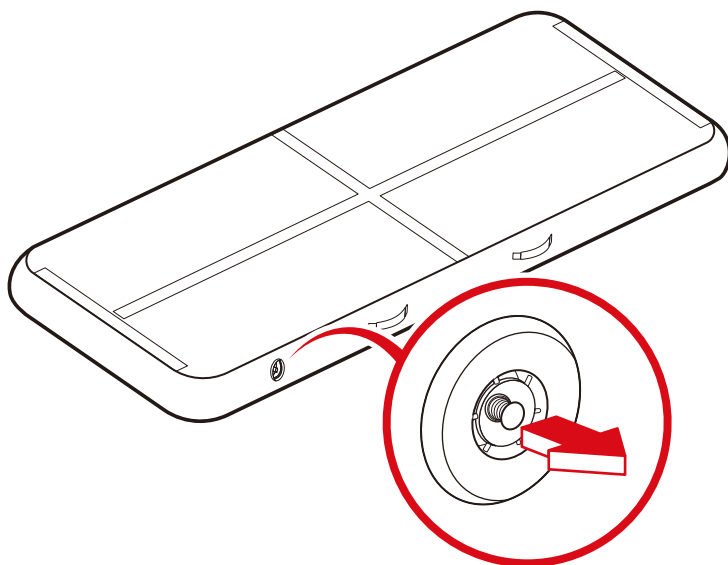

PRODUCT ASSEMBLY

5

Use the plastic wrench to fully tighten the valve.

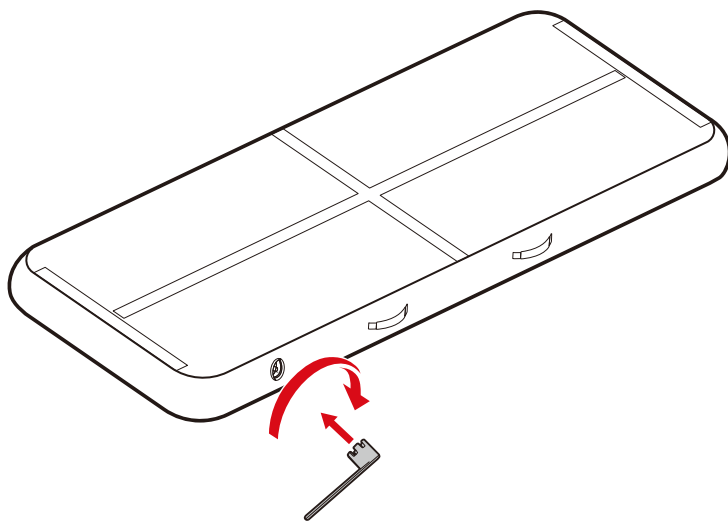

6

Replace the valve cover.

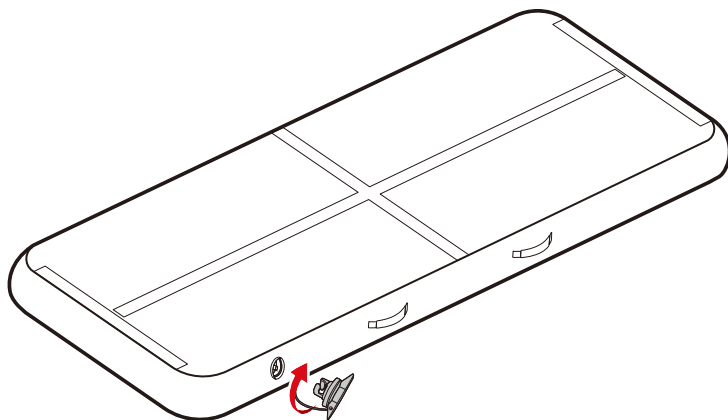

DEFLATING MAT

1

Remove the hose from the part A air pump by rotating it counterclockwise.
Move the hose to the opposite side of the air pump and rotate it clockwise to attach.

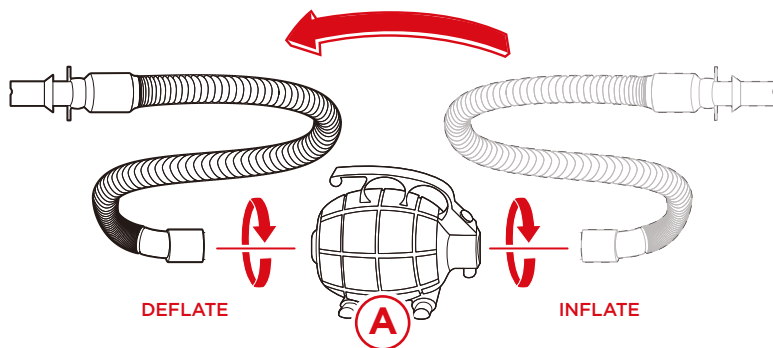

2

Press the valve in to open it.
Insert the hose into the open valve and turn on the air pump to deflate the mat.

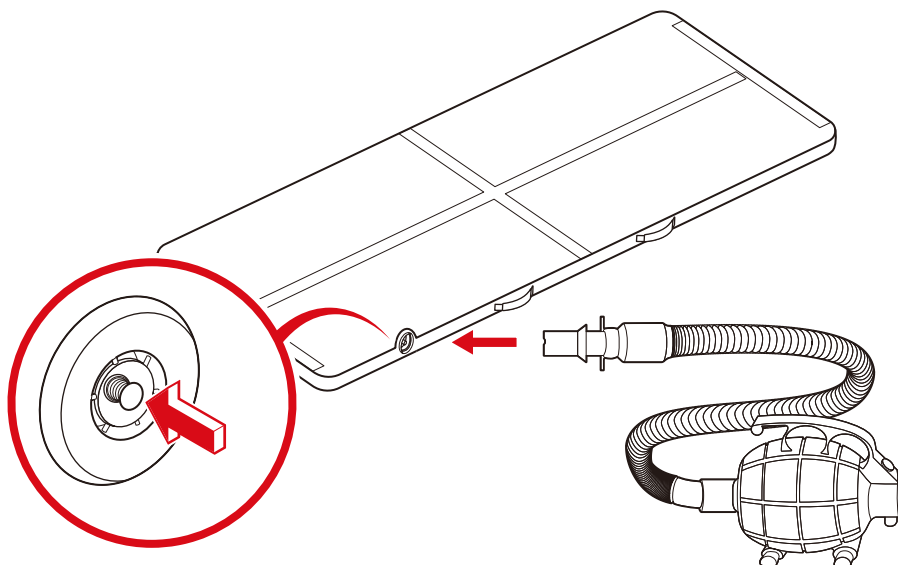

REPAIRING MAT

Repair rips or tears as soon as possible to prevent them from getting worse.

1

- Identify the rip or tear. Completely deflate the mat.
Cut a suitable patch from the part B repair patch.

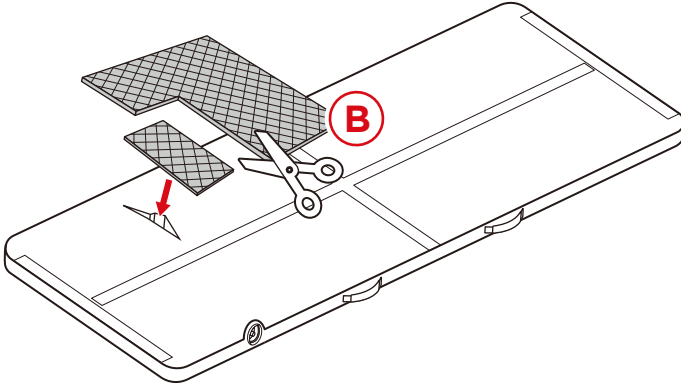

2

- Use glue (not included) to attach the patch to the mat, making sure to completely cover the rip or tear. Allow glue to completely dry before inflating the mat.

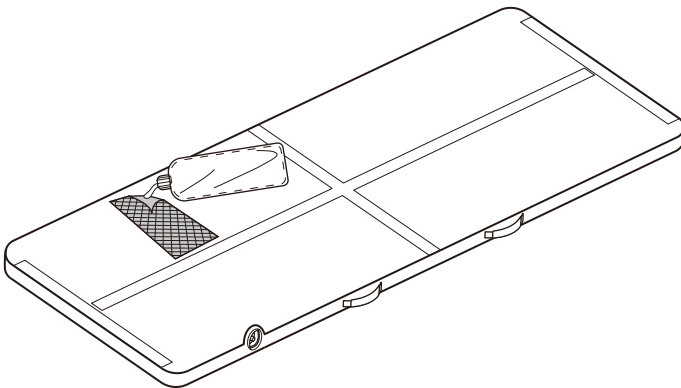



HELP CENTER



Question about your product? We're here to help. Visit us at:

help.bestchoiceproducts.com



Chat Support



Product Inquiry



Orders FAQ



Product Assembly



Returns & Refunds

PRODUCT WARRANTY INFORMATION

All items can be returned for any reason within 60 days of the receipt and will receive a full refund as long as the item is returned in its original product packaging and all accessories from its original shipment are included. All returned items will receive a full refund back to the original payment method. All returned items will not be charged a re-stocking fee.

All returned items require an RA (Return Authorization) number, which can only be provided by a Best Choice Products Customer Service Representative when the return request is submitted. Items received without an RA may not be accepted or may increase your return processing time. Once an item has been received by Best Choice Products, refunds or replacements will be processed within 5 business days.

All returns must be shipped back to the Best Choice Products Return Center at the customer's expense. If the reason for return is a result of an error by Best Choice Products then Best Choice Products will provide a pre-paid shipping label via email. Boxes for return shipping will not be provided by Best Choice Products, and is the customer's responsibility to either use the original shipping boxes or purchase new boxes.

Pictures may be required for some returns to ensure an item is not damaged prior to its return. Items returned are not considered undamaged until they are received by Best Choice Products and verified as such. All damages to items are the customer's responsibility until the item has been received by and acknowledge by Best Choice Products as undamaged.



WARNING

Manufacturer and seller expressly disclaim any and all liability for personal injury, property damage or loss, whether direct, indirect, or incidental, resulting from the incorrect attachment, improper use, inadequate maintenance, or neglect of this product.