

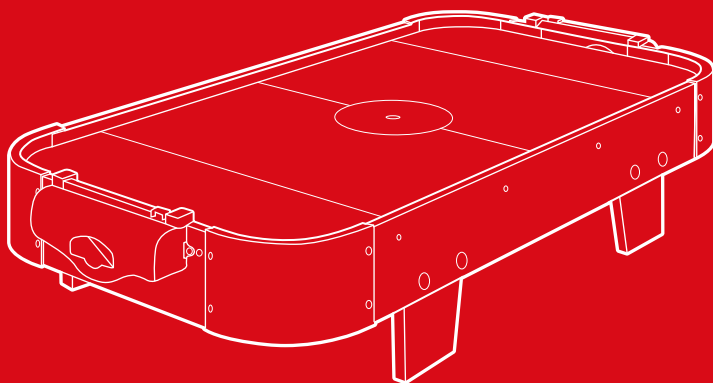

bestchoiceproducts



# INSTRUCTION MANUAL

---

## 40-inch Air Hockey Table



bestchoiceproducts

---

As shoppers, we're always trying to find the perfect balance between quality & value. At BCP, we believe we've achieved that. Our diverse catalog of everyday essentials is tailored especially to our customers & guaranteed to hit that sweet spot of high quality & low price.

— Always. —



## WARNING

**CHOKING HAZARD** - Small parts.  
Not for children under 3 years old.



## WARNING

**ADULT ASSEMBLY REQUIRED**



This product contains  
a **Hardware** and a  
**Parts/Accessory**  
box located on the  
bottom of the table,  
remove both boxes  
before assembly.

[bestchoiceproducts.com](http://bestchoiceproducts.com)

## ! NOTICE

Please retain these instructions for future reference.

- Do not stand on or use any part of this set as a step ladder.
- Firmly secure all bolts, screws, and knobs before use.
- Reconfirm that all bolts, screws, and knobs are secure every 90 days.
- Be aware that some parts are heavy and have sharp edges.
- Do not use or store this item in the proximity of open flame or flammable/combustible chemicals.
- If any parts are missing, broken, damaged, or worn, stop using this product until repairs are made and/or factory replacement parts are installed.
- Do not use this item in a way inconsistent with the manufacturer's instructions as this could void the product warranty.

## TOOLS REQUIRED



ALLEN WRENCH  
(PROVIDED)



PHILLIPS  
SCREWDRIVER



3 YEARS  
OLD AND UP



1 PERSON  
ASSEMBLY



UP TO 15 MIN.  
ASSEMBLY

## HARDWARE

1

M3 x 10mm  
SCREW



8 PCS

2

M6 x 20mm  
SCREW



8 PCS

## PARTS/ACCESSORY

A

HOCKEY  
TABLETOP



1 PC

B

SCORER

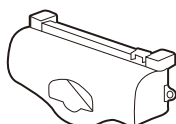

2 PCS

C

LEG I



2 PCS

D

LEG II



2 PCS

E

PUCK



2 PCS

F

PUSHER

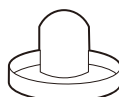

2 PCS

G

POWER  
ADAPTOR



1 PC

## PRODUCT ASSEMBLY

1

Attach two part C and two part D legs with eight part 2 screws.

**NOTE:** Arrange the same legs diagonal from each other.

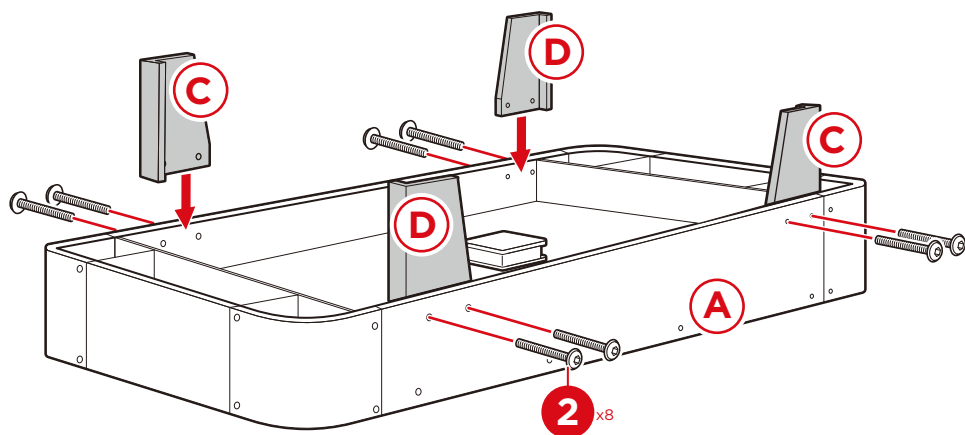

2

Attach two part B scorers to the part A hockey tabletop with eight part 1 screws.

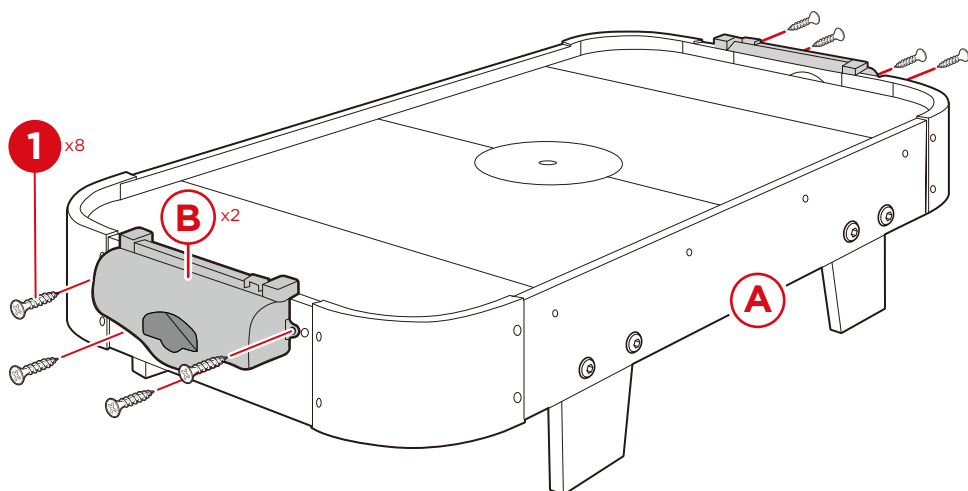

## PRODUCT ASSEMBLY

3

Underneath the hockey tabletop, insert the part G power adaptor into the corresponding connector on the fan.

Plug the power adaptor into a wall outlet.

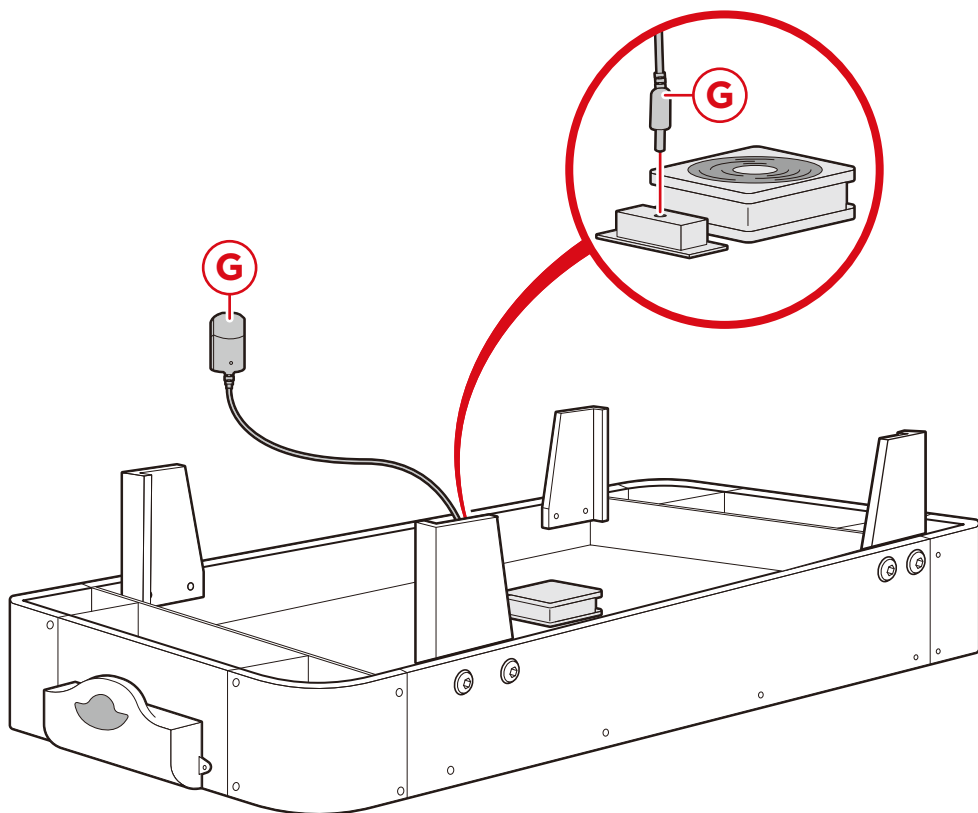

Earn points while you shop. Join today!

# bestchoiceproducts **rewards**

**Join | Earn | Redeem**

Give your friends 15% off their first order! For each successful referral you'll receive 100 points.

[bestchoiceproducts.com](https://bestchoiceproducts.com)



# HELP CENTER



Question about your product? We're here to help. Visit us at:

[help.bestchoiceproducts.com](http://help.bestchoiceproducts.com)



Chat Support



Product Inquiry



Orders FAQ



Product Assembly



Returns & Refunds

## PRODUCT WARRANTY INFORMATION

All items can be returned for any reason within 60 days of the receipt and will receive a full refund as long as the item is returned in its original product packaging and all accessories from its original shipment are included. All returned items will receive a full refund back to the original payment method. All returned items will not be charged a re-stocking fee.

All returned items require an RA (Return Authorization) number, which can only be provided by a Best Choice Products Customer Service Representative when the return request is submitted. Items received without an RA may not be accepted or may increase your return processing time. Once an item has been received by Best Choice Products, refunds or replacements will be processed within 5 business days.

All returns must be shipped back to the Best Choice Products Return Center at the customer's expense. If the reason for return is a result of an error by Best Choice Products then Best Choice Products will provide a pre-paid shipping label via email. Boxes for return shipping will not be provided by Best Choice Products, and is the customer's responsibility to either use the original shipping boxes or purchase new boxes.

Pictures may be required for some returns to ensure an item is not damaged prior to its return. Items returned are not considered undamaged until they are received by Best Choice Products and verified as such. All damages to items are the customer's responsibility until the item has been received by and acknowledge by Best Choice Products as undamaged.



## WARNING

Manufacturer and seller expressly disclaim any and all liability for personal injury, property damage or loss, whether direct, indirect, or incidental, resulting from the incorrect attachment, improper use, inadequate maintenance, unapproved modification, or neglect of this product.