

- Ⓐ 38mm CUSTOM REXAM NECK FINISH
- 1) 6 THREADS PER INCH
  - 2) PITCH .167
  - 3) 1.5 TURNS (540°) OF THREAD @ FULL DEPTH
  - 4) THREAD START IS 45° TO P.L. IN PIN HALF AS SHOWN.
  - 5) HELIX ANGLE 29°
  - 6) USE THREAD CUTTER #MA1006-89

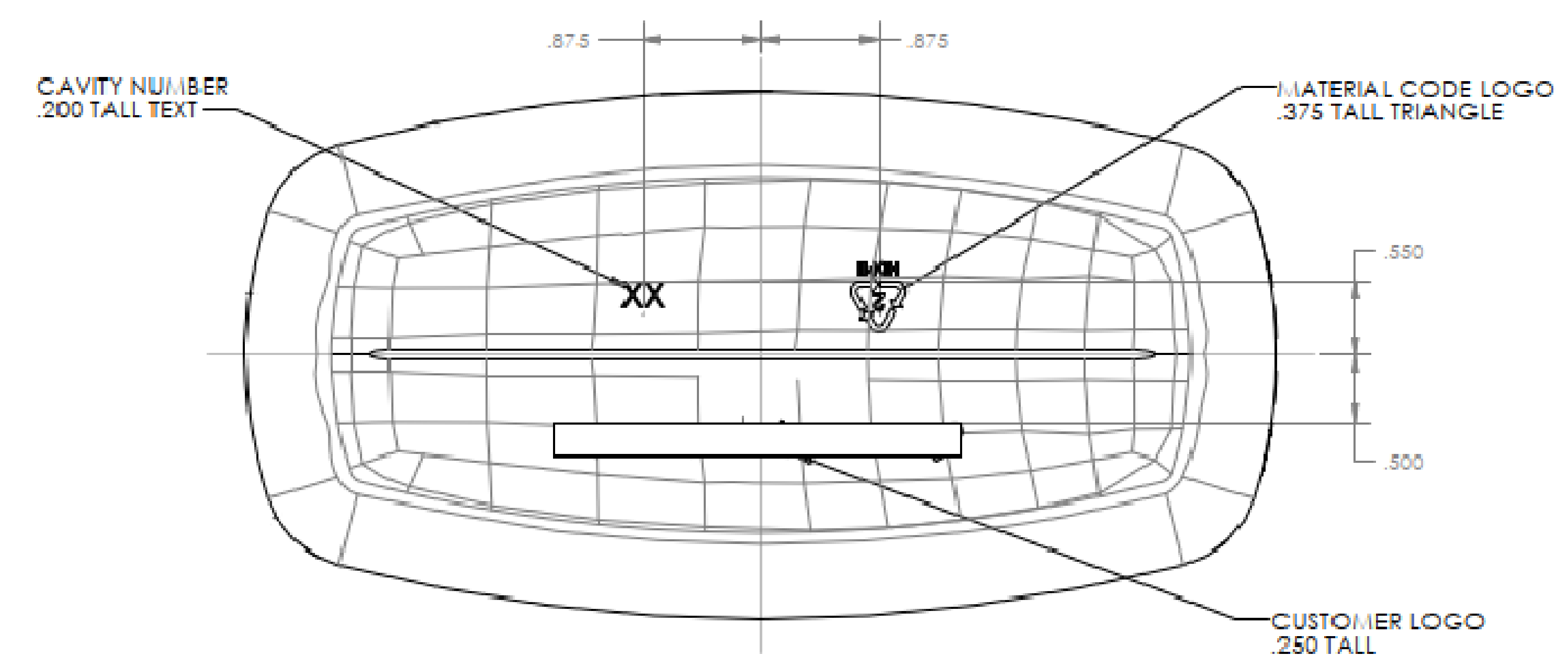

\*\*ALL ENGRAVING RAISED .010-.012\*\*

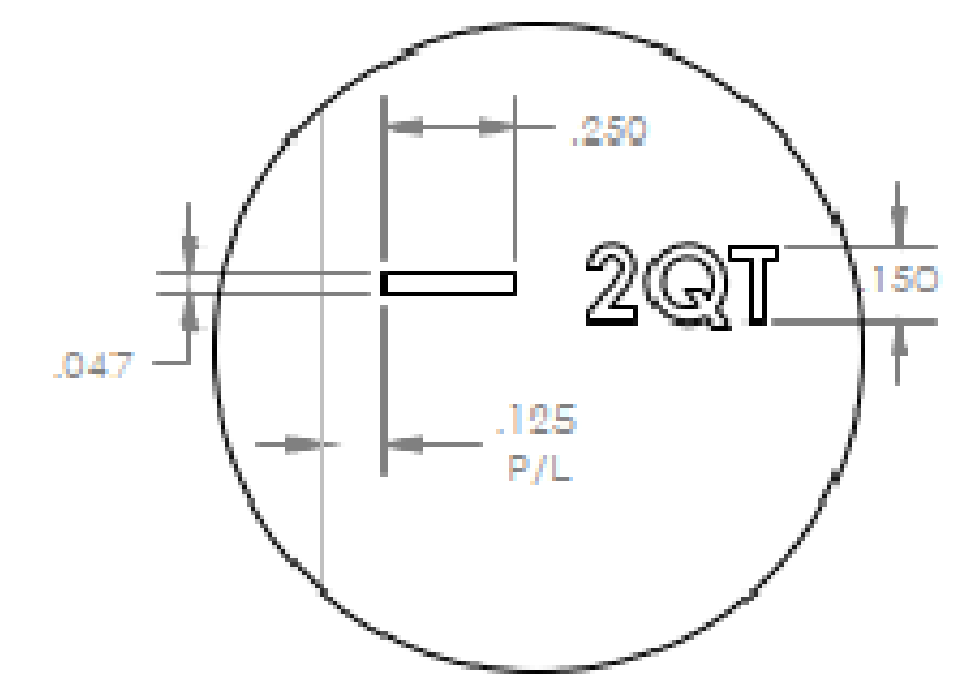

USE BALL ENDMILL FOR MARKS AND TEXT  
DETAIL A  
SCALE 2:1

- Notes:**
- 1) Tolerances Unless Specified:  
Vertical -- .080"  
Horizontal -- .090"  
Volumetric -- 1.8 oz
  - 2) Bottles to be Checked Aged with 20C water
  - 3) Estimated Bulge -- 3.7 oz

Container Data:	
Fill Level Capacity	128 oz
Overflow Capacity	140.9 oz
Material	HDPE

**DISCLAIMER**  
THIS INFORMATION IS PROVIDED AS A GENERAL GUIDE, INCLUDING DIMENSIONS. IT IS THE CUSTOMER'S RESPONSIBILITIES TO SELECT THE PROPER CONTAINER FOR PRODUCT AND APPLICATION COMPATIBILITY.

DISTRIBUTED BY: REF NO.: DWG31594  
DESCRIPTION: 128 oz HDPE F-Style, 38-400, with Graduation Marks