



BEST CHOICE  
PRODUCTS



# INSTRUCTION MANUAL

---

Lighted 2D Outdoor  
Christmas Tree with Gifts

## ! NOTICE

Please retain these instructions for future reference.

- This product is intended for outdoor use and should be assembled outdoors only.
- This item is not intended for permanent installation or use.
- Unplug item when not in use or if left unattended.
- Ensure that your voltage is consistent with specifications.
- If any parts are missing, broken, damaged, or worn, stop using this product until repairs are made and/or factory replacement parts are installed.
- Do not use this item in a way inconsistent with the manufacturer's instructions as this could void the product warranty.
- This product is intended for residential use only.



1 PERSON  
ASSEMBLY



UP TO 25 MIN.  
ASSEMBLY

## ! WARNING

- Do not plug into a wall outlet until item is fully assembled and lights are properly connected.
- Do not use in extreme weather conditions.
- This product contains glitter, do not assemble indoors to avoid unintended property damage and cleanup.
- Do not allow glitter to contact your eyes or face as this may result in skin irritation or injury.
- Keep item away from all heat sources (fireplace, stove, heater, etc.).
- Please use the provided stakes to properly secure the tree and gift boxes.
- Do not secure wiring with staples, nails, or sharp hooks.
- Do not hang ornaments or other objects from the cord.
- Unplug item before removing or changing bulbs.
- Replace burned-out bulbs immediately. Make sure to purchase bulbs of the same rated voltage and wattage.

## HARDWARE

**A**

U-STAKES

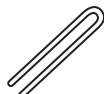

8 PCS

**B**

GIFT STAKES



3 PCS

**C**

WINGNUT/  
SCREW



5 PCS

**D**

S-HOOKS



9 PCS

**E**

COTTER PIN



1 PC

**F**

ZIP TIE



1 PC

**G**

STORAGE BAG

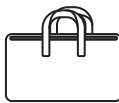

1 PC

## PARTS

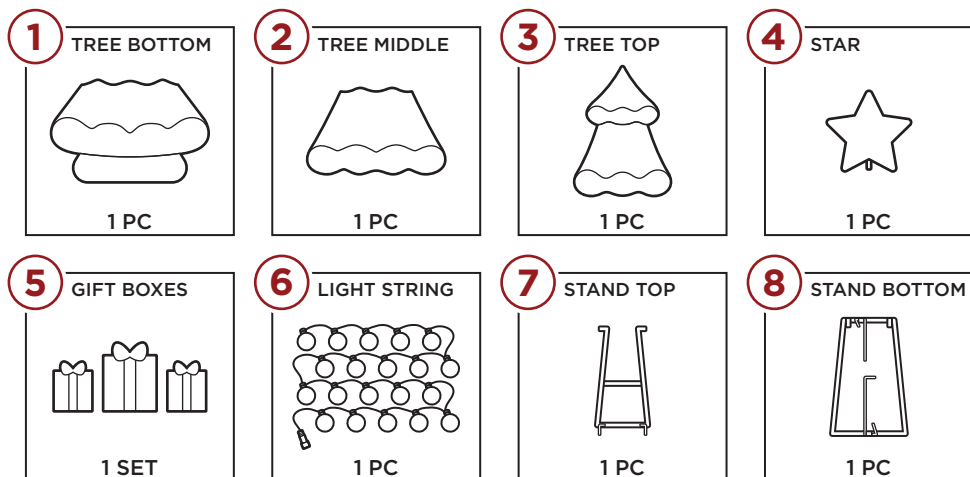

## PRODUCT ASSEMBLY

1

Thread the peg of the **part 2 tree middle** through the receiver on the **part 1 tree bottom**, then secure with two **part C wingnuts/screws**.

### BACK VIEW

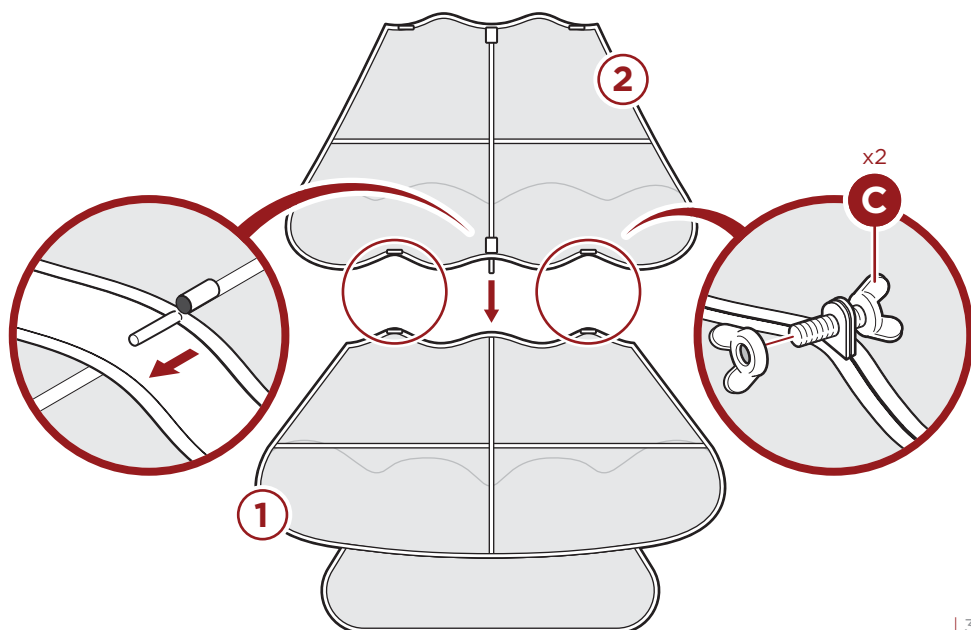

## PRODUCT ASSEMBLY

2

Thread the peg of the **part 3 tree top** through the receiver of the **part 2 tree middle**, then secure with two **part C wingnuts/screws**.

Insert the **part 4 star** into the **part 3 tree top** and secure with one **part F zip tie**.

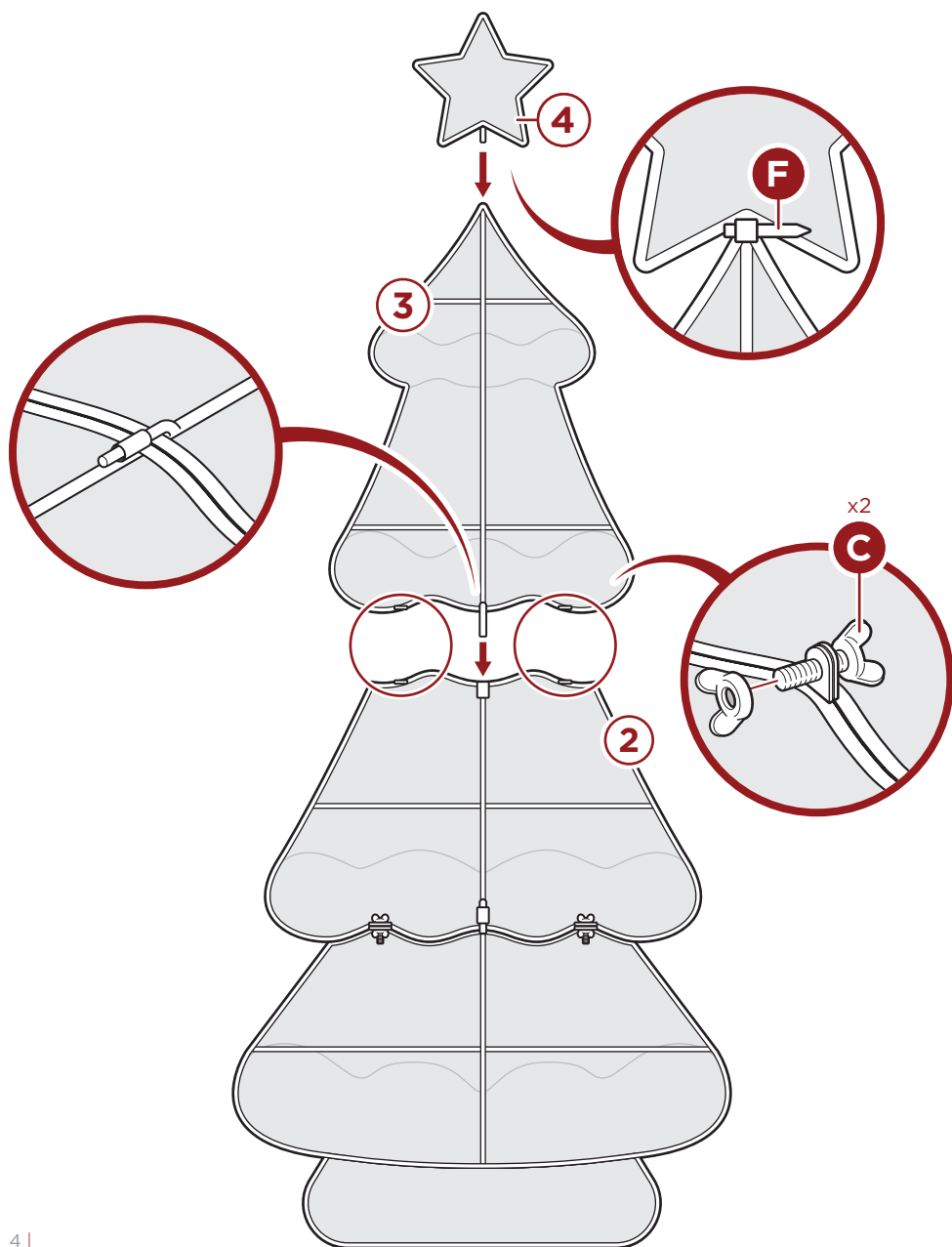

## PRODUCT ASSEMBLY

3

Thread the pegs on the **part 7 stand top** through the **part 8 stand bottom**, then secure with one **part C wingnut/screw**.

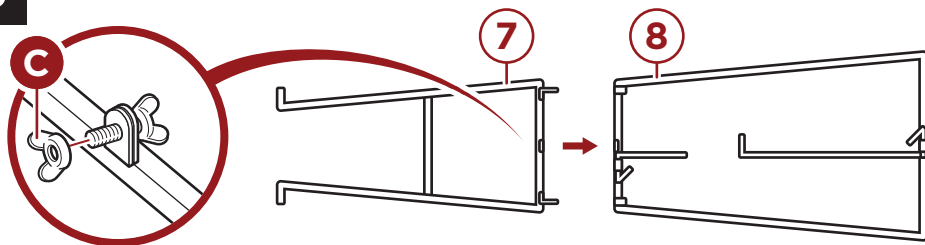

4

Insert the pegs on the **part 7 stand top** into the receivers on the back of the **part 3 tree top**, then connect the latch in the center of the tree and secure with one **part E cotter pin**. Connect the latch at the bottom of the stand to the bottom of the tree assembly.

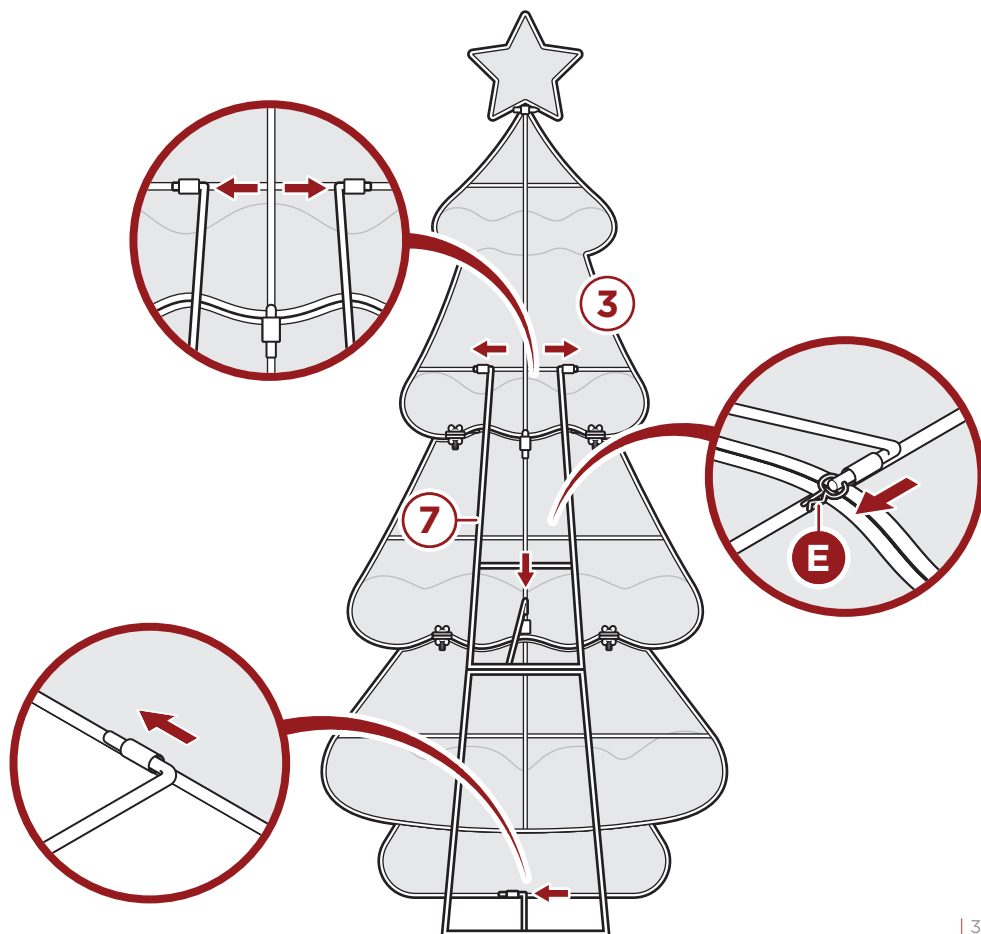

## PRODUCT ASSEMBLY

5

Thread the **part 6 string lights** along the front of the tree assembly, and secure with the pre-attached s-hooks, use additional **part D s-hooks** if necessary.

Attach the connector at the end of the **part 6 string lights** to the power receiver on the back of the tree assembly.

### FRONT VIEW

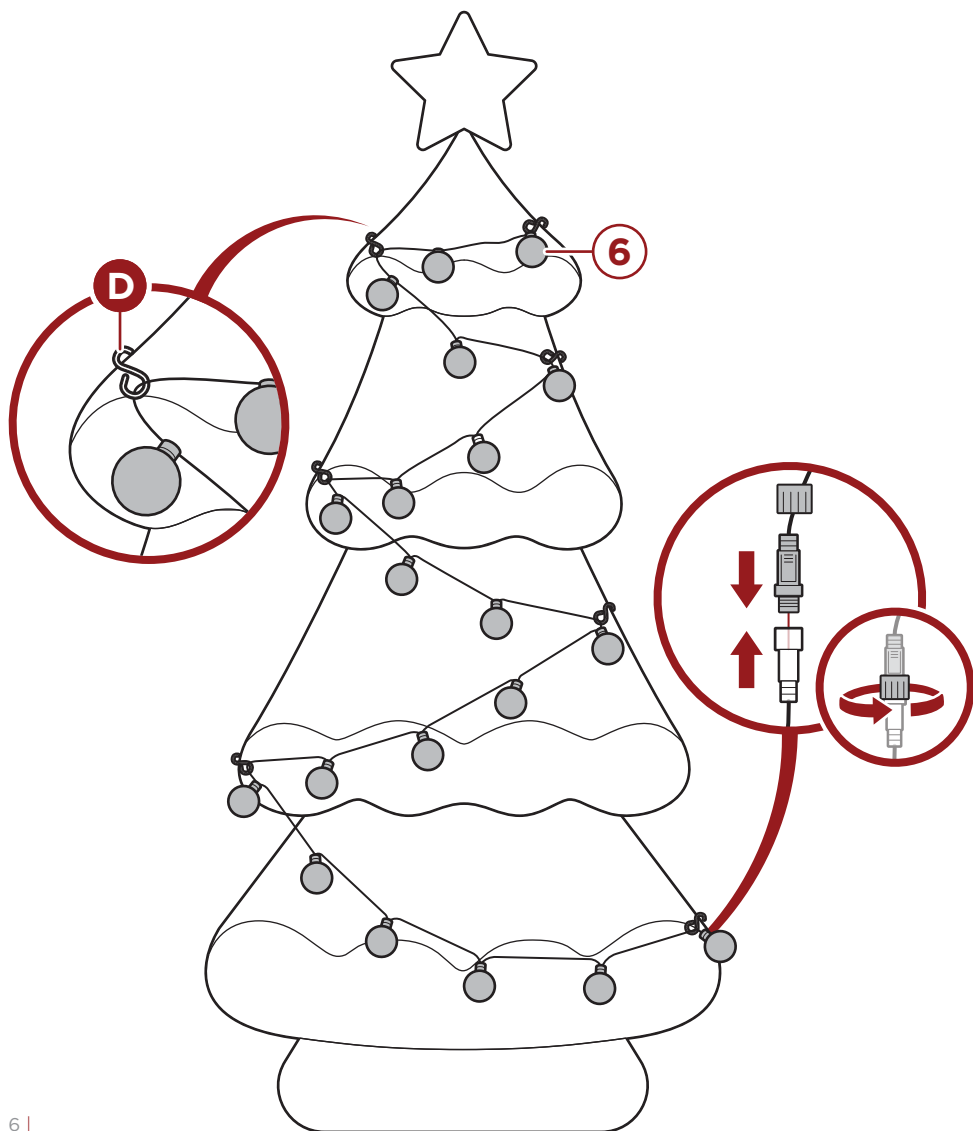

## PRODUCT ASSEMBLY

6

Use eight **part A U-stakes** to secure the tree assembly to the ground.

Arrange the **part 5 gift boxes** in front of the tree assembly.

Use three **part B gift stakes** to secure the **part 5 gift boxes** to the ground, one stake per box.

Plug the power cord into a wall outlet.

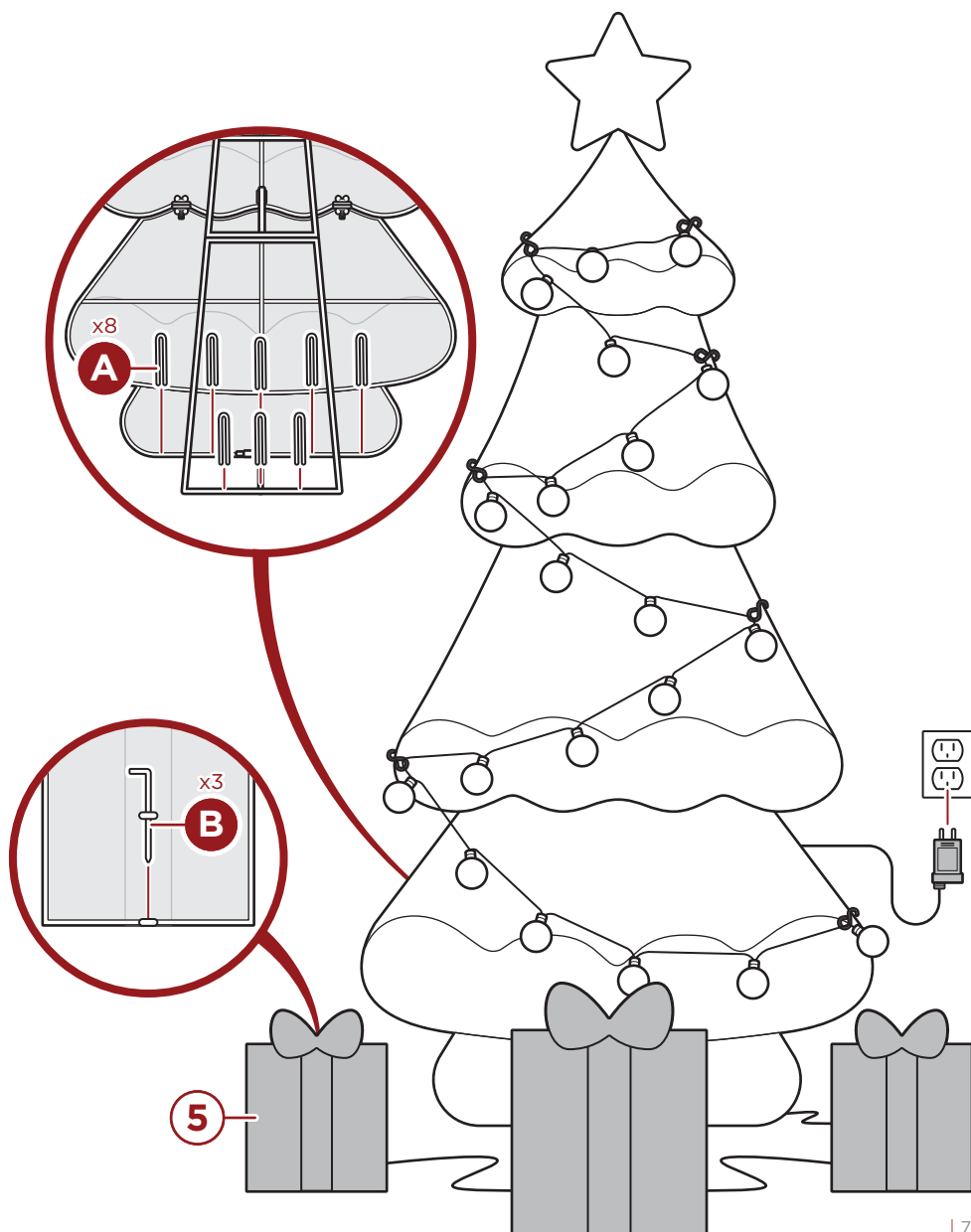



# HELP CENTER



Question about your product? We're here to help. Visit us at:

[help.bestchoiceproducts.com](http://help.bestchoiceproducts.com)



Chat Support



Product Inquiry



Orders FAQ



Product Assembly



Returns & Refunds

## PRODUCT WARRANTY INFORMATION

All items can be returned for any reason within 60 days of the receipt and will receive a full refund as long as the item is returned in its original product packaging and all accessories from its original shipment are included. All returned items will receive a full refund back to the original payment method. All returned items will not be charged a re-stocking fee.

All returned items require an RA (Return Authorization) number, which can only be provided by a Best Choice Products Customer Service Representative when the return request is submitted. Items received without an RA may not be accepted or may increase your return processing time. Once an item has been received by Best Choice Products, refunds or replacements will be processed within 5 business days.

All returns must be shipped back to the Best Choice Products Return Center at the customer's expense. If the reason for return is a result of an error by Best Choice Products then Best Choice Products will provide a pre-paid shipping label via email. Boxes for return shipping will not be provided by Best Choice Products, and is the customer's responsibility to either use the original shipping boxes or purchase new boxes.

Pictures may be required for some returns to ensure an item is not damaged prior to its return. Items returned are not considered undamaged until they are received by Best Choice Products and verified as such. All damages to items are the customer's responsibility until the item has been received by and acknowledge by Best Choice Products as undamaged.

© Best Choice Products, Inc. All rights reserved. Distributed by Best Choice Products, Inc. Tustin, CA 92780



## WARNING

Manufacturer and seller expressly disclaim any and all liability for personal injury, property damage or loss, whether direct, indirect, or incidental, resulting from the incorrect attachment, improper use, inadequate maintenance, unapproved modification, or neglect of this product.