

CAT900112

paulin[®]

ANCHORS

www.hpaulin.com

**HOLLOW WALL ANCHORS
CONCRETE ANCHORS
And more...**

HILLMAN[™]



At The Hillman Group, we stock a comprehensive range of standard and non-standard fasteners, hardware, fittings, fluid flow components and automotive products under our Hillman, Paulin, Papco, Dominion, and Pro-Tip family of brands. Our range of products are complimented by our ability to source any item in the required size and material for any type of project. Let us help standardize your range of products or create new programs with the help from our dynamic and vibrant organization. For over 100 years, the Paulin® brand has been recognized as an industry leader. Our customers are retailers, original equipment manufacturers, industrial and automotive aftermarket distributors, and plumbing and gas wholesalers.

The Hillman Group has been a customer-first organization that built a loyal customer base centred on trust, dedication and long-lasting relationships. Paulin® being the First In Fasteners, we look forward to being The Right Fastening Choice for you.

Our five strategically situated warehouses in Vancouver, Edmonton, Winnipeg, Toronto and Montreal are conveniently located to provide courteous service to all of our customers.

The items listed in our catalogue are a representation of the products available and stocked in our distribution network. Our availability may not represent all sizes available or certain applications required. Please contact your local Hillman customer service or sales representative for additional product inquiries. Our knowledgeable staff will provide you with information and solutions that are both cost effective and reliable.

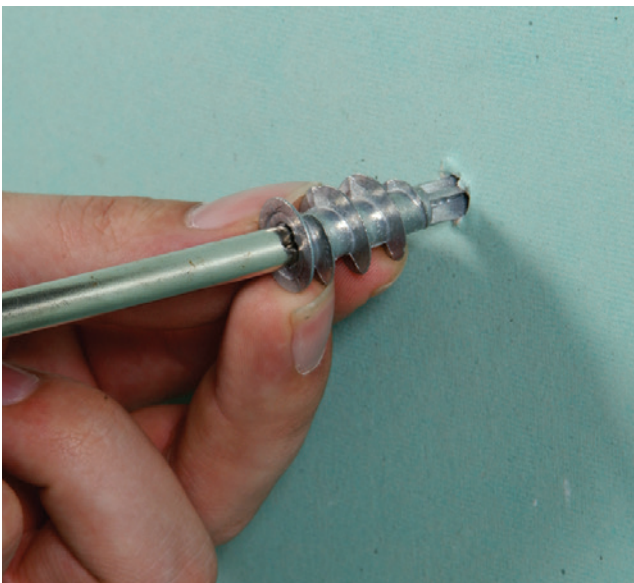

TABLE OF CONTENTS

HOLLOW WALL

Hollow Wall Anchors	10
Tie Wire Acoustic Lag Screws	24
Toggle Anchors Nylon (Plastic)	8
Toggle Bolts Zinc Plated	11
Wall Anchors Nylon	9
Wall Anchors Zinc	9
Wall Plugs	7

SOLID WALL

Acoustic Wedge Anchors	22
Conical Concrete Wall Anchors	12
Drop-In Anchors	15
Drop-In Anchors Setting Tool	15
Foundation Bolts	23
Lag Screw Driver Bit	24
Lag Shields	16
Lead Anchors	17
Nail-In Anchors	14
Plug For Masonry	13
Sleeve Anchors Stainless Steel	20
Sleeve Anchors Zinc Plated	21
Wedge Anchors Stainless Steel	18
Wedge Anchors Zinc Plated	19

PACKAGING TYPES AVAILABLE

Bag



Clamshell



Black Box



Jar



Bulk Carton
(1/4 Keg)



SELECTING AN ANCHOR

Before selecting an anchor for a specific project, the following installation conditions should be determined:

Project Load and Load Conditions – The total weight of the fixture or structure being secured and the applied forces to which the anchor will be subjected to after installation.

Project Climate Conditions – The environment in which the anchor is installed, such as outdoors, indoors, presence of moisture and other corrosive conditions found in materials such as pressure treated lumber.

BASE MATERIAL

The material in which the fixture or structure is being secured and what the anchor will be embedded in. The icons shown below represent the various base materials that Anchors are used in. Throughout this catalog you will see a mix of these icons shown by each anchor type. These icons reflect the different types of base materials that can be used with each anchor.



Drywall, or wallboard, is a low density material formed between two sheets of heavy paper. It is one of the most commonly used materials for covering studded walls and ceilings in residential and commercial applications. The three most common thicknesses of drywall are 3/8", 1/2" and 5/8". The most widely used thickness is 1/2".



Concrete is a mixture of cement, sand, aggregate, and water that hardens over varying lengths of time. Commonly used in home foundations, floors and ceilings of elevated buildings.



Masonry block is a mixture of cement, water, and aggregate that is commonly used in homes and commercial buildings for exterior walls. Block comes in both hollow and solid wall styles. Hollow block requires special anchoring products that can be installed into a material with empty cavities and still provide reliable load values.

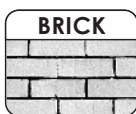

Brick is a rectangular shaped piece of baked clay that is used with mortar for building exterior walls and other permanent structures. Brick is available in many forms: hard or soft, and solid or hollow core.



Wood studs are light, structural timber boards milled from softwood trees and is a structural material most commonly covered by drywall and plaster. Wood paneling consists of boards or strips of wood covering a wall inside a building or material used in fabrication of doors and furniture.

HOLLOW WALL ANCHORS

Hollow Wall Anchors are a general description of anchors that are typically used in interior base material applications such as drywall. Oftentimes it could be used in other base materials including concrete, brick & block depending on the anchor type.

WALL PLUGS



NYLON TOGGLE ANCHORS



WALL ANCHORS ZINC



WALL ANCHORS NYLON



HOLLOW WALL ANCHORS



TOGGLE BOLTS



TIE WIRE ACOUSTIC LAG SCREW



SOLID WALL ANCHORS

Solid Wall Anchors are a general description of anchors that are typically used in solid base material applications. The most common of those base materials are concrete, brick & block. All solid wall anchors require pre-drilling a hole into the base material for installation.

CONICAL CONCRETE WALL ANCHOR



PLUG FOR MASONRY



NAIL-IN ANCHORS



DROP-IN ANCHORS



LAG SHIELDS



LEAD ANCHORS



WEDGE ANCHORS STAINLESS STEEL



WEDGE ANCHORS ZINC PLATED



SLEEVE ANCHORS STAINLESS STEEL



SLEEVE ANCHORS ZINC PLATED



ACOUSTIC WEDGE ANCHORS



FOUNDATION BOLTS



227
Series**537**
Series**paulin® WALL PLUGS**PART CLASS #
810AJ |

DRYWALL

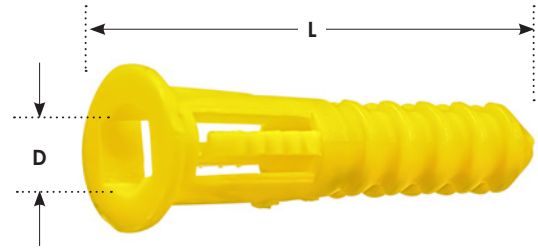
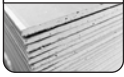

YELLOW PLASTIC ANCHORS are designed for hollow wall application in drywall. Used only for lightweight applications where holding strength is not critical. It has a one piece body with two horizontal slits which open to allow grip to the outside walls of the hole. It should not be used for overhead. Drill hole to the minimum depth required. Clean hole of dust after drilling. Insert anchor through the fixture and tap the anchor until it is flush with the surface of the material. Insert the proper size screw into the anchor and tighten until fixture is securely fastened.

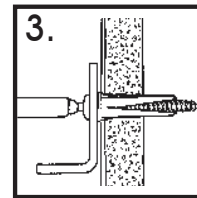
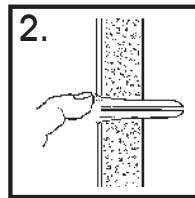
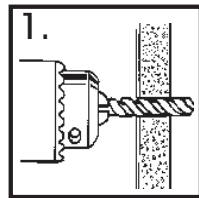

L = Length

D = Diameter

ORDER BY ITEM (PACKAGE) NUMBER

Product not available in this pack size

PLASTIC								
Screw Diameter x Anchor Length	Approx. Weight (lb) /100 pcs	Drill Hole Size (in)	Colour	Type	Bag #	Qty	Jar #	Qty
#6-8 x 3/4	0.098	3/16	Yellow	Hollow	—	—	537-345	850
#6-8 x 1	0.081	3/16	Yellow	Hollow	227-608	100	—	—
#8-12 x 1	0.176	1/4	Yellow	Hollow	—	—	537-346	450
#8-12 x 1-1/4	0.170	1/4	Yellow	Hollow	227-612	100	—	—
#12-14 x 1-1/2	0.200	19/64	Yellow	Hollow	227-614	100	—	—
#12-14 x 1-1/2	0.292	5/16	Yellow	Hollow	—	—	537-347	250

Load Capacities for DRYWALL			
Anchor Size (in)	Depth (in)	Tension (lbs)	Shear (lbs)
#6-8	1	180	215
#8-12	1-1/4	290	235
#12-14	1-1/2	350	280

227
Series

hpaulin[®]

NYLON TOGGLE ANCHORS

PART CLASS #
810AH |



NYLON TOGGLE ANCHORS are designed for hollow wall applications in wallboard and panelling. This toggle is designed to flare out creating a tight triangular clamp behind the hollow based material. The screw penetrates into the anchor making the tabs flare out creating a triangular shape. The extruded points that align the wings ensure extra grip to the material. Drill a 5/16" hole. Squeeze toggle together and push into the hole until flush with wall. Position fixture over the anchor. Insert the screw and tighten until it feels secure.

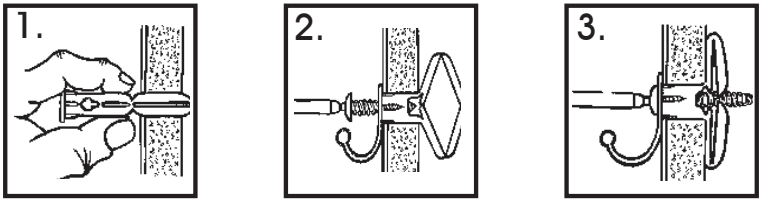

L = Length

ORDER BY ITEM (PACKAGE) NUMBER

NYLON (PLASTIC)				
Anchor Length	Approx. Weight (lb) /100 pcs	Drill Hole Size	Black Box #	Qty
3/8S	0.372	5/16	227-022	25
1/2L	0.242	5/16	227-024	25
5/8XL	—	5/16	227-026	25

Load Capacities for WALLBOARD		
Anchor Size (in)	5/16" Wallboard	
	Tension (lbs)	Shear (lbs)
3/8	135	165
1/2	150	220
5/8	170	250

537 Series paulin WALL ANCHORS

PART CLASS #
810AI |



E-Z ANCOR® SELF-DRILLING ANCHORS are designed for optimal holding in drywall (gypsum). Deep threads provide strong engagement in 3/8", 1/2" and 5/8" wallboards. Installs easily with either a phillips or square drive bit.

D = Diameter

ORDER BY ITEM (PACKAGE) NUMBER

ZINC				
Screw Diameter	Approx. Weight (lb) /100 pcs	Drill Hole Size (in)	Jar #	Qty
#8	1.4133	N/R	537-357	150

537 Series paulin WALL ANCHORS

PART CLASS #
810AI |



E-Z ANCOR® TWIST N LOCK SELF-DRILLING ANCHORS are designed for optimal holding in drywall (gypsum). Deep threads provide strong engagement in 3/8", 1/2" and 5/8" wallboards. Twist N Lock design splits and grips easily and provides a strong hold. Installs easily with either a phillips or square drive bit.

D = Diameter

ORDER BY ITEM (PACKAGE) NUMBER

NYLON				
Screw Diameter	Approx. Weight (lb) /100 pcs	Drill Hole Size (in)	Jar #	Qty
#6	0.365	N/R	537-355	200
#8	0.393	N/R	537-356	150

227
Series

paulin[®] HOLLOW WALL ANCHORS

PART CLASS #
810AI |



HOLLOW WALL ANCHORS or “Molly” anchors are designed to expand and grip as the screw is tightened in drywall, plaster or other hollow wall applications. These anchors are available in various wall thicknesses, therefore, check size designation on the package. Once installed screw may be removed and re-installed as often as required. For drill type anchors, drill hole the size of anchor and install. For hammer-in type simply install by tapping in with a hammer.

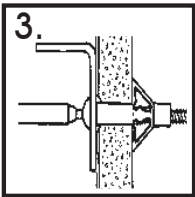
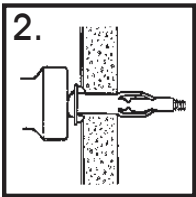
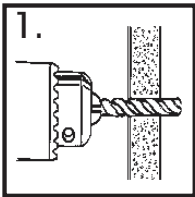

D = Diameter

ORDER BY ITEM (PACKAGE) NUMBER

ZINC PLATED				
Anchor Diameter	Approx. Weight (lb) /100 pcs	Drill Hole Size (in)	Black Box #	Qty
1/4S	4.6750	7/16	227-132	40
1/4L	—	7/16	227-133	40

			Wallboard Thickness			
	Anchor Size	Depth	3/8"	1/2"	5/8"	3/4"
Tension (lbs)	1/4	7/16	95	200	220	245
Shear (lbs)	1/4	7/16	150	200	220	250

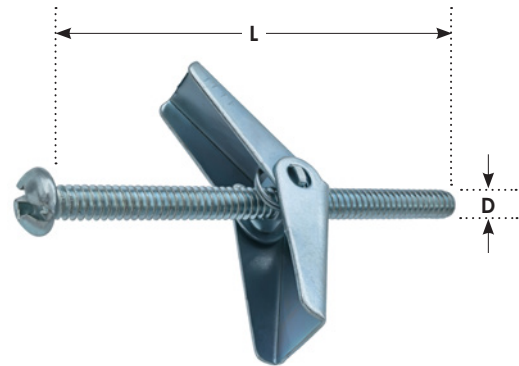
227
Series**537**
Series**hpaulin® TOGGLE BOLTS**PART CLASS #
810AH |

TOGGLE BOLTS are a hollow wall anchoring device specifically used in block, drywall, and other hollow materials. The anchor has a dual wing spread that opens automatically with an internal spring. Once the anchor is pushed through and tightened, the wing is calibrated to sit flush against the backside of the wall. This provides even weight distribution and prevents pull out. Drill required hole through the material. Insert bolt through fixture and attach wing. Fold wings completely back and insert through hole. Push through until wings are released and then pull back so that wings sit flush with the back of the material. Tighten bolt until firmly in place.

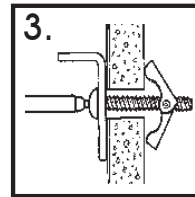
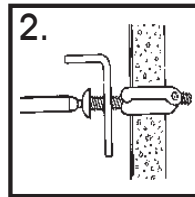
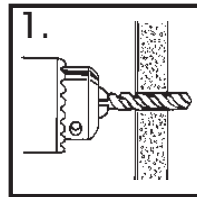

L = Length

D = Diameter

ORDER BY ITEM (PACKAGE) NUMBER

Product not available in this pack size

ZINC PLATED

Anchor Diameter x Length	Approx. Weight (lb) /100 pcs	Drill Hole Size	Clamshell #	Qty	Jar #	Qty	Jar Size
1/8 x 2	1.460	3/8	227-684	30	537-330	50	400
1/8 x 3	1.740	3/8	227-685	25	537-331	50	400
1/8 x 4	2.010	3/8	—	—	537-332	50	400
3/16 x 2	2.720	9/16	227-688	20	537-333	50	750
3/16 x 3	3.310	9/16	227-690	20	537-334	50	750
3/16 x 4	3.910	9/16	227-691	20	537-335	50	750
1/4 x 3	5.690	3/4	227-692	12	537-336	50	750
1/4 x 4	6.688	3/4	227-694	12	537-337	40	750

Load Capacities for WALLBOARD

Anchor Size (in)	3/8" Wallboard		1/2" Wallboard		5/8" Wallboard		3/4" Wallboard	
	Tension (lbs)	Shear (lbs)	Tension (lbs)	Shear (lbs)	Tension (lbs)	Shear (lbs)	Tension (lbs)	Shear (lbs)
1/8	150	180	200	205	250	265	290	310
3/16	170	210	245	280	315	350	385	420
1/4	285	310	310	350	350	385	420	445
5/16	320	360	330	420	365	450	425	510
3/8	325	370	340	440	385	470	450	530

227
Series

537
Series

paulin

CONICAL CONCRETE WALL ANCHORS

PART CLASS #
810AI | 810AJ

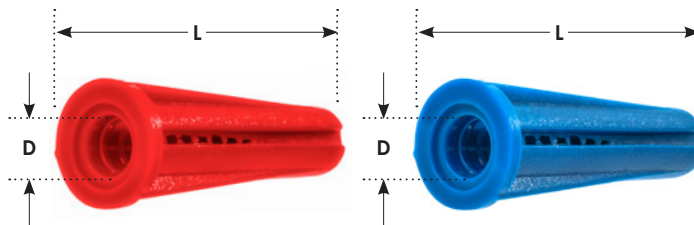
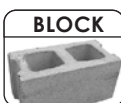

BLUE OR RED CONICAL PLASTIC ANCHORS can be used in concrete, block, brick and wallboard. They are specifically designed for lightweight use only. They are a one piece plug with three slots that don't allow the anchor to spin freely in the hole when tightened. Drill hole to the length of the plug so that it sits flush with the surface. Clean hole of dust after drilling. Tap anchor into the hole with hammer. Position fixture and tighten screw until the threads grip the anchor body.

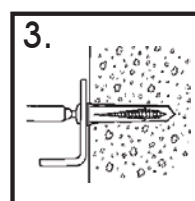
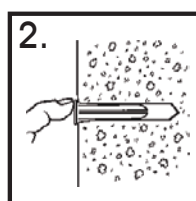
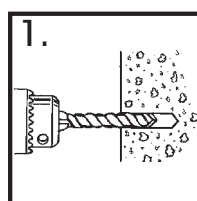

L = Length

D = Diameter

ORDER BY ITEM (PACKAGE) NUMBER

PLASTIC								
Screw Diameter x Anchor Length	Approx. Weight (lb) /100 pcs	Drill Hole Size (in)	Colour	Type	Black Box #	Qty	Jar #	Qty
#6-8 x 3/4	0.075	3/16	Blue	Concrete	227-046	100	537-340	900
#8-10 x 7/8	0.100	3/16	Red	Concrete	227-048	100	537-341	900
#10-12 x 1	0.150	1/4	Blue	Concrete	227-050	100	537-342	500
#14-16 x 1-3/8	0.270	5/16	Red	Hollow	227-054	50	537-343	250

Load Capacities for:			BLOCK		BRICK		CONCRETE					
Anchor Size (in)	Color	Depth (in)	Tension (lbs)	Shear (lbs)	Tension (lbs)	Shear (lbs)	2000 psi		4000 psi		6000 psi	
							Tension (lbs)	Shear (lbs)	Tension (lbs)	Shear (lbs)	Tension (lbs)	Shear (lbs)
#6-8	Blue	3/4	180	215	100	230	185	215	210	240	225	240
#8-10	Red	7/8	290	235	160	260	300	235	440	280	520	280
#10-12	Blue	1	350	280	280	320	350	280	550	350	640	350
#14-16	Red	1-1/2	840	530	880	500	840	530	840	575	900	575

227
Series

537
Series

hpaulin® PLUG FOR MASONRY

PART CLASS #
810AC |

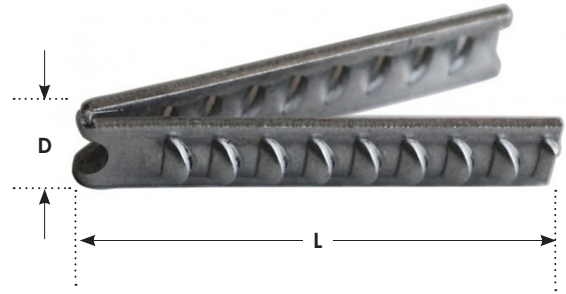
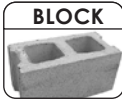

PLUG FOR MASONRY are commonly used with screw fasteners to secure objects in place. They are designed to be used with drywall or masonry walls, floors or ceilings.

L = Length

D = Diameter

ORDER BY ITEM (PACKAGE) NUMBER

 Product not available in this pack size

ALUMINUM						
Anchor Diameter x Length	Screw Diameter	Approx. Weight (lb) /100 pcs	Bag #	Qty	Jar #	Qty
1/4 x 1	#6-10	0.185	227-099	100	537-348	100
1/4 x 1-1/4	#6-10	—	—	—	537-349	100
1/4 x 1-1/2	#6-10	—	—	—	537-350	100

227
Series

paulin®

NAIL-IN ANCHORS

PART CLASS #
810AB |

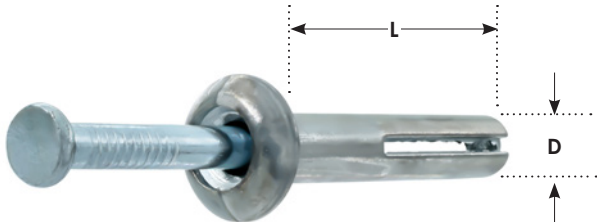

NAIL-IN ANCHORS are a nail drive anchor used in cement block, solid concrete, brick or stone. The anchor has a corrosion resistant zinc alloy coating and carbon steel nail. As the nail is driven into the anchor body, each half of the expansion mechanism is compressed against the walls of the drilled hole. Drill hole 1/4" deeper than the required embedment. Clean hole of dust after drilling. Insert anchor through the fixture and hammer in the nail head until flush.

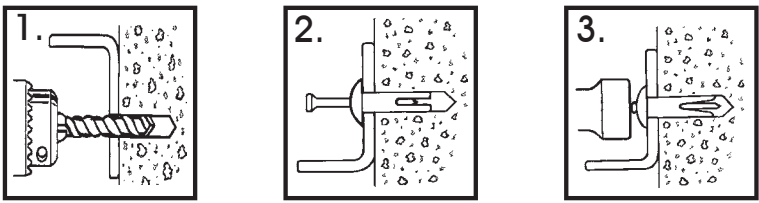

L = Length D = Diameter

ORDER BY ITEM (PACKAGE) NUMBER

ZINC PLATED / ALLOY						
Anchor Diameter x Length	Approx. Weight (lb) /100 pcs	Hole Drill Size (in)	Black Box #	Qty	Jar #	Qty
1/4 x 1	1.750	1/4	227-104	40	537-360	100
1/4 x 1-1/4	2.000	1/4	227-106	40	537-361	100
1/4 x 1-1/2	2.670	1/4	227-108	30	537-362	100
1/4 x 2	4.000	1/4	227-110	30	537-363	100

Load Capacities for BLOCK			
Anchor Size (in)	Depth (in)	Tension (lbs)	Shear (lbs)
1/4	1	590	1320
1/4	1-1/4	800	1320
1/4	2	1000	1320

Load Capacities for BRICK			
Anchor Size (in)	Depth (in)	Tension (lbs)	Shear (lbs)
1/4	1	820	1400
1/4	1-1/4	950	1400
1/4	2	1115	1400

227
Series

paulin® DROP-IN ANCHORS

PART CLASS #
810AC |

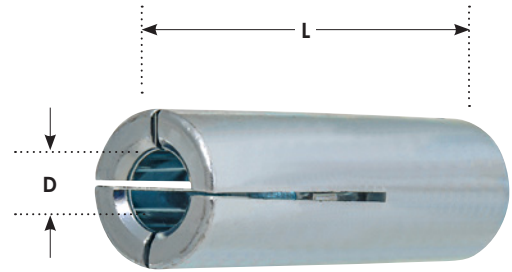
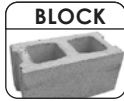

DROP-IN ANCHORS are ideal for anchoring bolts or threaded rod into concrete, brick, block or stone. The anchor is expanded with a setting tool which drives the internal plug to the end of the anchor. This in turn expands the four slots surrounding the plug holding the anchor in place. Drill hole size indicated in chart below. Clean hole of dust after drilling. Tap the anchor flush to the surface. Set the internal anchor using the Paulin setting tool. Drive the tool into the anchor until the tool sits flush with the surface.

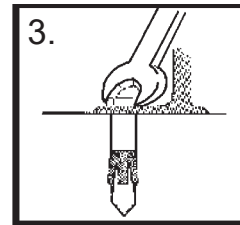
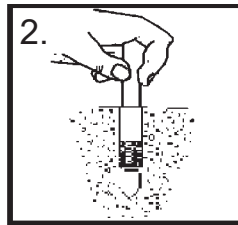
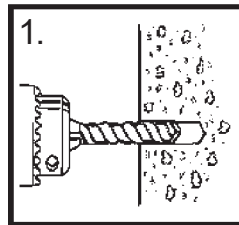

L = Length

D = Diameter

ORDER BY ITEM (PACKAGE) NUMBER

ZINC PLATED				
Anchor Diameter x Length	Approx. Weight (lb) /100 pcs	Hole Drill Size (in)	Black Box #	Qty
1/4 x 1	2.000	3/8	227-200	25
3/8 x 1-9/16	5.600	1/2	227-202	25
1/2 x 2	10.800	5/8	227-204	25

2000 psi Concrete		4000 psi Concrete		6000 psi Concrete	
Tension	Shear	Tension	Shear	Tension	Shear
1950	1760	3400	1800	3880	3120
3230	3990	6400	4220	5740	5970
4100	5940	9000	6640	10660	11000

227
Series

paulin® DROP-IN ANCHOR SETTING TOOL

PART CLASS #
805AJ |



ZINC PLATED			
Diameter	Approx. Weight (lb)/100 pcs	Bag #	Qty
1/4	17.000	227-210	1
3/8	20.500	227-212	1
1/2	40.000	227-214	1

135
Series

 LAG SHIELDS

PART CLASS #
810AA |

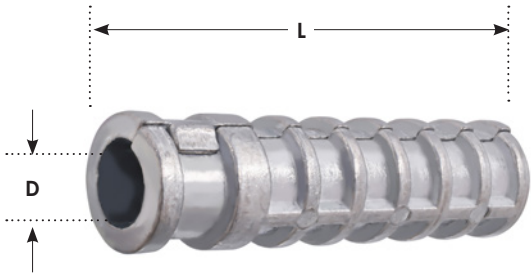

LAG SHIELDS are a screw type anchor designed to be used with Lag Screws. Short type shields are used in harder masonry materials to reduce drilling time. The Long version is used in soft masonry to develop better holding strength. For use in concrete or mortar joints of brick or block walls. Drill hole size embossed on shield to the depth of embedment required plus 1/2". Clean hole of dust after drilling. Tap in anchor until head is flush with surface. Apply lag screw and tighten.

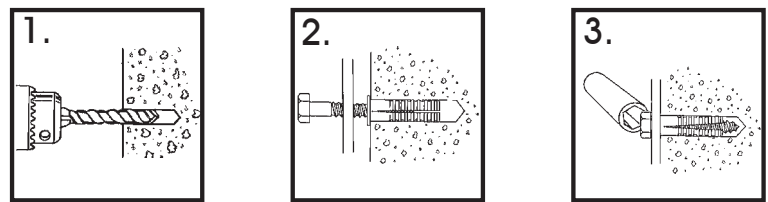

L = Length D = Diameter

ORDER BY ITEM (PACKAGE) NUMBER

 Product not available in this pack size

ZINC ALLOY						
Anchor Diameter x Length	Approx. Weight (lb)/100 pcs	Hole Drill Size (in)	Black Box #	Qty	Bulk Carton #	Qty
1/4S	2.510	1/2	135-800	50	B135-800	1500
1/4L	3.250	1/2	135-802	50	B135-802	1000
5/16S	2.752	1/2	135-804	50	B135-804	1250
5/16L	3.750	1/2	135-806	50	B135-806	1000
3/8S	5.830	5/8	135-808	50	B135-808	500
3/8L	7.970	5/8	135-810	50	B135-810	350
1/2S	8.220	3/4	135-812	25	B135-812	400
1/2L	11.550	3/4	135-814	25	B135-814	200

Load Capacities for BLOCK			
Anchor Size (in)	Depth (in)	Tension (lbs)	Shear (lbs)
1/4	1	390	800
5/16	1-1/4	580	1140
3/8	1-1/2	920	1250
1/2	1-1/2	1210	1780

Load Capacities for BRICK			
Anchor Size (in)	Depth (in)	Tension (lbs)	Shear (lbs)
1/4	1	400	1140
5/16	1-1/4	980	1650
3/8	1-1/2	1380	1800
1/2	1-1/2	1980	2380

135
Series

paulin® LEAD ANCHORS

PART CLASS #
810AJ |

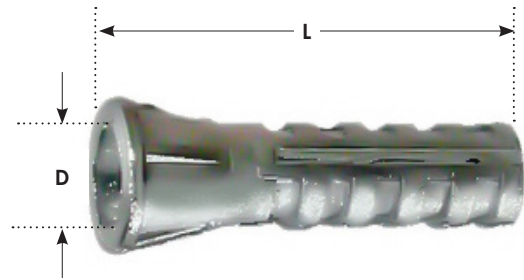
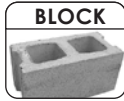
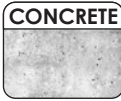

LEAD ANCHORS are made entirely of lead alloy which is soft enough for easy installation, yet hard enough to ensure holding strength. This anchor is recommended for light duty workloads where holding strength is at a minimum. Drill hole same size as diameter of anchor to the depth required. Clean hole of dust after drilling. Insert anchor flush to the surface of the material. Insert screw through the fixture, into the anchor and tighten.

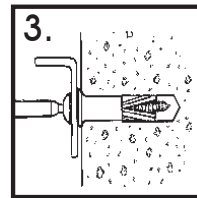
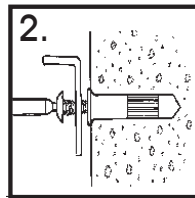
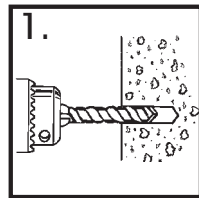

L = Length

D = Diameter

ORDER BY ITEM (PACKAGE) NUMBER

Product not available in this pack size

ZINC ALLOY						
Anchor Diameter x Length	Approx. Weight (lb)/100 pcs	Hole Drill Size (in)	Black Box #	Qty	Bulk Carton #	Qty
#6-8 x 3/4	0.950	1/4	135-830	100	—	—
#6-8 x 1	1.504	1/4	135-832	100	B135-832	2500
#6-8 x 1-1/2	1.765	1/4	135-834	100	—	—
#10-14 x 1	1.855	5/16	135-838	100	—	—
#10-14 x 1-1/2	3.300	5/16	135-840	100	B135-840EA	1200

Load Capacities for BLOCK			
Anchor Size (in)	Depth (in)	Tension (lbs)	Shear (lbs)
#6-8	3/4	70	200
#6-8	1	100	280
#6-8	1-1/2	200	300
#10-14	1	410	520
#10-14	1-1/2	640	900

Load Capacities for BRICK			
Anchor Size (in)	Depth (in)	Tension (lbs)	Shear (lbs)
#6-8	3/4	95	200
#6-8	1	200	420
#6-8	1-1/2	300	460
#10-14	1	410	520
#10-14	1-1/2	790	900

5198
Series

paulin®

WEDGE ANCHORS

PART CLASS #
810AL |

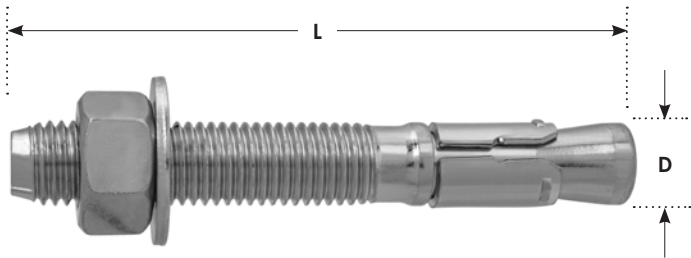

WEDGE ANCHORS are designed for anchoring fixtures into solid concrete or grout filled masonry. These anchors work by inserting them into a hole drilled into concrete and tightening the nut against the fixture. The three prong wrap around clip slides down and is then expanded, wedging itself securely in the concrete. Our wedge anchors have a chamfered threaded end for ease of starting nut and a heavy duty three prong wrap around clip to secure tightly against the concrete.

L = Length

D = Diameter

ORDER BY ITEM (PACKAGE) NUMBER

STAINLESS STEEL							
Anchor Diameter x Length	Approx. Weight (lb) /100 pcs	Concrete Embed.	Max. Mat Thickness	Ultimate Load Capacity*		Black Box #	Qty
				Load Lbs	Shear Lbs		
1/4 x 2-1/4	3.200	1-15/16	7/8	2999	1910	5198-020	10
3/8 x 2-1/4	8.000	1-1/2	3/8	2319	4029	5198-022	10
3/8 x 2-3/4	8.000	1-1/2	7/8	3219	4029	5198-023	10
3/8 x 3-3/4	1.000	4-1/2	1-7/8	5935	4581	5198-025	10
1/2 x 2-3/4	17.850	2-1/4	1-1/8	5100	4760	5198-026	10
1/2 x 3-3/4	3.000	2-1/4	1-1/8	5384	6900	5198-027	10
1/2 x 4-1/2	13.000	4-1/8	1-1/2	7333	7449	5198-029	10

227
Series

paulin WEDGE ANCHORS

PART CLASS #
810AK |

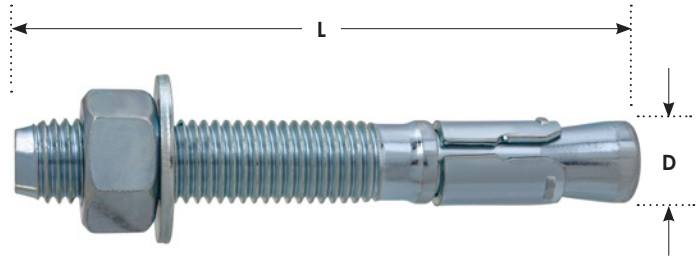
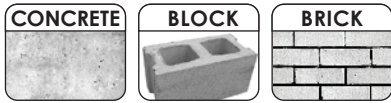

WEDGE ANCHORS are designed for anchoring fixtures into solid concrete or grout filled masonry. These anchors work by inserting them into a hole drilled into concrete and tightening the nut against the fixture. The three prong wrap around clip slides down and is then expanded, wedging itself securely in the concrete. Our wedge anchors have a chamfered threaded end for ease of starting nut and a heavy duty three prong wrap around clip to secure tightly against the concrete.

L = Length

D = Diameter

ORDER BY ITEM (PACKAGE) NUMBER

ZINC PLATED				
Anchor Diameter x Length	Approx. Weight (lb) /100 pcs	Drill Hole Size (in)	Black Box #	Qty
3/8 x 2-3/4	8.800	3/8	227-150	50
3/8 x 3	9.630	3/8	227-152	50
3/8 x 3-3/4	11.280	3/8	227-154	50
1/2 x 3-3/4	20.940	1/2	227-156	25
1/2 x 4-1/2	24.080	1/2	227-158	25
5/8 x 4-1/2	40.150	5/8	227-160	10
5/8 x 5	46.400	5/8	227-162	10
3/4 x 4-1/4	61.200	3/4	227-170	10

Anchor Size (in)	Embed Depth (in)	Torque	2000 psi		4000 psi		6000 psi	
			Shear (lbs)	Tension (lbs)	Shear (lbs)	Tension (lbs)	Shear (lbs)	Tension (lbs)
3/8	1-1/2	25-30	1631	4318	3636	5121	4448	6232
	3		3229	4318	5653	5121	5975	6232
	5		4074	4318	6328	5121	6360	6232
1/2	2-1/4	50-60	3999	7419	6714	9377	9616	9888
	4		6336	7419	8942	9377	10192	9888
	6		6902	7419	10175	9377	12064	9888
5/8	3-3/4	75-90	4999	8264	8747	12928	9760	16373
	5		8854	8264	15590	12928	16802	16373
	7		9381	8264	16710	12928	17732	16373
3/4	3-1/4	150-175	6638	12504	11314	17050	16230	22965
	6		10084	12504	18408	17050	21092	22965
	6		11170	12504	19805	17050	22522	22965

5198
Series

hpaulin® SLEEVE ANCHORS

PART CLASS #
810AG |



SLEEVE ANCHORS are designed for anchoring fixtures into concrete, brick and block. Sleeve anchors work by inserting them into a hole drilled into concrete. Turning the nut pulls the working end of the sleeve anchor up through the sleeve, expanding and anchoring itself securely in the concrete, brick or block.

L = Length

D = Diameter

ORDER BY ITEM (PACKAGE) NUMBER

 Product not available in this pack size

STAINLESS STEEL							
Anchor Diameter x Length	Approx. Weight (lb) /100 pcs	Min. Embed	Max. Mat. Thicknes	Ultimate Load Capacity		Black Box #	Qty
				Load Lbs	Shear Lbs		
3/8 x 1-7/8	—	1-1/2	3/8	2597	2872	5198-006	10
3/8 x 3	8.950	1-1/2	1-1/2	2597	2872	5198-007	10

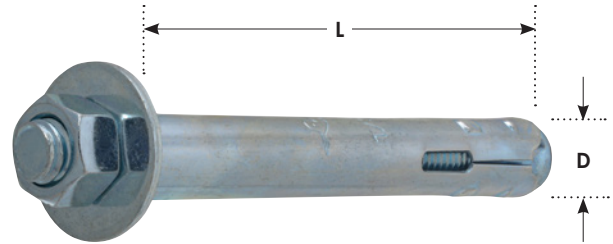
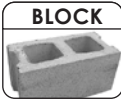
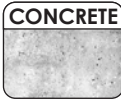
227
Series**paulin® SLEEVE ANCHORS**PART CLASS #
810AF |

SLEEVE ANCHORS are designed for anchoring fixtures into concrete, brick and block. Sleeve anchors work by inserting them into a hole drilled into concrete. Turning the nut pulls the working end of the sleeve anchor up through the sleeve, expanding and anchoring itself securely in the concrete, brick or block.

L = Length

D = Diameter

ORDER BY ITEM (PACKAGE) NUMBER

ZINC PLATED				
Anchor Diameter x Length	Approx. Weight (lb) /100 pcs	Hole Drill Size (in)	Black Box #	Qty
3/8 x 1-7/8	6.910	3/8	227-180	50
3/8 x 3	9.290	3/8	227-182	50
1/2 x 2-1/4	12.260	1/2 x 2-1/4	227-190	25
1/2 x 2-3/4	19.600	1/2	227-192	25
1/2 x 4	19.000	1/2	227-194	25

Anchor Size (in)	Embed Depth (in)	Torque	Grout Filled CMU					
			2000 psi		Single Face Shell		Mortar "T" Joint	
			Shear (lbs)	Tension (lbs)	Shear (lbs)	Tension (lbs)	Shear (lbs)	Tension (lbs)
3/8	1-1/2	15	1590	3060	1735	2860	1915	3420
1/2	2-1/4	25	3145	4975	3370	5650	3835	5835

DYNABOLT®

ZINC PLATED							
Anchor Diameter x Length	Approx. Weight (lb) /100 pcs	Min. Embed	Max. Mat. Thicknes	Ultimate Load Capacity		Black Box #	Qty
				Load Lbs	Shear Lbs		
1/2 x 2-1/4	—	1-7/8	3/8	5385	5582	3430B	25
1/2 x 3	16.100	1-7/8	1-1/8	5385	5582	3435X	10
1/2 x 4	19.700	1-7/8	2-1/8	5385	5582	3440X	10

222
Series

537
Series

hpaulin[®] ACOUSTIC WEDGE ANCHORS

PART CLASS #
810AK |

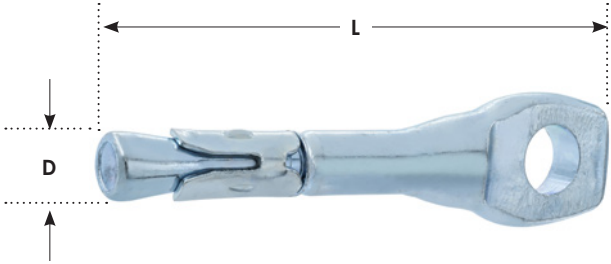
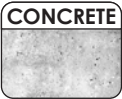

ACOUSTIC WEDGE ANCHORS are a wedge-style expansion anchor for use in normal-weight concrete or in concrete over metal deck.

L = Length

D = Diameter

ORDER BY ITEM (PACKAGE) NUMBER

ZINC PLATED						
Anchor Diameter x Length	Approx. Weight (lb) /100 pcs	Drill Hole Size (in)	Bulk Carton #	Qty	Jar #	Qty
1/4 x 2-1/4	3.713	1/4	B222-202	1500	537-402	150

141
Series

paulin® FOUNDATION BOLTS

PART CLASS #
810AC |

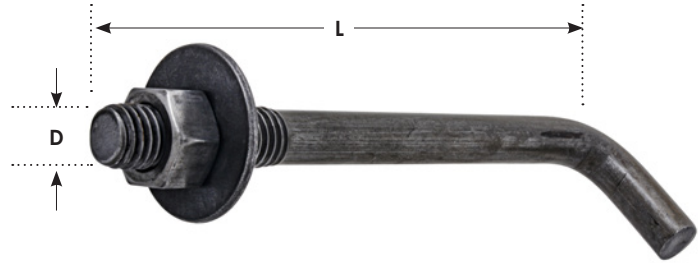
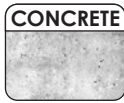

FOUNDATION BOLTS are made from low carbon steel. Used for anchoring such things as wood stud walls, structural steel columns, light poles, highway sign structures, bridge rail equipment and many other applications in pre-poured concrete. Leg of bolt is firmly embedded in concrete after it cures, allowing for clamping on the threaded portion of the bolt.

L = Length

D = Diameter

ORDER BY ITEM (PACKAGE) NUMBER

CARBON STEEL			
Anchor Diameter x Length	Approx. Weight (lb) /100 pcs	Bag #	Qty
1/2 x 6	39.000	141-061	1
1/2 x 8	46.000	141-063	1

222
Series

paulin®

TIE WIRE ACOUSTIC LAG SCREWS

PART CLASS #
810AE |

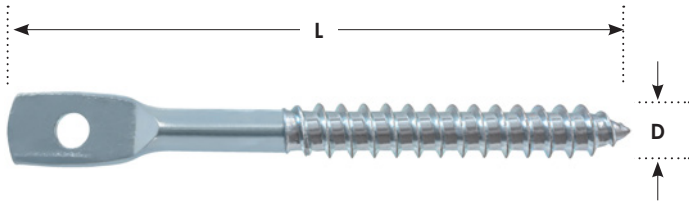

TIE WIRE ACOUSTIC LAG SCREWS are used for drop ceiling applications in wood. They are specifically designed to withhold the weight of t-bar drop ceiling construction. Drill a 3/16" pilot hole to the depth of the allocated screw. Using the Paulin Lag Screw Driver (847-570), insert the flat head into the driver and tighten until resistance is felt.

L = Length D = Diameter

ORDER BY ITEM (PACKAGE) NUMBER

ZINC PLATED						
Anchor Diameter x Length	Approx. Weight (lb) /100 pcs	Hole Drill Size (in)	Bag #	Qty	Bulk Carton #	Qty
1/4 x 3	2.200	3/16	222-200	50	B222-200	2000

847
Series

paulin®

LAG SCREW DRIVER BIT

PART CLASS #
805AJ |

ZINC PLATED	
Clamshell #	Qty
847-570	1

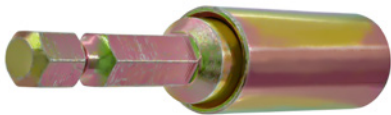

PROJECT LOAD AND LOAD CONDITIONS

When determining the total weight of the fixture or structure, keep in mind the total item(s) weight and variable forces that may be applied. For example, visualize a project to install a towel bar in a restroom. Consider the weight of the towel bar itself, towels that it will accommodate, if the towels may be wet (additional weight), and the repetitive forces applied to the fixture used during removal and replacement of the towel.

MAXIMUM ALLOWABLE LOAD

The Maximum Allowable Load is calculated based on applying a safety factor to the average ultimate shear and tension loads obtained from laboratory testing. The Maximum Allowable Load can be found on most Paulin Anchor packages or within this catalogue to assist in locating the proper anchor for your project. The Maximum Allowable Load is a guide only and cannot be guaranteed. Pound ratings are based on the anchor only. Effectiveness can be diminished based on the material and conditions of the base material.

LOAD CONDITION FACTORS

When calculating required holding power, the way the load is transferred to the anchor should be considered, as well as the load factor. The conditions of use should be reviewed. Is the installed anchor being used to support a static load, or will it be subjected to a vibration or shock load?

1. **STATIC LOAD** – constant of unchanging where no outside force will be applied, such as mirrors, electrical outlet boxes, and flush mounted signs.
2. **VARIABLE or COMBINED LOAD** – irregular load is experienced as found in suspended signs, hand rails or drapery rods. The load may be applied to the anchor at any angle from 0 to 90.
3. **VIBRATION LOAD** – high frequency but low intensity impact, such as encountered in motor or fan installation.
4. **SHOCK or IMPACT LOAD** – intense or sharply applied impacts as encountered in door bumpers and guard rails.
5. **TENSION LOAD** – direct load applied to installed anchor at 180° angle, either horizontally or vertically as found in ceiling light or clothesline installations.
6. **SHEAR LOAD** – load applied to installed anchor at 90° angle as encountered in bookshelves.

PROJECT CLIMATE CONDITIONS

Environmental factors and fixture material types (treated lumber) may have an effect on the life of the anchor. Specific anchor materials and coatings are designed to protect against the corrosive effects found in outdoor applications where moisture may be present and where the anchor is exposed to chemicals found in pressure treated lumber. Use the appropriate anchor based on the environmental conditions in which it will be used.



TORONTO

900 Passmore Avenue, Toronto, ON, M1X 0C6

Tel: 416-694-3351

Fax: 416-981-7956

LAVAL

2591 Debray Street Laval, QC H7S 2J4

Tel: 1-450-688-4292

Fax: 1-450-688-4750

EDMONTON

17306 129th Avenue Edmonton, AB T5V 0C7

Tel: 1-800-262-9026

Fax: 1-780-900-0463

WINNIPEG

1670-A Inkster Blvd. Winnipeg, MB. R2X 2W8

Tel: 1-204-694-3802

Fax: 1-204-694-3804

VANCOUVER

3179 Thunderbird Cres. Burnaby, BC V5A 3G1

Tel: 1-604-421-3096

Fax: 1-604-357-1112

The Hillman Group Canada ULC

HILLMAN™