

PARTS LIST

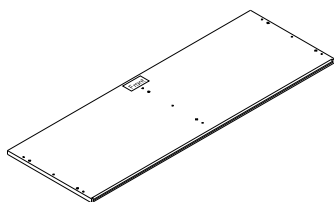

NAME: TOP PANEL
CODE: 1
QTY: 1Pc

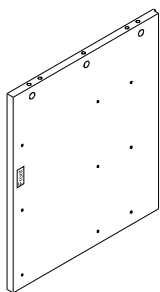

NAME: SIDE PANEL(LEFT)
CODE: 2
QTY: 1Pc

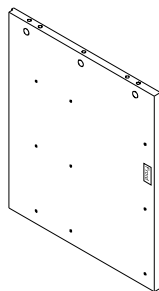

NAME: SIDE PANEL(RIGHT)
CODE: 3
QTY: 1Pc

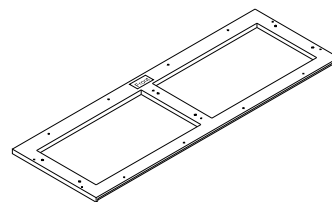

NAME: BOTTOM FRAME
CODE: 4
QTY: 1Pc

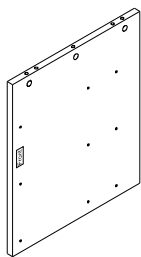

NAME: PARTITION
CODE: 5
QTY: 1Pc

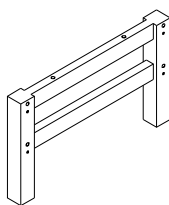

NAME: SIDE LEG
CODE: 6
QTY: 2Pcs

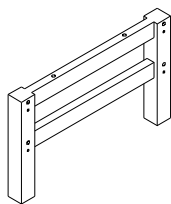

NAME: CENTER LEG
CODE: 7
QTY: 1Pc

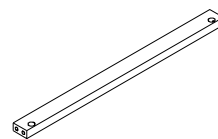

NAME: BOTTOM BAR
CODE: 8
QTY: 8Pcs

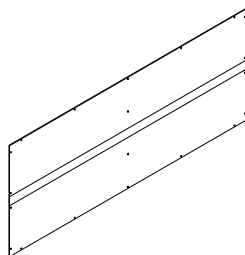

NAME: BACK PLYWOOD
CODE: 9
QTY: 1Pc

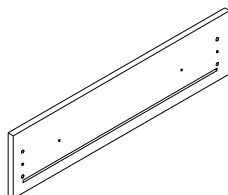

NAME: DRAWER FRONT(LEFT)
CODE: 101
QTY: 3Pcs

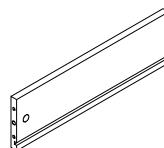

NAME: DRAWER SIDE(LEFT)
CODE: 102
QTY: 6Pcs

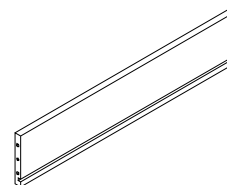

NAME: DRAWER BACK
CODE: 103
QTY: 6Pcs

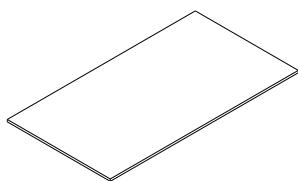

NAME: DRAWER BASE
CODE: 104
QTY: 6Pcs

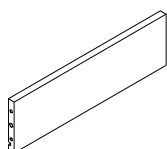

NAME: DRAWER SIDE(RIGHT)
CODE: 105
QTY: 6Pcs

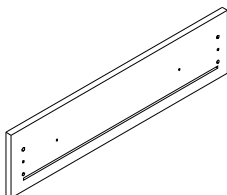

NAME: DRAWER FRONT (RIGHT)
CODE: 106
QTY: 3Pcs

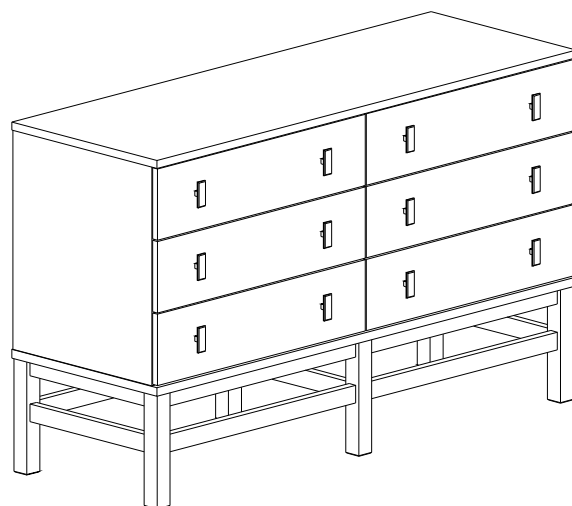

6 DRAWER DRESSER

—THE UNIT SHOULD BE ASSEMBLED BY 2 OR MORE PEOPLE
—EXTRA HARDWARE INCLUDED

HARDWARE LIST



NAME: CHIPBOARD SCREW M3X16mm
CODE: A
QTY: 72Pcs



NAME: PANHEAD SCREW M4X20mm
CODE: B
QTY: 12Pcs

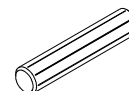

NAME: WOOD DOWEL M8X35mm
CODE: C
QTY: 34Pcs

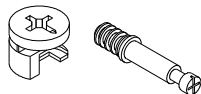

NAME: CAM LOCK & CAM BOLT
CODE: D
QTY: 49Sets



NAME: WOOD DOWEL M6X30mm
CODE: E
QTY: 48Pcs



NAME: RUNNER 400mm
CODE: F
QTY: 6Sets



NAME: CAM LOCK COVER
CODE: G
QTY: 49Pcs



NAME: PANHEAD CHIPBOARD SCREW M4X16mm(BLACK)
CODE: H
QTY: 20Pcs



NAME: CHIPBOARD SCREW M4X38mm
CODE: I
QTY: 14Pcs



NAME: HANDLE
CODE: J
QTY: 12Pcs

STEP 1

- A) Insert and secure Cam Bolt(D) to Top Panel(1)

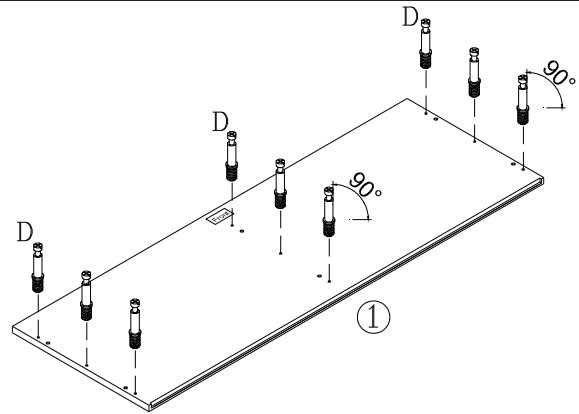
STEP 2

- A) Insert Wood Dowel(C) to Left&Right Side Panel(2&3)
 B) Attach Cam Lock(D) to Left&Right Side Panel(2&3)

NOTE : Make sure arrows on each Cam Lock points towards nearest edge with holes

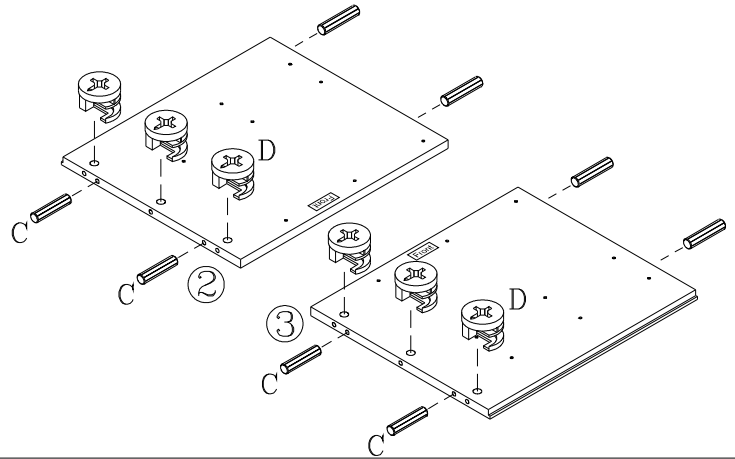
STEP 3

- A) Attach Runner(F) to Left&Right Side Panel(2&3) using Chipboard Screw(A) to secure

NOTE : Do not over tighten the screw

NOTE : Runner roller should be toward the front of the panel

NOTE : Chipboard Screw(A) should be assembled from the front of the runner. Start from A¹, A² then A³

NOTE : Make sure the screws are installed vertically without slant to ensure screw sits properly in the hole

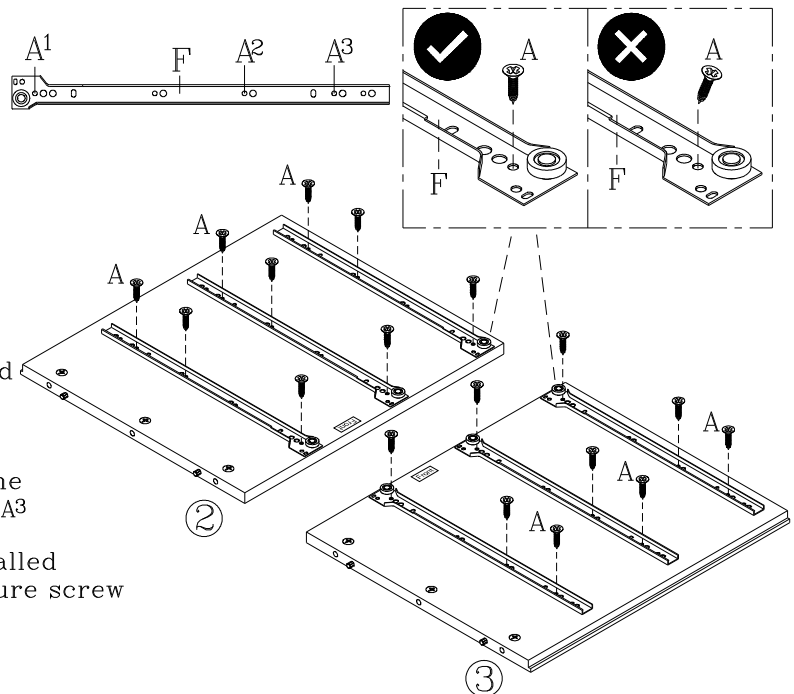
STEP 4

- A) Insert Wood Dowel(C) to Partition(5)
 B) Attach Cam Lock(D) to Partition(5)

NOTE : Make sure arrows on each Cam Lock points towards nearest edge with holes

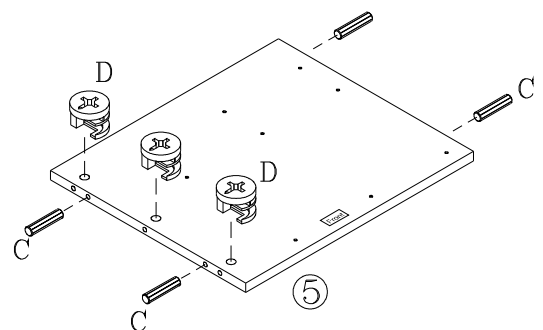

STEP 5

- A) Attach Runner(F) to both side of Partition(5) using Chipboard Screw(A) to secure

NOTE : Do not over tighten the screw

NOTE : Runner roller should be toward the front of the panel

NOTE : Chipboard Screw(A) should be assembled from the front of the runner. Start from A¹, A² then A³

NOTE : Make sure the screws are installed vertically without slant to ensure screw sits properly in the hole

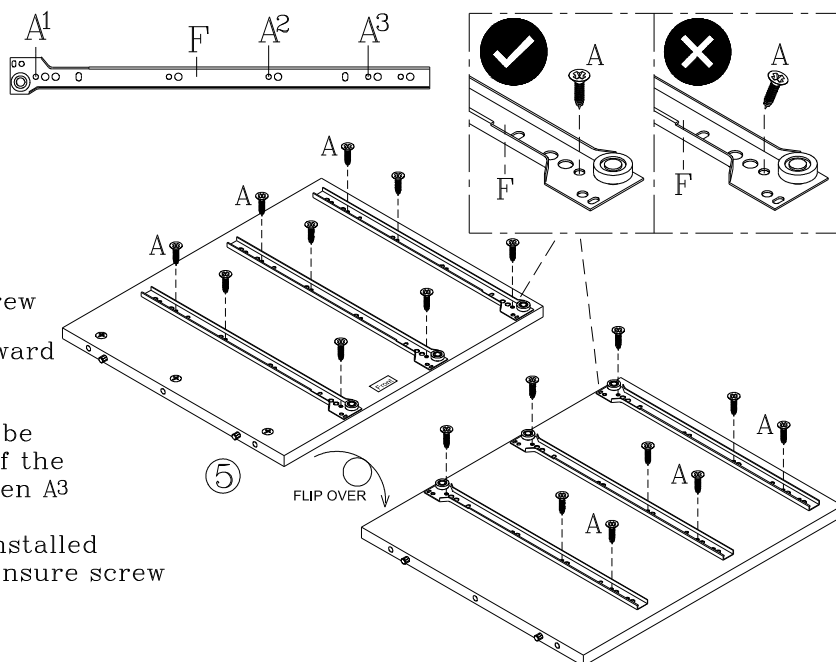
STEP 6

- A) Attach Wood Dowel(C) to 8 of Bottom Bar(8)
- B) Attach Cam Lock(D) to 8 of Bottom Bar(8)

NOTE : Make sure arrows on each Cam Lock points towards nearest edge with holes

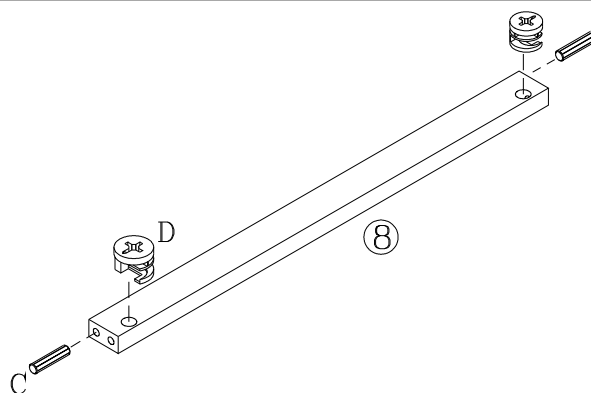
STEP 7

- A) Attach Wood Dowel(C) to both Side Leg (6)
- B) Insert and secure Cam Bolt(D) to Side Leg (6)

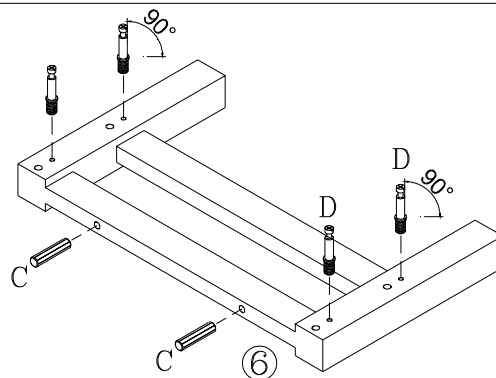
STEP 8

- A) Attach Wood Dowel(C) to Center Leg(7)
- B) Insert and secure Cam Bolt(D) to both side of Center Leg (7)

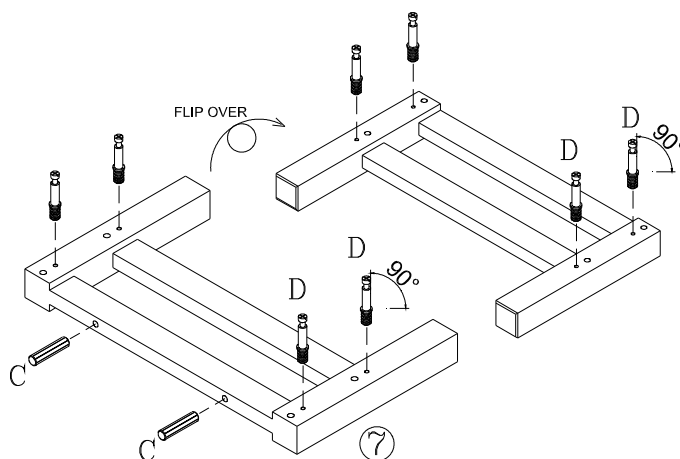

STEP 9

- A) Attach Bottom Bar(8) to both Side Leg (6) turn each Cam Lock clockwise until it securely engages each Cam Bolt(D).
- B) Cover Cam Lock with Cam Lock Cover(G)
- NOTE: Do not over tighten the Cam Lock

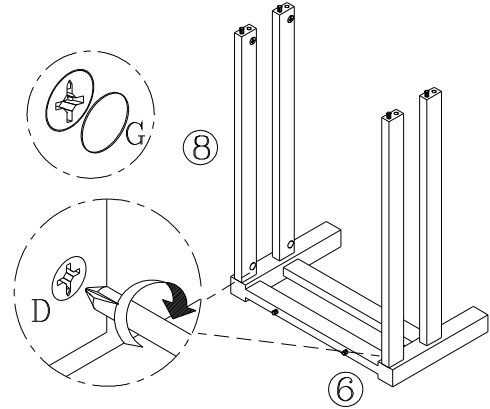
STEP 10

- A) Attach Bottom Bar(8) to Center Leg(7) turn each Cam Lock clockwise until it securely engages each Cam Bolt(D).
- B) Cover Cam Lock with Cam Lock Cover(G)
- NOTE: Do not over tighten the Cam Lock

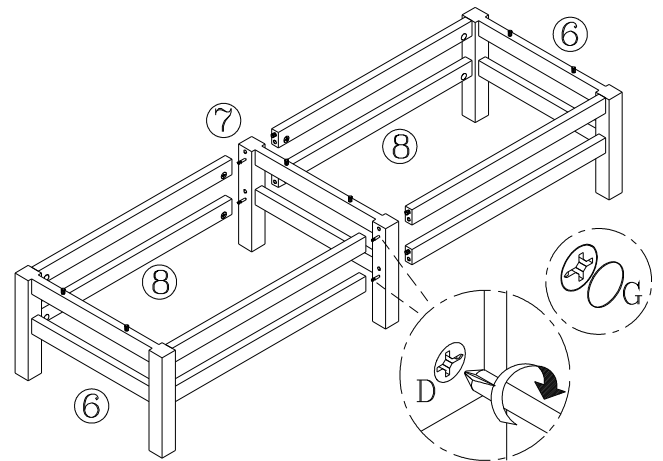
STEP 11

- A) Attach Side Panel Left&Right(2&3) & Partition(5) to Bottom Frame(4) and secure with Chipboard Screw(I)
- NOTE: Do not over tighten the Screw

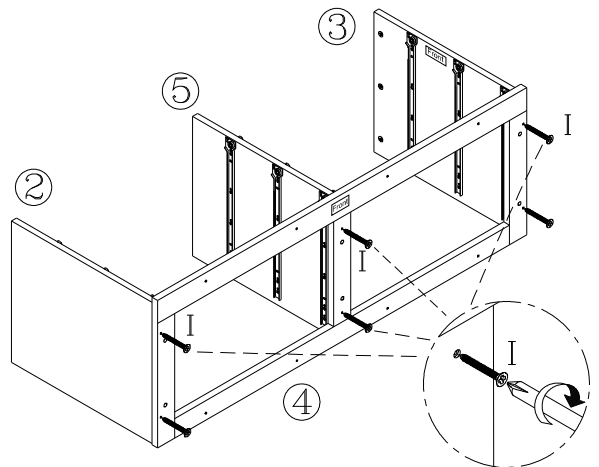

STEP 12

- A) Attach Bottom Frame(4) to Leg Frame secure with Chipboard Screw(I)

NOTE : Do not over tighten the screw

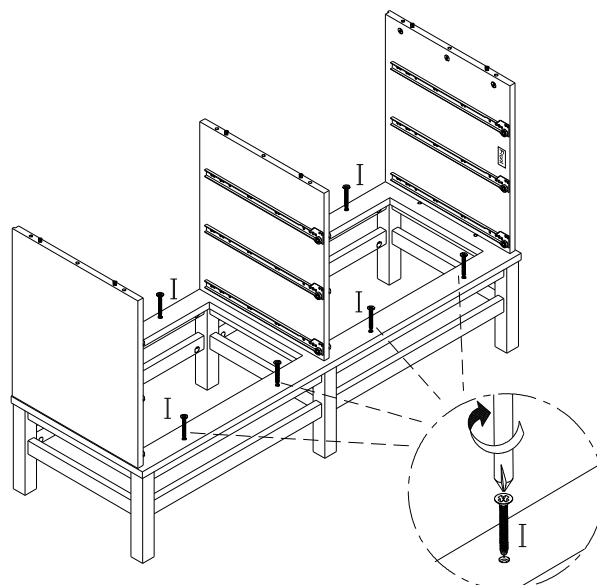
STEP 13

- A) Attach Top Panel(1) to assembled unit secure with Cam Lock(D).
- B) Cover Cam Lock with Cam Lock Cover(G)

NOTE : Do not over tighten the Cam Lock

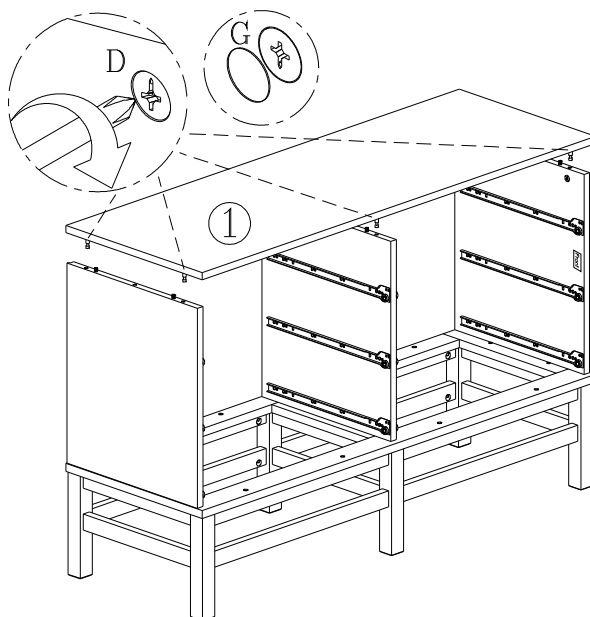
STEP 14

- A) Attach Back Plywood(9) to assembled unit using Panhead Chipboard Screw(Black)(H) to secure

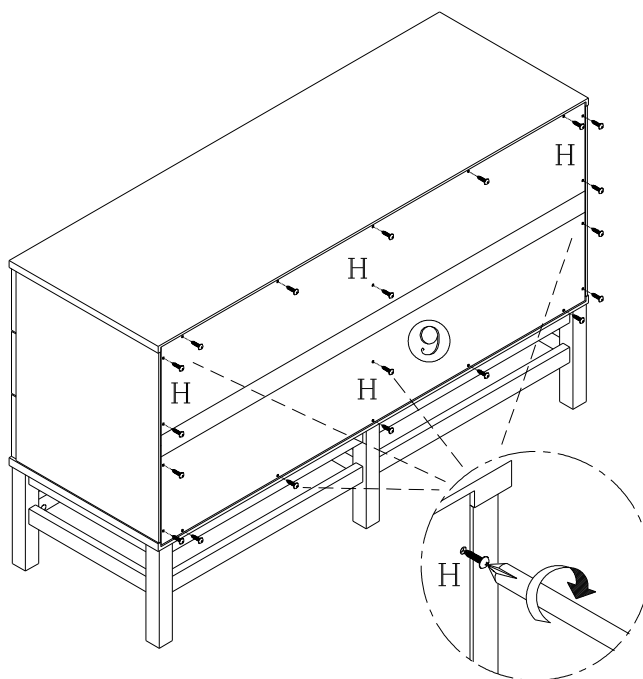

STEP 15

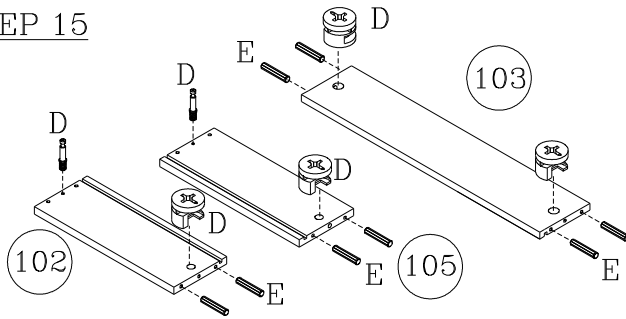

- Insert Wood Dowel(E) to Left&Right Drawer Side(102&105) & Drawer Back(103)
- Attach Cam Lock(D) to Left&Right Drawer Side(102&105) & Drawer Back(103)
- Insert secure Cam Bolt(D) to Left&Right Drawer Side(102&105)

STEP 16

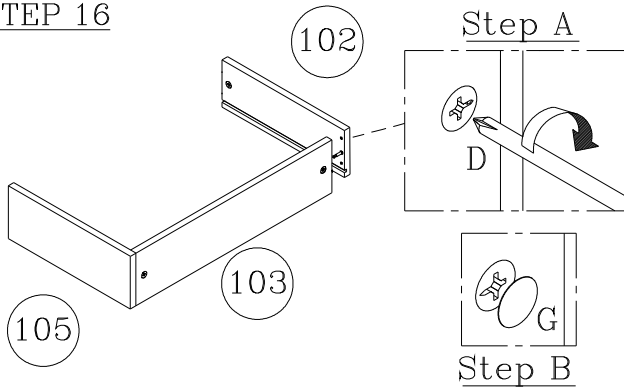

- Attach Left&Right Drawer Side(102&105) to Drawer Back(103) secure with Cam Lock(D)
- Using Cam Lock Cover(G) to cover Cam Lock(D)

STEP 17

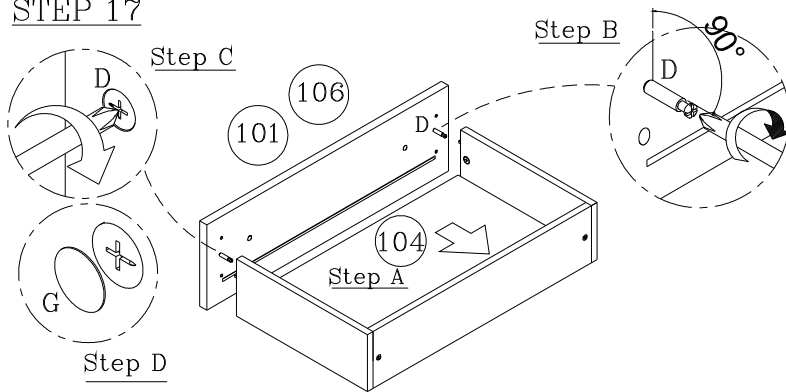

- Slot in Drawer Base(104) in corresponding grooves
- Insert and secure Cam Bolt(D) to Drawer Front(101&106)
- Attach Drawer Front(101&106) to Drawer Box & secure with Cam Lock(D)
- Using Cam Lock Cover(G) to Cover Cam Lock(D)

STEP 18

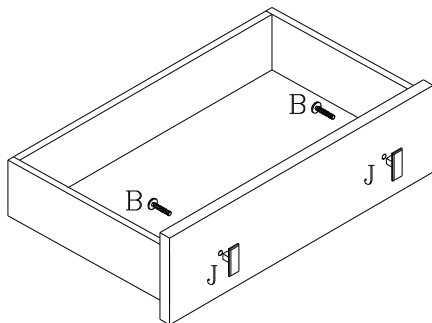

- Attach Handle(J) to Drawer Front(101&106) secure using Panhead Screw(B)

STEP 19

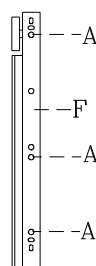
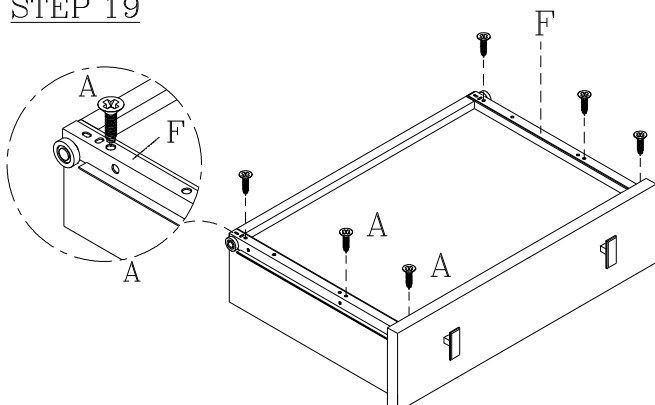

- Turn over the Drawer box, Attach Runner(F) to Drawer Side(102&105) using Chipboard Screw(A) to secure

NOTE: Runner roller should be flush and toward the back of the Drawer Box