

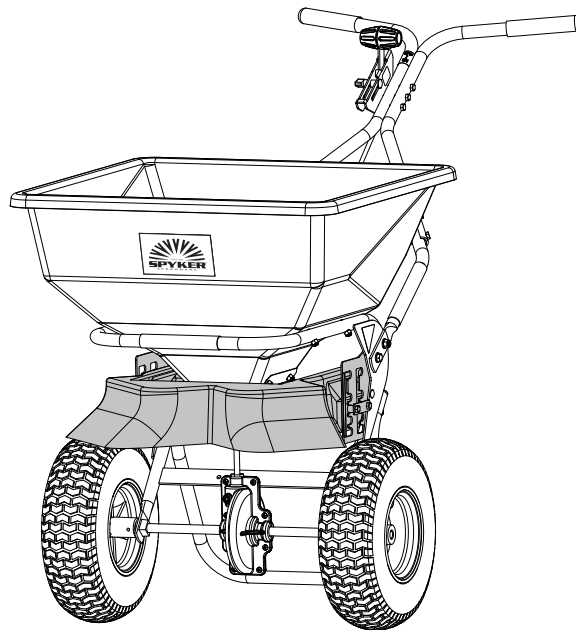

OPERATOR'S MANUAL

SPYVD-80100 Deflector Kit



*For use
with the Spyker
SPY100-1S
Push Spreader*

Spyker Spreaders

Contact us at 800.972.6130
www.spyker.com

▲ IMPORTANT

**This manual contains information for the safety of persons and property.
Read it carefully before assembly and operation of the equipment!**

Part List

DO NOT RETURN PRODUCT IF YOU ARE MISSING PARTS. PLEASE CALL: 1 (800) 972-6130

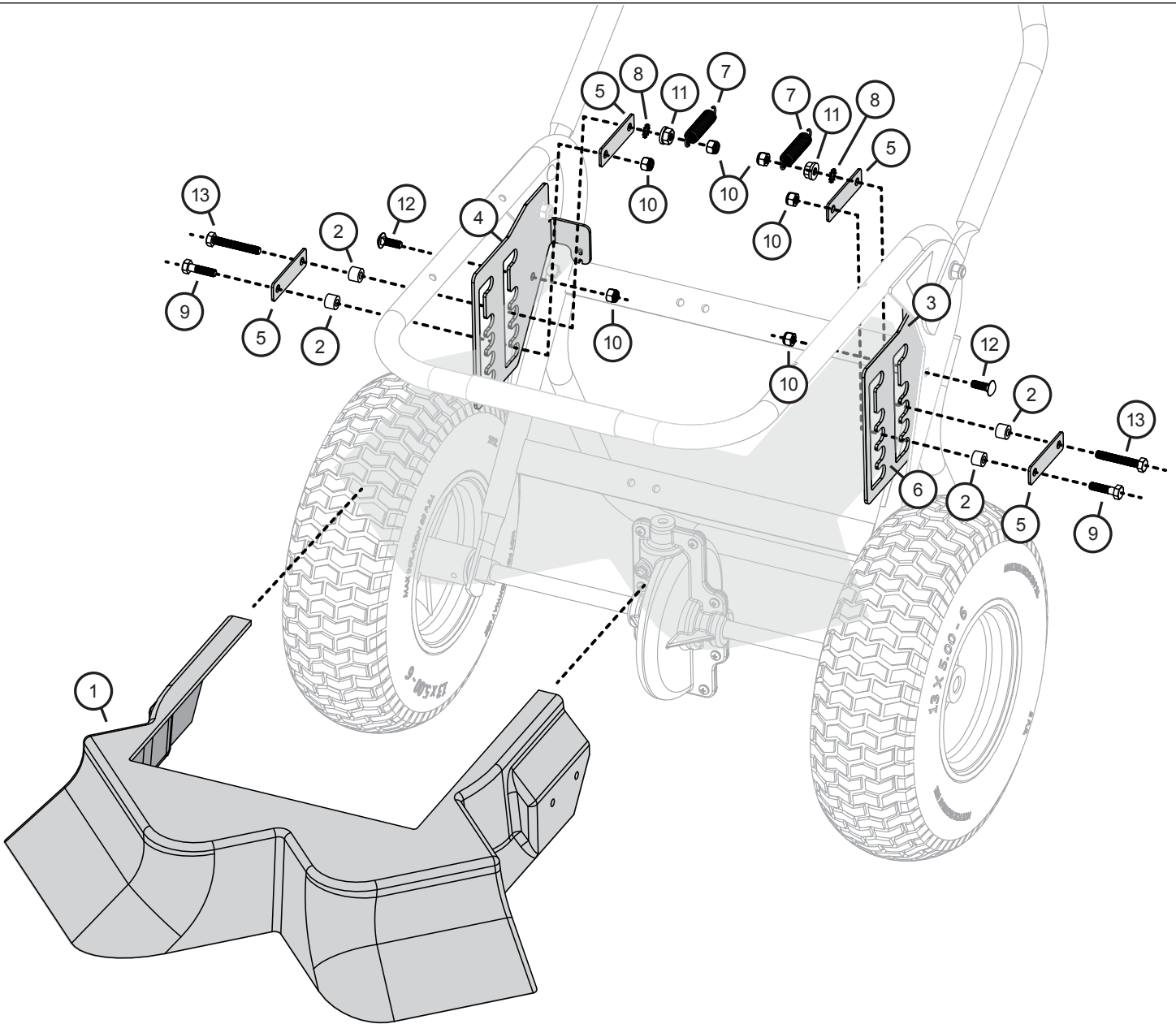

No.	Part #	Qty	Description
-----	--------	-----	-------------

1	1019367	1	Deflector
2	1018993	4	Spacer, Plastic
3	1018706LH	1	Mounting Bracket, LH
4	1018706RH	1	Mounting Bracket, RH
5	1018708	4	Stiffener Plate
7	1018738	2	Spring
8	1018740	2	External Tooth Lockwasher

No.	Part #	Qty	Description
-----	--------	-----	-------------

9	1001255	2	Bolt, HexHd, SS: 1/4"-20 x 1"
10	1005198	6	Nut, NylonLock, SS: 1/4"-20
11	1004975	2	Nut, 1/4-20 Hex Flange
12	1007386	2	Bolt, Carriage, SS: 1/4"-20 x 3/4"
13	1019001	2	Bolt, HexHd: 1/4"-20 x 1-3/4"
14*	1019187	1	Label, Material Striping

*Not Illustrated

Hardware Identifier

ILLUSTRATIONS ON THIS PAGE ARE TO SCALE FOR FASTER IDENTIFICATION OF HARDWARE DURING ASSEMBLY.

DO NOT RETURN PRODUCT IF YOU ARE MISSING PARTS. PLEASE CALL: 1 (800) 972-6130

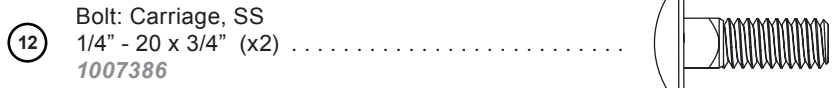
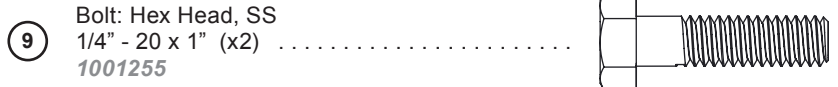
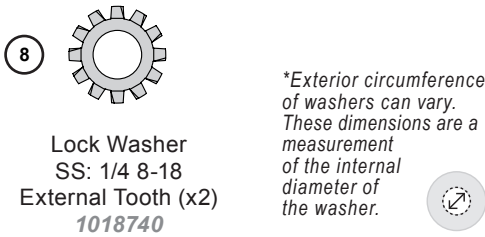
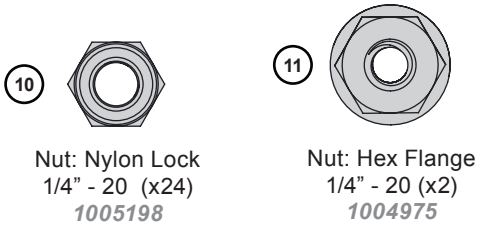

Tools Required for Assembly:
1/2" Wrench
7/16" Wrench



Assembly

- Using a 1/2" wrench, temporarily remove the hex bolt (A), two washers (B) & lock nut (C) at the base of the handle. Repeat on the other side of the spreader.

Keep this hardware for the following step.

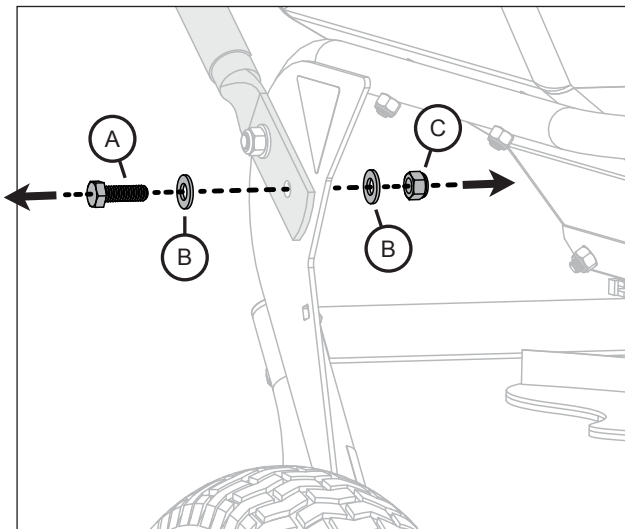

- Each of the mounting brackets (3 and 4) has a small arm that extends toward the center of the spreader.

Hook both of the springs (7) through the base of each bracket extension as illustrated.

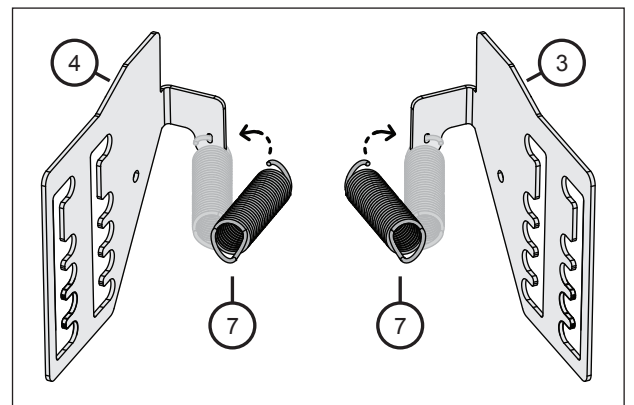
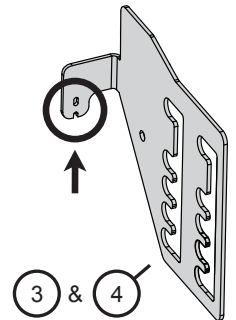

Assembly

3. On both sides of the spreader, align the mounting brackets (3 and 4) as illustrated.

Secure with the hex bolt (A), two washers (B) and lock nut (C) that were removed on Step 1.

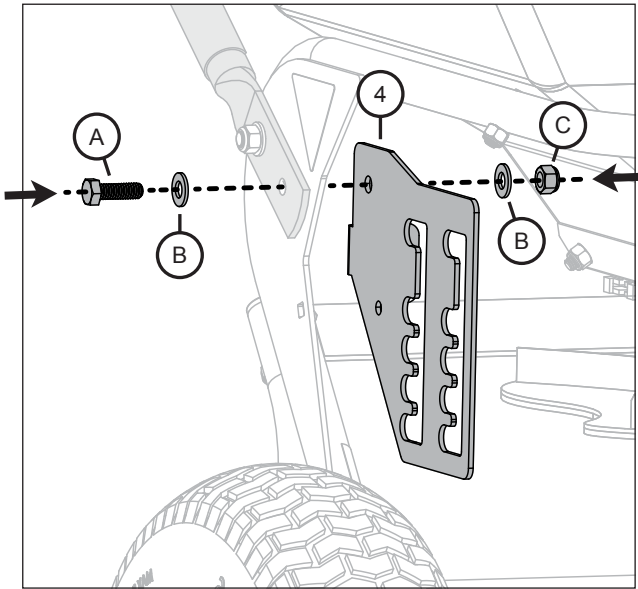

4. Secure the mounting brackets (3 and 4) as illustrated through the square hole just below the bolt that was added on step 3.

From the outside and facing in, run a carriage bolt (12), and lock nut (10).

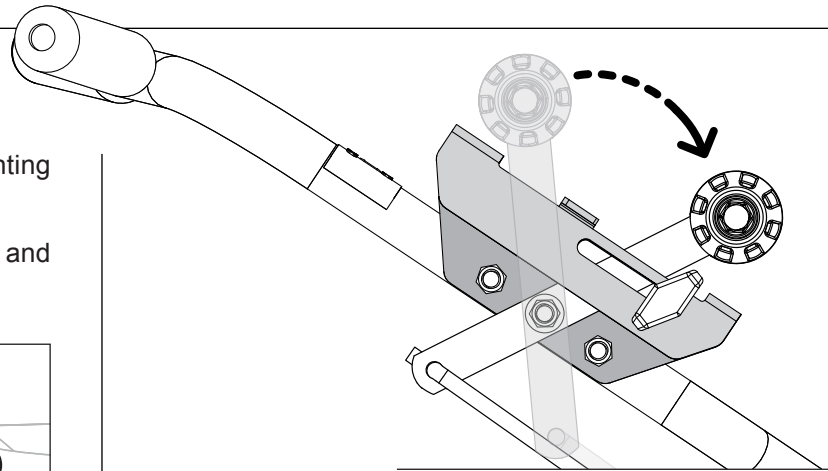
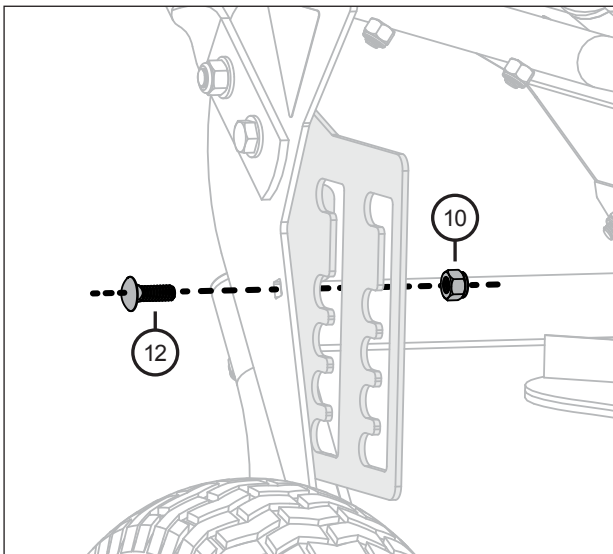

- 5a. Lock the Control Lever in the fully open position.
To do this: Position the lever all the way forward, closest to the hopper.

- 5b. Place material striping label (14) centered on the large back panel back of the hopper.

(Some parts not illustrated below for visibility)

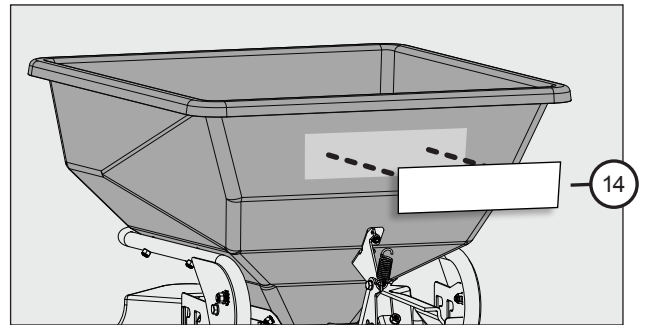

6. Gently flip the spreader over, balancing it on the rim of the hopper and the handles.

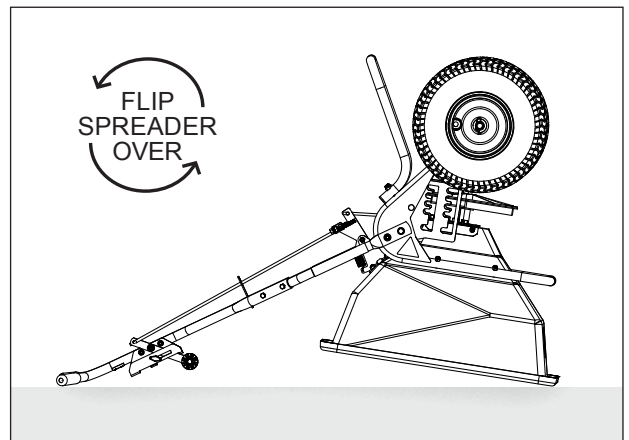

Assembly

7. Orient the deflector (1) with the open side pointing up, as illustrated.

Slide the deflector (1) between the two mounting brackets (3 and 4).

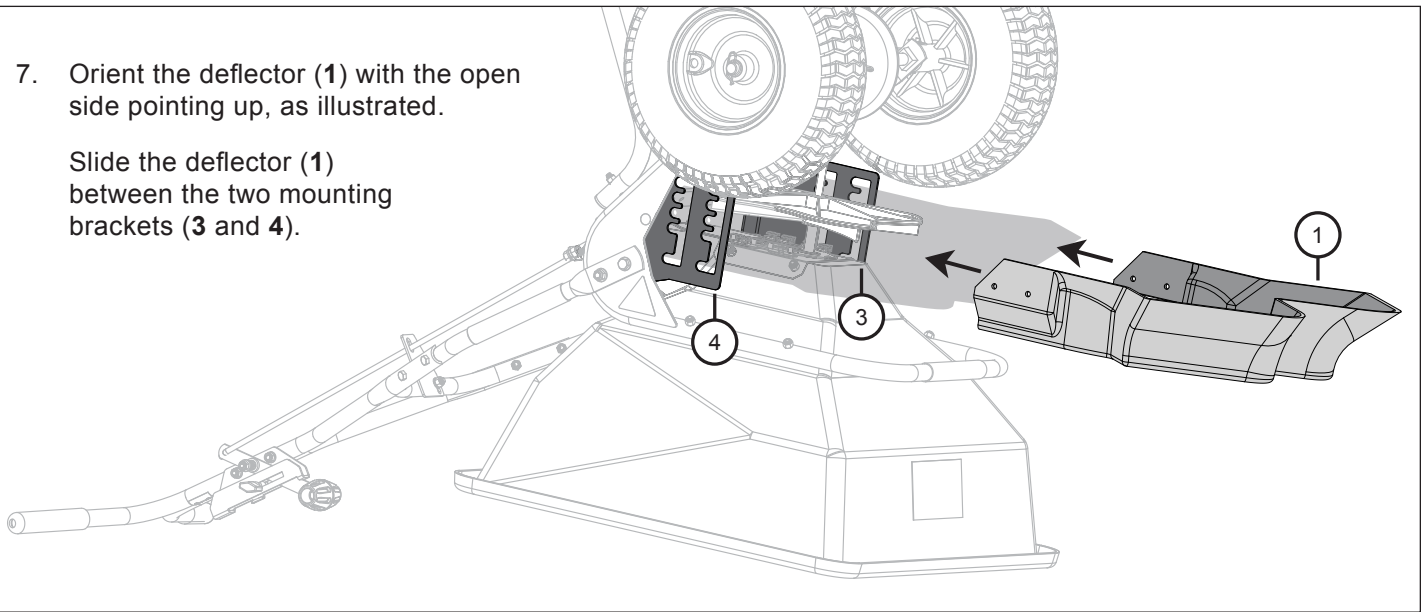

- 8a. Find the 1" long Hex Head Bolt (9) and add a stiffener plate (5) followed by a plastic spacer (2).

Run the bolt through the second row of slots of the mounting bracket and second hole of the deflector (1) as illustrated here.

Repeat on the other side of the deflector.

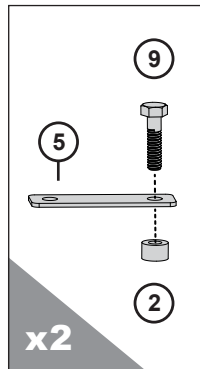

- 8b. On the inside edge of the deflector, find the end of the hex head bolts added on step 8a.

Add a stiffener plate (5) to this bolt. Add a 1/4" Nylon Lock Nut (10) to the end of the bolt, however:

Do not tighten this nut fully YET and repeat this step on the other side of the deflector.

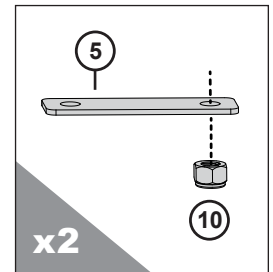

OUTSIDE EDGE OF THE DEFLECTOR

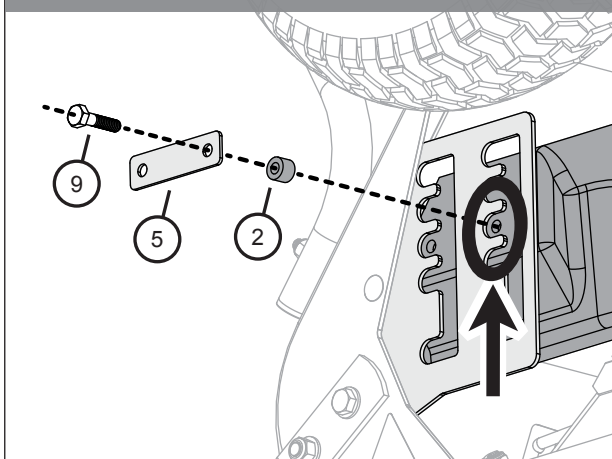

INSIDE EDGE OF THE DEFLECTOR

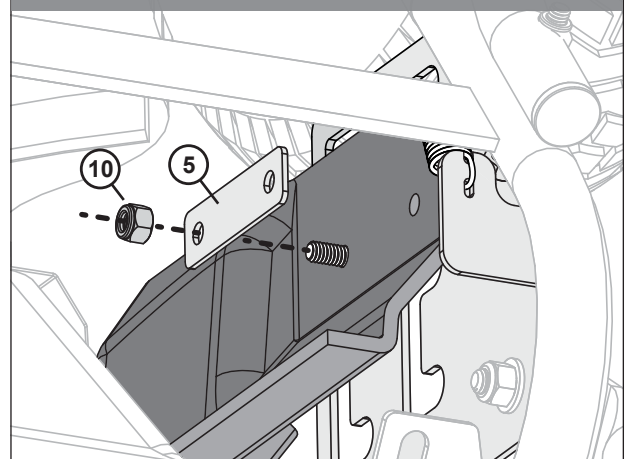

Assembly

- 8c. On the outside edge of the deflector, slide a second plastic spacer (2) in place between the stiffener plate (5) and deflector (1) as illustrated.

Run the 1-3/4" long Hex Head Bolt (13) through the stiffener plate (5), plastic spacer (2) and deflector (1). Repeat on the other side of the deflector.

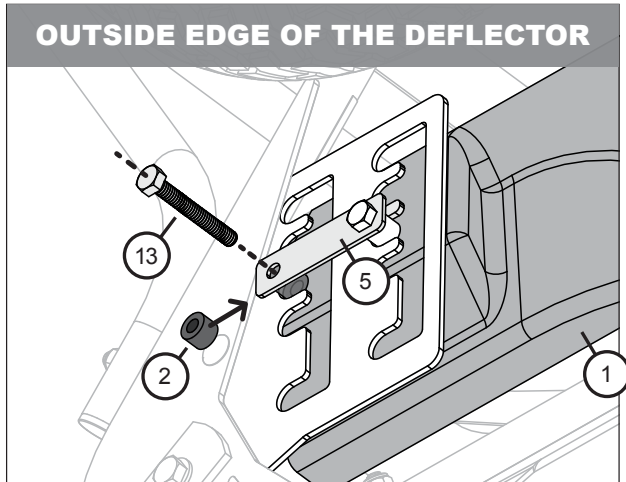

9. Pull the end of the spring (7) toward the bolt and hook it in place between the two nuts.

Add a 1/4" Nylon Lock Nut (10) to the end of the same, long bolt (13) from step 8c.

Repeat on the other side of the deflector.

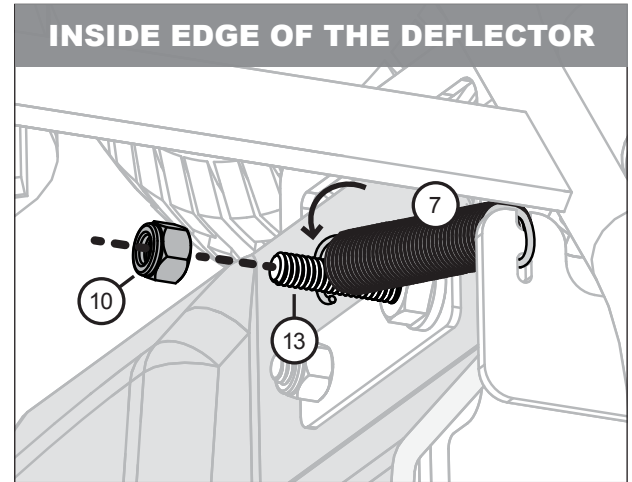

- 8d. On the inside edge of the deflector, find the end of the hex head bolts (13) added on step 8c.

Add an external tooth lockwasher (8) and a 1/4" Nylon Lock Nut (11). Rotate the lock nut down the length of this bolt, however, allow a little bit of movement.

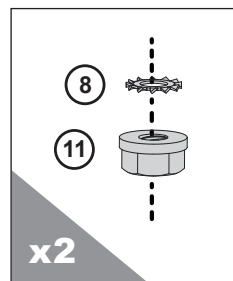

Repeat on the other side of the deflector.

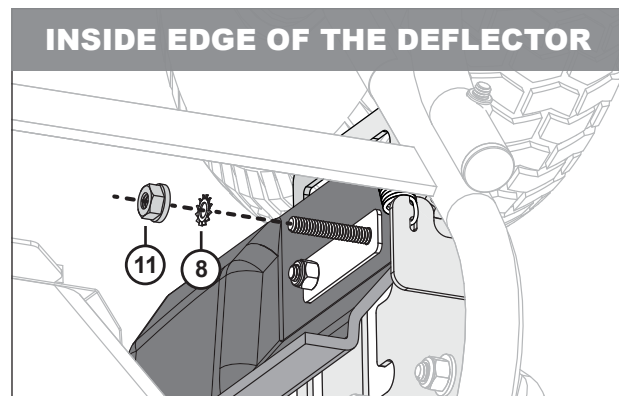

10. Tighten the nuts from step 8b.

11. Flip the spreader back to the upright position.

Assembly is complete!

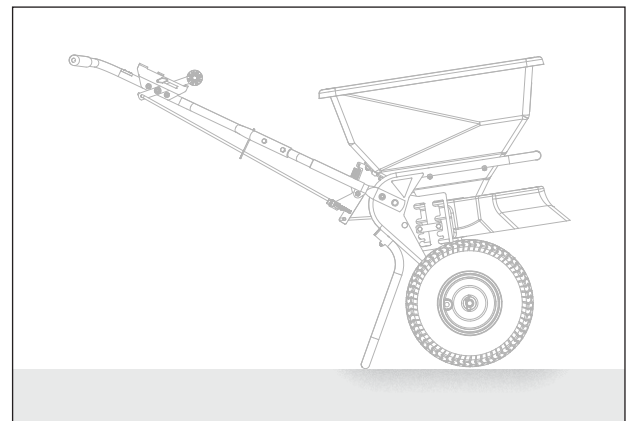

DEFLECTOR SETTINGS

WIDENING THE SPREAD AREA

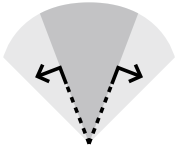

HIGHEST SETTING = 0% DEFLECTION

When the deflector is at the highest position, it enables a full spread pattern.

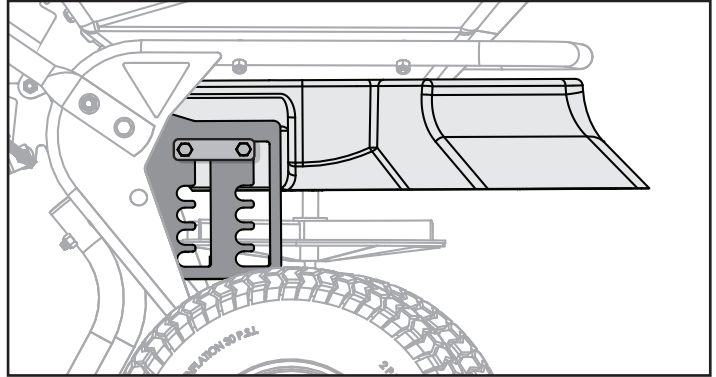

NARROWING THE SPREAD AREA

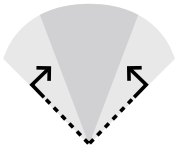

LOWEST SETTING = 100% DEFLECTION

When the deflector is at the lowest position, the spread width will be approximately 3 feet.

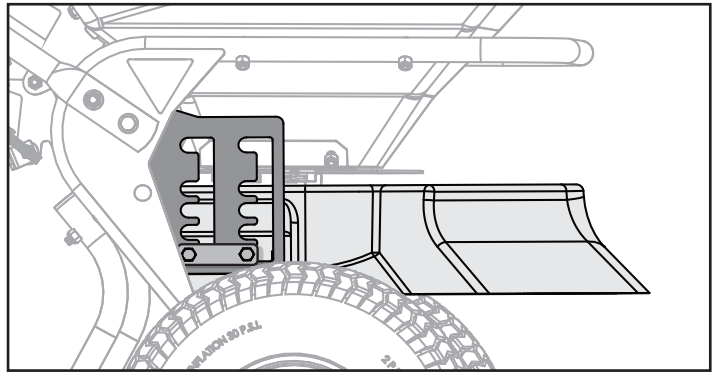

STRIPING ISSUES?

IF YOU FIND THAT THE MATERIAL IS STRIPING HEAVY ON THE LEFT SIDE OF THE SPREAD WHEN THE DEFLECTOR IS IN USE:
Reduce the gate opening until the distribution is uniform.

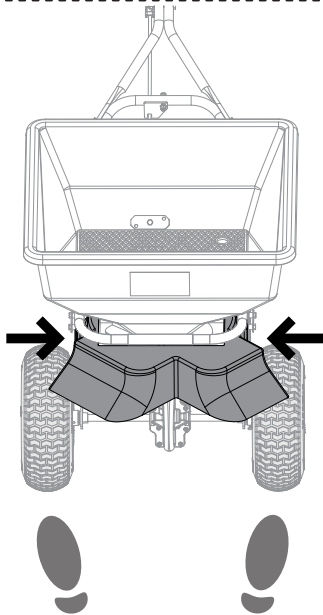

ADJUSTING THE DEFLECTOR

1. To move the deflector, stand in front of the spreader and plant your feet just before both wheels to prevent movement.
2. Grasp the deflector (as illustrated here) on both sides and pull toward yourself while raising or lowering to the desired setting.

NOTE:
Moving the deflector **UP** increases the spread width.

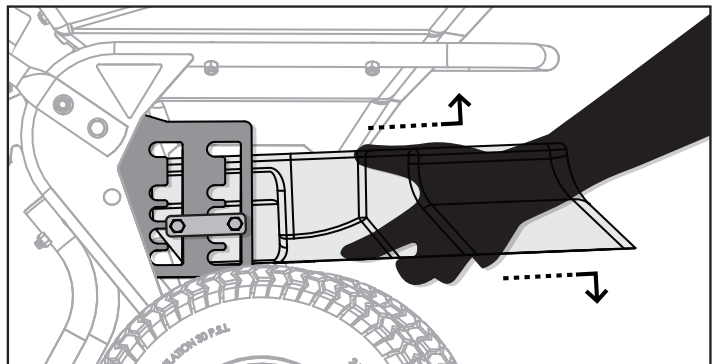

MAINTENANCE



Clean and oil spreader immediately after each use.

Method #1	Method #2
Wipe spreader thoroughly with an oily cloth. Oil all bearings and bearing areas.	Wash, rinse & dry the spreader. <i>Note: Drying takes time. Moisture trapped in bearing areas is slow to go.</i> Immediately after drying - oil all bearings and moving parts. Make certain all operations are thorough.

NOTE: Good "Dry Cleaning" (Method #1) is preferable to poor "Wet Cleaning" (Method #2).

- It is virtually impossible to have rust and corrosion on a clean, dry, oiled surface.
- Again - just before using - oil all bearings & moving parts.
- In storage, ideally the spreader should be hung by the handle. In any case, do not pile weight on the spreader, as excess weight over a period of time can distort the tires.

Oil Bearings and All Moving Parts

Make sure the spreader is running freely!

SERVICE

If you have installation questions, are missing parts or need replacement parts, don't go back to the store!

Please find your product serial number and model number, then contact our Customer Service department:



In North America and Canada
call Toll-Free: **800.972.6130**

