

Harper Pendant

700TDHARP_

1.2

VISUAL COMFORT & Co.

MODERN COLLECTION

GENERAL PRODUCT INFORMATION:



This product is suitable for damp locations.

This product can be dimmed with a standard incandescent dimmer.

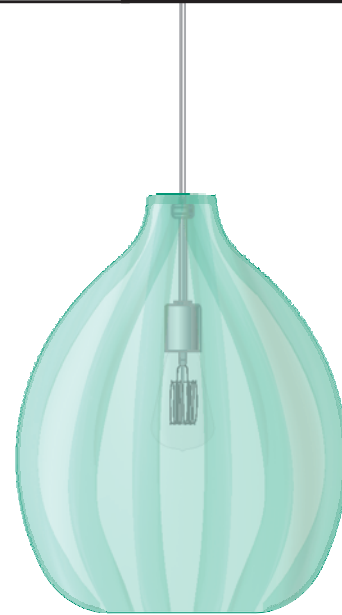

Assemble the Fixture

1A

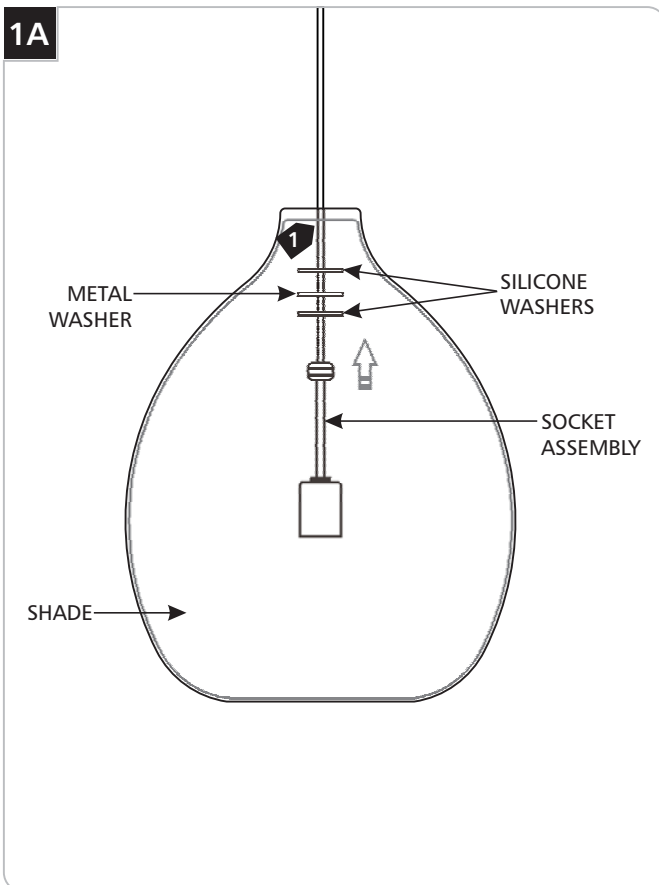

- 1 Install the silicone washer, metal washer, and silicone washer (in that order) on top of the socket assembly and feed the fixture cord completely through the shade.
- 2 Adjust the shade until it is level on the socket assembly.

1B

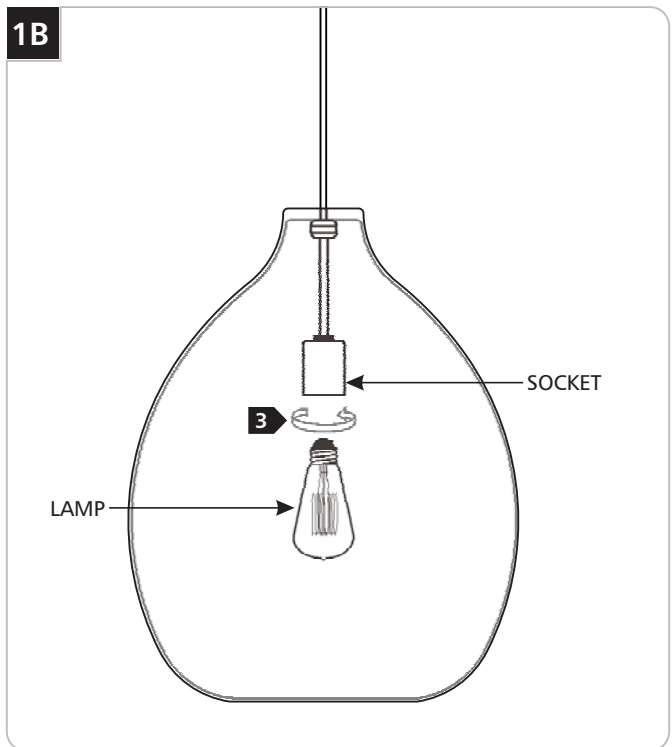

CAUTION: To reduce the risk of a burn or electric shock during re-lamping, disconnect the power to the fixture.

Use **MAX 60 Watt** S-21 Squirrel Cage type A19 medium base lamps or other style **60 Watt** type A19 medium base lamps.

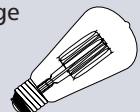

- 3 Screw the lamp into the socket.

SAVE THESE INSTRUCTIONS!