

ASSEMBLY INSTRUCTIONS



OZARK TRAIL®
OUTDOOR EQUIPMENT

MODEL NO W967 - 14P Cabin Tent with Convertible Screen Room

SAFETY WARNING - DOs AND DO NOTs

EVERYONE WHO USES THIS TENT SHOULD READ THIS MANUAL AND BECOME FAMILIAR WITH ALL SAFETY WARNINGS AND PRECAUTIONS FOR SAFE USE, ASSEMBLY, CARE, MAINTENANCE, AND STORAGE. KEEP THIS MANUAL SO YOU CAN REFER TO IT LATER.

⚠ DANGER CARBON MONOXIDE GAS WILL KILL YOU

Stoves, heaters, grills, lantern, candles, and other fuel-burning devices that burn propane, natural gas, charcoal, kerosene, coal, or other fuels produce a toxic gas called carbon monoxide. Because carbon monoxide gas is invisible, odorless, and colorless, a dangerous level of carbon monoxide gas can accumulate in a tent which cannot be detected by sight, smell, or taste. For these reasons:

- DO NOT use matches, lighters, stoves, heaters, grills, lanterns, candles, cooking equipment, or other fuel-burning devices inside or near a tent.
- DO NOT build fires inside or near a tent.
- DO NOT leave campfires unattended.

Your failure to follow this warning will cause death, serious injury, or permanent disability to you or others.

⚠ DANGER PROTECT YOUR CHILDREN

- DO NOT leave children unattended inside a tent or in camp.
- DO NOT allow children to assemble a tent.
- DO NOT allow children to enter or exit a tent except through the door.
- DO NOT allow children to remain in a closed-up tent on hot days.

Your failure to follow this warning will cause death, serious injury, or permanent disability to your children.

⚠ WARNING FLAMMABILITY WARNING KEEP ALL FLAME AND HEAT SOURCES AWAY FROM THIS TENT FABRIC

This tent is made with flame resistant fabric which meets CPAI-84 specification. IT IS NOT FIREPROOF. The fabric will burn if left in continuous contact with any flame source. The application of any foreign substance to the tent fabric may render the flame-resistant properties ineffective. Your failure to follow this warning could cause death, serious injury, or permanent disability to you or others.

CAMPING DO'S AND DON'TS **DO NOT...**

1. Do not pitch tent near open fire.
2. Do not leave campfire unattended.
3. Do not leave children unattended inside a tent.
4. Do not use heating, lighting or cooking equipment with open flames in or near tents.
5. Do not use other than recommended water repellent compounds on your tent.
6. Do not spray the tent with insecticide.
7. Do not store tent on concrete floor.

DO...

1. Always extinguish campfire before leaving area.
2. Exercise care when using electricity and lighting in and near tents.
3. Make certain your tent is properly ventilated in all weather conditions. In extreme weather conditions, snow could obstruct airflow and cause asphyxiation unless cleared frequently.
4. Anchor your tent securely to provide additional security from changing climatic conditions. Snow pegs, skis and/or heavy rocks may be necessary to supplement tent stakes and guy cords.
5. Take your tent down and store properly after camping.

CARE

DO NOT LEAVE YOUR TENT SET UP IN DIRECT SUNLIGHT LONGER THAN NECESSARY. THE SUN'S ULTRAVIOLET (UV) LIGHT DEGRADES ALMOST EVERY FABRIC AND MATERIAL. IF LEFT IN SUNLIGHT FOR PROLONGED PERIODS OF TIME, FABRIC WILL FADE AND WEAKEN. DO NOT STORE TENT ON CONCRETE FLOOR. DO NOT SPRAY THE TENT WITH INSECTICIDE.

Your tent is water repellent, however, it is not waterproof. During heavy rain, some leakage may occur. Keep objects from touching the inside of the tent. Such objects may cause leakage at point of contact. If seam leakage occurs, it can be controlled by applying a seam sealer compound.

EXERCISE CARE WHEN USING ELECTRIC DEVICES IN AND NEAR TENTS.

Although our tents and screen houses are constructed to rigid specifications, periods of wind or rain soaking the ground may loosen the stakes and cause the uprights to sink into the ground. This will weaken the rigidity of the overall structure. Water pockets may also form in the roof if the unit is not assembled taut, possibly causing broken frames and torn fabric.

REPLACEMENT PARTS

If you have questions or need to order a part, call 1-800-325-4121 or send an e-mail to contactus@wenzelco.com. Have your model number or part number ready when you call. DO NOT ORDER BY REFERENCE KEY NUMBER.

Send your request for parts to:
Exxel Outdoors, LLC.
6235 Lookout Road
Boulder, CO 80301

KEY NO.	W967 - 14P Cabin Tent with Convertible Screen Room		QTY REQ
	DESCRIPTION	PART NO.	
A	Main Roof Pole	W967M	2
B	Roof Ridge Pole	W967R	1
C	Main Upright Pole	W967MU	4
D	Center Upright Pole	W967CU	2
	Complete Frame	W967ST	1
E	Corner Joint	W967CJ	6
	Guy Rope	A1001	12
	Steel Stake	PIN STAKE	20

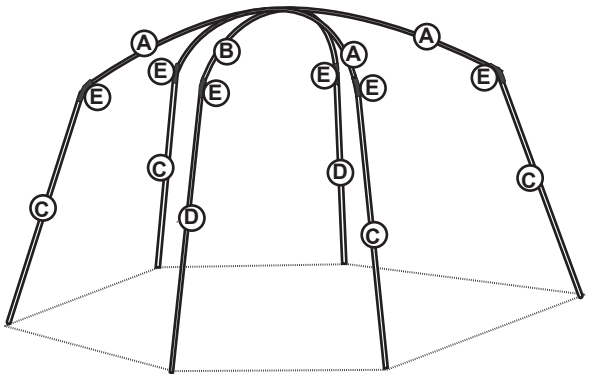

ASSEMBLY INSTRUCTIONS



MODEL NO W967 - 14P Cabin Tent with Convertible Screen Room

IMPORTANT: WE ADVISE YOU TO ASSEMBLE THE TENT ONCE BEFORE GOING CAMPING TO BECOME FAMILIAR WITH THE ASSEMBLY OF THE TENT.

NOTE: PLEASE LOOK AT THE REPLACEMENT PARTS DIAGRAM TO SEE HOW YOUR FRAME IS ASSEMBLED.

TO PROLONG THE LIFE OF THE TENT FLOOR, SELECT A LEVEL, CLEAN AREA FOR THE CAMPSITE. TO PREVENT DAMAGE TO THE ZIPPER, UNZIP THE DOORS TO ALLOW AIR TO ENTER THE TENT.

TO IMPROVE THE WEATHER RESISTANCE OF YOUR TENT, IT IS ADVISABLE TO USE SEAM SEALER TO COAT ALL EXPOSED SEAMS. YOU SHOULD APPLY ONLY TO THE INSIDE SEAMS OF THE TENT AND UNDERSIDE OF THE TENT FLY. IF APPLIED TO THE OUTSIDE OF SEAMS, DISCOLORATION OF YOUR TENT MAY OCCUR. SEAM SEALER IS AVAILABLE IN THE CAMPING SECTION OF ANY LOCAL SPORTING GOODS STORE.

STEP 1: Spread tent out flat, floor side down. Unzip the doors.

STEP 2: Stake tent to the ground by inserting metal stakes through the rings located at each tent corner. Hammer the stakes into the ground at a 45°, making sure to pull tent floor out even and tight. Continue to stake down all intermediate stake loops.

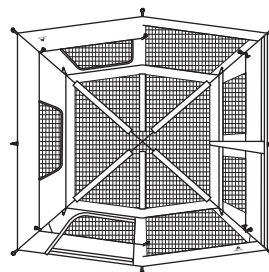

STEP 3: Locate the three fiberglass tent poles. Extend each fiberglass pole by pulling out each section and placing the ends of the pole sections into the metal connecting ferrules. The two longer poles (A) are the main roof poles, which run corner to corner across your tent roof. The third pole (B) is the center ridge pole which is marked with white tape.

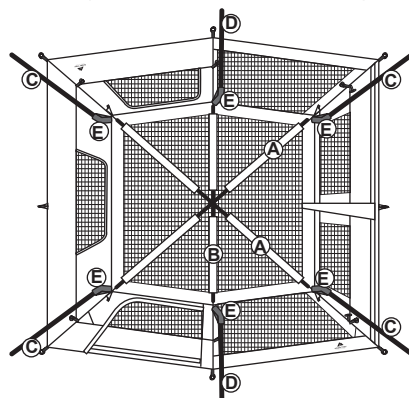

STEP 4: While making sure the sleeves are in line with each other, slide each main roof pole (A) through the blue sleeves that are opposite each other on the roof of the tent. Next insert the center roof ridge pole (B) through the grey sleeves. Be sure that all the poles go through the loop at the center top of the tent.

STEP 5: Locate the plastic corner joints (E) that are attached to the tent canopy and attach them to the ends of the fiberglass poles. The smaller opening of the corner joints with "teeth" fit over the roof poles.

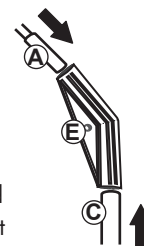

STEP 6: Extend each of the six steel poles, by pulling out each wire-corded section and placing the jointed ends into the connected pole sections. The 4 poles with no D-rings are the corner upright poles (C). The 2 poles (D) with the D-Rings near one end are the center upright poles.

STEP 7: With an adult on each corner at one end of the tent, insert the ends of the steel corner upright poles (C) into the bottom openings of the plastic corner joints (E).

STEP 8: Each adult should lift up on the steel pole and while raising one side of the tent, place the bottom end of the steel poles onto the pins attached to the rings at the base of the tent.

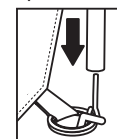

STEP 9: Using the two center upright poles (D) with the D-rings near the top repeat steps 7 and 8 at the center of the tent.

STEP 10: Using the two remaining corner upright poles (C) repeat steps 7 and 8 at the remaining 2 corners of the tent.

Tent should appear as shown.

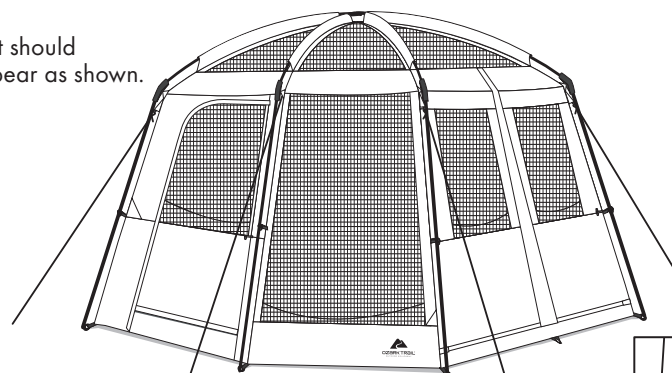

STEP 11: Clip the plastic hooks on the tent walls around the steel poles.



STEP 12: Unfold the fly and place it over the tent, making certain that triangular panels on the fly are placed at the corners of the tent. Attach the hooks at the four corners of the fly to the metal rings at the base of the tent. Attach the hooks at the edge of the fly to the D-Rings on the center upright poles.

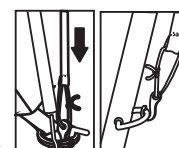

WARNING: Elastic cords can snap back and hit your eye. To reduce the risk of injury to you and others:

- Keep your body and face clear.
- Do not over stretch elastic cords.
- Maintain firm grip on hook.
- Pull the hook toward you; if it slips it will spring away from you.
- Make sure hook is fully clipped to tent before releasing.
- Wear protective eye wear during tent assembly.

Your failure to follow this warning could cause serious injury or permanent disability.

STEP 13: Secure the tent to the fly by wrapping the Velcro fasteners at the edge of the fly around the metal tent poles as well as securing the ties on the underside of the fly to the corner joints.



STEP 14: Guy ropes have been provided for the tent. Extend each of the guy ropes and make a loop at the opposite end by using the slider (as shown). Place the loop over tent stake and stake to the ground. Adjust the slider to make guy rope tight.

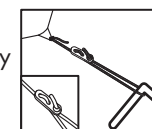

Tent should appear as shown.

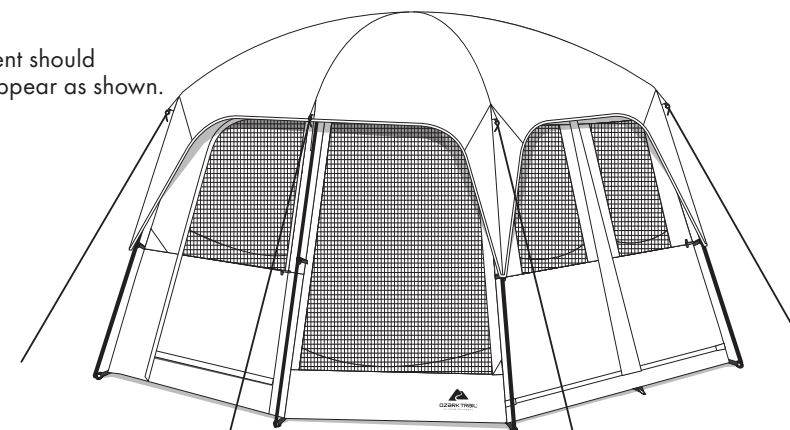

NOTE: To take down tent, follow steps above in the reverse order. Be sure to leave door and windows unzipped. Place stakes into stake bag and pole into the pole bag, which are provided. **Make sure tent is clean and dry before storing.** The tent should be folded into equal parts toward the center of the tent to distribute the bulk. Start a small tight roll, the width of the carry bag, with the pole bag placed at the end opposite the door. Roll tent toward door to allow air to escape. Once rolled, tie a string or rope around tent to hold into place. Place tent, frame and stakes into carry bag.