

HEKMAN

A HOWARD MILLER COMPANY

ASSEMBLY INSTRUCTIONS

25820 - RECTANGLE DINING TABLE

NO.	Hardware List		Q'ty
A		Nut m8	8
B		Spring Washer M8	8
C		Flat Washer M8	8
D		Wretch 12mm	1

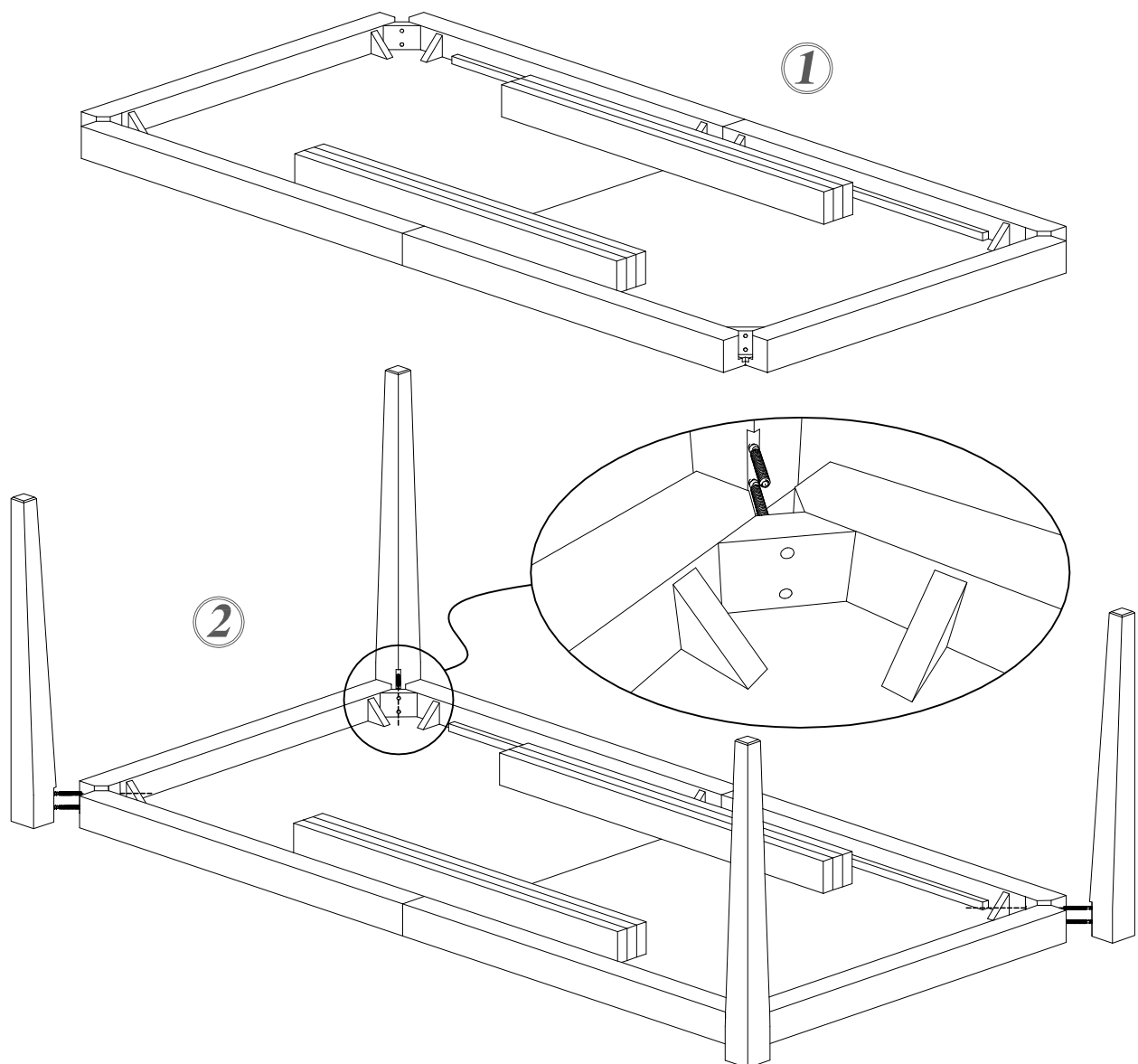

1. PLACE THE TOP ASSEMBLY UPSIDE DOWN ON SOFT AND CLEAN SURFACE TO PREVENT SCRATCHING
2. ATTACH THE FOUR LEGS (#1) TO THE TABLE TOP USING NUT (A), SPRING WASHER (B), AND FLAT WASHER (C), TIGHTEN WITH WRENCH (D).

MADE IN INDONESIA

HEKMAN

A HOWARD MILLER COMPANY

ASSEMBLY INSTRUCTIONS

25820 - RECTANGLE DINING TABLE

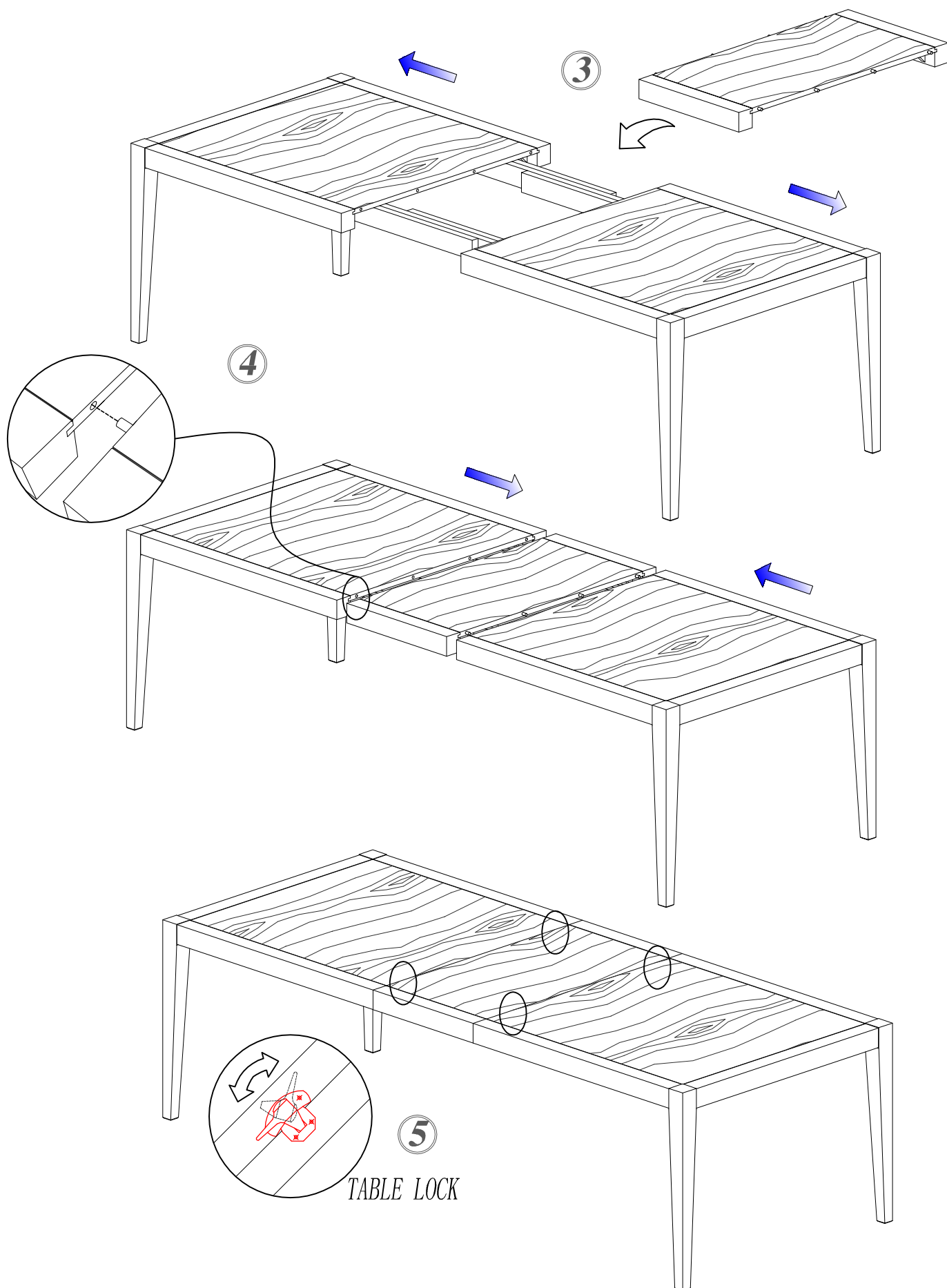

MADE IN INDONESIA