

Installation Guide

Deck- or Bath-Mount Handshower Holder with Hoses

K-368

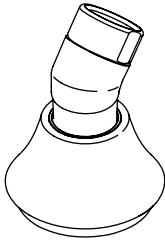

K-424

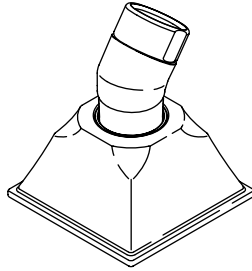

K-977

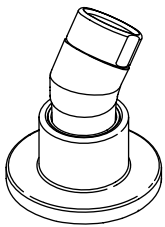

K-10573

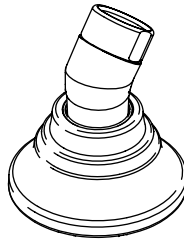

M product numbers are for Mexico (i.e. K-12345**M**)
Los números de productos seguidos de
M corresponden a México (Ej.
K-12345**M**)
Français, page "Français-1"
Español, página "Español-1"

1041355-2-C

THE BOLD LOOK
OF **KOHLER**®

Thank You For Choosing Kohler Company

We appreciate your commitment to Kohler quality. Please take a few minutes to review this manual before you start installation. If you encounter any installation or performance problems, please don't hesitate to contact us. Our phone numbers and website are listed on the back cover. Thanks again for choosing Kohler Company.

Tools and Materials



Adjustable Wrench



Tape Measure



Drill



1-1/4" Drill Bit

Before You Begin

- Please read all instructions before you begin.
- Observe all local plumbing and building codes.
- Shut off the main water supply.
- Provide an access panel for all installations.
- Carefully inspect waste and supply tubing for any sign of damage. Replace if needed.

NOTE: Plumbing codes may require a vacuum breaker be installed in-line to handshowers. Please consult with local plumbing codes. If a vacuum breaker is required, ensure that it is not installed between the handshower high pressure and interlock hoses.

- Kohler Co. reserves the right to make revisions in the design of products without notice, as specified in the Price Book.

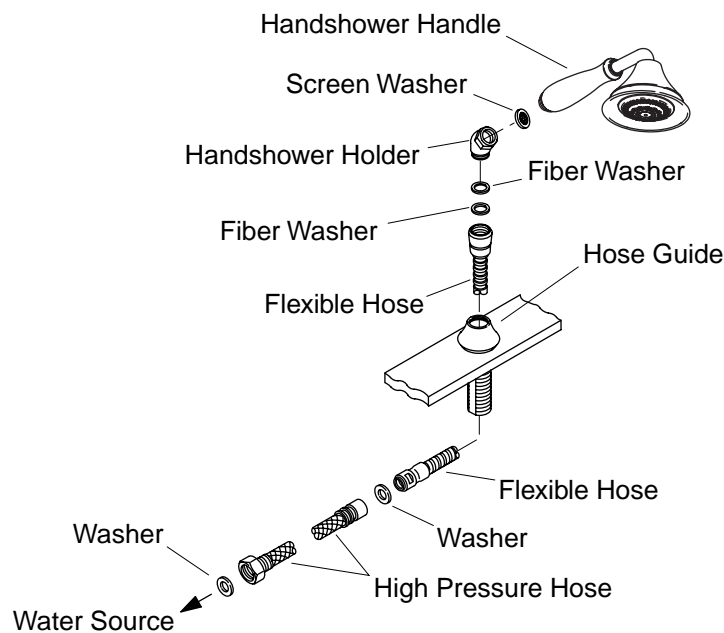

1. Install the Handshower

- From the top of the bath or finished deck, insert the smaller end of the flexible hose down through the hose guide.
- From the underside of the bath or finished deck, insert one washer into the flexible hose.
- Thread the flexible hose into the high pressure hose.
- Insert one washer into the other end of the high pressure hose.
- Connect the high pressure hose onto a vacuum breaker (if installed), or to the appropriate water source.
- Run cold and hot water through the hoses to flush out dirt and debris.
- Check for leaks.
- Turn the cold and hot water valves off.
- Insert the two fiber washers into the end of the flexible hose.
- Thread the handshower holder onto the flexible hose.
- Insert the screen washer into the end of the handshower holder.

Install the Handshower (cont.)

- Thread the handshower handle into the handshower holder.
- To avoid kinking, remove any twists or loops in the hose.

2. Installation Checkout

- Complete the installation of the valve, valve trim and any other components according to the instructions packed with the product.
- Ensure all connections are tight.
- Open the drain.
- Turn on the main water supply and check for leaks above and below the bath or finished deck. Repair as needed.
- Open both hot and cold valves and run water through the spout (if installed) to remove debris. Check for leaks.
- Check the handshower for smooth operation.
- Confirm proper diverter operation.
- Turn the valves to the closed position.