

EV-DW4917 Recessed Door/Window Contact - Installation Manual

Introduction

The EV-DW4917 is the industries most flexible supervised recessed door/window contact allowing a multitude of applications while hiding the transmitter within a door or window frame. The EV-DW4917 uses a replaceable lithium battery and should last 5 years under normal usage.

Accessing the EV-DW4917

Use a flat head screw driver to access the EV-DW4917 to change tops or access the battery. (See figure 1)

NOTICE: Before removing the circuit board, notice that it fits inside a channel on the inside of the case. When replacing the board, ensure you fit it back into the same channel for proper fit.

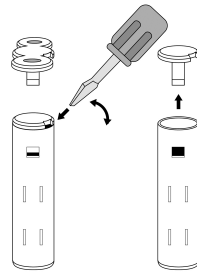
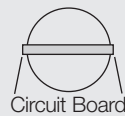

Figure 1

Install Battery

Use care when installing the battery and observe the correct polarity when the battery is inserted (see Figure 2). Use only Panasonic Lithium CR2 batteries for replacement. When replacing battery use a flat head screw driver to open the top (See accessing the EV-DW4917)

WARNING!: Battery may explode if mistreated. Do not recharge, disassemble or dispose of in fire.

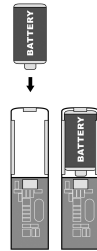

Figure 2

Mount Transmitter and Magnet

It is important to select the proper placement of the recessed transmitter and magnet. The transmitter has two separate tops that allow a flush mount or screw mount in case you accidentally over drill the hole or require extra support to ensure the transmitter does not move. The magnet does not have a second top with a flange to screw it into place so you must be extra careful to ensure that the magnet is tightly in place once installed.

Step 1) Install the CR2 battery if you have not already done so (See Install battery section of the manual)

Step 2) Write down the serial number printed on the outside of the EV-DW4917 case or on the board inside where you place the battery

Step 3) Select a location on the door or window frame for the EV-DW4917 transmitter and magnet to be installed. Use a marker or piece of clay to mark and ensure that the two holes you intend to drill are lined up directly across from each other.

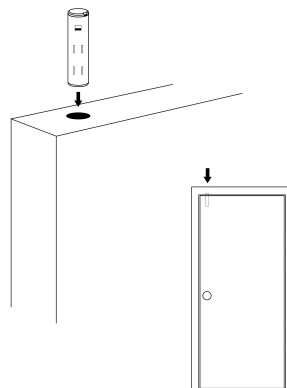

This is only one option when mounting the EV-DW4917, You must assess the best mounting method based on the application.

Step 4) Using an 11/16" drill bit, slowly drill the first hole for the magnet. The EV-DW4917 was specifically designed to be slightly larger than an 11/16" hole so you will need to carefully drill to fit by slowly routing the hole little by little to ensure a snug fit.*

Step 5) Drill the mating hole for the transmitter and use either the standard flush mount cap and insert the transmitter for a snug fit or use the flanged cap and use the included screws for mounting the transmitter to the door or window frame.

* If you accidentally drill the magnet side too big and it is loose, you can place the transmitter in that position and use the flanged cap to screw it into position.

Enrolling

Refer to your installation manual for enrolling wireless devices into a DSC control panel.

FCC COMPLIANCE STATEMENT

This device complies with Part 15 of the FCC Rules. Operation is subject to the following two conditions: (1) This device may not cause harmful interference, and (2) this device must accept any interference received, including interference that may cause undesired operation.

IC: The term 'IC:' before the radio certification number only signifies that Industry Canada technical specifications were met.



©2005 Secure Wireless

Technical Support: (866) 908-TECH (8324)