

I PORT CONNECT PHONE

CONNECT RUGGED Phone Case Install

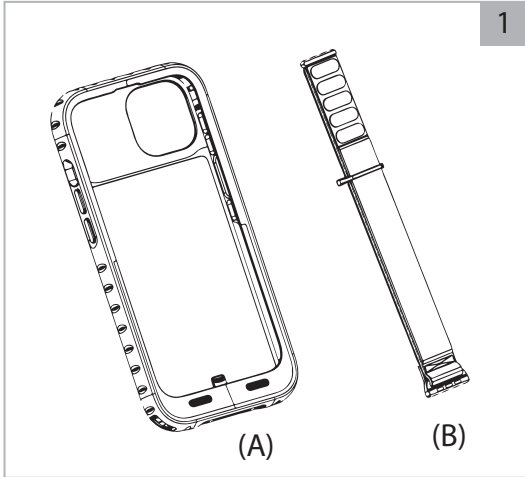

Remove the Phone Case (A) from packaging. (B) Rugged Phone Strap (72xxx) is able to be ordered for replacement from iportproducts.com

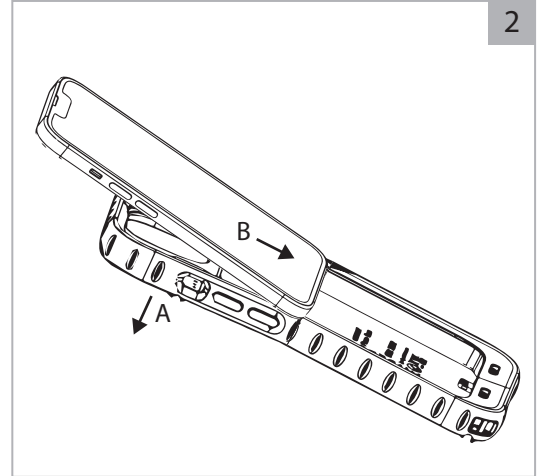

(A) Bend the Rugged Phone Case top down and (B) insert iPhone into the Phone Case inserting the bottom of the phone first then pressing down into the top of the Case.



Move the top of the Rugged Phone Case over the top of the iPhone ensuring the case fully covers the iPhone before using the case.

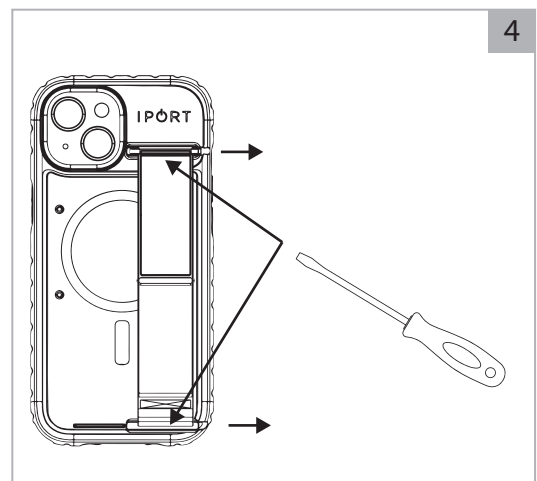

To replace or service the hand strap use a flat head screwdriver and press the small silver trigger under the strap loops, slide each loop towards the outside of the iPhone case.

I PORT CONNECT PHONE

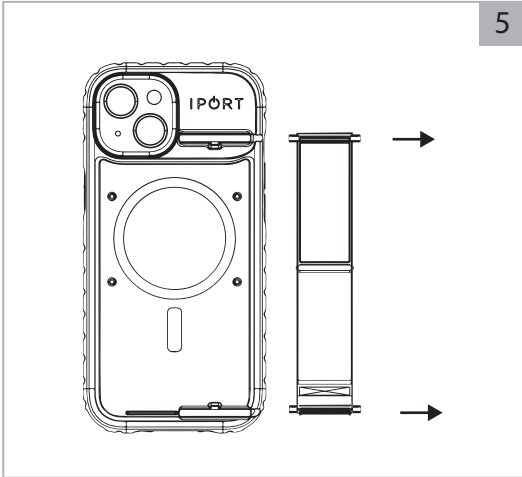

Remove the Strap and replace as needed. To reinstall slide the clips in reverse order as removal.

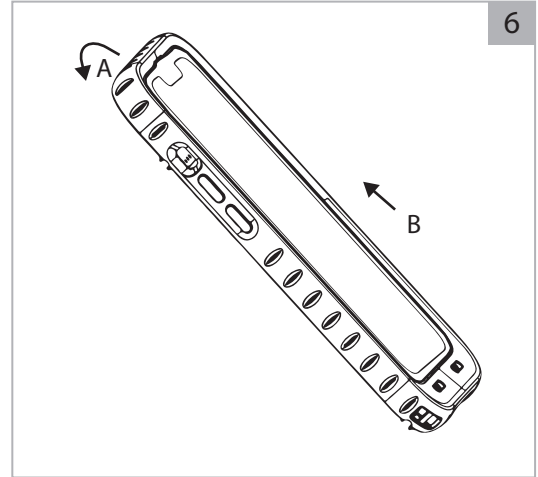

To remove the iPhone (A) first flip the top of the case over the top of the iPhone. (B) Next slide the iPhone towards the top of the **DO NOT** pull the iPhone towards you, slide it up away from the bottom of the case.

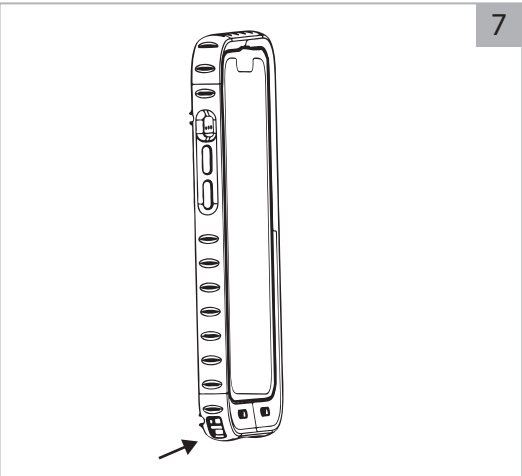

The CONNECT Rugged Phone case is equipped with two tether loops on the left and right of the bottom of the case to attach a 3rd party tether or strap to the iPhone.

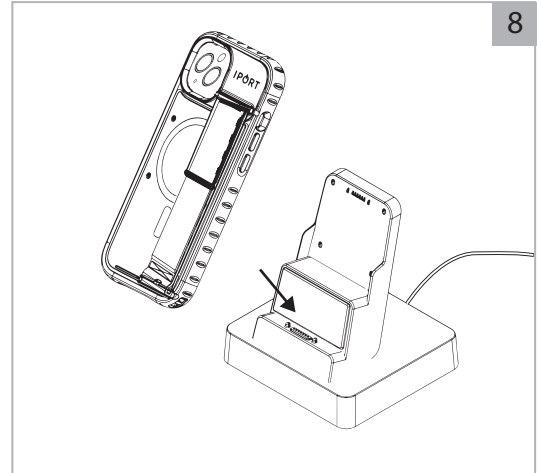

To charge the iPhone in an IPORT Phone Dock or MultiDock place the iPhone with the Screen facing the back of the dock, If not the hand strap will interfere with docking and the iPhone will not charge.