



LEATHER DRIVER F9-360



USA
(800) 222-4296

Spain
+34 93 628 22 00

Canada
(877) 278-5822

Australia
1 300-731 336

Japan
03 4590 0066

MECHANIX WEAR LLC
www.mechanix.com

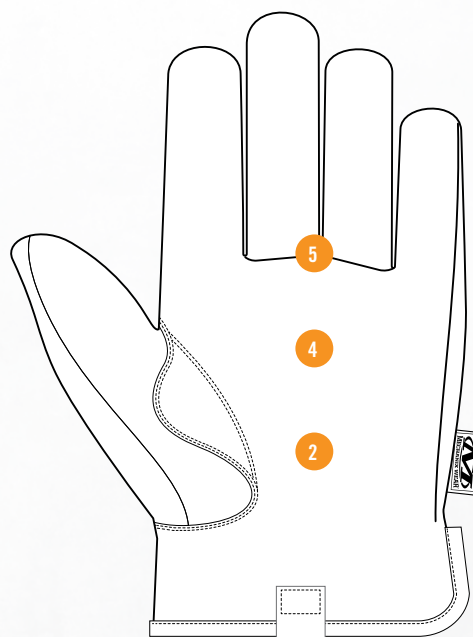
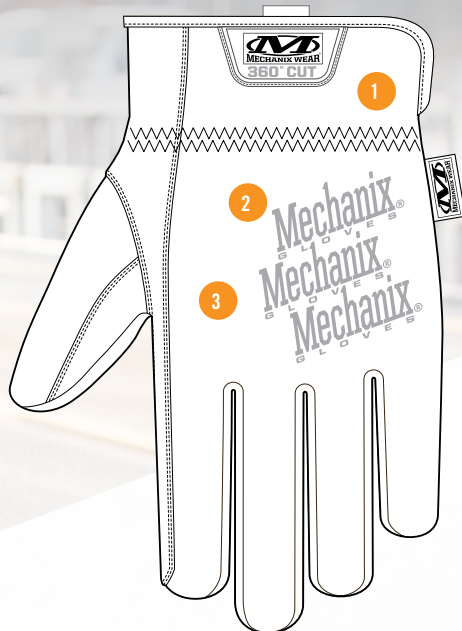

LEATHER HAND PROTECTION

The Leather Driver F9-360 is built with Durahide™ leather and lined with high-tensile strength fibers to deliver 360° EN 388 Level F & ANSI A9 cut-resistance. The Durahide™ Driver F9-360 features a Gunn cut finger design that repositions vulnerable seams, and a stretch-elastic wrist closure for easy on/off glove removal between jobs.

FEATURES

- 1 Comfortable stretch-elastic cuff provides easy on and off flexibility.
- 2 High-tensile strength liner provides 360° EN 4X43F Level F & ANSI A9 cut resistance.
- 3 Top grain Durahide™ leather protects the back of your hands while you work.
- 4 Durahide™ leather protects your palm with extreme abrasion resistance.
- 5 Gunn cut finger design repositions vulnerable seams for improved durability.



MACHINE
WASHABLE



DURAHIDE™ LEATHER
TECHNOLOGY



360° CUT-RESISTANCE

INTENDED USES

- Construction
- Oil & Gas
- Mining
- Rigging

CERTIFICATIONS



SIZE	S-008	M-009	L-010	XL-011	XXL-012	XXXL-013
COLOR	LD-C75 BROWN/BLACK					

Product is Imported

LEATHER DRIVER F9-360