

# Printed Circuit Board (PCB)

## REPLACEMENT INSTRUCTIONS

Kit Name	PCB Replacement Kit
Kit Part Number and Compatible Rinnai Products	<ul style="list-style-type: none"> <li>803000057 for Rinnai Commercial Boiler Model: RCB301AN</li> <li>803000058 for Rinnai Commercial Boiler Model: RCB399AN</li> </ul>

**WARNING** Failure to correctly assemble the components according to these instructions may result in electric shock, injury, or death.

### CAUTION

To protect yourself from harm, follow the steps below before proceeding.

- Disconnect the electrical power supply by turning off the electricity at the circuit breaker.
- Shut off the gas at the gas valve, usually located near the gas connection at the appliance.
- Turn off the water by closing manual ball valves at the return and supply piping connections at the appliance.

## Items Inside Product Box

Table 1

Item #	Item (Part Number)	Qty
1	Main Control LMS14 (805000120)	1
2	Main Control Back Cover (809000230)	1
3	Main Control Front Cover (809000231)	1
4	Main Control Top Cover (809000228)	1
5	Main Control Warning Label (809000229)	2
6	Screw, DIN 7981 3,5 x 9,5 (809000210)	4
7	Screw, DIN 7981 2,9 x 9,5 (809000212)	4
8	Screw, DIN 7981 2,9 x 13 (809000270)	1
9	Screw, DIN 7981 4,8 x 9,5 (809000203)	3

### TOOLS/MATERIALS REQUIRED

- Phillips Head Screwdriver #1
- Phillips Head Screwdriver #2

## Instructions

1. Turn off and disconnect 120 V power supply.
2. Turn off water supply.
3. Turn off gas supply.

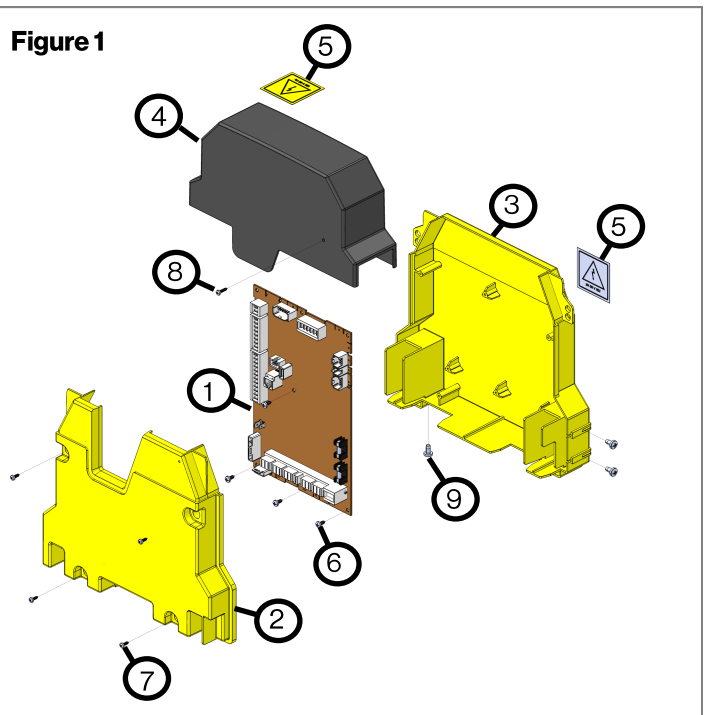

**CAUTION** Confirm gas valve is turned off and not leaking. Use gas valve switch to prevent gas valve from being turned on.

4. Use a Phillips head screw driver to remove two screws located on the bottom of the appliance securing the front panel (Figure 2A). Pull out the bottom of the front panel to clear the display assembly (Figure 2B), then move the front panel up to clear the pins located on top of the appliance (Figure 2C).

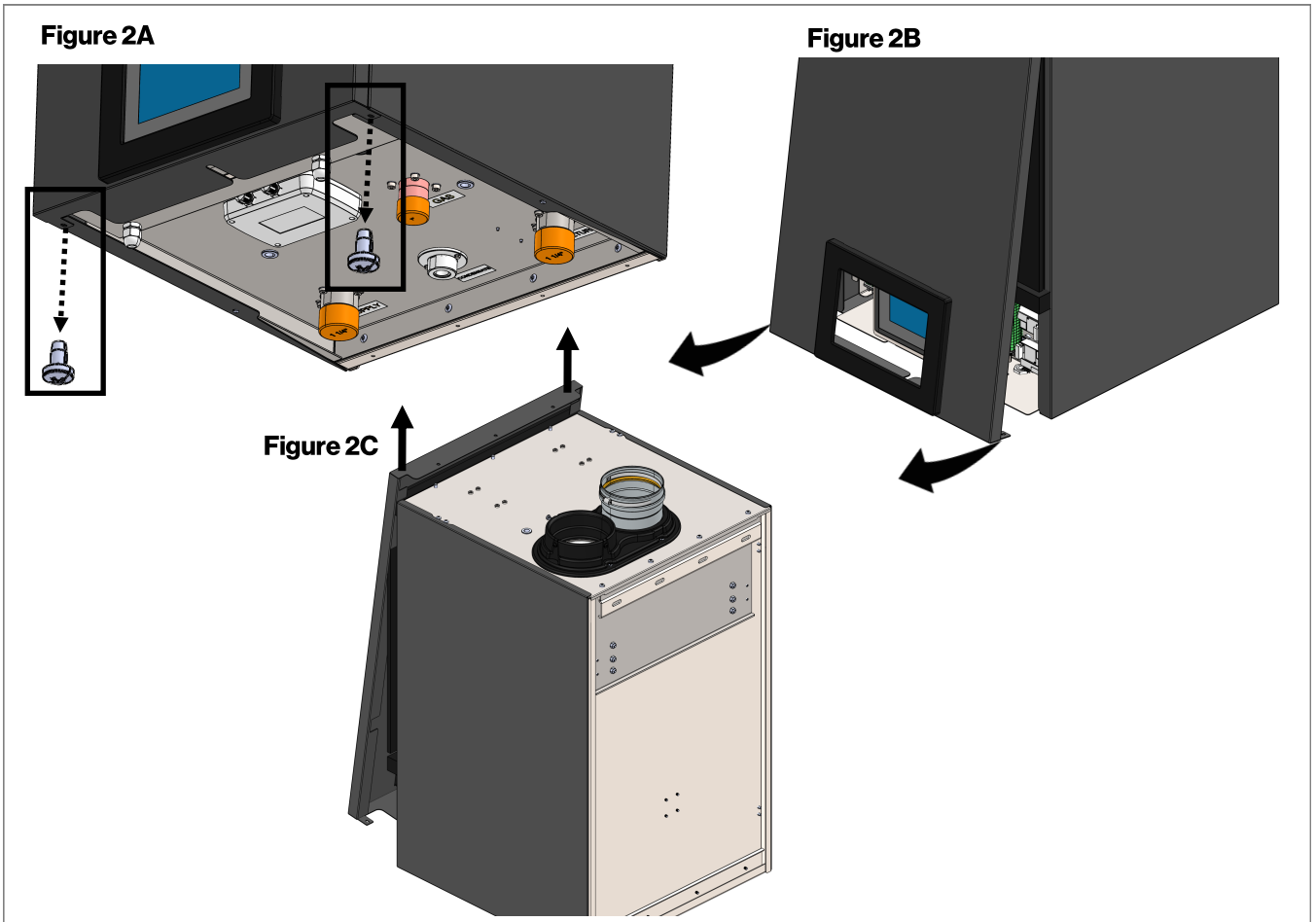

5. Use a Phillips head screw driver to remove three screws holding left side panel (Figure 3A). Rotate the side panel out (Figure 3B), push the panel up to clear the cutout located on back side of boiler, and pull the side panel out (Figure 3C).

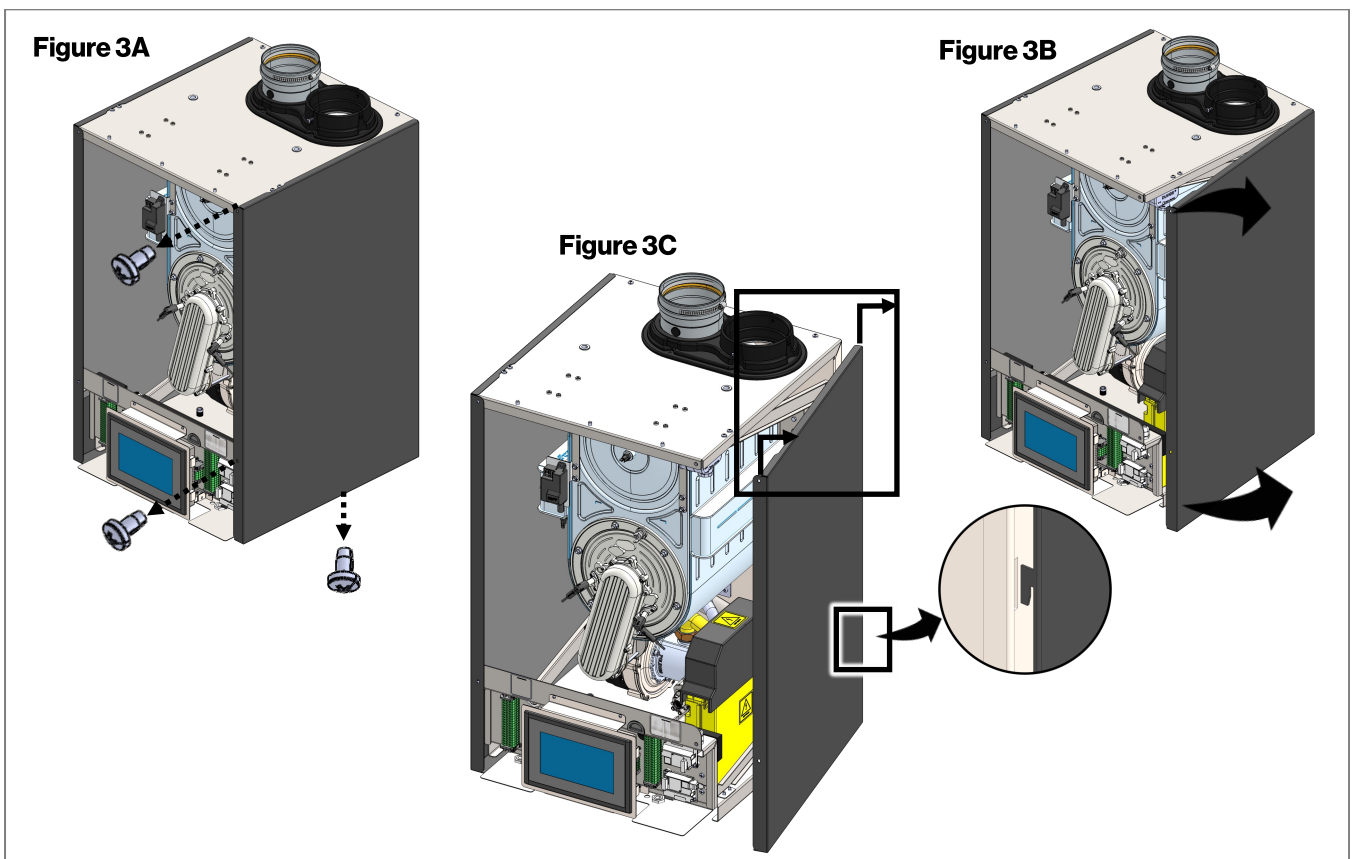

6. Disconnect three screws holding PCB enclosure to the unit (Figure 4).
7. Remove a screw holding PCB top cover and remove the top cover (Figure 5).

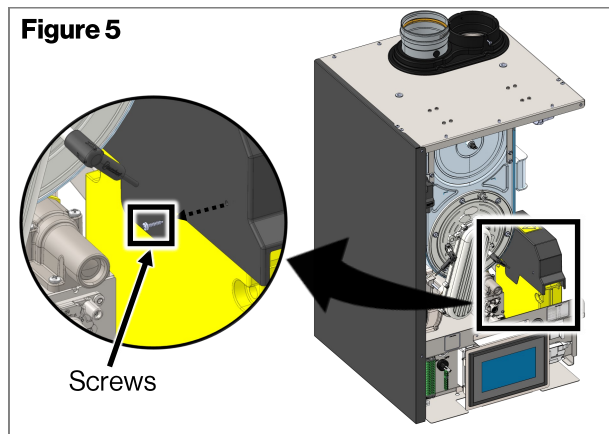
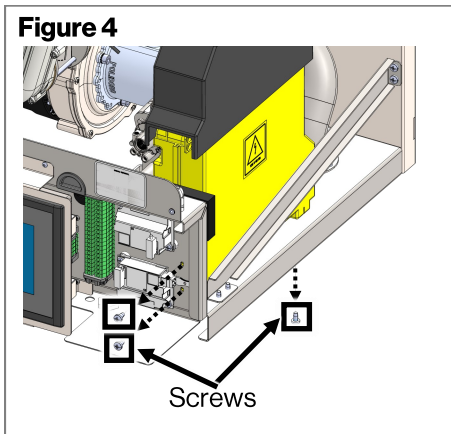

8. Rotate the PCB enclosure on the right side (Figure 6). **Caution:** Ensure that the connectors are not pulled out while rotating the PCB.
9. Remove four screws securing PCB cover (Figure 7).

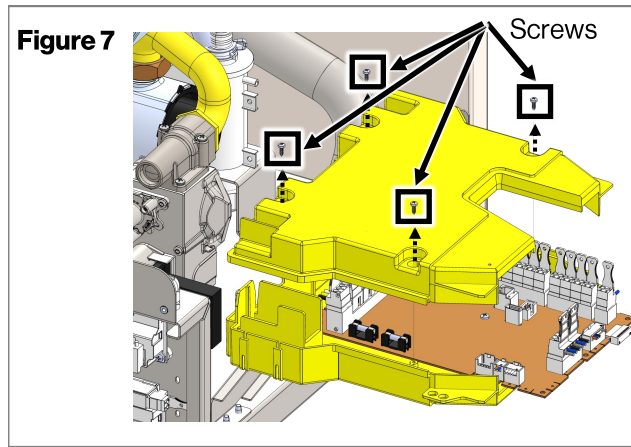
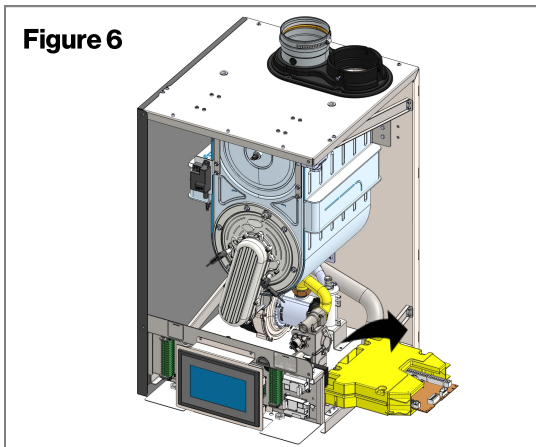

Instructions continued on next page.

10. Ensure that all the connectors are labeled for identification during reassembly. Disconnect all the connectors (Figure 8).

11. Remove the screws holding top cover and back cover on new PCB kit (Figure 9)

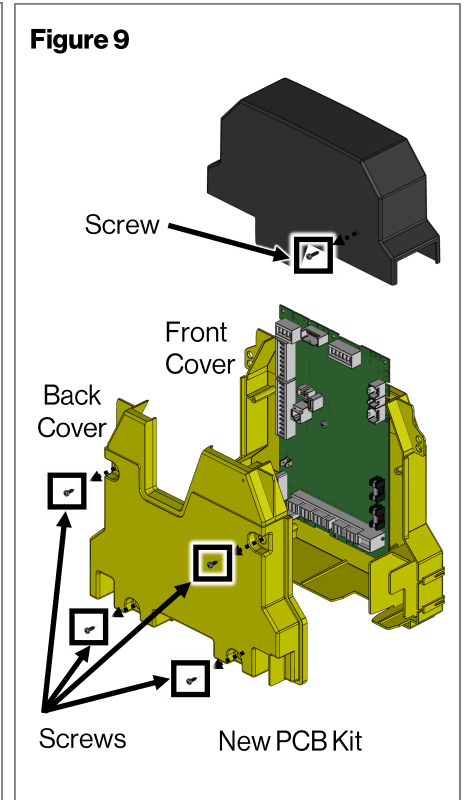
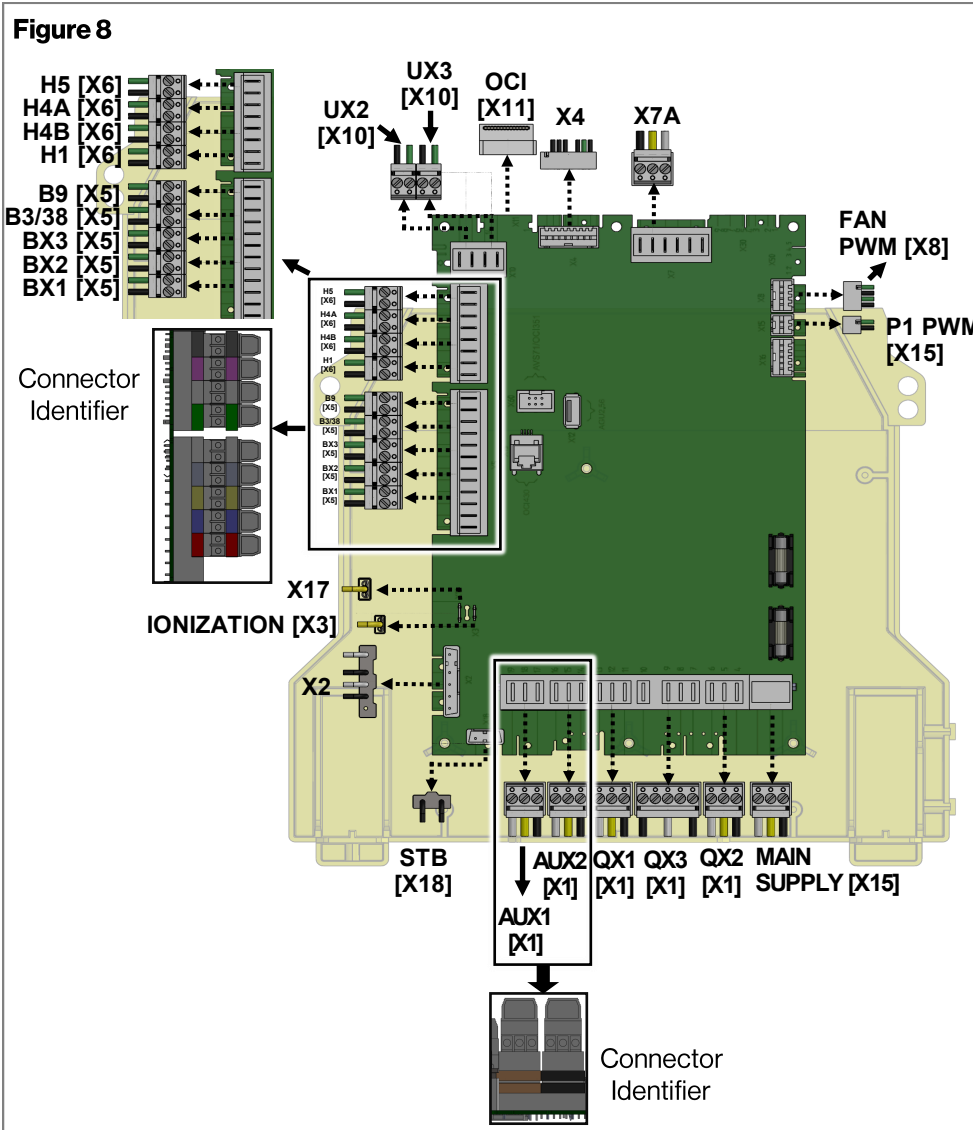

## PCB Reassembly

1. Bring the new PCB close to unit and mount all the connectors on new PCB (Figure 8).
2. Mount new PCB cover using four screws (Figure 7).
3. Rotate the PCB back into the unit (Figure 6).
4. Mount new PCB top cover using one screw (Figure 5).
5. Secure the new PCB enclosure on unit using three screws (Figure 4).
6. Line up right side panel with pin located on back side of boiler and secure it using three screws (Figure 3A, 3B & 3C).
7. Reconnect and turn on 120 V power supply, water supply and gas supply.
8. Test the new PCB functionality.
9. Line up front panel assembly with pins located on top side on boiler and secure using two screws on bottom. (Figure 2A, 2B & 2C).