

IMPORTANT SAFETY INSTRUCTIONS

When using electrical products, basic precautions should always be practiced including the following:

1. READ AND FOLLOW ALL SAFETY INSTRUCTIONS.
2. Maximum ambient temperature around the adapter must not exceed 40°C
3. Read and follow all instructions that are on the product or provided with the product.
4. Use only power supplies that are certified according to the relevant safety standards UL1310.
5. The output power taken from the power supply must not exceed the rating given on the adapter.
6. Unplug from outlet before installing the product.
7. Do not use in a bathroom.
8. This product is NOT a toy.
9. Do not open the product. Use only as intended.
10. Do not roll up the product when using. Spread out to full length before connecting power supply.
11. Do not operate if any component is damaged.
12. Do not puncture, cut, shorten, or splice LED neon flex.
13. Do not operate Neon flex over the specified voltage.

SAVE THESE INSTRUCTIONS

This manual contains important safety and operating instructions to power the unit.

LIMITED WARRANTY. This product is warranted to be free from defects in workmanship and materials for up to 1 year from date of purchase. If the product fails within the warranty period, please contact Feit Electric at feit.com/help for help. REPLACEMENT OR REFUND IS YOUR SOLE REMEDY. EXCEPT TO THE EXTENT PROHIBITED BY APPLICABLE LAW, ANY IMPLIED WARRANTIES ARE LIMITED IN DURATION TO THE DURATION OF THIS WARRANTY. LIABILITY FOR INCIDENTAL OR CONSEQUENTIAL DAMAGES IS HEREBY EXPRESSLY EXCLUDED. Some states and provinces do not allow the exclusion of incidental or consequential damages, so the above limitation or exclusion may not apply to you. This warranty gives you specific legal rights, and you may also have other rights which vary from state to state or province to province.

PARTS INCLUDED:

 **NOTE:** Parts not shown to actual size.

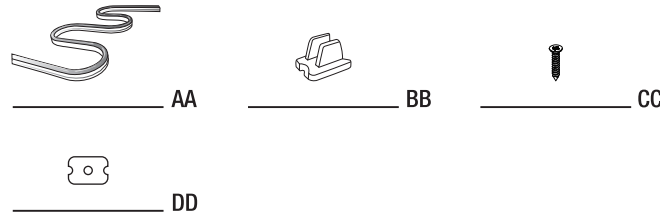

Part	Description	Quantity
AA	5ft. Neon Flex Light	1
BB	Mounting Clips	5
CC	Screws	5
DD	3M Adhesives	5

MODEL: NF5/3K/USB

FEIT
ELECTRIC

Bright White - 5FT

Neon Flex Light

Quick Install Guide

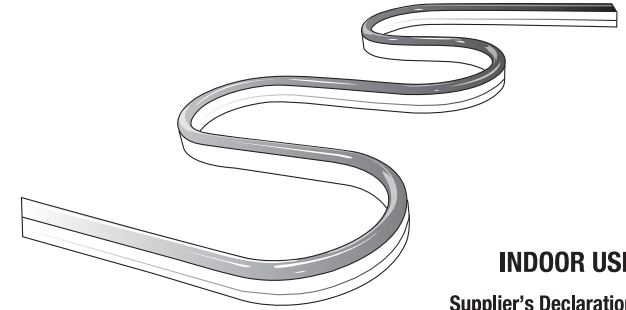

INDOOR USE

Supplier's Declaration of Conformity:

47 CFR § 2.1077
Compliance Information
Responsible Party:
Feit Electric Company
4901 Gregg Road,
Pico Rivera, CA 90660, USA
562-463-2852
Unique Identifier: NF5/3K/USB

ELECTRICAL RATINGS:

LUMENS: 120
WATTS: 10
VOLTS: 5VDC
KELVIN: 3000K
CURRENT: 2A MAX
DO NOT USE WITH DIMMERS
MADE IN THAILAND

This device complies with part 15 of the FCC Rules. Operation is subject to the following two conditions: (1) This device may not cause harmful interference, and (2) this device must accept any interference received, including interference that may cause undesired operation. Note: This equipment has been tested and found to comply with the limits for a Class B digital device, pursuant to part 15 of the FCC Rules. These limits are designed to provide reasonable protection against harmful interference in a residential installation. This equipment generates, uses and can radiate radio frequency energy and, if not installed and used in accordance with the instructions, may cause harmful interference to radio communications. However, there is no guarantee that interference will not occur in a particular installation. If this equipment does cause harmful interference to radio or television reception, which can be determined by turning the equipment off and on, the user is encouraged to try to correct the interference by one or more of the following measures: Reorient or relocate the receiving antenna. Increase the separation between the equipment and receiver. Connect the equipment into an outlet on a circuit different from that to which the receiver is connected. Consult the dealer or an experienced radio/TV technician for help. Any changes or modifications not expressly approved by the manufacturer could void the user's authority to operate the equipment. www.feit.com.

Getting Started:

WARNING: These products may represent a possible shock or fire hazard if improperly installed or attached in any way. Products should be installed in accordance with this install guide, current electrical codes and/or the current National Electric Codes.

CAUTION:

1. Use only insulated staples or plastic ties to secure cords.
2. Route and secure cords that they will not be pinched or damaged when furniture is pushed to the wall.
3. When mounting lights on furniture ensure product caution remains visible
4. Not intended for recessed installation in ceilings.
5. Electrical codes do not permit cords to be concealed where damage to insulation may go unnoticed.

To prevent fire danger, do not run cord behind walls, ceilings, soffits, or cabinets where it may be inaccessible for examination. Cords should be visually examined periodically and immediately replaced when any damage is noted. This product will not operate properly when connected to a dimmer or dimming control.

1 Connect USB to Power Supply

Connect the USB to a USB Wall Charger (Not Included) as shown in the image below.

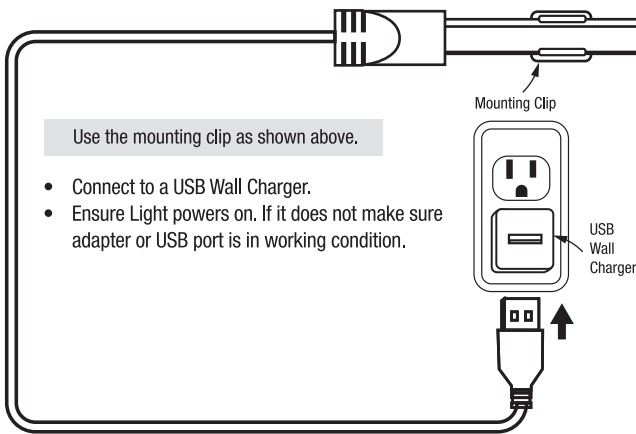

 **NOTE:** Wall adapter should be 5VDC 2A Max.

2 Prepare the Neon Flex

- Clean the mounting area thoroughly (surface must be free of dust, dirt, or grease).
- Avoid areas where the neon flex can be pierced which may damage the LEDs.
- Avoid removing and relaying the 3M tape multiple times as the adhesive may wear off.

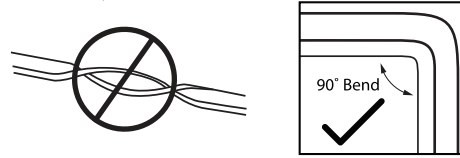

3 Peel the Adhesive Tape

Peel one side of the adhesive 3M and place it on the underside of the mounting clip. Plan out your design before mounting. The Neon Flex will hold its shape when its bent. Use this feature and plan the locations of the mounting clip at 5 evenly spaced locations.

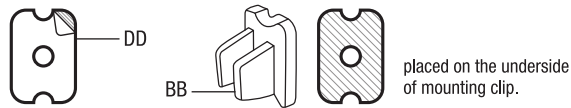

4 Mount the Neon Flex

Unroll the neon flex and place near mounting location. Ensure cord can reach your power source. Do not connect to power yet.

- Once you find the starting point of your design, attach the clip and peel off the other side of the 3M adhesive and press firmly to the wall or surface.
- Ensure you are spacing out your clips adequately and press firmly along neon flex to ensure proper adhesion.
- Screw in mounting clips (required for all long term installations).

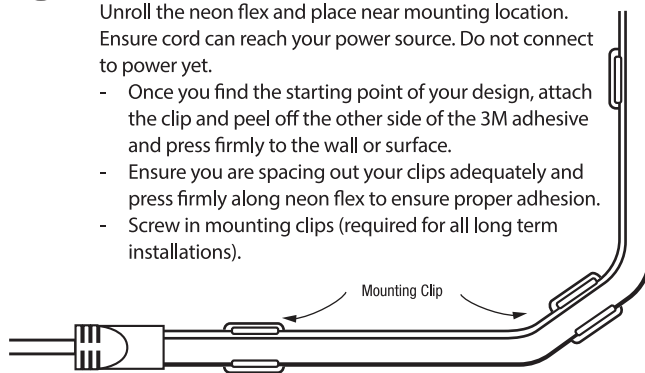

This neon flex light uses permanent tape and may cause surface damage if removed. Not recommended for mounting on brick or concrete.

Feit Electric is not responsible for damage to mounted surfaces.

Need Help?



For 24/7 customer support, visit [feit.com/help](https://www.feit.com/help)