

ASSEMBLY INSTRUCTION

SWIVEL GLIDER RECLINING CHAIR

A Back Rest

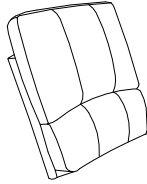

1PC

B Seat

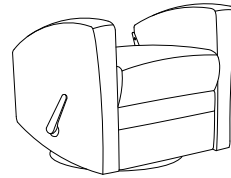

1PC

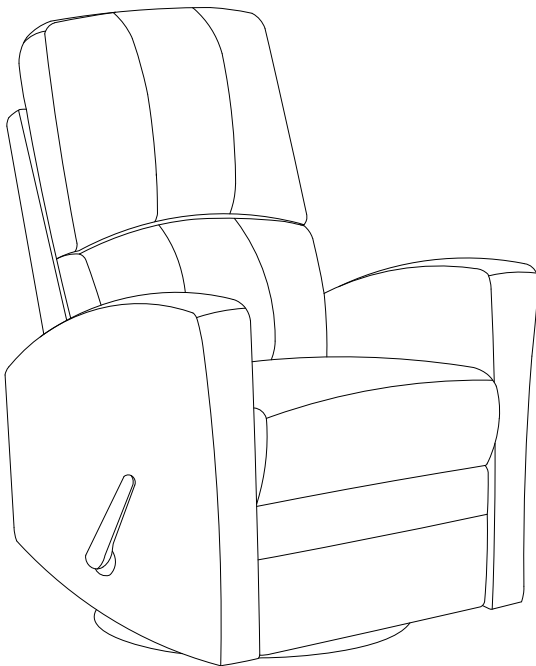

This page lists all the contents included in the box. Please take the time to identify the hardware as well as the individual components to this product. As you unpack and prepare for assembly, place the contents on a carpeted or padded area to protect them from damage.

-
- 1** Please remove / cut the plastic tie straps at the bottom of the Seat (B) before assembly.

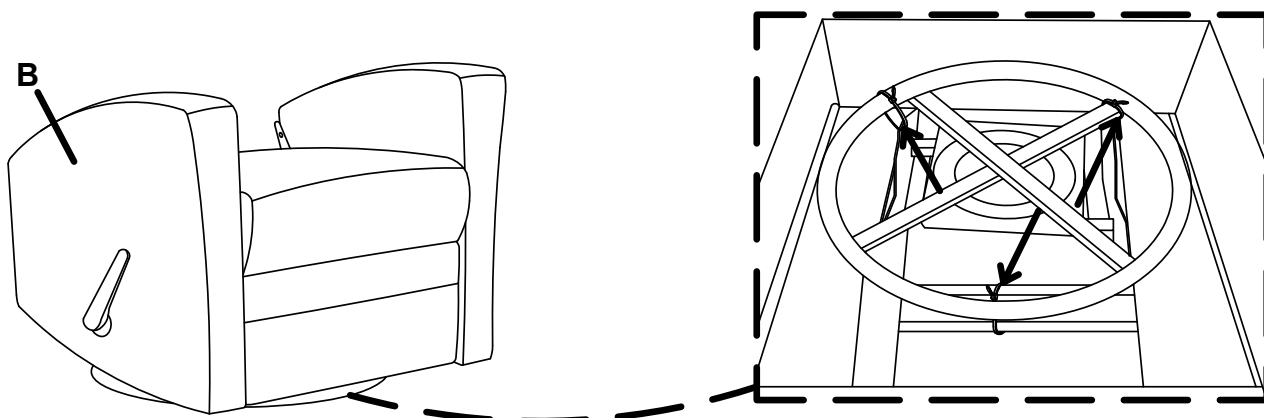

-
- 2** Align the female brackets at the Back Rest (A) onto the male brackets at the Seat (B), insert to the end, and make sure the brackets are secured in position.

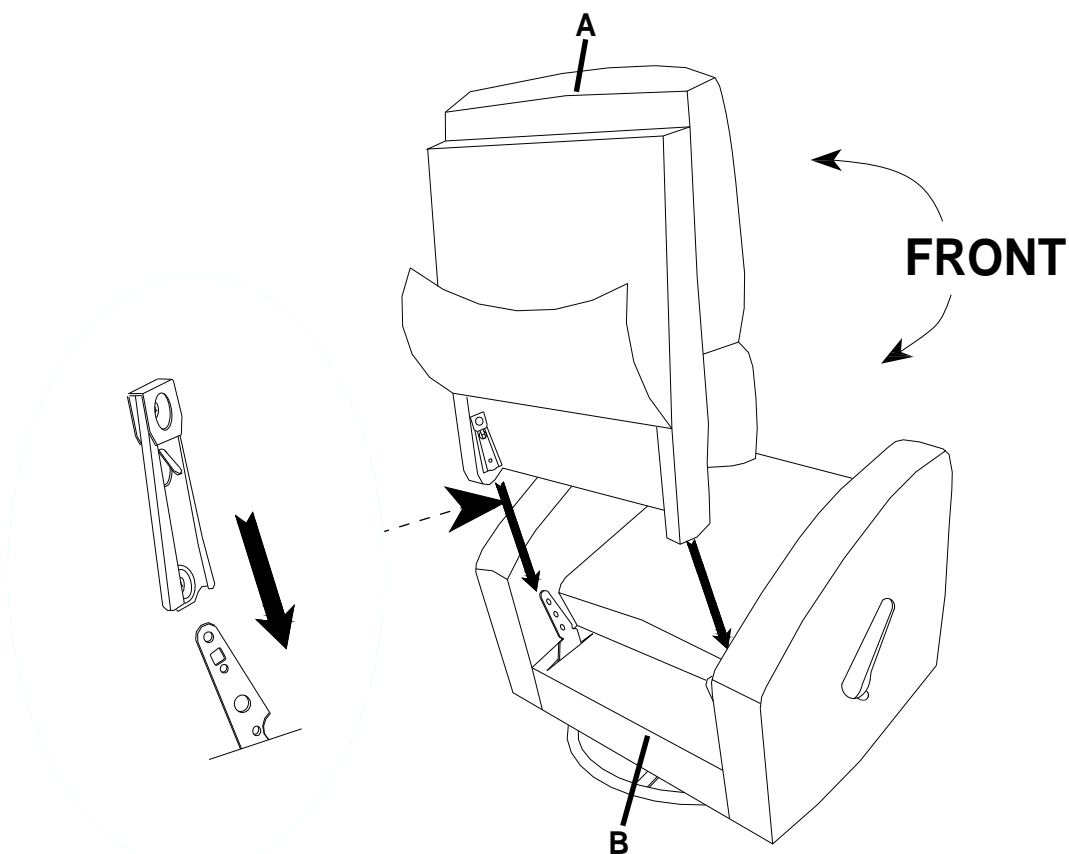

Cleaning & Care

Treat surface with care. Surface is resistant to scratches but is not scratch resistant. Clean surface with a dry or damp soft cloth. Do not use abrasive cleaners. Hardware may loosen over time. Periodically check that all connections are tight.