

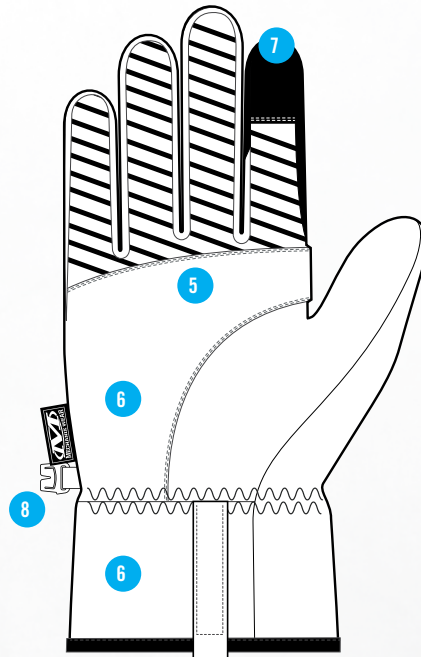

COLDWORK™ WIND SHELL

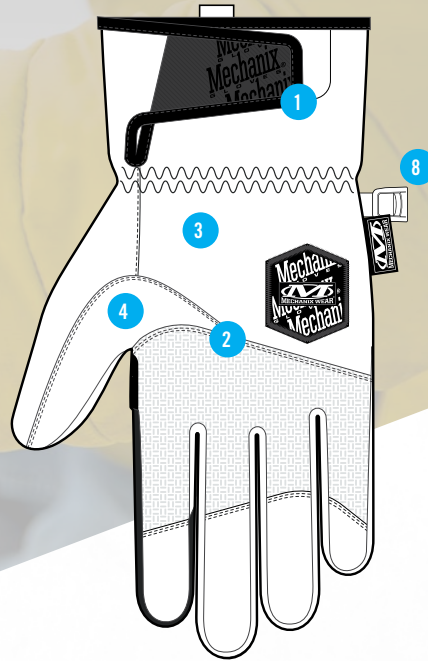

COLD WEATHER HAND PROTECTION

When the wind picks up and the cold front moves in, reach for our ColdWork™ Wind Shell gloves to ward off the elements. Comfortable micro-fleece lines the entire glove and PrimaLoft® Gold encases your hands with a combo of 40g and 60g insulation to reduce bulk. The Wind Shell features an internally bonded wind barrier to prevent cold air from pushing through when the gusts are strong.

FEATURES

- 1 Extended cuff with hook and loop wrist closure creates a secure fit.
- 2 Heavyweight fleece construction with water resistant soft shell back of hand protection.
- 3 PrimaLoft® 40g Gold performance back of hand insulation.
- 4 Rugged Armortex® thumb saddle reinforcement and fingertip reinforcement.
- 5 Rugged Armortex® palm resists water and maintains grip.
- 6 PrimaLoft® 60g Gold performance palm insulation.
- 7 Touchscreen capable index finger keeps you connected in cold conditions.
- 8 Removable spring clip keeps your gloves organized for easy storage.



MACHINE WASHABLE



TOUCHSCREEN TECHNOLOGY



PRIMALOFT®

INTENDED USES

- Maintenance & Repair
- Construction
- Snow Removal
- Towing & Transportation

CERTIFICATIONS

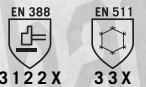

3122 X 33X

USA
(800) 222-4296

Spain
+34 93 628 22 00

Canada
(877) 278-5822

Australia
1 300-731 336

Japan
03 4590 0066

MECHANIX WEAR LLC
www.mechanix.com

SIZE	S-008	M-009	L-010	XL-011	XXL-012
COLOR	CWKWS-58 GREY/BLACK				

COLDWORK™ WIND SHELL