

citrus juicer at the mains power supply.

**STEP 8:** Turn the jug in an anticlockwise direction until it unlocks. Place one hand on the citrus juicer base unit and lift the jug away.

**STEP 9:** When pouring the juice, use a thumb to keep the juicing cone in place.



**NOTE:** The citrus juicer must have fruit in it in order for it to work. The direction of the juicing cone will change each time pressure is reapplied.



**WARNING:** Only use the citrus juicer with citrus fruit; do not press hands directly onto the juicing cone. Do not juice for extended periods. Max. operation time is 10 minutes; allow the citrus juicer to cool before using it again. Make sure that all pulp is removed. If pulp begins to build up, stop juicing, switch off and unplug the citrus juicer from the mains power supply and remove the pulp. Do not operate the citrus juicer if any of the accessories are damaged.

## Storage

Reassemble the citrus juicer. To reassemble, follow the steps in the section entitled '**Assembling the citrus juicer**'.

Check that the citrus juicer is cool, clean and dry before storing in a cool, dry place.

## Specifications

Product code: EK5878

Operating voltage: 220–240 V ~ 50/60 Hz

Power: 40 W



### Disposal of Waste Batteries and Electrical and Electronic Equipment



This symbol on the product, its batteries or its packaging means that this product and any batteries it contains must not be disposed of with household waste. Instead, it is the user's responsibility to hand this over to an applicable collection point for the recycling of batteries and electrical and electronic equipment. This separate collection and recycling will help to conserve natural resources and prevent potential negative consequences for human health and the environment due to the possible presence of hazardous substances in batteries and electrical and electronic equipment, which could be caused by inappropriate disposal. Some retailers provide take-back services which allow the user to return exhausted equipment for appropriate disposal. **It is the user's responsibility to delete any data on electrical and electronic equipment prior to disposal.** For more information about where to drop batteries, electrical and electronic waste off, please contact the local city/municipality office, household waste disposal service, or the retailer.

# User manual

Citrus juicer

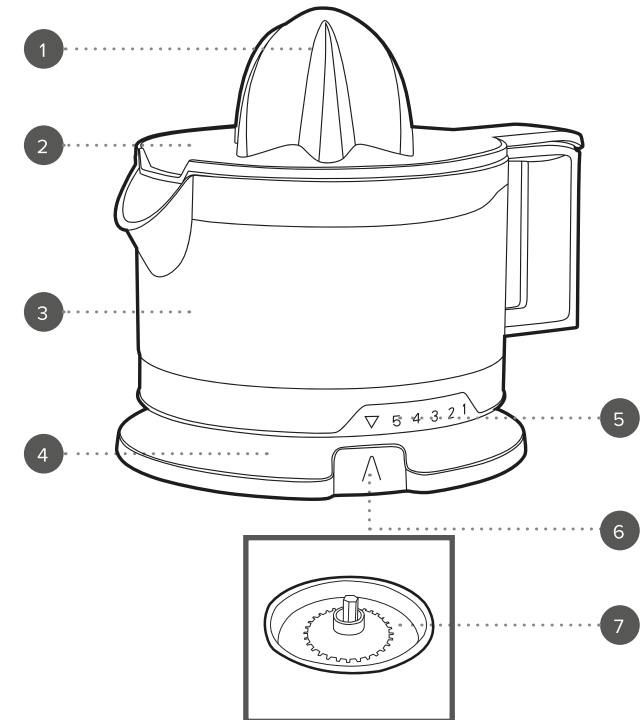

1. Juicing cones
2. Lid
3. 500 ml jug
4. Citrus juicer base unit

5. Pulp content scale
6. Drive shaft
7. Juicing filter

Manufactured by:  
Ultimate Products UK Ltd.,  
Victoria Street, Manchester OL9 0DD. **UK.**  
Ultimate Products Europe Ltd.,  
19 Baggot Street Lower, Dublin DO2 X658. **ROI.**

**MADE IN CHINA.**

CD131023/MD000000/V1

Please retain instructions for future reference.

## SAFETY INSTRUCTIONS

- When using electrical appliances, basic safety precautions should always be followed.
- Check that the voltage indicated on the rating plate corresponds with that of the local network before connecting the appliance to the mains power supply.
- Children aged from 8 years and people with reduced physical, sensory or mental capabilities or lack of experience and knowledge can use, and clean this appliance, only if they have been given supervision or instruction concerning use of the appliance in a safe way and understand the hazards involved.
- If the power supply cord, plug or any part of the appliance is malfunctioning, or if the appliance has been dropped or damaged, cease using the product immediately to avoid potential injury. This appliance contains no user serviceable parts, only a qualified Electrician should carry out repairs. Improper repairs may place the user at risk of harm.
- Keep the appliance and its power supply cord away from heat or sharp edges that could cause damage. Keep hands, fingers, hair and any loose clothing away from the rotating tools of the appliance.
- Do not touch any moving parts on this appliance during use, as this could cause injury.
- Do not immerse the appliance in water or any other liquid.
- Do not operate the appliance with wet hands.
- Do not leave the appliance unattended whilst connected to the mains power supply.

- Do not use any accessories other than those supplied.
- Do not move the appliance whilst it is in use.
- Use of an extension cord with the appliance is not recommended.
- This appliance should not be operated by means of an external timer or separate remote-control system, other than that supplied with this appliance.
- This appliance is intended for domestic use only. It should not be used for commercial purposes.

## Care and maintenance

**STEP 1:** Switch off and unplug the citrus juicer from the mains power supply before performing any cleaning or user maintenance.

**STEP 2:** Wipe the citrus juicer base unit with a soft, damp cloth and allow to dry thoroughly.

**STEP 3:** Wash all of the accessories in warm, soapy water, then rinse and dry thoroughly.



**CAUTION:** Do not use harsh or abrasive scourers to clean the citrus juicer, as this could cause damage. The citrus juicer and accessories are not suitable for use in a dishwasher. Always clean the citrus juicer immediately after each use.

**WARNING:** Exercise caution when attaching, removing, cleaning or storing the attachments.

## Instructions for use

### Before first use

Clean the citrus juicer following the instructions outlined in the section entitled '**Care and maintenance**'.



**NOTE:** When using the citrus juicer for the first time, a slight odour may be emitted. This is normal and will soon subside. Allow for sufficient ventilation around the citrus juicer.

## Assembling the citrus juicer

**STEP 1:** Place the citrus juicer base unit on a flat, stable surface. Make sure that it is unplugged from the mains power supply.

**STEP 2:** Slot the jug onto the base unit, turning in a clockwise direction until it locks into position.

**STEP 3:** Slot the juicing cone into the juicing filter, aligning the compartments until they slot into place.

**STEP 4:** Place the juicing filter and attached cone onto the drive shaft.

**STEP 5:** Align the compartments until they click into place.



**WARNING:** Do not plug in the citrus juicer until it is fully assembled. Place the bigger juicing cone directly on top of the smaller cone when juicing larger fruits.

## Using the citrus juicer

**STEP 1:** Place the citrus juicer onto a flat, stable surface.

**STEP 2:** Prepare the citrus fruit by cutting it in half.

**STEP 3:** Plug in and switch on the citrus juicer at the mains power supply.

**STEP 4:** Open the lid and place the prepared citrus fruit onto the desired juicing cone, with the cut side facing down. Close the lid.

**STEP 5:** Apply pressure to the lid. The juicing cone will automatically rotate when pressure is applied. Excess juice will run down into the 500 ml jug.

**STEP 6:** Slowly turn the jug in an anticlockwise direction to adjust the pulp concentration. There are 5 levels indicated on the dial; turn to 1 for less pulp and 5 for more pulp.

**STEP 7:** Once the fruit has been juiced, switch off the