

Important safety

Please read carefully

Please retain instructions for future reference.

SAFETY INSTRUCTIONS

- When using electrical appliances, basic safety precautions should always be followed.
- Check that the voltage indicated on the rating plate corresponds with that of the local network before connecting the appliance to the mains power supply.
- This appliance can be used by children aged from 8 years and above and persons with reduced physical, sensory or mental capabilities and knowledge, if they have been supervised/instructed and understand the hazards involved.
- Children shall not play with the appliance.
- Children should not perform cleaning or user maintenance, unless they are older than 8 and supervised.
- This appliance is not a toy.
- If the power supply cord, plug or any part of the appliance is malfunctioning or if it has been dropped or damaged, cease using the product immediately to avoid potential injury.
- This appliance contains no user serviceable parts, only a qualified electrician should carry out repairs. Improper repairs may place the user at risk of harm.
- Keep the appliance and its power supply cord out of the reach of children.
- Keep the appliance out of the reach of children when it is switched on or cooling down.
- Keep the appliance and its power supply cord away from heat or sharp edges that could cause damage.
- Keep the power supply cord away from any parts of the appliance that may become hot during use.
- Keep the appliance away from other heat emitting appliances.
- Do not allow the power supply cord to hang over worktops, touch hot surfaces or become twisted.
- Do not immerse the electrical components of this appliance in water or any other liquid.
- Do not operate the appliance with wet hands or if any connections are wet.
- If this appliance falls or accidentally becomes immersed in water, unplug it from the wall outlet immediately. Do not reach into the water.
- Do not leave the appliance unattended whilst connected to the mains power supply.
- Do not remove the appliance from the mains power supply by pulling the cord; switch it off and remove the plug by hand.
- Do not pull or carry the appliance by its power supply cord.
- Do not use the appliance for anything other than its intended use.
- Do not use any accessories other than those supplied.
- Do not use any damaged accessories.
- Do not use this appliance outdoors.
- Do not store the appliance in direct sunlight or in high humidity conditions.
- Do not move the appliance whilst it is in use.
- Do not touch any moving parts on this appliance during use, as this could cause injury.
- Do not touch any sections of the appliance that may become hot during use, as this could cause injury.
- Always unplug the appliance after use and ensure it has cooled fully before any cleaning, user maintenance or storing away.
- Always use the appliance on a stable, heat-resistant surface, at a height that is comfortable for the user.
- Use of an extension cord with the appliance is not recommended.
- This appliance should not be operated by means of an external timer or separate remote control system.
- This appliance is intended for domestic use only. It should not be used for commercial purposes.



CAUTION: Keep hands, fingers, hair and any loose clothing away from the rotating tools of the appliance.



WARNING: Do not touch sharp blades.

UK CE

EN | Disposal of Waste Batteries and Electrical and Electronic Equipment



This product is labelled with this crossed out wheel bin symbol in accordance with European Directive 2012/19/EC to indicate that it must not be disposed of with your other household waste. Due to the presence of hazardous substances, mixtures or components, electrical and electronic devices that are not subject to selective sorting are potentially dangerous to the environment and human health. Please check your local city office or waste disposal service for the return and recycling of this product.

Manufactured by:
Ultimate Products UK Ltd.,
Victoria Street, Manchester OL9 0DD. **UK.**
Ultimate Products Europe Ltd.,
19 Baggot Street Lower, Dublin D02 X658. **ROI.**
MADE IN CHINA.

CD260324/MD000000/V1

Description of parts

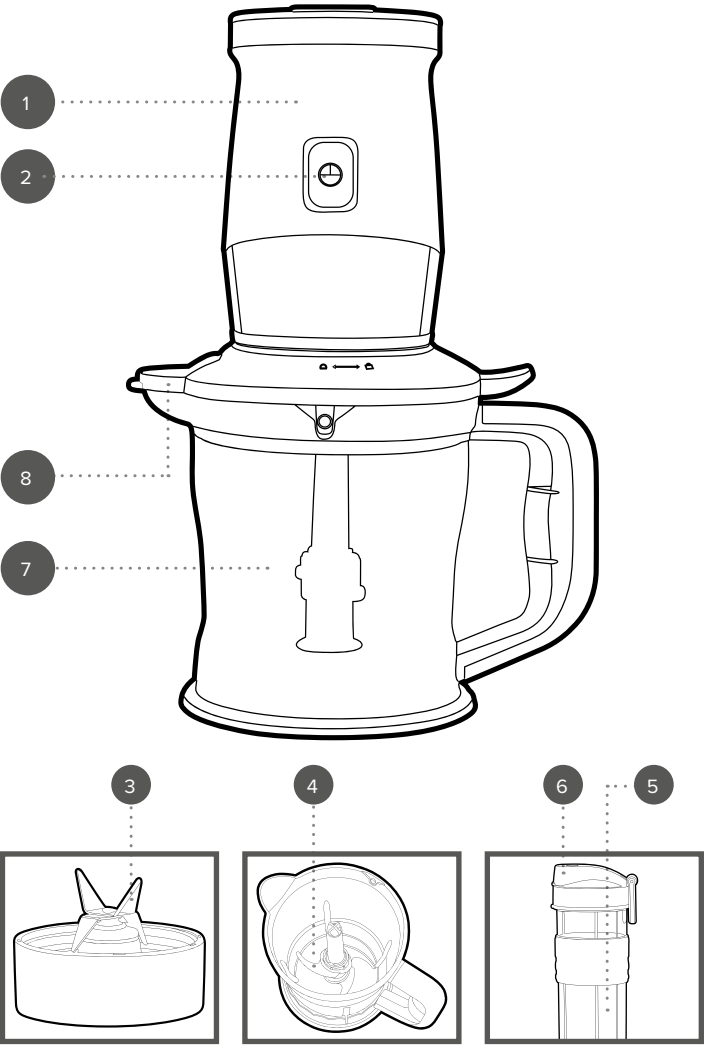

- 1. Blender/chopper main unit
- 2. Power button
- 3. Blender blade
- 4. Chopper blade
- 5. Sports bottle (570 ml)
- 6. Sports bottle lid
- 7. Chopping bowl (1.2 L)
- 8. Chopping bowl lid with spout

User manual

Blender/chopper

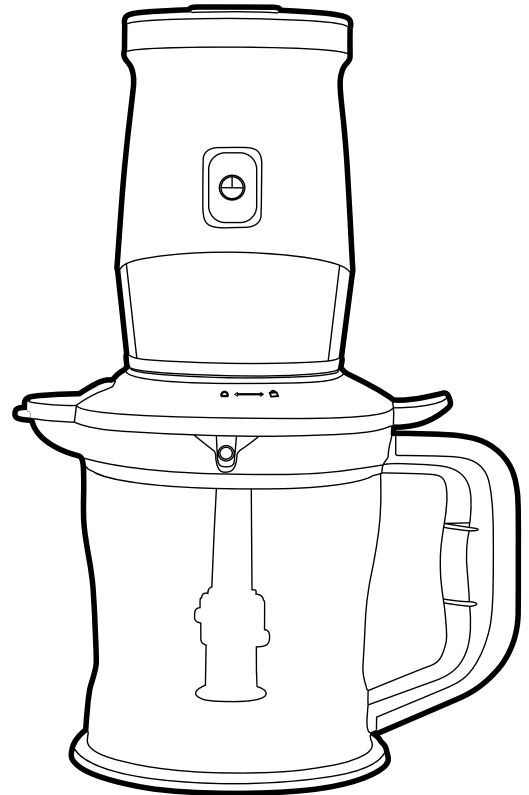

To register for your extended guarantee, scan the QR code or visit guarantee.uppic.com/salter and register your product within 30 days of purchase. For any further queries, visit www.salter.com.

Dos and don'ts

DO:
 Add a small amount of cold liquid or reduce the quantity of the ingredients in the chopping bowl/sports bottle if the blades are not running smoothly.
 If the ingredients do not blend evenly, remove the chopping bowl/sports bottle from the blender base unit. Shake the chopping bowl/sports bottle to redistribute the ingredients and then blend once more.
 Switch off the blender/chopper and disconnect it from the mains power supply before changing or fitting attachments.
 Check that the stainless steel cross-blade attachment is securely fitted to the blender bottle before use.
 Chop all ingredients into small pieces before blending.

DO NOT:
 Place boiling water or very hot liquid in the blender/chopper.
 Dry blend ingredients; always add a small amount of liquid.
 Overload the blender/chopper as the mixture level may rise during blending. Exceed the max fill mark.
 Operate the blender/chopper whilst empty, as this can cause damage.
 Use attachments or cutting/rotating blades if they are loose, damaged or broken.

Care and maintenance

Before attempting any cleaning or maintenance, switch off and unplug the blender/chopper from the mains power supply and allow it to fully cool.
STEP 1: Wipe the blender/chopper main unit with a soft, damp cloth and allow to dry thoroughly.
STEP 2: Wash all of the accessories in warm, soapy water, then rinse and dry thoroughly.
 Never touch the blades; using extreme caution, clean the blades with a brush and dry carefully.
 Do not use harsh or abrasive detergents or scourers to clean the blender/chopper, as this could cause damage.

 **NOTE:** The blender/chopper should be cleaned after each use.

 **WARNING:** Handle the attachments with care, as the blades are sharp. Exercise caution when attaching, removing, cleaning or storing attachments.

Instructions for use

Before first use

Clean the blender/chopper following the instructions outlined in the section entitled 'Care and maintenance'.

 **NOTE:** When using the blender/chopper for the first time, a slight odour may be emitted. This is normal and will soon subside. Allow for sufficient ventilation around the blender/chopper.

Assembling the blender/chopper

All attachments must be securely fitted before use; do not attempt to remove attachments until the blades have stopped moving.
STEP 1: Check that the blender/chopper main unit is switched off and unplugged from the mains power supply.
STEP 2: Position the blender/chopper main unit onto a flat, stable surface, at a height that is comfortable for the user. Check that the rubber feet are firmly planted so that the blender/chopper does not wobble during use.
STEP 3: Select the attachments as desired.

Assembling the chopper

STEP 1: Place the chopping bowl onto a flat, stable surface at a height that is comfortable for the user.
STEP 2: Remove the chopping bowl lid and place the ingredients into the chopping bowl. Replace the chopping bowl lid.
STEP 3: Invert the blender/chopper main unit and place it on top of the chopping bowl. Align the blender/chopper main unit with the locking tabs on the chopping bowl and gently press downwards. Twist in a clockwise direction until locked into place.

Using as a chopper

STEP 1: Holding the blender/chopper main unit steady, press and hold the power button until chopping is complete. Wait for the blades to stop rotating before detaching the chopping bowl.
STEP 2: Remove the chopper blade by twisting in an anticlockwise direction and lifting away from the chopping bowl.



CAUTION: Exercise caution when handling the stainless steel cross-blade attachment, as the blades may get hot during use. If blending warm ingredients, take care when removing the stainless steel cross-blade attachment, as there may be a pressure build-up from blending, which could cause the blended ingredients to spout from the lid.



WARNING: Do not blend hot liquid or food. Never exceed the 1.2 L mark when adding ingredients to the sports bottle/chopping bowl, as this could cause spillage and may damage the blender. The blender must not be operated when the sports bottle or chopping bowl are empty, cracked or broken.

Assembling as a sports bottle blender

STEP 1: Place the ingredients into the sports bottle.
STEP 2: Carefully place the blender blade on top of the sports bottle and rotate in a clockwise direction until locked into place.
STEP 3: Invert the sports bottle and place it on top of the blender/chopper main unit. Align the locking tabs and gently press downwards while twisting in a clockwise direction to lock into place.

Using as a sports bottle blender

STEP 1: Holding the blender/chopper main unit steady, press and hold the power button until the ingredients are blended. Wait for the blades to stop rotating before detaching the sports bottle.
STEP 2: Remove the blender blade by twisting in an anticlockwise direction and lifting away from the sports bottle.

Storage

Check that the blender/chopper main unit and its accessories are cool, clean and dry before storing in a cool, dry place.
 Never wrap the cord tightly around the blender/chopper; wrap it loosely to avoid causing damage.

Troubleshooting

Problem	Possible cause	Solution
The blender/chopper will not operate.	The blender/chopper is not connected to the mains power supply.	Plug in and switch on the blender/chopper at the mains power supply.
	The blender/chopper is not correctly assembled.	Check that the blender/chopper has been correctly assembled and that the attachments are secure.
There are large chunks of ingredients after chopping.	The blender/chopper has been overfilled.	Remove some of the ingredients and chop in batches.
The sports bottle is leaking.	The sports bottle lid is not fitted correctly.	Checking that the threads are correctly aligned, twist the sports bottle lid in a clockwise direction until secure.

Specifications

Product code: EK5029
 Input: 220–240 V ~ 50–60 Hz
 Output: 500 W