

Wi-Fi

REPLACEMENT INSTRUCTIONS

Kit Name	Wi-Fi Replacement Kit
Kit Part Number	803000059
Compatible Rinnai Products	Rinnai Commercial Boiler Models: RCB301AN and RCB399AN

WARNING Failure to correctly assemble the components according to these instructions may result in electric shock, injury, or death.

CAUTION

To protect yourself from harm, follow the steps below before proceeding.

- Disconnect the electrical power supply by turning off the electricity at the circuit breaker.
- Shut off the gas at the gas valve, usually located near the gas connection at the appliance.
- Turn off the water by closing manual ball valves at the return and supply piping connections at the appliance.

Items Inside Product Box

Before you begin, please make sure all parts are located inside the product box.

Table 1

Item #	Item (Part Number)	Qty
1	Web Server Card Enclosure (809000232)	1
2	Web Server Card + Wi-Fi PCB (805000121)	1
3	HMI Connector (805000122)	1
4	PG 7 Cable Gland (809000233)	2
5	Screw, DIN 7981 (809000271)	4
6	Screw, DIN 7981 (809000212)	2
7	Screw, DIN 7891 (809000210)	4

TOOLS/MATERIALS REQUIRED

- Phillips head screwdriver #1
- Phillips head screwdriver #2
- Flat head screwdriver

Instructions

1. Turn off and disconnect 120 V power supply.
2. Turn off water supply.
3. Turn off gas supply.

CAUTION Confirm gas valve is turned off and not leaking. Use gas valve switch to prevent gas valve from being turned on.

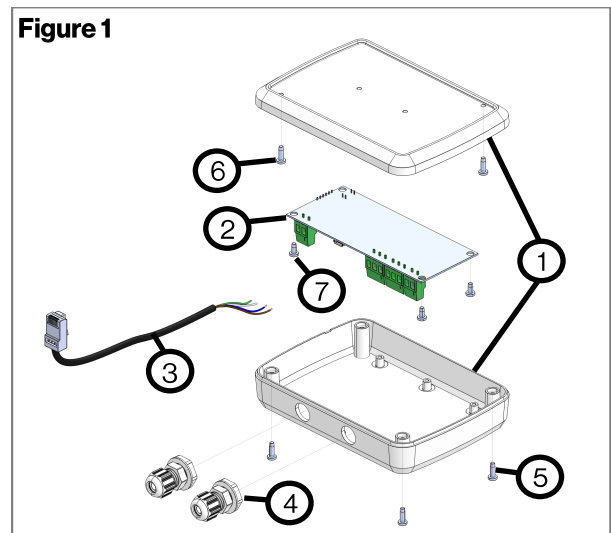

- Use a Phillips head screw driver to remove two screws located on the bottom of the appliance securing the front panel (Figure 2A). Pull out the bottom of the front panel to clear the display assembly (Figure 2B), then move the front panel up to clear the pins located on top of the appliance (Figure 2C).

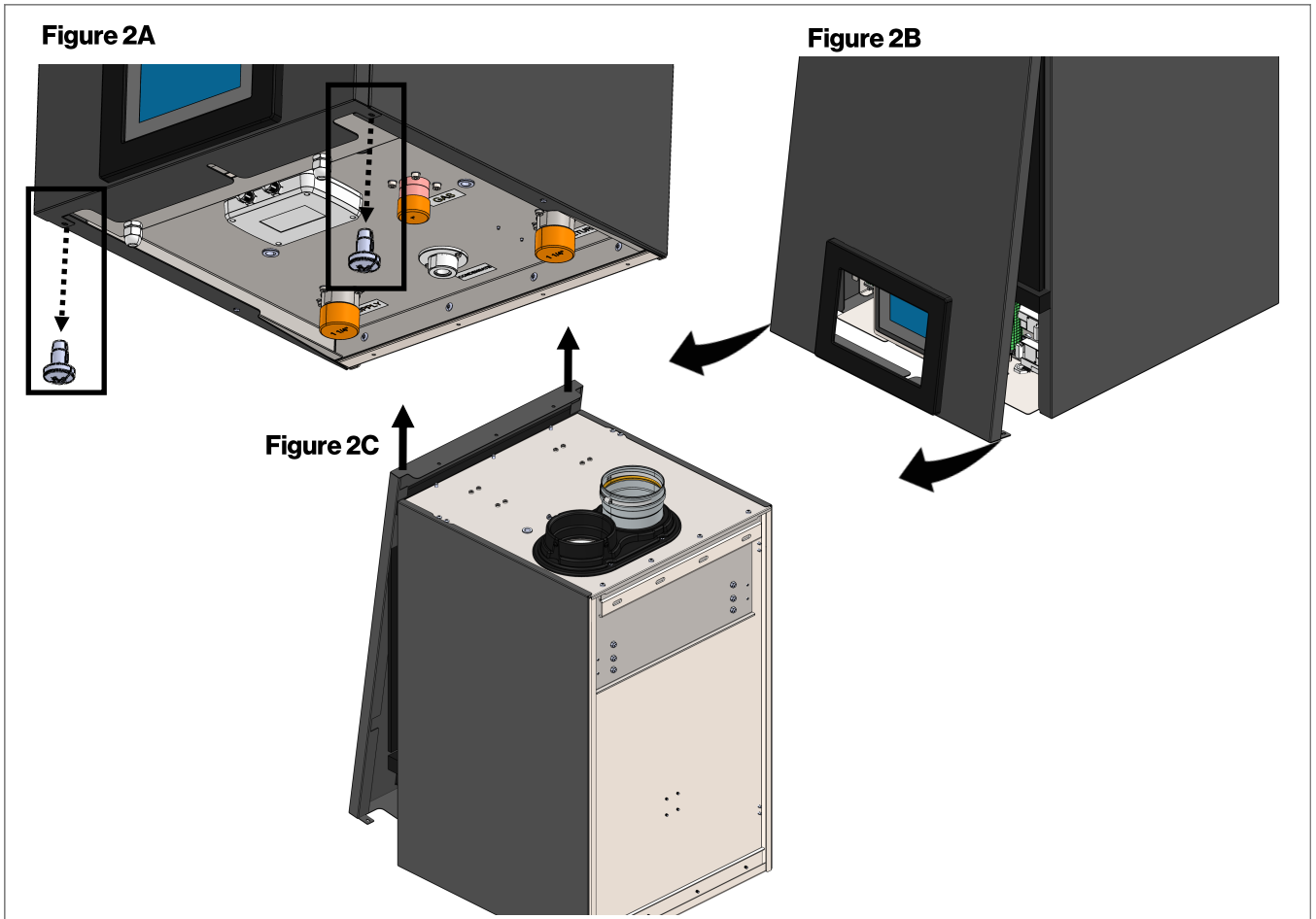

- Disconnect the HMI connector from HMI panel (Figure 3).
- Use a Phillips head screwdriver to remove four screws holding top cover of Web server card (Figure 4).

Note: Leave the top cover hanging since the HMI connector and other harnesses are still connected to web server card PCB.

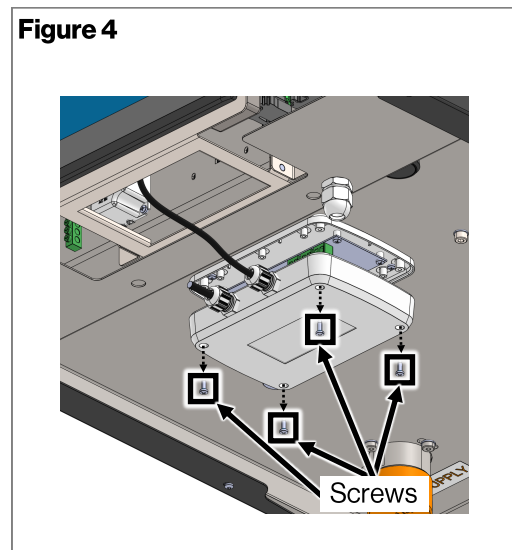
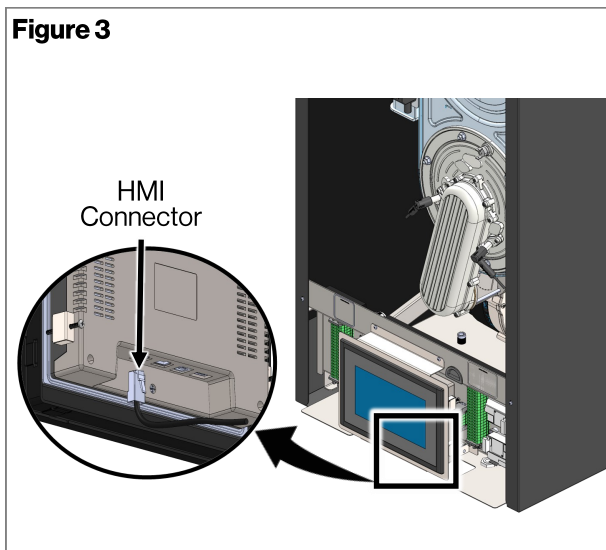

7. Disconnect the wires* from the webserver card (Figure 5).
8. Remove two cable glands to take out HMI and LMS/PS connectors (Figure 6).
9. Remove two screws to take off bottom cover of Wi-Fi module with PCB (Figure 7).

*Wires:	Brown	24+
	Blue	24-
	Black	A+
	Green	B-
	Green	G
	Green/White	A+
	Green	B-
	Black	Cl+
	Green	Cl-

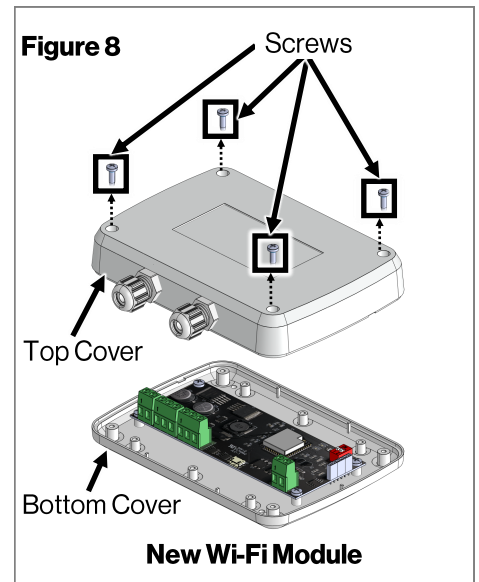
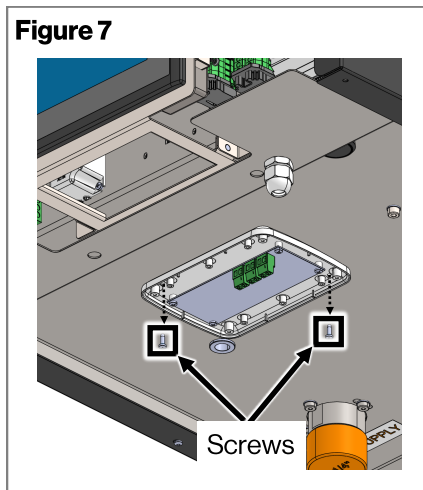
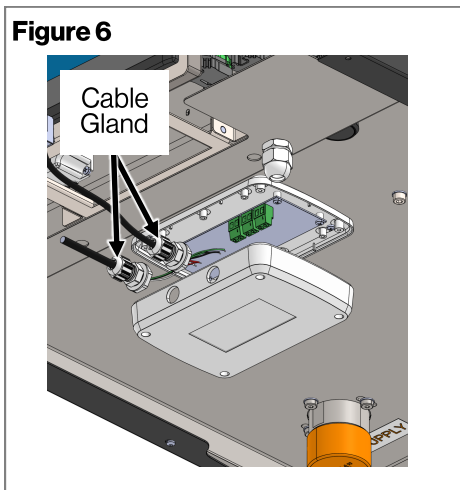
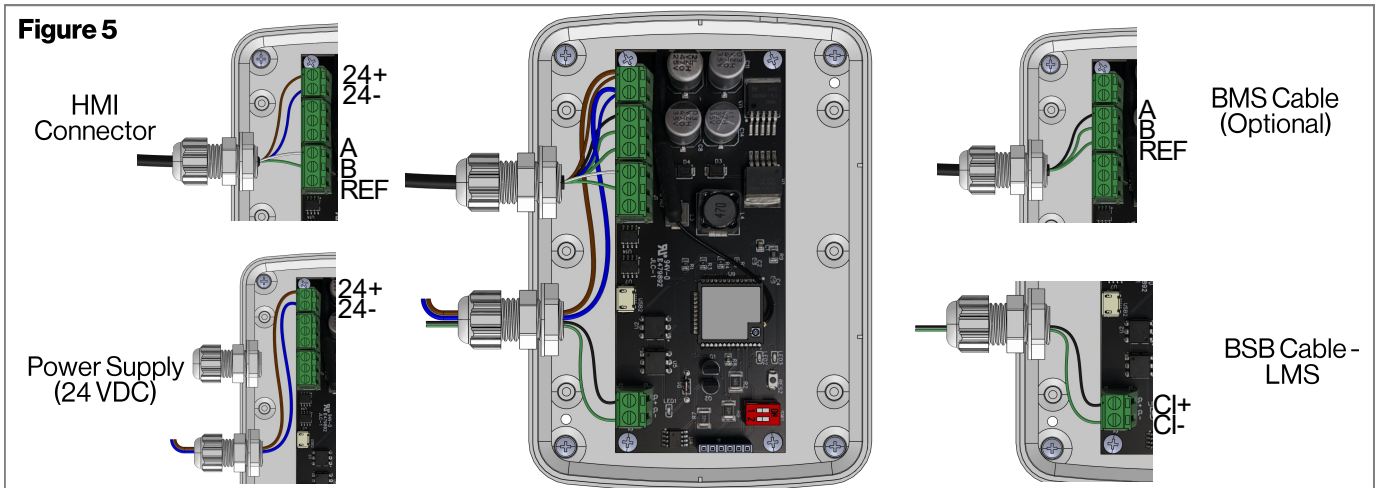

Wi-Fi Reassembly

1. Remove four screws to take off top cover of new Wi-Fi module. Ensure that new PCB is already mounted in the new Wi-Fi module (Figure 8).
2. Attach the new bottom cover with PCB to the unit using two screws (Figure 7).
3. Pass HMI and LMS/PS connectors through cable glands to the Wi-fi PCB and connect wires*. Mount the cable glands back on Wi-Fi module (Figure 5 & 6). **Note:** If required, new HMI connector can be used.
4. Reassemble new top cover to Wi-fi module using four screws (Figure 4).
5. Reconnect HMI connector to HMI touch panel (Figure 3).
6. Reconnect and turn on 120 V power supply, water supply and gas supply.
7. Line up front panel with pins located on top of the unit and secure it using two screws on bottom side (Figure 2A, 2B & 2C).

*Wires:

Brown	24+
Blue	24-
Black	A+
Green	B-
Green	G
Green/White	A+
Green	B-
Black	Cl+
Green	Cl-