

SECTION A-A

STATIC TORQUE RECOMMENDATION
 25-43 in-lbs
 THIS REQUIREMENT MAY VARY DEPENDING
 UPON BOTTLE MATERIAL, NECK FINISH, AND
 CAPPING EQUIPMENT

THREAD DETAIL INFORMATION
 6 THREADS PER INCH, 0.167 PITCH

REFERENCE	TOLERANCE	DIMENSION	UNITS
E	±0.010 [0.25]	2.382 [60.50]	in [mm]
T	±0.010 [0.25]	2.451 [62.26]	in [mm]
H	±0.010 [0.25]	0.622 [15.8]	in [mm]
OAH	±0.015 [0.38]	0.782 [19.86]	in [mm]
OD	±0.015 [0.38]	2.585 [65.66]	in [mm]
PART WEIGHT	± 0.2	11.1	g
OPENING FORCE FULL POUR	± 2.0	5.00	lbf
OPENING FORCE SIFT	± 2.0	4.50	lbf

DISCLAIMER

This specification does not relieve the customer of their ultimate responsibility for the determination of the appropriate container. It is the customer's responsibility to select the appropriate packaging based upon all information at their disposal including the specific application, regulatory compliance, product compatibility and shipping requirements. WE HEREBY DISCLAIM AND EXCLUDE ANY EXPRESS OR IMPLIED WARRANTIES, INCLUDING WITHOUT LIMITATION THE IMPLIED WARRANTIES OF MERCHANTABILITY AND FITNESS FOR A PARTICULAR PURPOSE.

DISTRIBUTED BY:



REF NO.:

DWG32007

DESCRIPTION:

63-485 PP Dual Flapper Cap, .300 Sift/Spoon

CRITICAL FOR ORIENTATION
 0.001"=2° IN ROTATION
 S' .190
 [4.82]

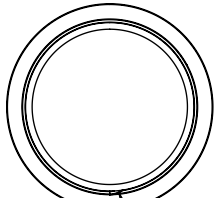

START THREAD

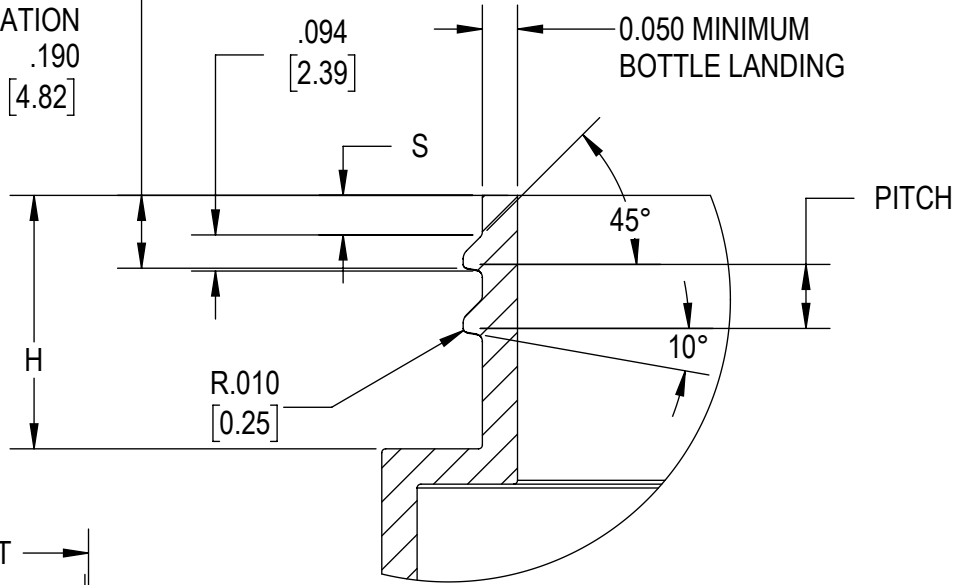

DETAIL H
 SCALE 2 : 1

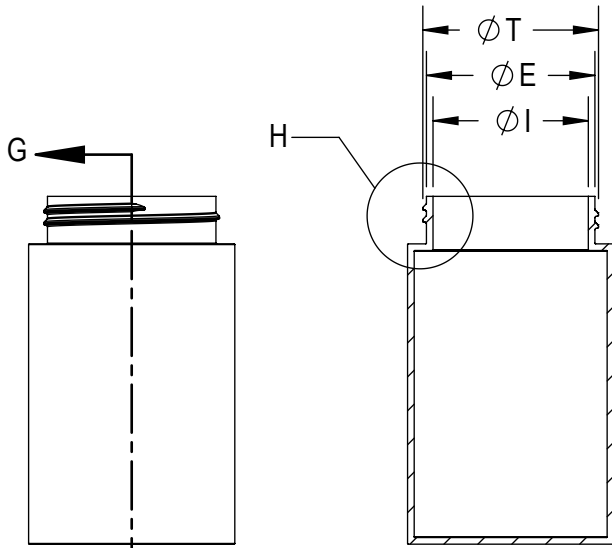

SECTION G-G

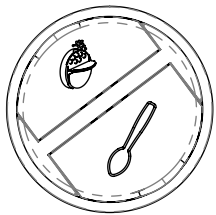

REFERENCE	TOLERANCE	UNITS	DIMENSION
E	±0.015 [0.38]	in [mm]	2.340 [59.44]
T	±0.015 [0.38]	in [mm]	2.440 [61.98]
I	MINIMUM	in [mm]	1.972 [50.09]
S	±0.007 [0.18]	in [mm]	0.103 [2.62]
H	MINIMUM	in [mm]	0.660 [16.76]
PITCH		in [mm]	0.167
TPI			6

DISCLAIMER

This specification does not relieve the customer of their ultimate responsibility for the determination of the appropriate container. It is the customer's responsibility to select the appropriate packaging based upon all information at their disposal including the specific application, regulatory compliance, product compatibility and shipping requirements. WE HEREBY DISCLAIM AND EXCLUDE ANY EXPRESS OR IMPLIED WARRANTIES, INCLUDING WITHOUT LIMITATION THE IMPLIED WARRANTIES OF MERCHANTABILITY AND FITNESS FOR A PARTICULAR PURPOSE.

DISTRIBUTED BY:



REF NO.:

DWG32007

DESCRIPTION:

63-485 PP Dual Flapper Cap, .300 Sift/Spoon