

BEFORE YOU BEGIN

This vinyl bead is intended to fill the gap between the bath rim and the finished wall material on apronless bath installations. You **must** apply a continuous bead of high-quality silicone sealant, as illustrated, to obtain a watertight seal.

There is enough vinyl bead supplied for any Kohler apronless bath. Some cutting will be required. The installation kit contains a vinyl bead and a length of pressure-sensitive tape.

Apply the vinyl bead to the bath rim before installing the bath.

CAUTION: Risk of improper installation. Do not apply the vinyl bead or pressure-sensitive tape in temperatures below 40° F (4° C).

INSTALLATION

Thoroughly clean the bath rim. Temporarily position the vinyl bead around the bath rim as illustrated. Trim excess tape material from the bath corner areas to form a miter joint. **Do not cut totally through the bead when mitering the corners. Some tiling beads may require trimming of the bottom edge for proper fit.**

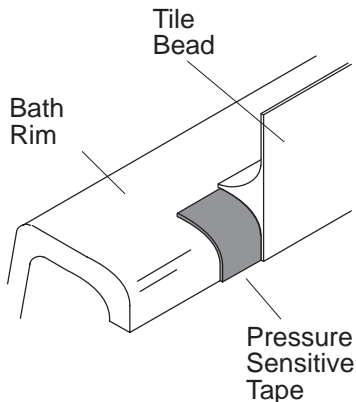

Apply the length of pressure-sensitive tape to the bath rim 3/4" (1.9cm) in from the rim edge. For the K-1181, apply the pressure-sensitive tape 2" (5cm) from the rim edge. Use the bottom edge of the rim as a guide. Do not remove the paper backing at this time. Cut away any excess pressure-sensitive tape from the corners to form a miter joint. Remove the paper backing.

Start the vinyl bead 3/4" (1.9cm) in from the end of the rim. Position the vinyl bead properly on the bath, as illustrated. Press the vinyl bead firmly against the pressure-sensitive tape. Repeat the procedure while working toward the opposite end of the bath.

When the vinyl bead is in place, firmly press the vinyl bead in place with the heel of your hand to ensure proper adhesion.

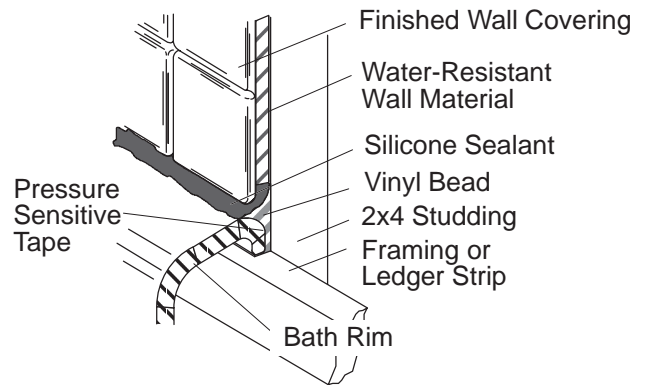

The bath is now ready for installation, leveling, framing, and the application of wall materials. Apply a continuous bead of high-quality silicone sealant between the bath rim and the edge of the finished wall. The silicone sealant must completely cover the vinyl bead to ensure a watertight seal. Wipe away any excess sealant, and fill any voids.