

CONNECT Case Assembly

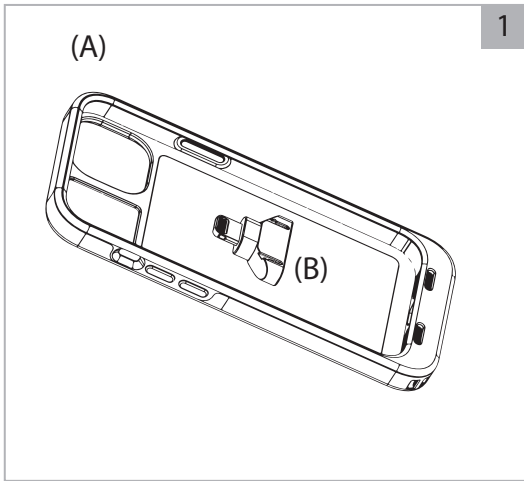

Remove the Phone Case (A) from packaging and remove the Lightning Dongle (B) from its packaging and set aside.



Insert iPhone into the Phone Case inserting the bottom of the phone first then pressing down into the top of the Case.

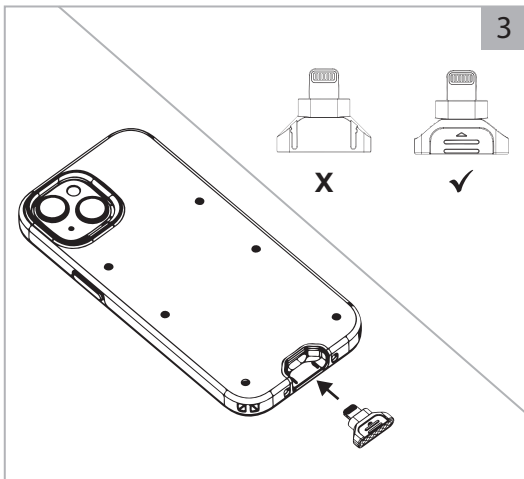

Rotate the case face down and insert the Lightning Dongle (B) into the bottom of the Phone Case (A) making sure to fully seat the Dongle into the Case.

NOTE: Orient the Lightning Connector with the thumbnail grooves facing up and the vertical grooves facing down.



To begin charging see the instruction guide for the IPOINT charging dock.

CONNECT Case Removal



To uninstall the iPhone first remove the Lightning Dongle by sliding it out from the bottom of the Case.



Make sure to completely remove the Lightning Dongle before attempting to remove the iPhone from the Case.

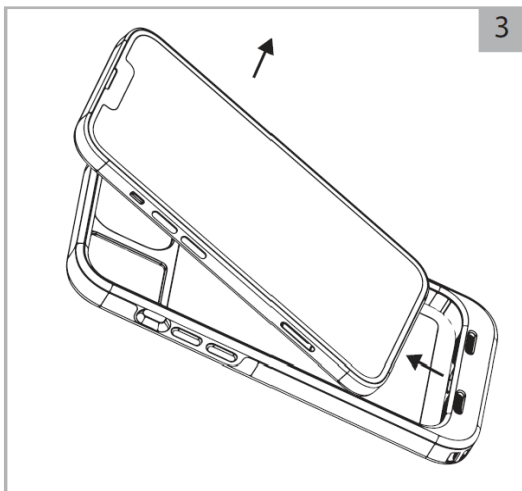

Press the top of the iPhone from behind the case outward enough to clear the edge of the case then pull the iPhone up and out of the case.