



**MERRILL**  
MANUFACTURING

**Y-1 SERIES**

# PUBLIC USE WATER SAVER.

**Y-1 Self Closing Series Specialty  
Frost-Proof Yard Hydrants**



LEARN MORE ABOUT THE BEST IN THE INDUSTRY AT [merrillmfg.com](http://merrillmfg.com)



## SPECIFICATIONS

Inlet: 3/4" NPT  
 Outlet: 3/4" No Lead Brass Hose Thread  
 Self-Closing can be locked open or closed  
 Brass Plunger with three quad ring seals  
 1" Galvanized Pipe & Galvanized Internal Pipe  
 Outlet stands 27" above ground level

### No-Lead Standard 3/4" Inlet Y-1 Self-Closing

Order Number	UPC Bar Code (Qty. 1)	Inlet & Length	Overall Length	Approx. Wt./Lbs.
Y17501	6 42367 03038 4	3/4" x 1' Bury	40.3"	13.16
Y17502	6 42367 03039 1	3/4" x 2' Bury	52.3"	15.70
Y17503	6 42367 03040 7	3/4" x 3' Bury	64.3"	18.24
Y17504	6 42367 03041 4	3/4" x 4' Bury	76.3"	20.78
Y17505	6 42367 03042 1	3/4" x 5' Bury	88.3"	23.32
Y17506	6 42367 03043 8	3/4" x 6' Bury	100.3"	25.86
Y17507	6 42367 03044 5	3/4" x 7' Bury	112.3"	28.40
Y17508	6 42367 03045 2	3/4" x 8' Bury	124.3"	30.94
Y17510	6 42367 03046 9	3/4" x 10' Bury	148.3"	33.48

### Parts List

Part Description	Part Number
Head Complete - Part No. Y-2A, Y-4, G-6, 1/8x3/8MDK	Y-1
Lock Pin	Y-2A
Roll Pin	1/8x3/8MDK
Compression Spring	Y-3
Spring Retainer	TECTM125ACUT
Countersuck Head Plug	Y-4
No Lead Hose Adapter	GNL-6
1/4" x 1/4" Socket Head Cap Screw (used before 11/1/77)	Y-7
3/8" x 5/16" Self-Locking Socket Head Cap Screw (used after 11/1/77)	Y-8
Flow Control Valve (Optional)	Y-20
3/8" Galvanized Pipe	Y-35
1" Galvanized Pipe	Y-37
Valve Body with Stainless Steel Sleeve	Y-40
Plunger with Seals	Y-41B
Quad Ring Seals (used after 11/1/78)	Y-45X
Container of Silicone Lube	A-250

### Optional Accessories List

#### Order No. Part Description

#### No-Lead Vacuum Breakers

- BVBADNL75 3/4" Hose - Automatic Drain, No-Lead
- BVBNL75M 3/4" Hose - Manual Drain, No-Lead



### Y-1 Hydrant Flow Rates

Water System Pressure	Gallons Per Minute (GPM)						
	0	5	10	15	20	25	30
20 PSI					13.6 GPM @ 20 PSI		
30 PSI					15.2 GPM @ 30 PSI		
40 PSI					18.8 GPM @ 40 PSI		
60 PSI					23 GPM @ 60 PSI		

**NOTE:** Most common 1/2 hp submersible pumps output is 10GPM.

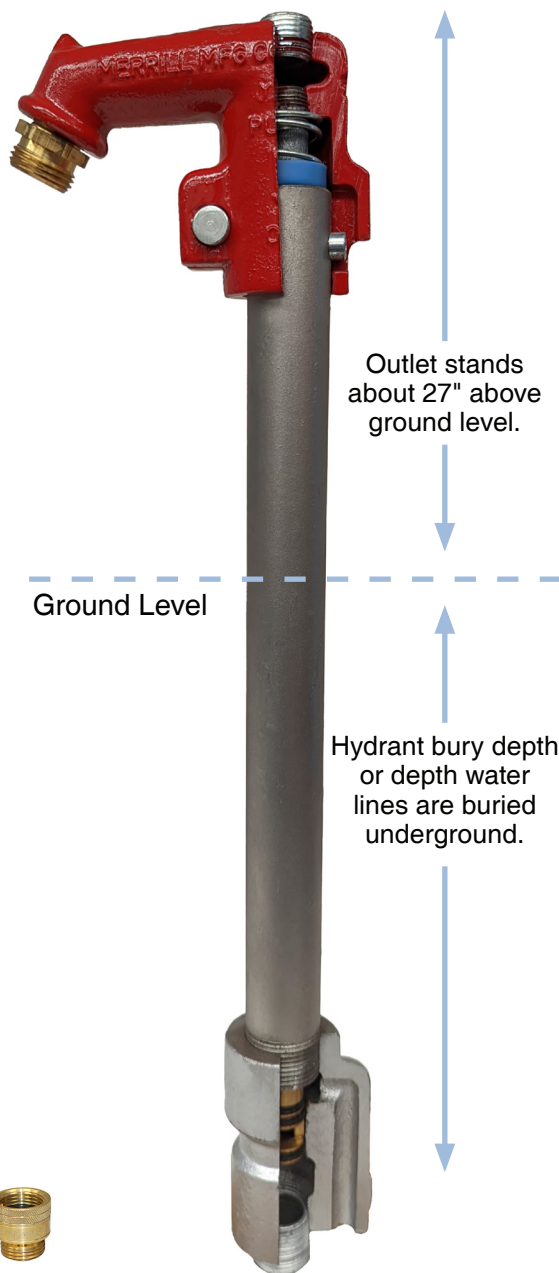

## FEATURES AND BENEFITS

- A Part Number: Y-1**  
Heavy-duty, thick-walled head casting
- B Part Number: Y-2A**  
Lock pin, simply push lock button to lock hydrant open or closed.
- C Part Number: 1/8x3/8MDK**  
Roll pin
- D Part Number: Y-3**  
Stainless steel compression spring and water pressure shuts off water so it's not wasted.
- E Part Number: TECTM125ACUT**  
Spring retainer
- F Part Number: Y-4**  
Countersuck
- G Part Number: GNL-6**  
Heavy-duty no lead brass hose adapter for standard 3/4" hose coupling ensures the perfect fit.
- H Part Number: Y-7**  
Manufactured after 11/1/77, 1/4" x 1/4" socket head cap screw provides strong hold for hydrant head to pipe.
- I Part Number: Y-8**  
Manufactured after 11/1/77, 3/8" x 5/16" self-locking socket head cap screw provides strong hold for hydrant head to pipe.
- J Part Number: Y-20**  
Standard hydrant sold without flow control valve. To install simply remove top plug.
- K Part Number: Y-35**  
High quality and extra heavy 3/8" inside galvanized pipe protected from corrosion.
- L Part Number: Y-37**  
High quality and extra heavy 1" galvanized pipe protected from corrosion.
- M Part Number: Y-40**  
Valve body with stainless steel sleeve
- N Part Number: Y-41B**  
Plunger with seals
- O Part Number: Y-45X**  
Manufactured after 11/1/78, quad ring seals.

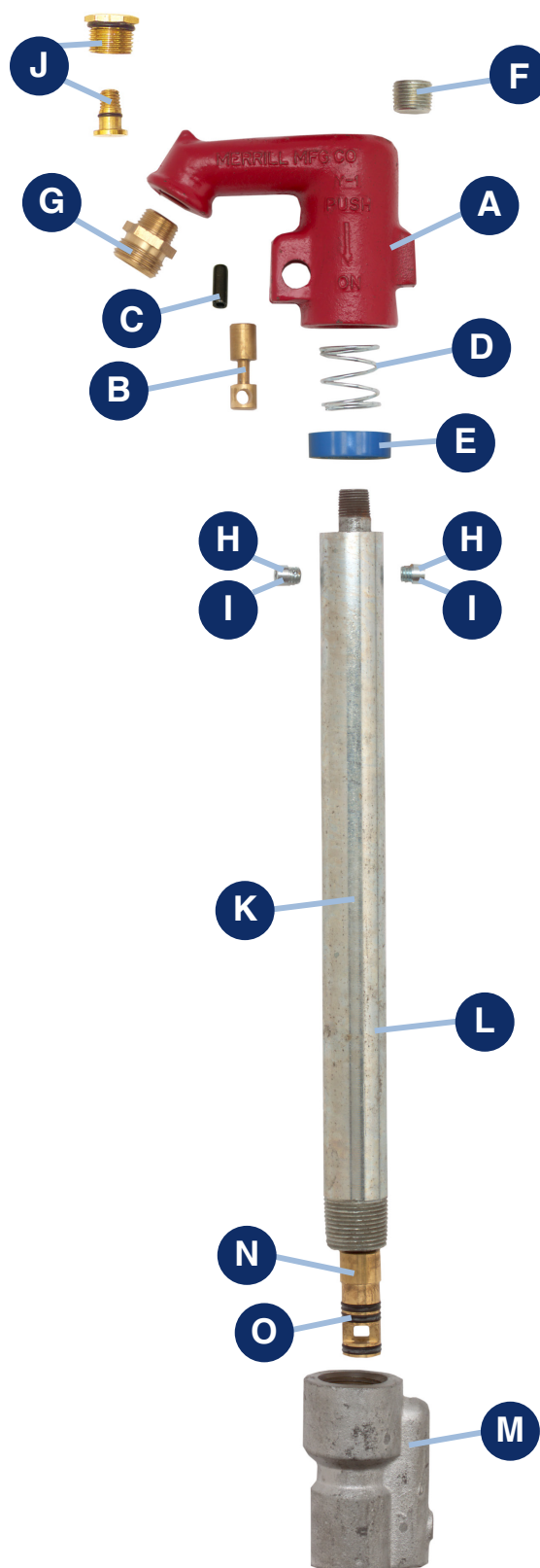

# BURY DEPTH MAP

Numbers represent the recommended bury depth in feet.

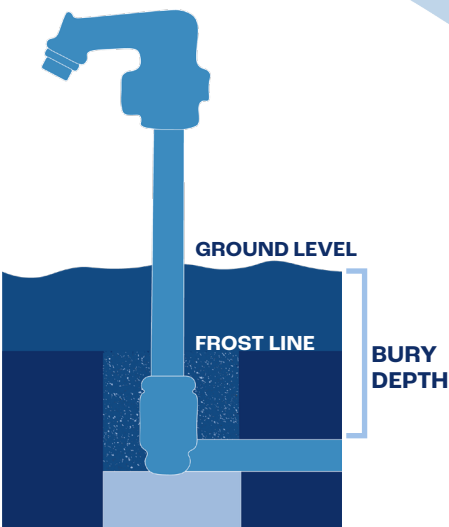
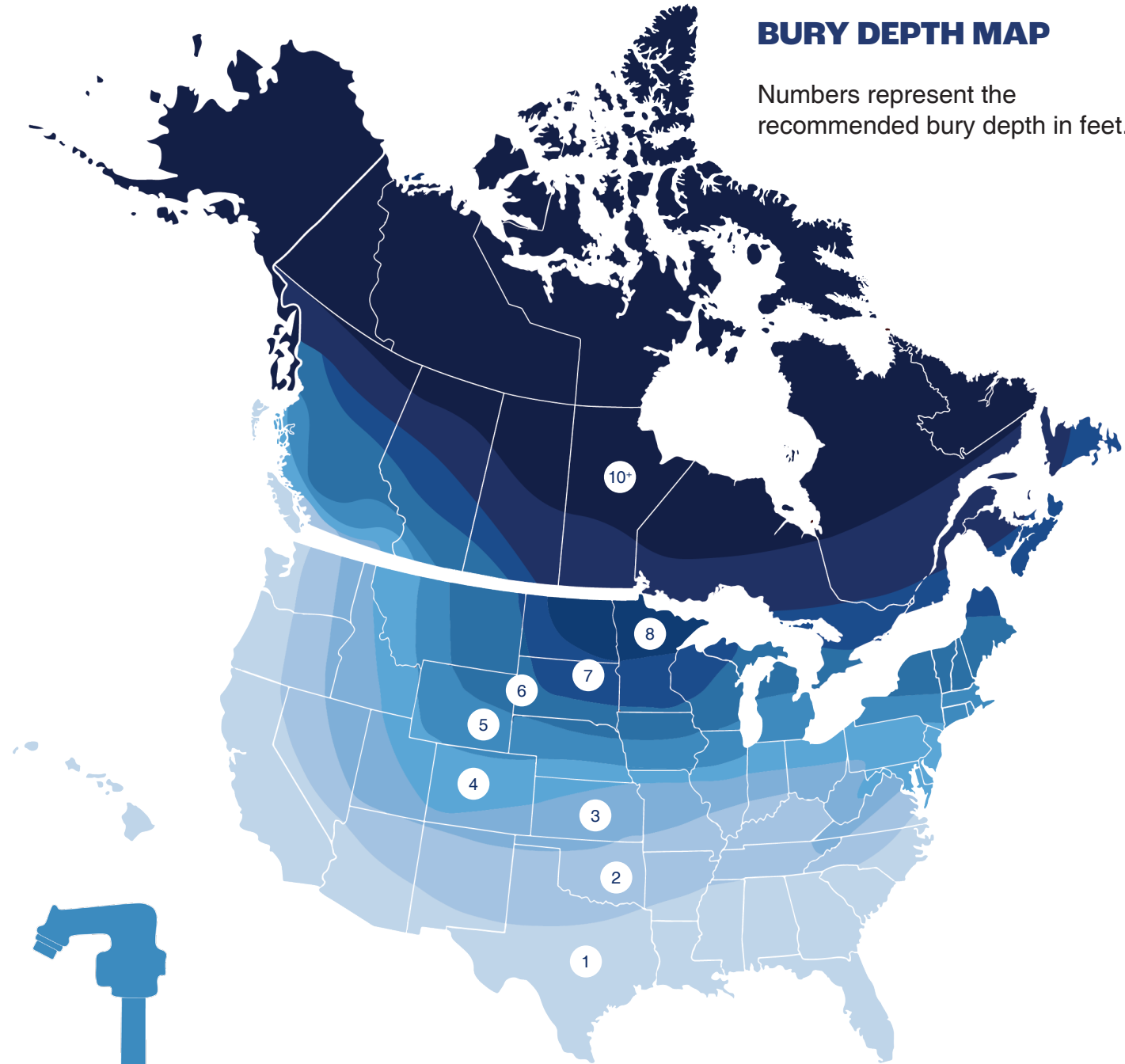

## Bury Depth Information

The frost line is simply the deepest point in the ground to which ground water will freeze. It's also referred to as the frost depth. Be sure the hydrant is installed with provision for drainage below the frost line.

Numbers represent the number of feet that is the recommended bury depth for this area. Check with your local code to ensure the right length.

