

# INSTALLATION | SHADOW RAIL CONNECTOR™ Stair

## IMPORTANT

UPPER (A) and LOWER (B) Shadow Rail Connector™ Stair assemblies look similar but are in fact *UNIQUE*. Each Stair assembly contains a *MALE* and *FEMALE* part specifically for UPPER and LOWER ends of the RAIL. Familiarize yourself with the corresponding Stair assembly and the end of the RAIL it was designed for.

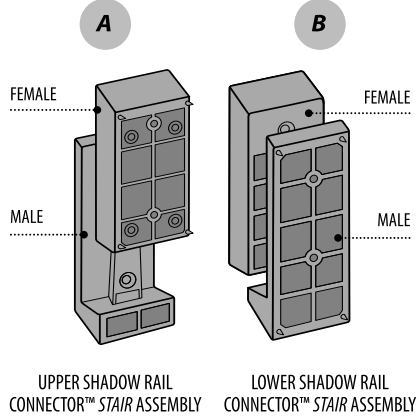

### 1 START

Dry fit the **BOTTOM RAIL** into place against the sides of posts for marking cut lines. Cut **BOTTOM RAIL** then use as template for **TOP RAIL**.

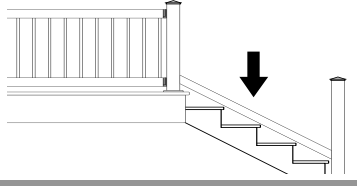

### 2

Cut 1-1/2" from *ONE SIDE ONLY* of **BOTTOM & TOP RAILS**, to allow installation space for *BOTH* Stair connector assemblies.

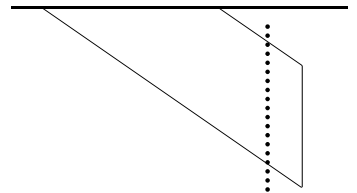

### 3

Screw the **FEMALE** connectors of **UPPER (A)** and **LOWER (B)** Stair assemblies to the ends of the **RAIL**.

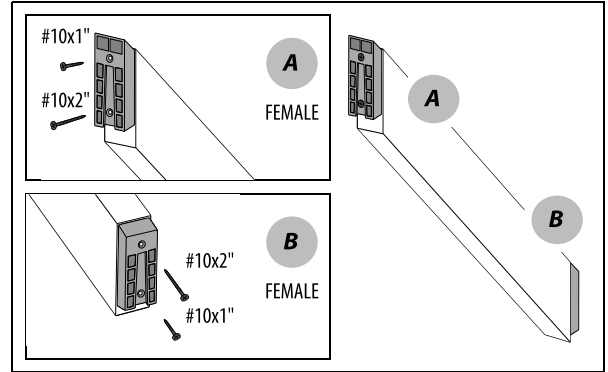

Slide **MALE** connectors into corresponding **FEMALE** connectors.

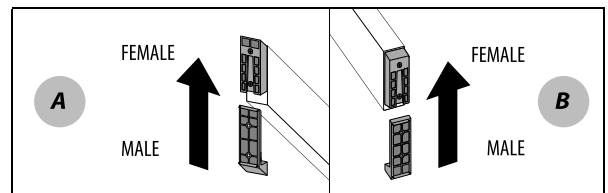

### 4

Dry fit the **BOTTOM rail** with Stair connector assemblies in place (Step 3) between posts.

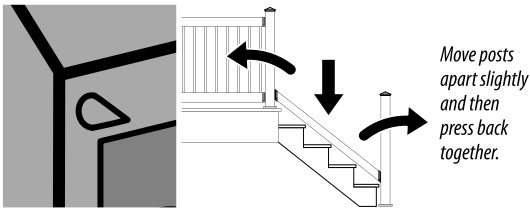

Move posts apart slightly and then press back together.

The **MALE GRIPPING CONES** will make *impression marks* into posts for relocating the **MALE** connectors.

### 5

Remove the **BOTTOM RAIL** and slide apart **MALE** connectors. Relocate and screw **MALE** connectors to posts. Impression marks from gripping cones will help. Verify the corresponding **UPPER (A)** and **LOWER (B)** **MALE** connectors.

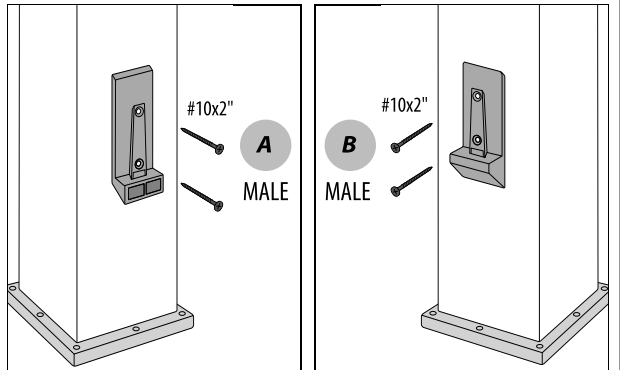

### 6

Install a baluster on each side of **BOTTOM RAIL**. Dry fit **TOP RAIL** with Stair connector assemblies in place.

Press **TOP RAIL** against posts to leave impression marks.

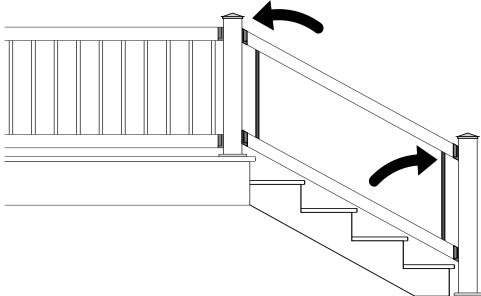

### 7

Remove the **TOP RAIL**. Install balusters. Relocate and screw **MALE** connectors to posts.

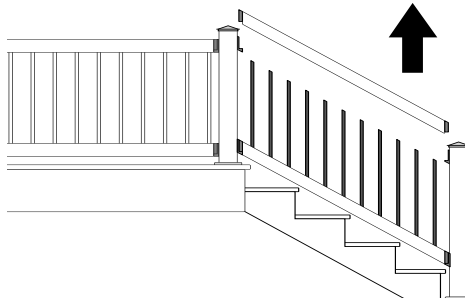

### 8

## FINISH

Slide the **TOP RAIL** into alignment with **MALE** connectors and balusters.

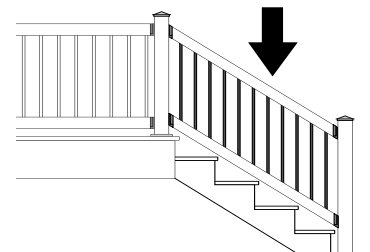

**QUESTIONS? CONTACT US AT 1-866-577-8868** IN NO EVENT SHALL TITAN BUILDING PRODUCTS BE LIABLE FOR ANY LOSS OR DAMAGE, DIRECT OR OTHERWISE, WHICH RESULTS FROM THE IMPROPER INSTALLATION OR USE OF THIS PRODUCT. IF FOR ANY REASON TITAN BUILDING PRODUCTS BECOMES LIABLE FOR LOSS OR DAMAGE, DIRECT OR OTHERWISE, THE AGGREGATE LIABILITY OF TITAN BUILDING PRODUCTS SHALL BE LIMITED TO THE RETAIL PURCHASE PRICE OF THE PRODUCTS.

T 1-866-577-8868

**TITAN BUILDING PRODUCTS**  
THE ART OF BUILDING  
More beautiful decks... Real easy.



www.titanbp.com