

Repair Kits for All Zurn ZW200 Series ACV Parts

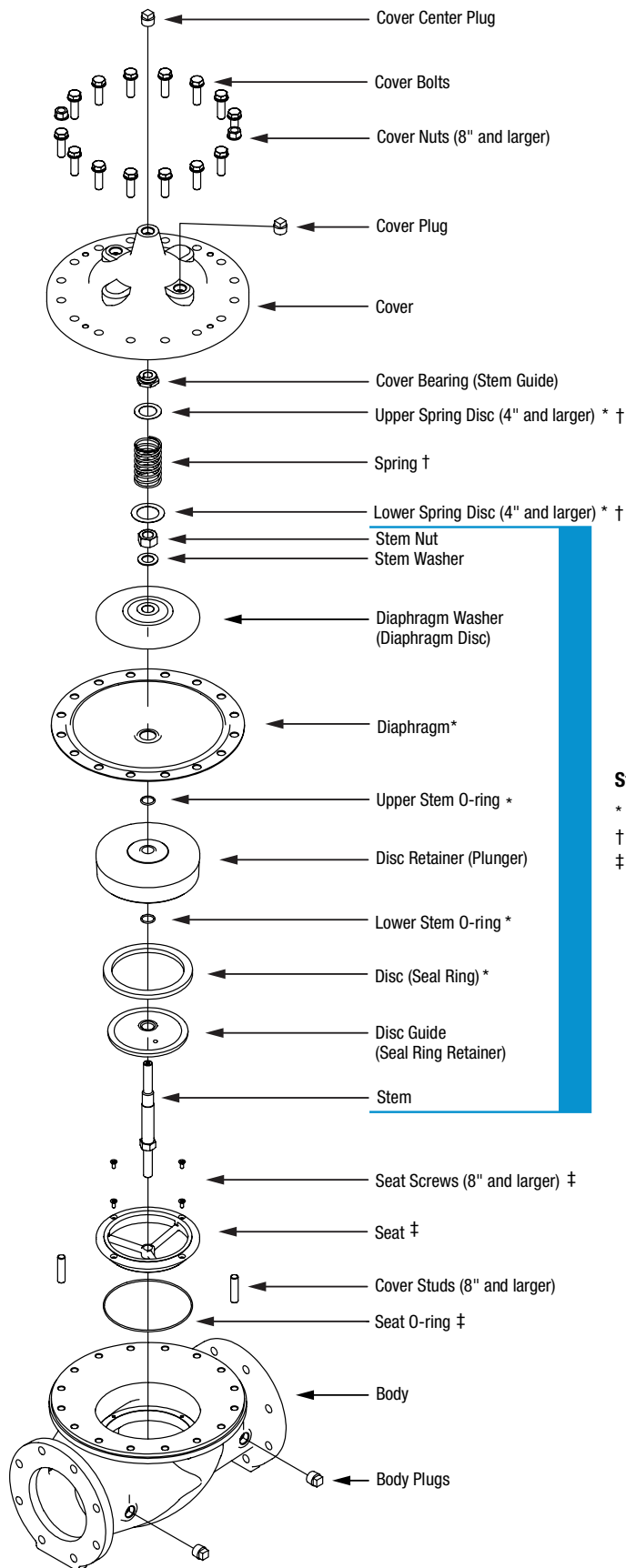

Stem Assembly †

* Rubber Repair Kit Items
 † Complete Repair Kit Items
 ‡ Seat Repair Kit

Zurn Wilkins ZW200 Series ACV Rubber Repair Kits

Rubber Repair Kit contains:
 diaphragm, stem o-rings, and disc
 (with spring discs for 4" and larger sizes)

| Size | Repair Kit Part Number |
|-----------------|------------------------|
| 1-1/4" - 1-1/2" | RK114-112-ZW200R |
| 2" | RK2-ZW200R |
| 2-1/2" | RK212-ZW200R |
| 3" | RK3-ZW200R |
| 4" | RK4-ZW200R |
| 6" | RK6-ZW200R |
| 8" | RK8-ZW200R |
| 10" | RK10-ZW200R |
| 12" | RK12-ZW200R |
| 14" | RK14-ZW200R |
| 16" | RK16-ZW200R |

Zurn Wilkins ZW200 Series ACV Complete Repair Kits

Complete Repair Kit contains:
 spring and complete stem assembly
 (with spring discs for 4" and larger sizes)

| Size | Repair Kit Part Number |
|-----------------|------------------------|
| 1-1/4" - 1-1/2" | RK114-112-ZW200C |
| 2" | RK2-ZW200C |
| 2-1/2" | RK212-ZW200C |
| 3" | RK3-ZW200C |
| 4" | RK4-ZW200C |
| 6" | RK6-ZW200C |
| 8" | RK8-ZW200C |
| 10" | RK10-ZW200C |
| 12" | RK12-ZW200C |
| 14" | RK14-ZW200C |
| 16" | RK16-ZW200C |

Zurn Wilkins ZW200 Series ACV Seat Repair Kits

Seat Repair Kit contains:
 seat and seat o-ring
 (with seat screws for 8" and larger sizes)

| Size | Repair Kit Part Number |
|----------------|------------------------|
| 1-1/4 - 1-1/2" | RK114-112-ZW200SK |
| 2" | RK2-ZW200SK |
| 2-1/2" | RK212-ZW200SK |
| 3" | RK3-ZW200SK |
| 4" | RK4-ZW200SK |
| 6" | RK6-ZW200SK |
| 8" | RK8-ZW200SK |
| 10" | RK10-ZW200SK |
| 12" | RK12-ZW200SK |
| 14" | RK14-ZW200SK |
| 16" | RK16-ZW200SK |