



Send Us a Text: 1-812-652-2525
(US and Canada Only.
Carrier Fees May Apply)



Find Us Online: www.safety1st.com
Email Us: support@djgusa.com



Give Us a Call: 1-800-544-1108
(Toll Free, US and Canada Only)



Replacement Parts List

(on select models)

- Seat Pad Set
- Removable Cup Holders
- Instructions

For parts availability and questions, call, email, text, or chat.
If requested color is not available, similar color will be substituted.
Applicable tax and shipping and handling will also be added.

Grow and Go™ 2-in-1 Belt-Positioning Booster featuring ComfortWings

Your model may look different than one shown on cover.

Read all instructions BEFORE USING this car seat.

KEEP INSTRUCTIONS FOR FUTURE USE.

⚠ Failure to follow the warnings on the labels and in the instruction manual can result in serious injury or death to your child. Serious injury may include paralysis and/or permanent brain injury.

4358-8598 08.28.24

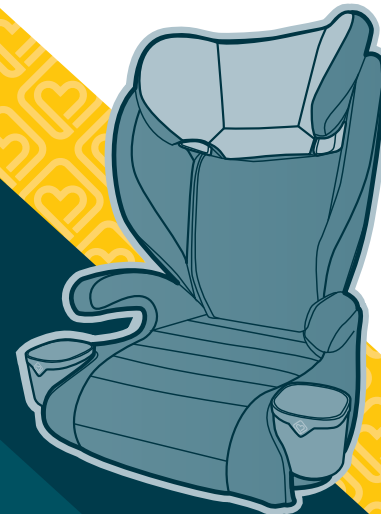

©2024 Dorel Juvenile Group, Inc. Safety 1st™ and the Safety 1st logo and design are trademarks of Dorel Juvenile Group, Inc. (800) 544-1108 www.safety1st.com. Styles, colors, and labeling may vary. Los estilos, colores y etiquetado pueden variar. Made in CHINA. Hecho en CHINA. Distributed by (distribuido por) Dorel Juvenile Group, Inc., 2525 State St., Columbus, IN 47201-7494. Dorel Juvenile Canada, 2233 Argentia Road, Suite 110, Mississauga, ON L5N 2X7. Representante exclusivo en Chile: DOREL JUVENILE CHILE S.A. Av. del Parque 4161, oficina 602 A, Huechuraba, Santiago, Chile - Fono: 56 2 24971500 - www.infanti.cl - www.dorel.cl. Importado y distribuido en Perú por: COMEXA COMERCIALIZADORA EXTRANJERA S.A. SUCURSAL DEL PERÚ - Los Libertadores 455, San Isidro, Lima 27, Lima, Perú RUC 20431062870 - Fono: 4413029 - www.infanti.com.pe. En Centro América, Caribe y Ecuador por: Best Brands Group S.A. - Av. Balboa, Bay Mall Plaza, Planta Baja, local 9, Panamá. - Fono: (507) 300 2884. En Colombia por: Baby Universe S.A.S. - Vía 40 No. 77-29, Barranquilla, Colombia - Fono: (575) 353 1110 Importador: DJGM, S.A. DE C.V. Gabriel Mancera No. 1041 Col. Del Valle, Benito Juárez C.P. 03100 México, Ciudad de México R.F.C. DJG140305GN9 Tel. (55) 67199202

Getting Started	3	Backless Booster Seat Mode	18	Safety Information	36
Parts of the Car Seat	4	Backless Booster Seat		Vehicle Belt Information	37
Accessory Use	6	Child Fit Requirements	19	Child Restraint Use	38
Choosing a Car Seat Mode	7	Backless Booster Seat		Vehicle Seating Position	39
Setting up Your Booster Seat	10	Use in Vehicle	20	Installation in Vehicle	40
Backed Booster Seat Mode	12	Removing the Backrest	23	Replacement and Expiration	41
Backed Booster Seat		Using the Backless Booster		Registration and Safety Notices ...	42
Child Fit Requirements	13	Belt-Positioning Clip	25	Warranty	43
Backed Booster		Wash and Care	29		
Seat Use in Vehicle	14	Removing the Seat Pad			
Adjusting the Headrest	17	Set for Cleaning	30		
		Cleaning the Seat Pad Set			
		and Booster Seat	33		

Getting Started

To help you get started using your child's new booster seat (also known as a car seat or a child restraint), these are the four main tasks you'll need to complete.

1**Measure Your Child.****2****Choose a booster seat mode and assemble the seat if necessary.****3****Place the booster seat in your vehicle.****4****Make any adjustments to properly fit your child and buckle up.**

Backed Booster

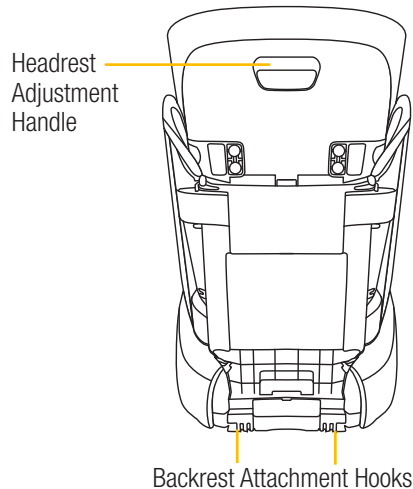
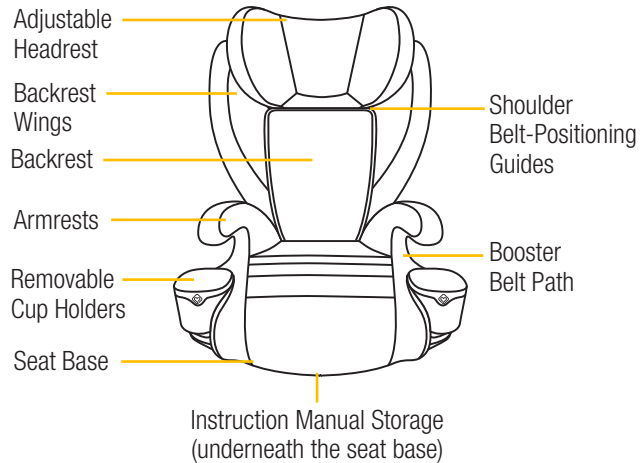

Your model may look different than one shown.

Backless Booster

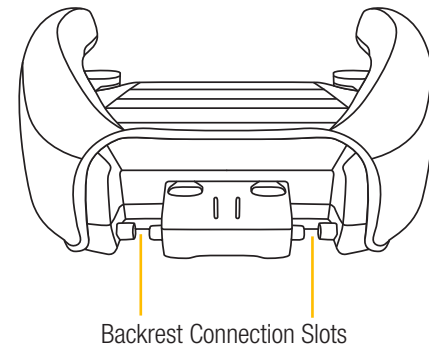
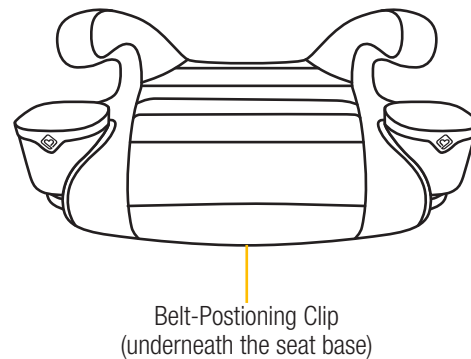

Your model may look different than one shown.

Removable Cup Holders

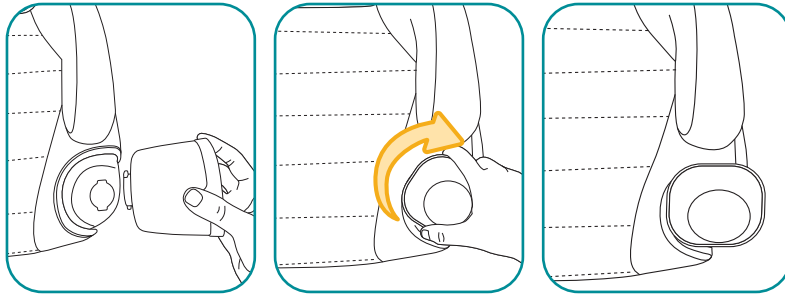

To install the cup holders: Align the bottom of the cup to the slot on the seat. Twist the cup holder clockwise until it clicks into place. Repeat on the other side.

To remove the cup holders: Twist the cup holder counterclockwise and pull it out of the slot in the seat. Repeat on the other side.

The cup holders are top-rack dishwasher safe.

! WARNING

Failure to follow these instructions may result in serious injury or death to your child. Serious injury can include paralysis and/or permanent brain injury.

Be certain to measure your child's weight and height (do not guess) before choosing this car seat's mode.

Your child's height, weight, and age determine how the car seat should be placed in the vehicle.

Children vary widely in body size, shape, and temperament—**please consult your doctor before switching between any modes within the limits and fit requirements of the car seat.**

School-Aged Children

Children can only use a belt-positioning booster car seat once they outgrow forward-facing harness weight or height limits. Children must use the belt-positioning booster mode until the vehicle's lap and shoulder seat belt fit them properly without the belt-positioning booster.

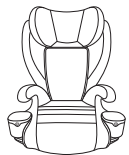

BACKED BOOSTER SEAT MODE

40–100 lb (18.4–45.4 kg) **and**
43.4–57 in. (110.1–144.8 cm)

In this car seat, your child can use the Booster Seat mode until they fit the vehicle's lap and shoulder seat belt properly without a Booster Seat **OR** outgrow any one of the above.

Backed Booster Seat Child Fit Requirements PAGE 13

Backed Booster Seat Use in Vehicle PAGE 14

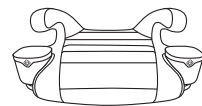

BACKLESS BOOSTER SEAT MODE

40–100 lb (18.4–45.4 kg) **and**
43.4–57 in. (110.1–144.8 cm)

In this car seat, your child can use the Booster Seat mode until they fit the vehicle's lap and shoulder seat belt properly without a Booster Seat **OR** outgrow any one of the above.

Backless Booster Seat Child Fit Requirements PAGE 19

Backless Booster Seat Use in Vehicle PAGE 20

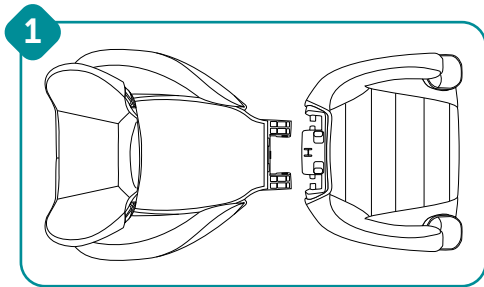

Lay the backrest flat oriented as shown.

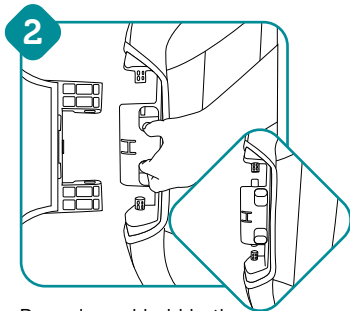

Press in and hold both sides of the center button to retract the inner pegs in the backrest connection slots.

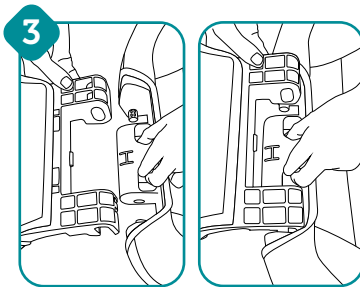

Continue pressing both sides of the button with one hand and lift up the bottom of the backrest with the other. Align the open sides of the hooks over the outer pegs in the connection slots.

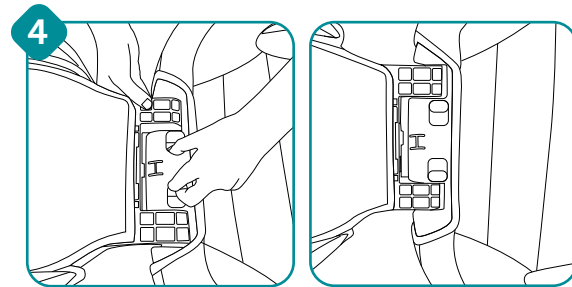

Push the hooks down over the outer pegs and then let go of both sides of the button to release the inner pegs and secure the backrest to the seat base.

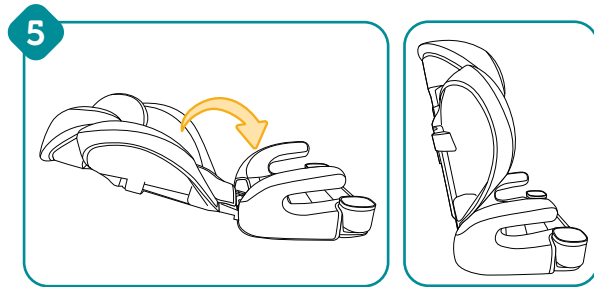

Lift the backrest all the way up until it clicks into the upright position and install the two cup holders (see Accessory Use on page 6).



40–100 lb (18.4–45.4 kg) and 43.4–57 in. (110.1–144.8 cm)

In this car seat, your child can use the Booster Seat mode until they fit the vehicle's lap and shoulder seat belt properly without a Booster Seat **OR** outgrow any of the following:

- Weight limit: 100 lb (45.4 kg); **OR**
- Height limit: 57 in. (144.8 cm); **OR**
- Backed Booster Seat Child Fit Requirements PAGE 13**

Backed Booster Seat Use in Vehicle PAGE 14

⚠ WARNING

Warning! Use **ONLY** the vehicle's lap and shoulder belt system when restraining the child in this booster seat.



DO NOT use only the lap belt when using this seat as a booster seat. The shoulder belt **MUST** always be adjusted snugly across the child's chest.

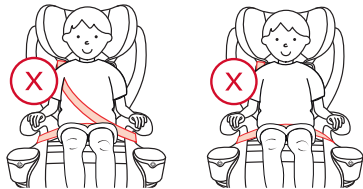

NEVER place shoulder belt under the child's arms or behind their back.

DO NOT use this booster seat if the top of your child's ears are above the top of the booster seat's headrest.

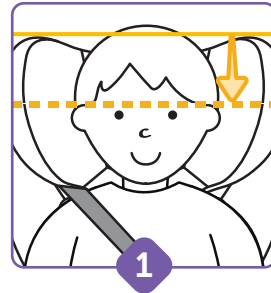

1 Check the head position

The top of your child's ears should **NEVER be above** the top of the booster seat's headrest. Adjust the headrest if needed (see page 17).

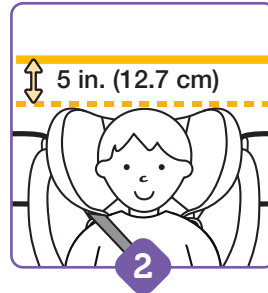

2 Check the car position

DO NOT use the booster seat if your child's head is less than 5 in. (12.7 cm) below the roof of the car.



3 Check the shoulder belt position

The shoulder belt should lay snugly across the center of your child's shoulder and across their chest.



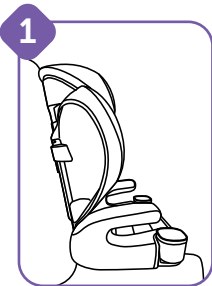

4 Check the lap belt position

The lap belt should lay snugly across your child's hips, **NOT on their stomach.**

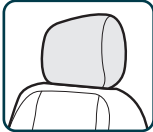

Place the booster seat forward-facing in the vehicle

The vehicle seatback **MUST** be in the upright position, but you can adjust the angle slightly to better match the angle of the booster seat. Refer to the vehicle owner's manual for how to adjust the vehicle seatback.



If your vehicle has a headrest that interferes with a flush booster seat fit, refer to your vehicle owner's manual to check whether it can be removed or adjusted, or if there are other seating locations to install the booster seat.

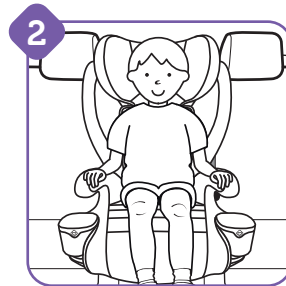

Have your child sit in the booster seat

The top of your child's ears should never be above the top of the booster seat's headrest.

DO NOT use the booster seat if your child's head is less than 5 in. (12.7 cm) below the roof of the car.

To adjust the headrest, see page 17.

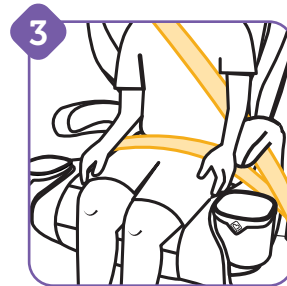

Position the lap belt on your child

Route the lap belt portion of the vehicle belt under both armrests.

The shoulder belt **MUST GO UNDER** the armrest on the vehicle buckle side.

The lap belt should lay snugly across your child's hips, not on their stomach.

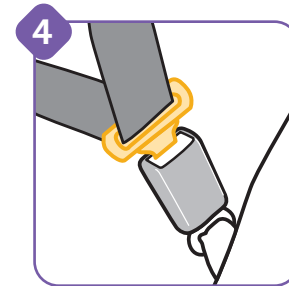

Buckle the vehicle belt

Pull the shoulder belt up to tighten it. Consult your vehicle owner's manual for proper seat belt usage.

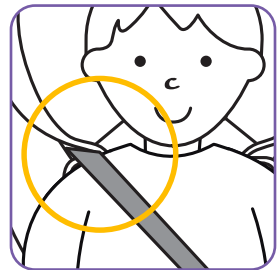
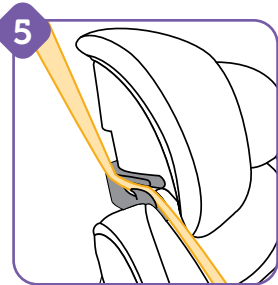

Position the shoulder belt on your child

Thread the shoulder belt through the belt-positioning guide in the headrest.

Pull the shoulder belt up to tighten it so that it lies snugly across the center of your child's shoulder and across their chest, not on their face and neck.

FINISH!

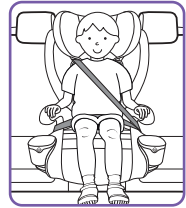

Check periodically to make sure your child has not moved out of position and loosened the shoulder belt.

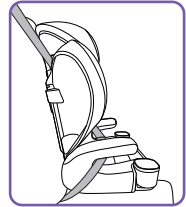

Keep the booster seat securely belted and buckled even when unoccupied.

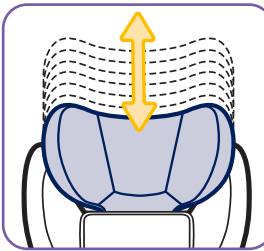
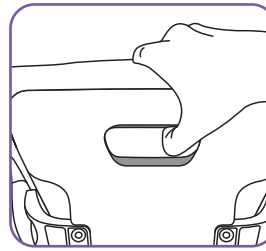

Squeeze the headrest adjustment handle and raise the headrest to the desired position. As the headrest is raised, the backrest wings expand.

The headrest has seven height positions. Choose the one that meets the fit requirements on page 13.

Make sure the handle is in the correct position to lock the headrest at the chosen height.

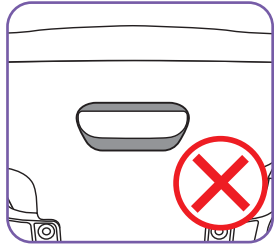
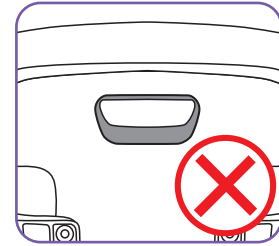
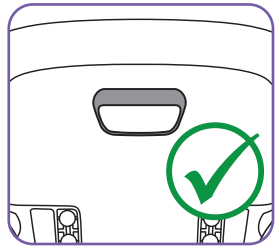

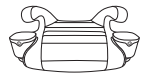

**40–100 lb (18.4–45.4 kg) and
43.4–57 in. (110.1–144.8 cm)**

In this car seat, your child can use the Booster Seat mode until they fit the vehicle's lap and shoulder seat belt properly without a Booster Seat **OR** outgrow any of the following:

- Weight limit: 100 lb (45.4 kg); **OR**
- Height limit: 57 in. (144.8 cm); **OR**
- Backless Booster Seat Child Fit Requirements PAGE 19**

**Backless Booster Seat Use in Vehicle
PAGE 20**

WARNING

Warning! Use **ONLY** the vehicle's lap and shoulder belt system when restraining the child in this booster seat.

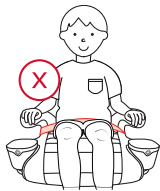

DO NOT use only the lap belt when using this seat as a booster seat. The shoulder belt **MUST** always be adjusted snugly across the child's chest.

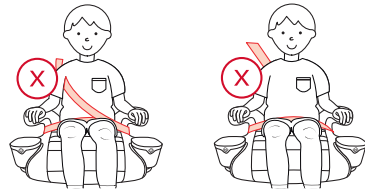

NEVER place shoulder belt under the child's arms or behind their back.

DO NOT use this booster seat if the top of your child's ears are above the top of the booster seat's headrest.

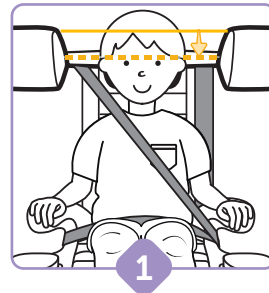

Check the head position

The top of your child's ears should **NEVER be above** the top of the vehicle seat's headrest.

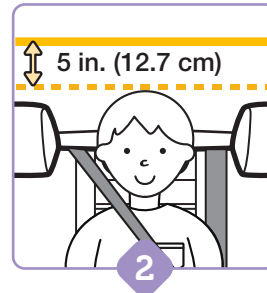

Check the car position

DO NOT use the booster seat if your child's head is less than 5 in. (12.7 cm) below the roof of the car.



Check the shoulder belt position

The shoulder belt should lay snugly across the center of your child's shoulder and across their chest, not on their face and neck.



Check the lap belt position

The lap belt should lay snugly across your child's hips, **NOT on their stomach.**

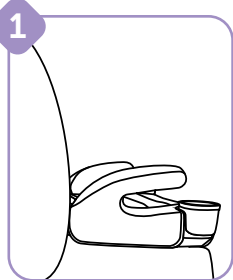

Place the backless booster seat forward-facing in the vehicle

Center the booster seat on the chosen vehicle seat. The vehicle seatback **MUST** be upright. The back of the booster seat should be flat against the vehicle seatback.



Have your child sit in the booster seat

Their back should sit flat against the vehicle seatback and their bottom flat against the booster seat base.

The top of your child's ears should never be above the top of the vehicle seat's headrest.

DO NOT use the booster seat if your child's head is less than 5 in. (12.7 cm) below the roof of the car.

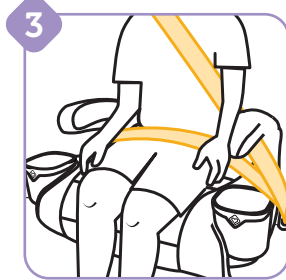

Position the lap belt on your child

Route the lap belt portion of the vehicle belt under both armrests.

The shoulder belt **MUST GO UNDER** the armrest on the vehicle buckle side.

The lap belt should lay snugly across your child's hips, not on their stomach.

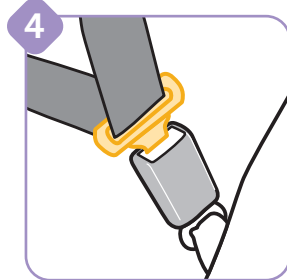

Buckle the vehicle belt

Pull the shoulder belt up to tighten it. Consult your vehicle owner's manual for proper seat belt usage.

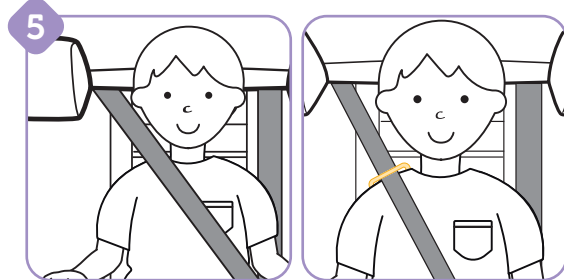

Position the shoulder belt on your child

Pull the shoulder belt up to tighten it so that it lies snugly across the center of your child's shoulder and across their chest, not on their face and neck.

Use the belt-positioning clip only if necessary to help position the shoulder belt correctly on your child.



To remove the backrest, see page 23.



i
To use the backless booster belt-positioning clip, see page 25.

! WARNING
By the nature of the design, backless booster car seats do not have a back or headrest. These types of booster car seats help position the vehicle belt across the body. Any additional protection of the body or head is dependent on the protection systems of your vehicle. Please consider this when choosing where this booster will be used in your vehicle and always consult your vehicle owner's manual.

FINISH!

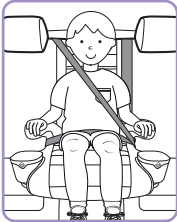
Check periodically to make sure your child has not moved out of position and loosened the shoulder belt.

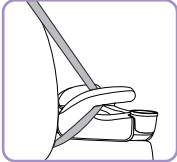
Keep the booster seat securely belted and buckled even when unoccupied.

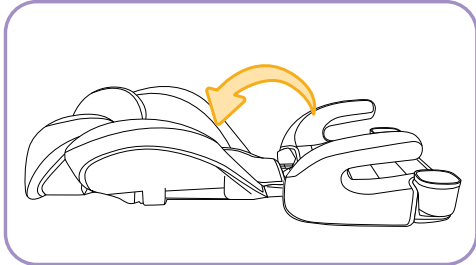
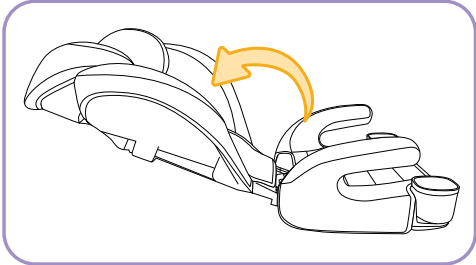
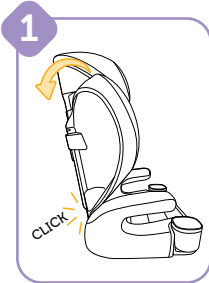

Push the backrest down so that it clicks. Continue pushing the backrest down from the upright position until it lays flat.

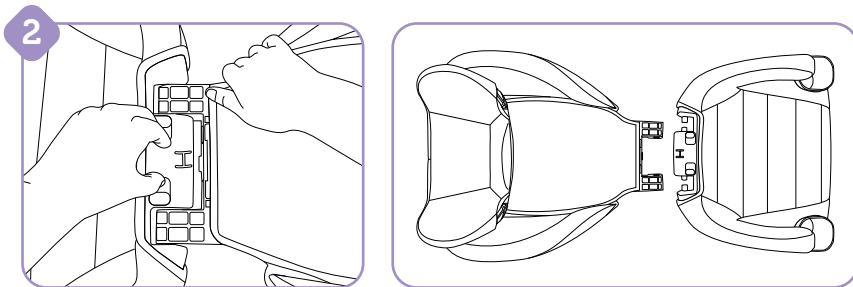

Press in and hold both sides of the center button while lifting the backrest up to separate it from the seat base.

Once the backrest is fully separated, let go of the center button.

i

The belt-positioning clip can only be used with a backless booster. See page 23 for how to remove the backrest.

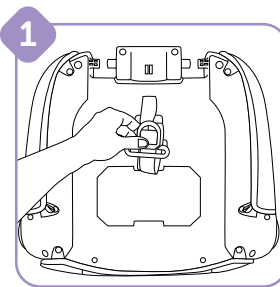

Turn the backless booster over to access the belt-positioning clip. Pull the clip out from its storage compartment.

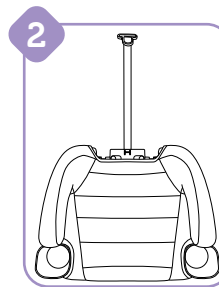

Turn the backless booster over again with the belt-positioning clip fully extended from underneath the seat.

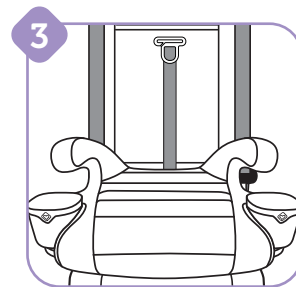

Place the backless booster in the vehicle so that the strap is accessible against the vehicle seatback.

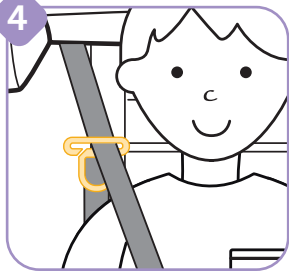

Have your child sit in the booster seat. Attach the belt-positioning clip to the vehicle shoulder belt. Buckle the shoulder belt. See Backless Booster Seat Use in Vehicle on pages 20–22.

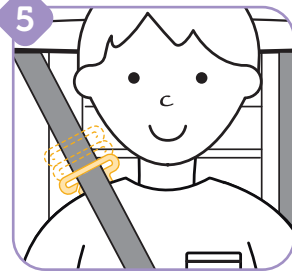

Pull the belt-positioning clip straight up to the top of your child's shoulder. Adjust the length of the strap if necessary (see the next page).



The top of your child's shoulder must be even with the bottom of the belt-positioning clip as shown.

i

Check the length of the belt-positioning clip strap often as your child grows. Adjust the strap as needed (see the next page).

The belt-positioning clip **MUST** be stored before installing the backrest for backed booster seat use (see page 28).

Adjusting the Length of the Belt-Positioning Clip Strap

To lengthen the strap:

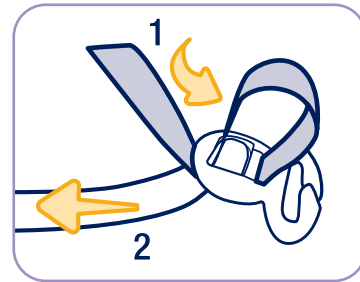

Push the free end of the strap (1) into the clip. Pull on the opposite end of the strap (2) to remove the slack.

To shorten the strap:

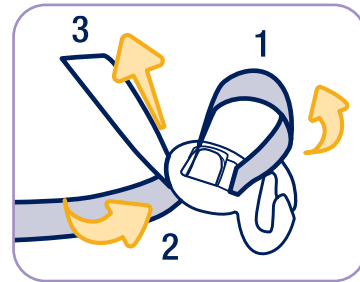

From the top of the clip, make a loop in the strap (1). Push the strap into the clip (2). Pull on the free end of the strap (3) to remove the loop.

Storing the Belt-Positioning Clip

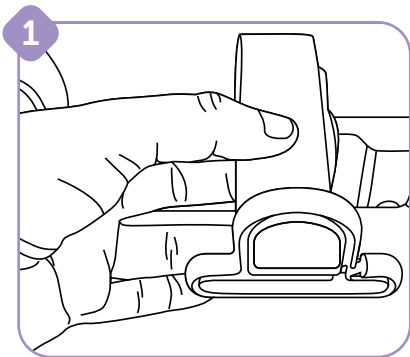

Turn the booster seat over and fold the belt-positioning clip strap so that it is compact enough to fit into the storage compartment.

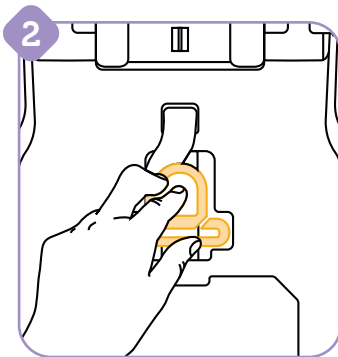

Insert the folded strap into the storage compartment and push the clip into place. Make sure the strap is completely tucked into the compartment for the clip to snap into place correctly.

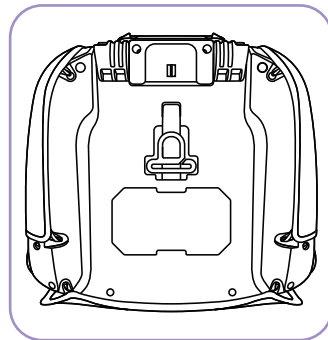

Wash & Care

Use the following sections to help you clean and care for your booster seat.

1

Removing the Seat Pad Set for Cleaning

2

Cleaning the Seat Pad Set and Booster Seat

3

Installing the Seat Pad Set



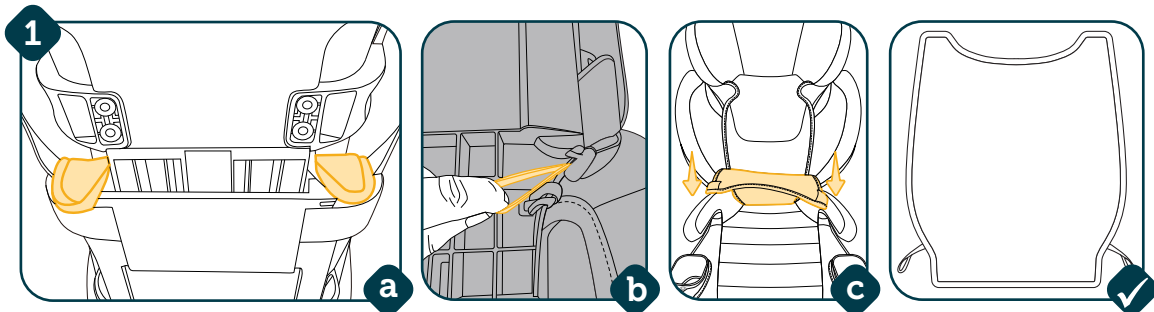

1. Remove the backrest pad.

- a. On the back of the seat just below the headrest, unfasten the two elastic straps connecting the top of the backrest pad to the seat.
- b. On the back of the seat near where the backrest meets the seat base, unfasten the two elastic straps connecting the bottom of the backrest pad to the seat. Note that the elastic straps for the backrest wings are fastened to the same tabs.
- c. Turn the seat around and gently pull the backrest pad away from the front of the seat.

 You may need to raise or lower the headrest for easier seat pad set removal. See Adjusting the Headrest on page 17.

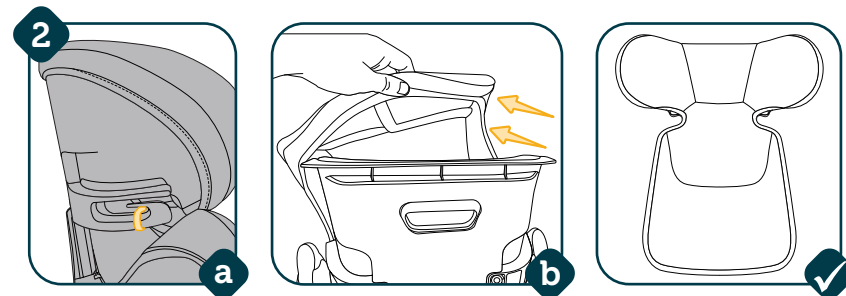

2. Remove the headrest pad.

- a. Unfasten the two elastic straps connecting the sides of the headrest pad to the seat.
- b. Gently pull off the headrest from the seat.

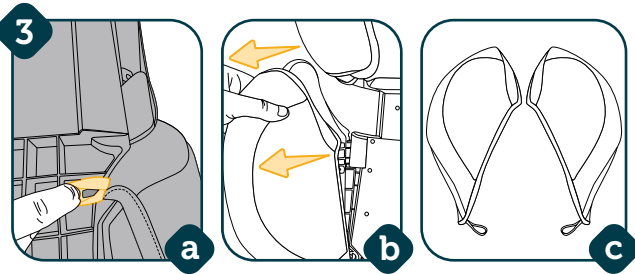

- 3. Remove the backrest wing pads.**
- a. Unfasten the elastic strap connecting the backrest wing pad to the seat.
 - b. Gently pull off the backrest wing pad from the seat.
 - c. Repeat with the other wing.

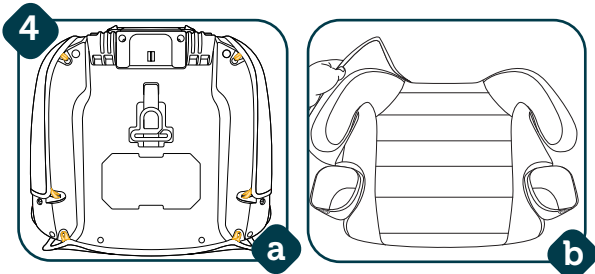

- 4. Remove the seat base pad.**
- a. Unfasten the elastic straps from the bottom of the seat base.
 - b. Gently pull the pad from the seat base.

To clean the seat pad set:

You **MUST** turn the seat pad set inside out before machine washing. Machine wash separately with cold water on gentle cycle. **DO NOT** use bleach. Tumble dry separately for 10–12 minutes on low heat. Remove immediately.

To clean the booster seat:

Spot clean using warm sudsy water and a damp cloth. **DO NOT** submerge any part of the seat in water.

To install the seat pad set:

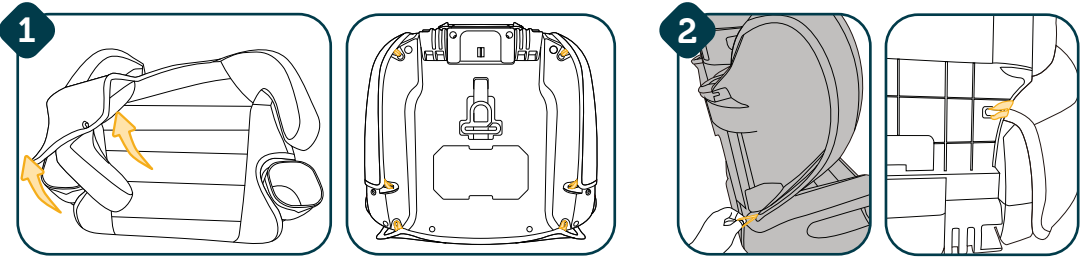

From the front of the seat, pull the seat pad onto the seat base and over the armrests. Fasten the elastic straps on the bottom of the base.

Pull the backrest wing pads onto the two wings. Pull the elastic straps on the bottom of each wing through to fasten them on the tabs on the back of the seat.



You may need to raise or lower the headrest for easier installation of the seat pad set. See Adjusting the Headrest on page 17.

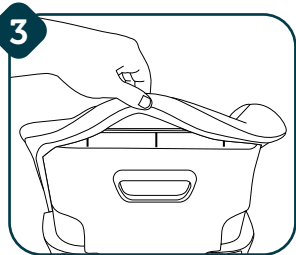

Pull the headrest pad onto the headrest making sure it is fully secure. Fasten the elastic straps onto the belt-positioning guides.

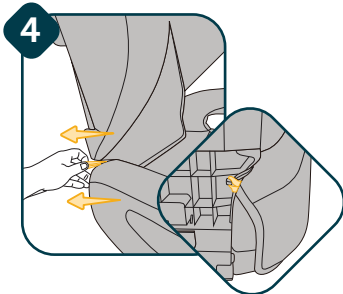
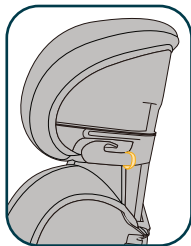

Pull the elastic straps at the bottom of the backrest through to the back and attach them to the tabs on the back of the seat. Note that the elastic straps for the backrest wings are fastened to the same tabs.

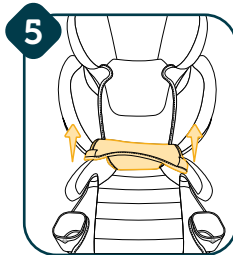

Tuck the lower part of the headrest pad behind the backrest pad. Fasten the two elastic straps at the top of the backrest pad to the seat.

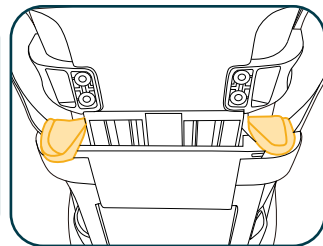

WARNING

DO NOT use the child restraint without the seat pad. Failure to do this can result in serious injury. Serious injury can include paralysis and/or permanent brain injury.

Safety Information

Review the following sections to learn about booster seat safety and other important information.



1 Vehicle Belt Information

2 Child Restraint Use

3 Vehicle Seating Position

4 Installation in Vehicle

5 Replacement and Expiration

6 Registration and Safety Notices

7 Warranty

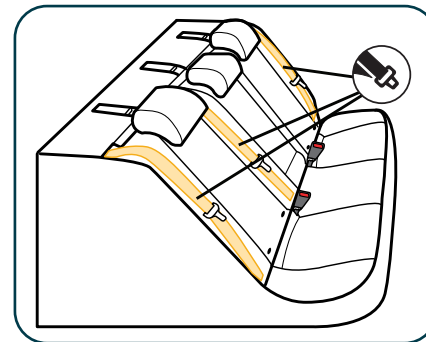

Your vehicle's features may be considerably different than those pictured here.



You MUST review your vehicle owner's manual.

Check your vehicle owner's manual to determine the vehicle belt and seating positions available for installing a booster seat.



NEVER use the following with this car seat:

- Emergency locking retractor lap-only belt
- Inflatable seat belts



This restraint is not certified for aircraft use because aircraft seats do not have shoulder belts.

⚠ WARNING

NEVER take your child out of the child restraint while the vehicle is moving.
NEVER leave your child unattended.
 Placing your child in a hot child restraint may result in burns.
DO NOT use a child restraint with damaged or missing parts.
DO NOT substitute parts or try to modify the child restraint in any way.
DO NOT use any child restraint accessory except those approved by Dorel Juvenile Group.
NEVER allow any child to play with this child restraint; it is not a toy.
DO NOT remove or cover up any of the warning labels on the child restraint.
 This child restraint has been certified for use in passenger vehicles. **DO NOT** use in a boat, on a motorcycle, or in a cargo van or bus where there are no seat belts. Read all instructions for additional warnings.

⚠ WARNING

Check the vehicle owner's manual for more information about air bag/child restraint use.

 Use the child restraint only on vehicle seats that face forward.

 **DO NOT** use on seats that face the sides or rear of the vehicle.

For vehicles without a back seat, refer to your vehicle owner's manual.



According to accident statistics, children are safer when properly restrained in the rear seating positions than in the front seating positions.

Rear seating positions are statistically safer, whether you have air bags, advanced air bags, or no air bags at all.

If you are not sure where to place the car seat in your vehicle:

- Consult your vehicle owner's manual; **OR**
- Contact Dorel Juvenile Group Consumer Care Department; **OR**
- Visit your local Child Passenger Inspection Station. Go to <https://www.nhtsa.gov/vehicle-safety/car-seats-and-booster-seats> to find your closest station.

To avoid your child being seriously burned, take the following precautions:

- Park in the shade or where the sun does not directly hit the car seat.
- Cover the car seat with a sheet or blanket when not in use.
- Check for hot seat and buckles before placing child in car seat.

To help protect your vehicle seat's upholstery from damage: You may use an accessory approved by Dorel Juvenile Group or a single layer towel underneath and behind car seat.

 **WARNING**

Check the vehicle belt before each use. Use only if the belt can be tightened properly and locked securely in place.

Even when unoccupied, this booster seat **MUST** be firmly secured to the vehicle with the vehicle seat belt.

In a crash or sudden stop, an unsecured booster seat could injure occupants.

DO NOT risk your child's safety.

To keep your child as safe as possible, Dorel Juvenile Group strongly recommends replacing the car seat even after a minor crash, even if it was not occupied at the time.

Replacement After a Minor Crash

The National Highway Traffic Safety Administration states that for a crash to be considered minor **ALL of the following MUST be true:**

- Vehicle able to drive away from the crash site; **AND**
- Vehicle door nearest the car seat was not damaged; **AND**
- No passengers were injured; **AND**
- Airbags did not deploy; **AND**
- There is no visible damage to the car seat.

If the crash your car seat was involved in meets **ALL** the criteria, you may not need to replace the car seat.

If one or more of these criteria are not true or if you are uncertain of any of your answers, replace the car seat immediately.

Replacement After a Moderate to Severe Crash

You **MUST** replace this car seat if it has been in a moderate to severe car crash.

This car seat is intended to protect a child in a single crash. During a crash, the car seat and all of its parts absorb crash energy which can deform or weaken it. Damage is not always visible. A damaged car seat **MUST** be replaced immediately.

Expiration

On the bottom of the car seat, there is a date of manufacture label as shown. **DO NOT** use this car seat more than 10 years after the date of manufacture.

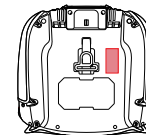

Please complete the postage-paid registration card that came with your child restraint, and send it to us.

Child restraints could be recalled for safety reasons.

You must register this restraint to be reached in a recall.

Send your name, address, email address if available, and the restraint's model number and manufacturing date to:

Dorel Juvenile Group

P.O. Box 2609
Columbus, IN 47202

or call 1-800-544-1108 or register online at www.djgusa.com/registration/carseat/us.

For recall information, call the U.S. Government's Vehicle Safety Hotline at 1-888-327-4236 (TTY: 1-800-424-9153), or go to www.NHTSA.gov.

0515079 *Tear Off and Mail This Part or Register Online* 4348-0081D

Consumer: Just fill in your name, address and email. Please print (use dark ink).

Your Name _____

Your Street Address _____

City _____ State _____ Zip Code _____

Email Address (optional) _____

Model Number AB123CDE	Model Name Brand Car Seat	Manufacture Date 2024/05/16
--------------------------	------------------------------	--------------------------------

 L#11 B265035

Example of model number, manufacture date, and line code.

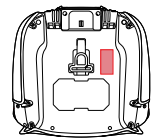

If you don't have the card or if your address changes, you will find the model number, manufacture date, and line code on the label located on the bottom of the car seat.

Dorel Juvenile Group, Inc. (DJG) warrants this product to the original retail purchaser as follows: This product is warranted against defective materials or workmanship for one year from the date of original purchase. **An original receipt is required to validate your warranty.** DJG will, at its option, provide replacement parts or replace this product. DJG reserves the right to substitute if the part or model has been discontinued. To make a claim under this warranty, please contact our Consumer Care Department by phone: 1-800-544-1108 or text: 1-812-652-2525. Our hours of operation are from 8:00 a.m. to 6:00 p.m. EST Monday through Thursday and from 8:00 a.m. to 4:30 p.m. on Friday.

Proof of purchase is required and shipping charges are the responsibility of the consumer.

Warranty Limitations: This warranty does not include damages which arise from misuse or abuse of this product.

Limitation of Damages: The warranty and remedies as set forth are exclusive and in lieu of all others, oral or written, expressed or implied. In no event will DJG or the dealer selling this product be liable to you for any damages, including incidental or consequential damages, arising out of the use or inability to use this product.

Limitation of warranties and other warranty terms and state law rights: Any implied warranties, including implied warranties of the merchantability and fitness for a particular purpose, shall be limited to the duration and terms of the express written warranty. Some states do not allow limitations as to how long an implied warranty lasts or the exclusion or limitation of incidental or consequential damages, so the above limitations may not apply to you.

This warranty gives you specific legal rights, and you may have other rights, which vary from state to state. Neither DJG nor the dealer selling this product authorized any person to create for it any other warranty, obligation, or liability in connection with this product.