

**PART NO. PVC 811 K**
**Closet Flange, Adjustable with Metal Ring**

SIZE	HUB END		
	A	B	C
4 x 3 (PVC)	7	1 1/4	1/4

**PART NO. 812**
**Closet Flange, Adjustable with Metal Ring**

SIZE	SPIGOT		
	A	B	C
4 x 3 (PVC)	7	2 5/8	1/4
4 x 3 (ABS)	7	2 3/4	1/4
4 x 4 (PVC)	7	2 5/8	1/4
4 x 4 (ABS)	7	2 13/32	1/4

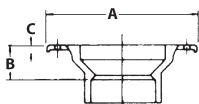
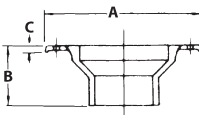

**PART NO. 812 P**
**Closet Flange, Adjustable with Plastic Ring**

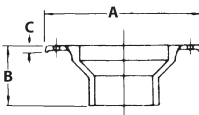
SIZE	SPIGOT		
	A	B	C
4 x 3 (PVC)	7	2 5/8	1/4
4 x 3 (ABS)	7	2 3/4	1/4
4 x 4 (PVC)	7	2 5/8	7/16

**PART NO. 815**
**Flush Closet Flange**

(Fits Over 3" Pipe or Inside 4" Pipe)

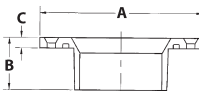
SIZE	HUB		
	A	B	C
4 x 4 / 4 x 3	7	2 7/8	7/16



Note: If PVC or ABS is not listed for a specific size, that size fitting is available in PVC and ABS materials, and the dimensions listed are the same for both materials.