

# BLACK DIAMOND®

Project Name: \_\_\_\_\_

Location: \_\_\_\_\_

Item #: \_\_\_\_\_

Qty: \_\_\_\_\_

## Black Diamond Reach-In Energy Star Freezer, 2 Solid Doors, 54" W, 46.7 Cu. Ft. Capacity, in Stainless Steel

### GRFZ-2DES



Elevate your commercial kitchen with the Black Diamond Solid Door Energy Star Reach-In Freezer, designed for efficient frozen storage in busy foodservice establishments. Constructed with a durable stainless steel exterior and interior, this freezer is Energy Star certified for energy efficiency and built to withstand demanding environments. It offers a generous 46.7 cubic feet of storage space, maintaining temperatures between -7° and 0°F. The bottom-mounted compressor and digital controls ensure consistent performance, while easy maintenance and cleaning make it a practical choice for restaurants and catering services.

### FEATURES AND CONSTRUCTION

- Best-in-class, energy-efficient design with Energy Star Certification
- Capacity of 46.7 Cu. Ft. offers ample frozen storage for commercial kitchens
- Powered by a 1 horsepower bottom mount compressor for efficient cooling
- Stainless steel construction ensures durability and easy maintenance
- Temperature range of -7° to 0°F for optimal frozen food preservation
- Utilizes eco-friendly R290 refrigerant for sustainable operation
- Includes six adjustable shelves to accommodate various frozen items
- Bottom mounted condensing unit positioned for easy maintenance
- Fitted with four casters, including two locking, for easy mobility

### ELECTRIC

115V / 60Hz / 1Ph

Cord Length (Inches): 98"

Plug Type: NEMA 5-15P

Cord set included

NEMA 5-15P



### 3RD PARTY APPROVALS



### WARRANTY (USA / CANADA)

Two (2) Year Limited Warranty on Parts and Labor, Five (5) Year Warranty on Compressor and Evaporator

Contact us for details at 1.877.368.2797



### STORAGE CAPACITY

- Cubic Feet: 46.7 Cu. Ft.

### TEMPERATURE

- Holding Temperature (Fahrenheit): -7° - 0°

These models are designed to operate in an environment where temperature and humidity do not exceed 75°F (24°C) and 55% relative humidity



# Black Diamond 2 Solid Door Reach-In Energy Star Freezer

GRFZ-2DES

FRONT

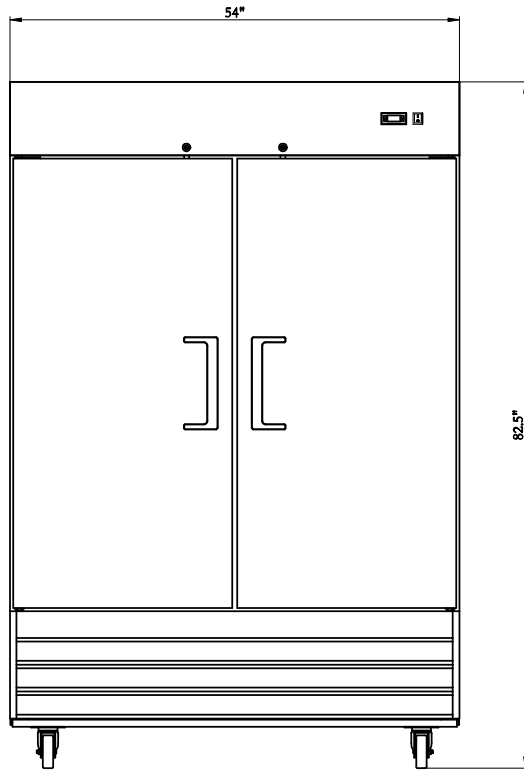

SIDE

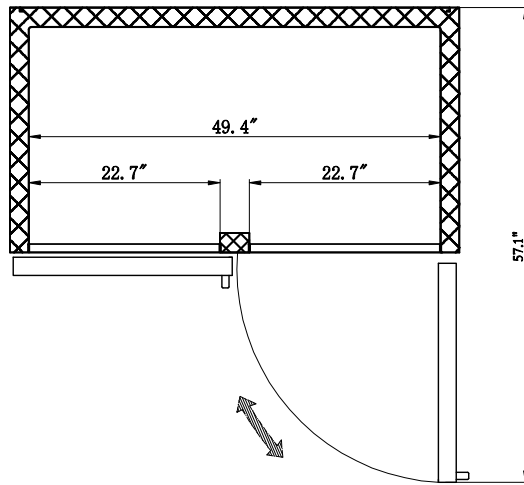
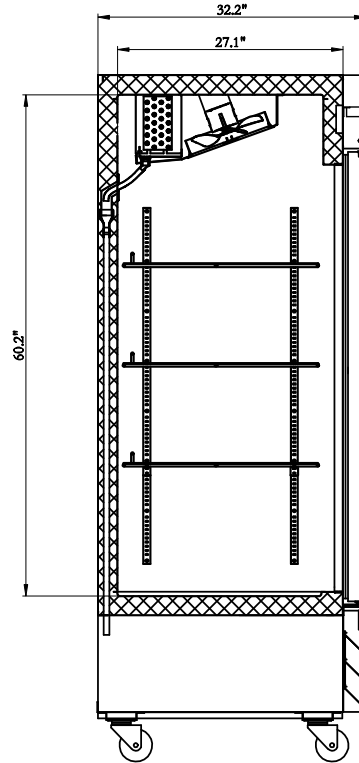

TOP

## Reach-In

Doors	Shelves	Amps	HP	Refrigerant	Assembled Dimensions (in)	Item Weight (lbs)	Shipping Weight (lbs)
2	6	7.8A	1	R290 3.88	32.20" x 54.00" x 82.50"	447.0	530.0

Due to periodic changes in designs, methods, procedures, policies and regulations, the specifications contained in this document are subject to change without notice. While we exercise good faith efforts to provide information that is accurate, we are not responsible for errors or omissions in information provided or conclusions reached as a result of using the specifications. By using the information provided, the user assumes all risks in connection with such use.