

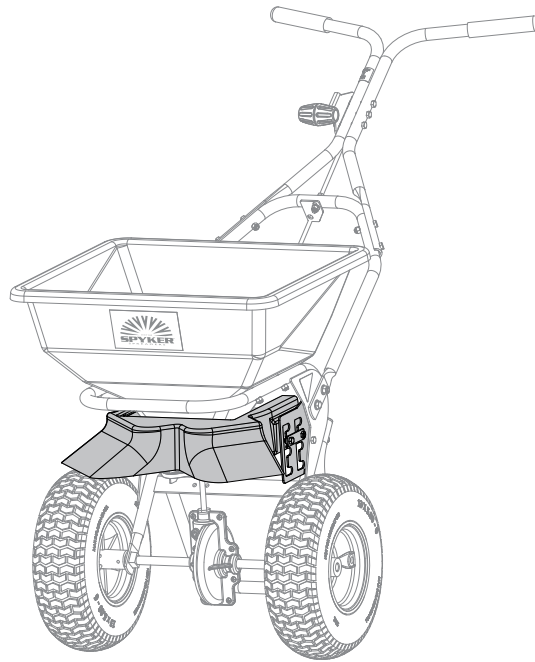

OPERATOR'S MANUAL

SPYVD-50 Deflector Kit



*For use
with the Spyker
SPY50L-2S
Push Spreader*

Spyker Spreaders

Contact us at 800.972.6130
www.spyker.com

▲ IMPORTANT

**This manual contains information for the safety of persons and property.
Read it carefully before assembly and operation of the equipment!**

Parts

DO NOT RETURN PRODUCT IF YOU ARE MISSING PARTS. PLEASE CALL: 1 (800) 972-6130

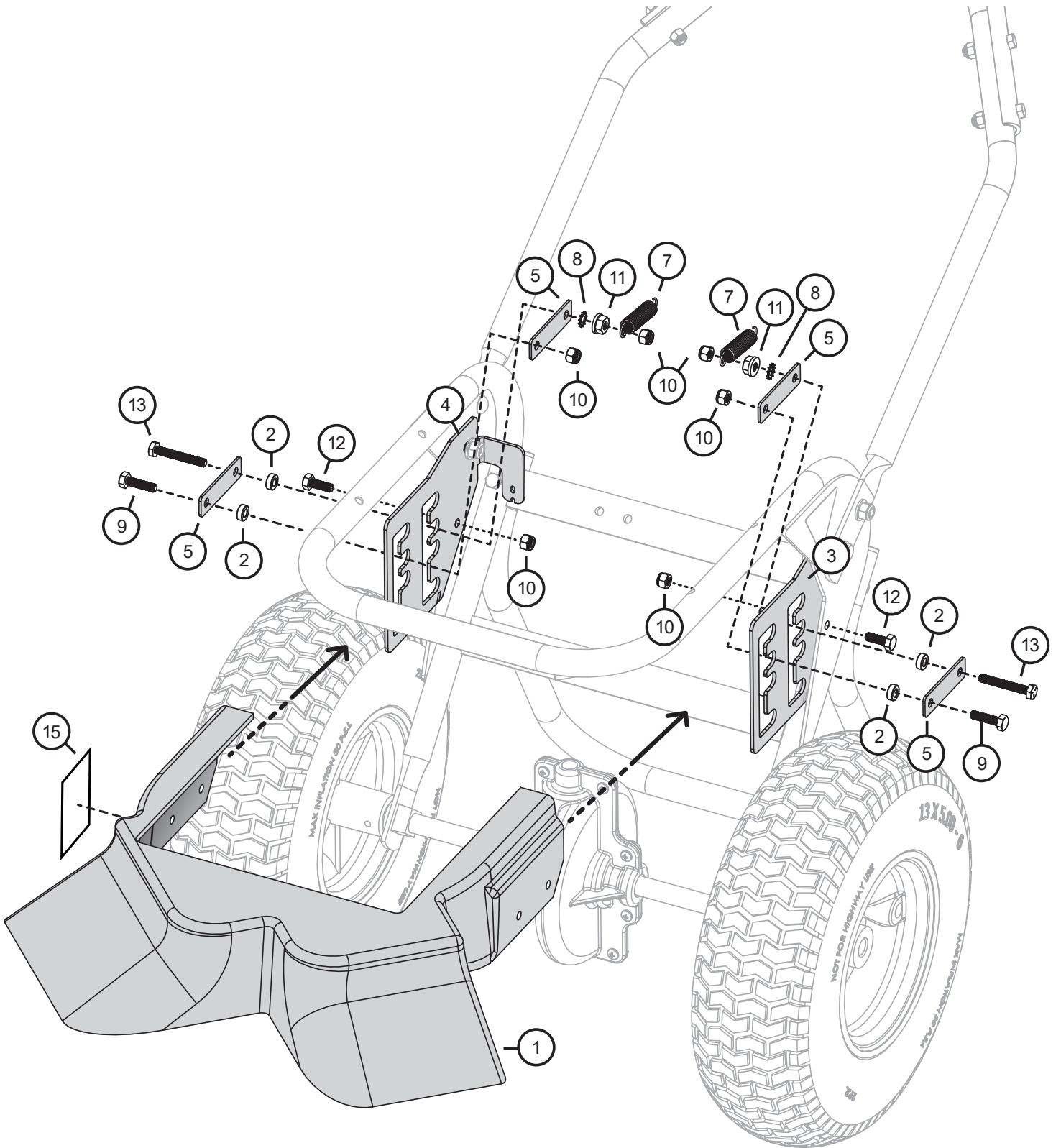

Parts

DO NOT RETURN PRODUCT IF YOU ARE MISSING PARTS. **PLEASE CALL: 1 (800) 972-6130**

ILLUSTRATIONS ON THIS PAGE ARE TO SCALE FOR FASTER IDENTIFICATION OF HARDWARE DURING ASSEMBLY.

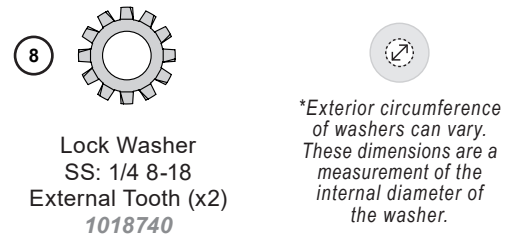
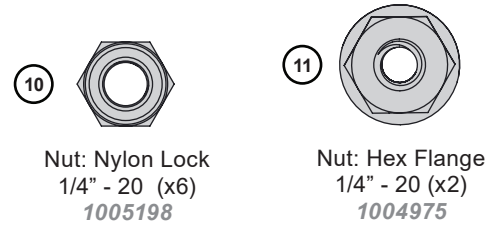
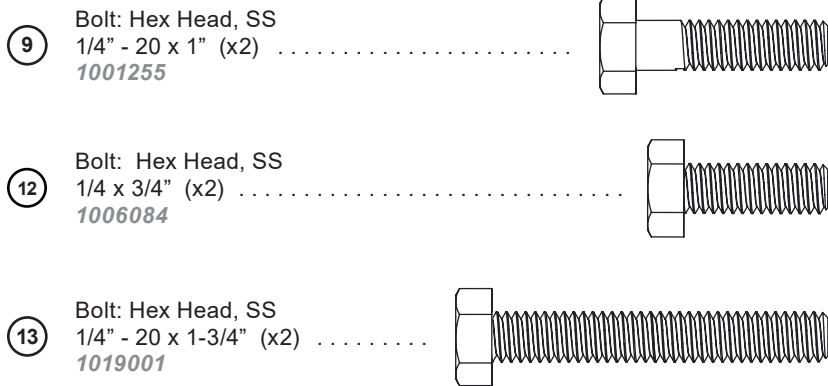

No.	Part #	Qty	Description
1	1019349	1	Deflector
2	1018993	4	Spacer, Plastic
3	1019231-LH	1	Mounting Bracket, LH
4	1019231-RH	1	Mounting Bracket, RH
5	1018708	4	Stiffener Plate
7	1018738	2	Spring
8	1018740	2	External Tooth Lockwasher
9	1001255	2	Bolt, Hex Head, SS 1/4"-20 x 1"

No.	Part #	Qty	Description
10	1005198	6	Nut, NylonLock, SS 1/4"-20
11	1004975	2	Nut, Hex Flange 1/4"-20
12	1006084	2	Bolt, 1/4"-20 x 3/4" Hex Head, SS
13	1019001	2	Bolt, Hex Head 1/4"-20 x 1-3/4"
15	1019348	1	Label, Deflector Position



Tools Required for Assembly:

- 1/2" Wrench
- 7/16" Wrench
- Set Punch
- Drill Bit 9/32

Assembly

1. On both sides of the deflector, temporarily remove the 1/4"-20 x 3/4" carriage bolts (12), and lock nuts (10) noted below.

Keep this hardware for step 6.

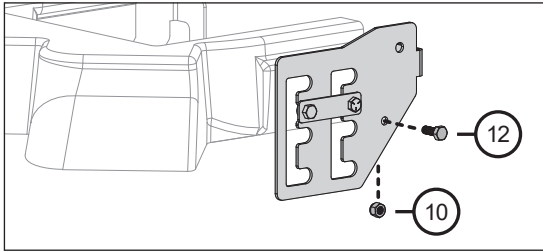

2. Using a 1/2" wrench, temporarily remove the hex bolt (A), two washers (B) & lock nut (C) at the base of the handle. Repeat on the other side of the spreader.

Keep this hardware for step 5.

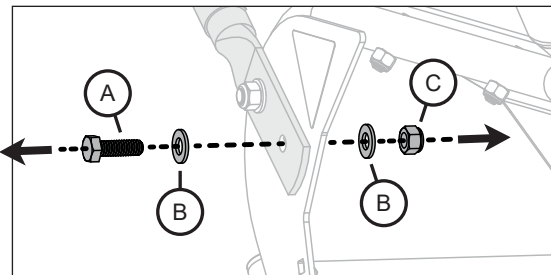
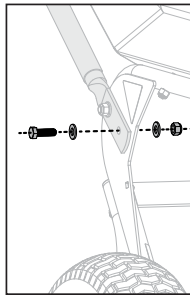

Some older models may require a hole to be drilled at the location marked with an "X" as illustrated here.

If drilling is necessary, continue to step 3a.

If drilling is NOT necessary, continue to step 4 on page 5.

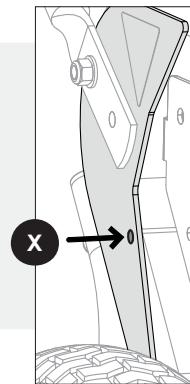

- 3a. Temporarily unhook both of the deflector springs (7), allowing them to hang from the bracket extensions as illustrated here.

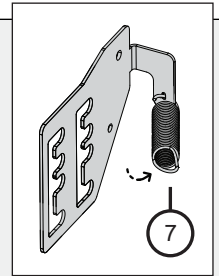

NOTE: Additional parts not illustrated here for clarity.

- 3b. On the outside edge of the spreader, temporarily attach the deflector by the mounting brackets with the bolt and nuts from step 1.

Align the deflector parallel to the frame as illustrated below:

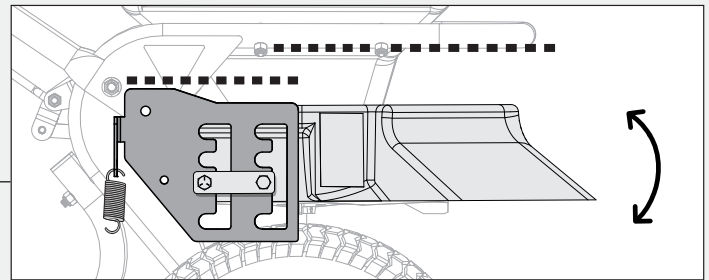
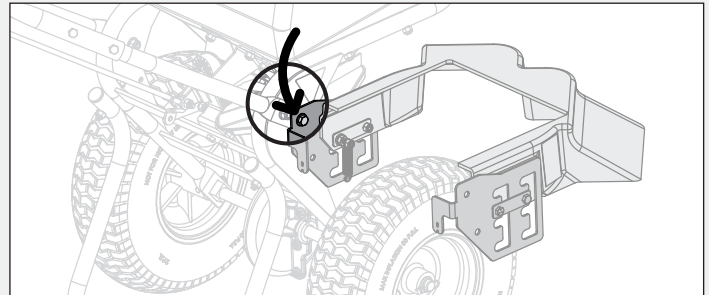
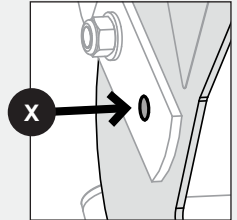

- 3c. Using the mounting bracket as a template, mark the center point for drilling (marked with a "Z" here) with a set punch or marker.

To prevent damage, remove the deflector at this point.

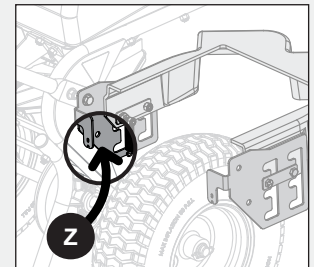

After laying the spreader sideways, making a stable surface:

Drill through the spreader frame with a 9/32 drill bit.

- 3d. Repeat the drilling process on the other side.

Assembly

4. Slide the deflector between the two side walls of the spreader frame, beneath the hopper, as illustrated.

NOTE: Align holes of the deflector assembly with the holes marked "x" below.

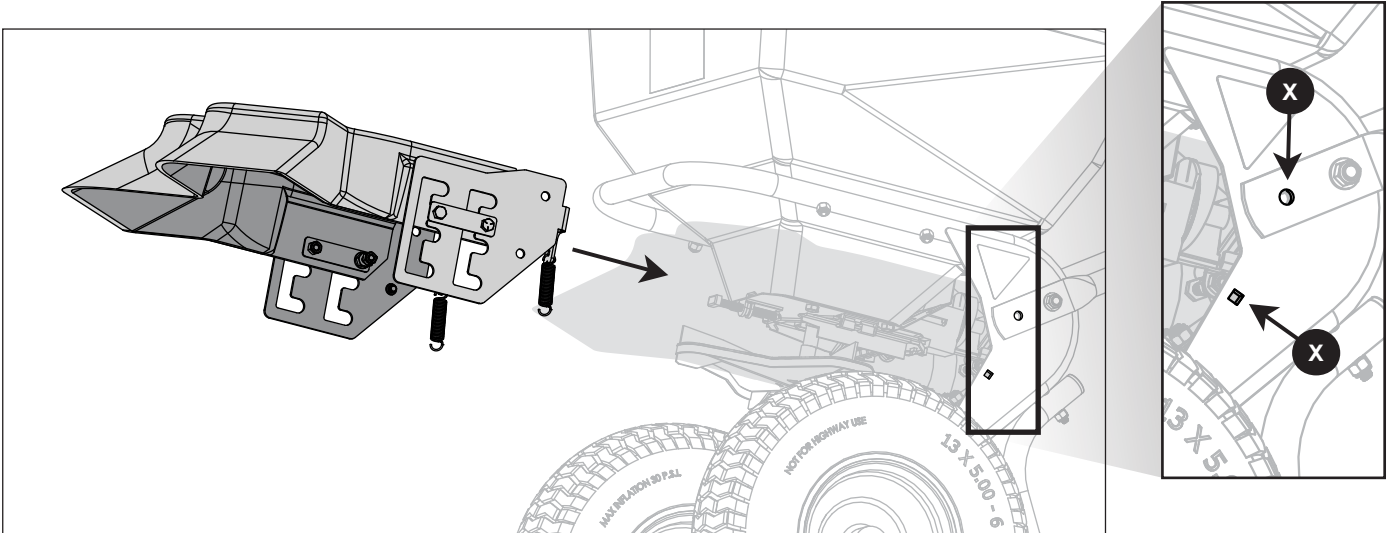

5. On both sides of the spreader, **LOOSELY** attach the deflector with the hex bolt (A), two washers (B) and lock nut (C) that were removed on Step 2.

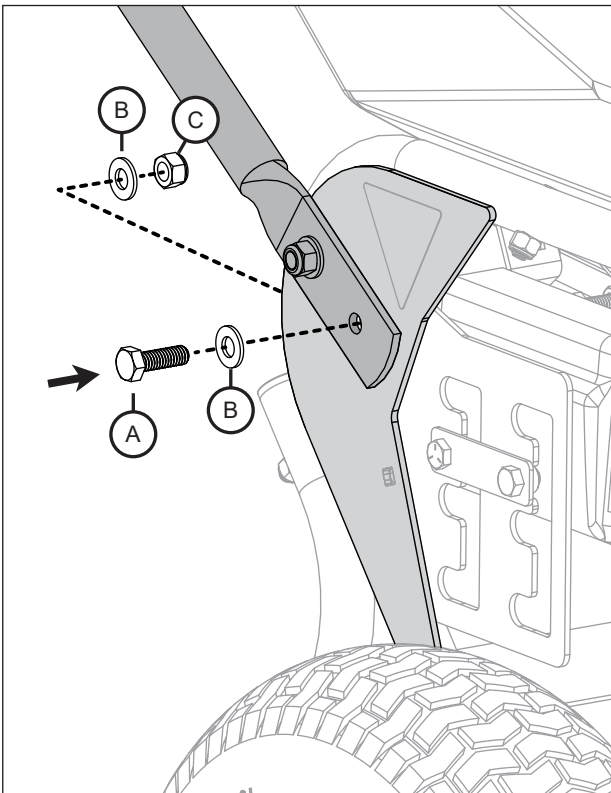

6. Just below the bolt that was added on step 5:
From the outside and facing in, reuse the hardware that was removed on step 1: Two 1/4"-20 x 3/4" carriage bolts (12), and lock nuts (10).

Tightly secure all of the hardware installed on steps 5 and 6.

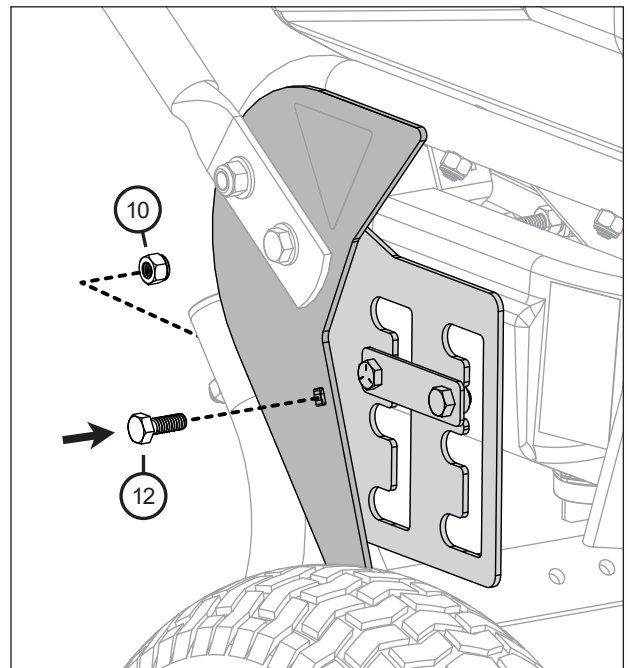

7. Beneath the deflector:

Pull the end of the spring (7) toward the bolt marked (x) and hook it in place between the two nuts, as illustrated below. *Repeat for other side.*

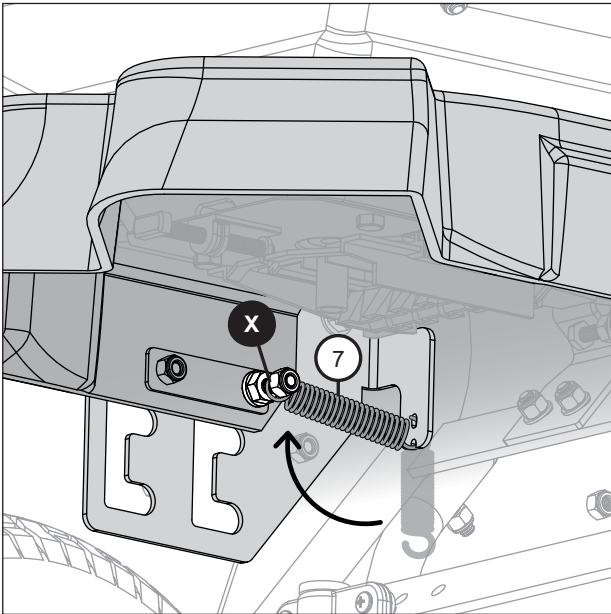

Assembly is complete!

MAINTENANCE



Clean and oil spreader immediately after each use.

Method #1	Method #2
Wipe spreader thoroughly with an oily cloth. Oil all bearings and bearing areas.	Wash, rinse & dry the spreader. <i>Note: Drying takes time. Moisture trapped in bearing areas is slow to go.</i> Immediately after drying - oil all bearings and moving parts. Make certain all operations are thorough.

NOTE: Good "Dry Cleaning" (Method #1) is preferable to poor "Wet Cleaning" (Method #2).

- It is virtually impossible to have rust and corrosion on a clean, dry, oiled surface.
- Again - just before using:
Oil all bearings & moving parts.

STORAGE

In storage, ideally the spreader should be hung by the handle. In any case, do not pile weight on the spreader, as excess weight over a period of time can distort the tires.

DEFLECTOR SETTINGS

WIDENING THE SPREAD AREA

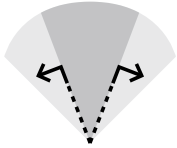

HIGHEST SETTING = 0% DEFLECTION

When the deflector is at the highest position, it enables a full spread pattern.

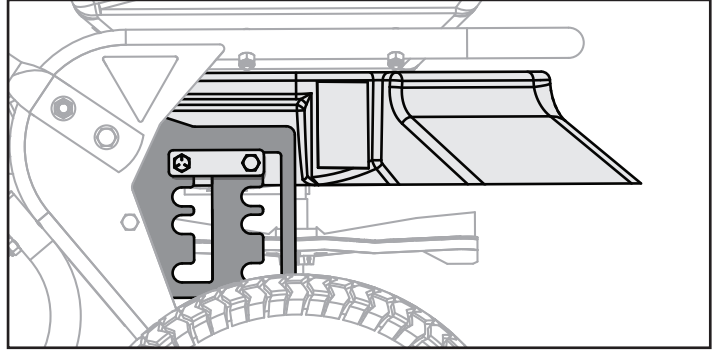

NARROWING THE SPREAD AREA

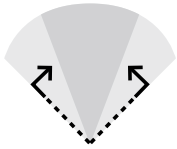

LOWEST SETTING = 100% DEFLECTION

When the deflector is at the lowest position, the spread width will be approximately 3 feet.

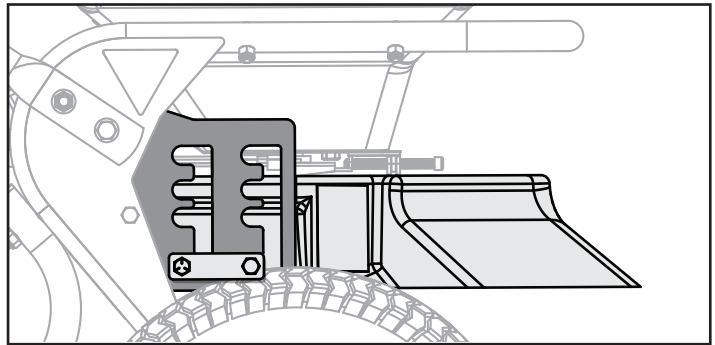

STRIPING ISSUES?

IF YOU FIND THAT THE MATERIAL IS STRIPING HEAVY ON THE LEFT SIDE OF THE SPREAD WHEN THE DEFLECTOR IS IN USE:

Reduce the gate opening until the distribution is uniform.

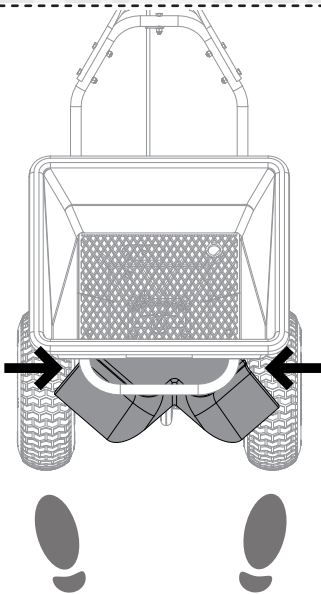

ADJUSTING THE DEFLECTOR

1. To move the deflector, stand in front of the spreader and plant your feet just before both wheels to prevent movement.
2. Grasp the deflector (as illustrated here) on both sides and pull toward yourself while raising or lowering to the desired setting.

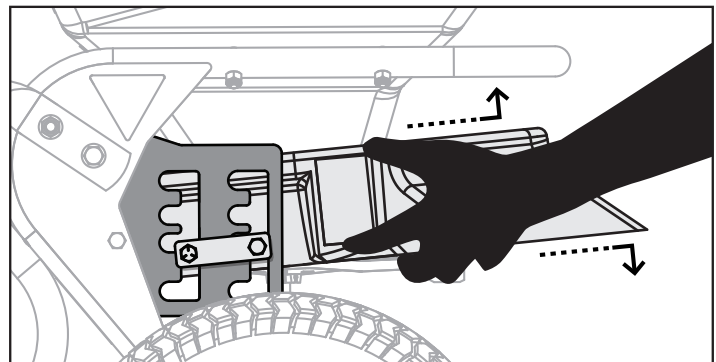

NOTE:
Moving the deflector **UP** increases the spread width.

