

# Elmwood Park Three Light Pendant

6537303 1.0

## VISUAL COMFORT & Co.

GENERATION LIGHTING

### GENERAL PRODUCT INFORMATION:

These fixtures are intended to be installed utilizing NEC compliant junction boxes.

This product is safety listed for damp locations.

Incandescent version may be dimmed with a standard incandescent dimmer. LED version may be dimmed with a LED dimmer. Consult lamp manufacturer for additional information.

This instruction shows a typical installation.

### CAUTION - RISK OF FIRE

This product must be installed in accordance with the applicable installation code by a person familiar with the construction and operation of the product and the hazards involved.

Use minimum 90°C supply conductors.

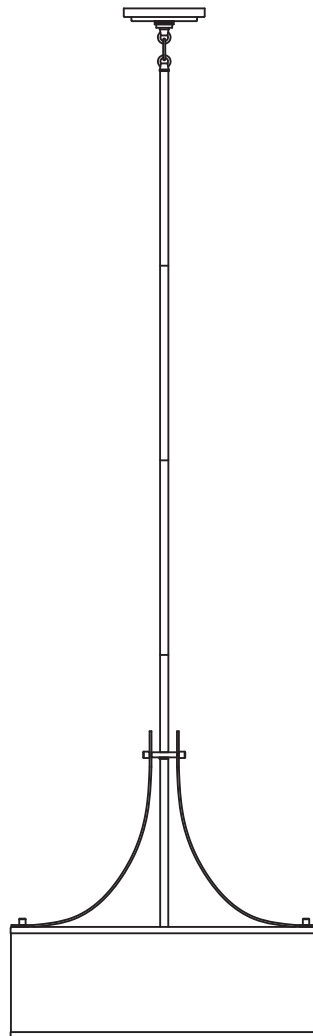

**SAVE THESE INSTRUCTIONS!**

# Install the Fixture

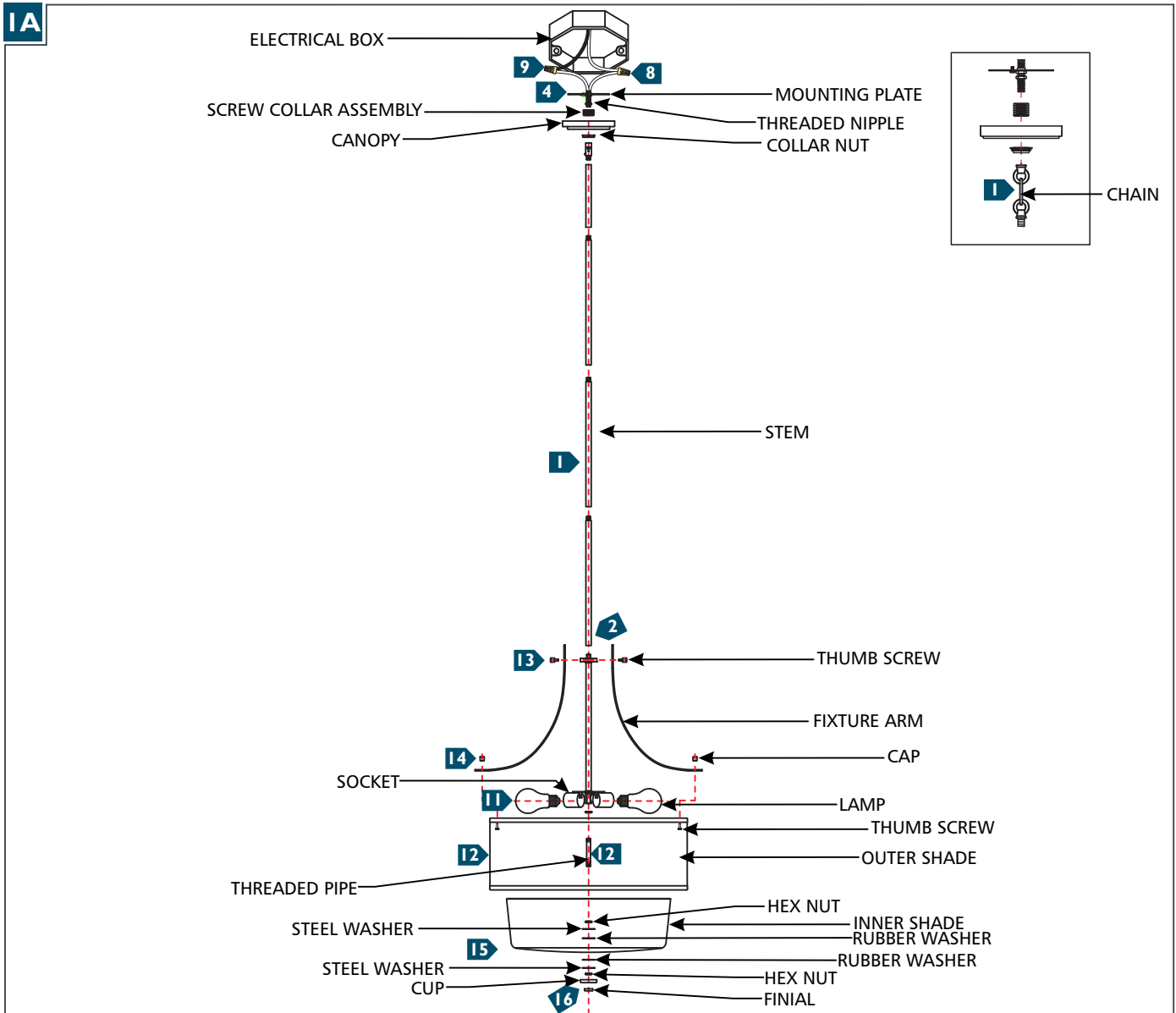

- 1** Determine the wanted height or look of the fixture with the provided swivel, stems, and chain and assemble them by screwing them together. All the parts may be used alone or used in combination.
- 2** Feed the fixture wires through the stems and screw to the fixture tightly.
- 3** Screw the collar nut down until it is loose on the stem, then slide the canopy onto the stem.
- 4** Screw the shorter end of the threaded nipple tightly onto the mounting plate.
- 5** Feed the fixture wires through the mounting plate/nipple assembly and screw it tightly onto the screw collar.
- 6** Align the mounting plate to the electrical box and secure the fixture tightly with two mounting plate screws.
- 7** Connect the fixture to a suitable ground in accordance to local electrical codes.
- 8** Connect the white fixture wire (square and rigid tracer) to the neutral power line wire with a wire nut.
- 9** Connect the black fixture wire (round and smooth tracer) to the hot power line wire with a wire nut.
- 10** Neatly place all the wires into the electrical box, place the canopy onto the ceiling, and secure it in place by screwing the collar nut tightly onto the screw collar.
- 11** Screw the lamps into the sockets. Refer to the label on the socket for Max Wattage Information.
- 12** Install a hex nut onto each end of the threaded pipe, then screw the threaded pipe to the bottom of the socket assembly.
- 13** Attach the fixture arms to the hub with the provided thumb screws.
- 14** Attach the outer shade to the fixture arms with the thumb screws and caps.
- 15** Place a steel washer, rubber washer, the shade, rubber washer, and steel washer (in that order) onto the threaded pipe, then secure them in place by screwing a hex nut onto the threaded pipe.
- 16** Place the cup onto the threaded pipe and secure it by screwing the finial onto the threaded pipe.