

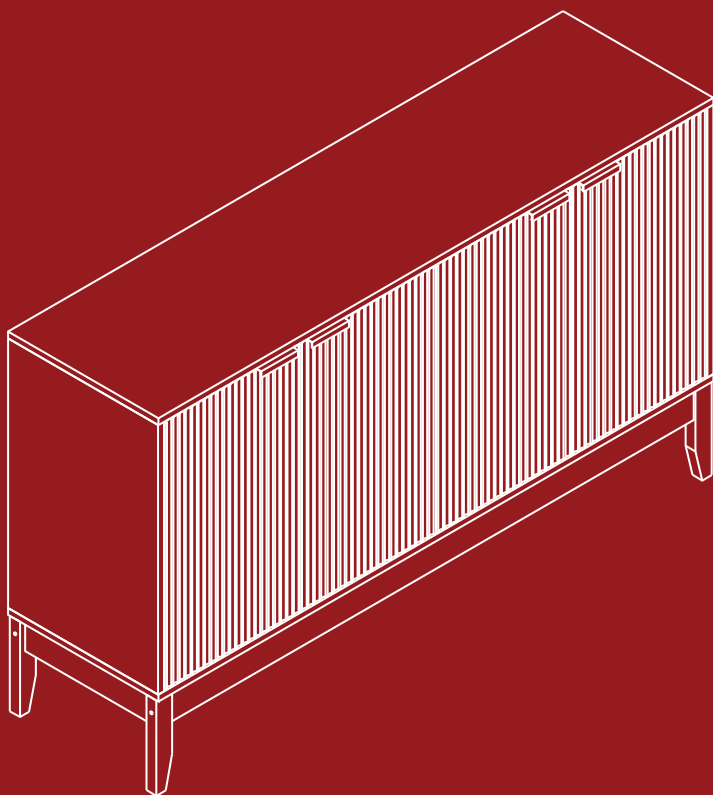

BEST CHOICE
PRODUCTS



INSTRUCTION MANUAL

4-Door Elevated
Storage Cabinet



145.3 LBS
TOTAL
CAPACITY



61.7 LBS
CABINET TOP
CAPACITY



26.4 LBS
BOTTOM BOARD
(EACH) CAPACITY



15.4 LBS
SHELF (EACH)
CAPACITY



2 PERSON
ASSEMBLY



UP TO 60 MIN.
ASSEMBLY

! NOTICE

Please retain these instructions for future reference.

- Please do not exceed the weight limitations of this item.
- Do not stand on or use any part of this item as a step ladder.
- Firmly secure all bolts, screws, and knobs before use.
- Reconfirm that all bolts, screws, and knobs are secure every 90 days.
- Fasten screws loosely during initial assembly. Do not firmly tighten the screws until the item is completely assembled.
- Do not use or store this item in the proximity of open flame or flammable/combustible chemicals.
- To prevent swelling or warping, wipe away any excess water on the surfaces of the product
- Be aware that some parts are heavy and have sharp edges.
- If any parts are missing, broken, damaged, or worn, stop using this product until repairs are made and/or factory replacement parts are installed.
- Do not use this item in a way inconsistent with the manufacturer's instructions as this could void the product warranty.
- This product is intended for indoor use only.
- This product is intended for residential use only.

TOOLS REQUIRED



PHILLIPS
SCREWDRIVER



ALLEN WRENCH
(PROVIDED)



POWER DRILL
(RECOMMENDED)

HARDWARE

1

M6 x 35mm
CAM BOLT

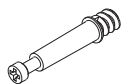

38 PCS

2

M15 x 10mm
CAM LOCK



38 PCS

3

M6 x 30mm
DOWEL



28 PCS

4

M4 x 35mm
WOOD SCREW

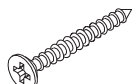

8 PCS

5

SHELF
SUPPORT



8 PCS

6

M3 x 12mm
SCREW



8 PCS

7

HINGE I

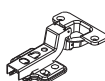

4 PCS

8

HINGE II

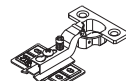

4 PCS

HARDWARE

9

M6 x 50mm
BARREL BOLT
& NUT SET



4 PCS

10

MOUNTING
HARDWARE



2 SETS

11

M4 x 45mm
SCREW

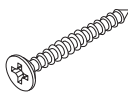

2 PCS

12

M3.5 x 12mm
SCREW



48 PCS

13

CENTRAL LEG
FOOT



1 PC

14

BACK SCREW
& GUIDE



16 PCS

15

DOOR
HANDLE



4 PCS

16

FOOT SLIDER



4 PCS

17

M4 x 35mm
SCREW



6 PCS

18

M6 x 50mm
LONG DOWEL



1 PC

19

BARREL BOLT
COVER



4 PCS

PARTS

A

CABINET TOP

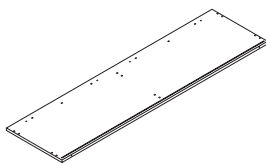

1 PC

B

CABINET BOTTOM

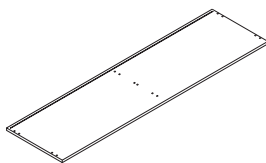

1 PC

C

CABINET RIGHT SIDE

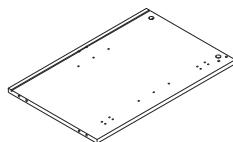

1 PC

D

CABINET LEFT SIDE

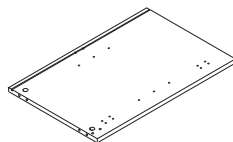

1 PC

E

CABINET CENTRAL
PANEL

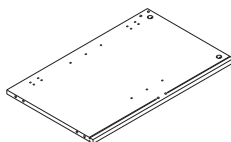

1 PC

F

LEFT DOOR I

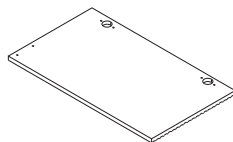

1 PC

PARTS

G

RIGHT DOOR I

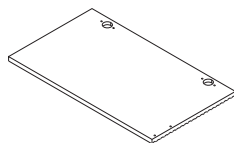

1 PC

H

LEFT DOOR II

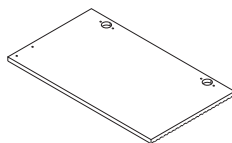

1 PC

I

RIGHT DOOR II

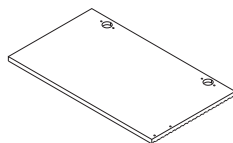

1 PC

J

BASE SIDE
FRAME

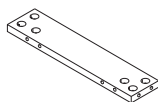

2 PCS

K

BASE FRAME
CONNECTOR

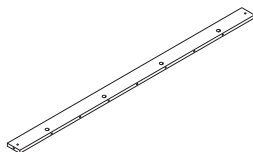

2 PCS

L

LEG I

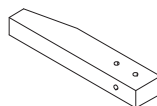

2 PCS

M

LEG II

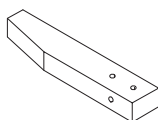

2 PCS

N

BACK BOARD

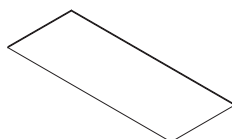

4 PCS

O

TOP FRAME
CONNECTOR

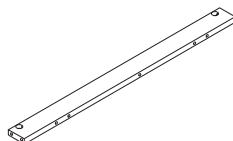

2 PCS

P

BACK DIVIDER

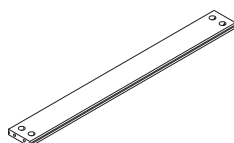

2 PCS

Q

CENTRAL LEG

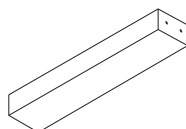

1 PC

R

SHELF

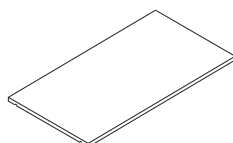

2 PCS

PRODUCT ASSEMBLY

Locate the **part A cabinet top** and insert six **part 1 cam bolts**, set aside.

Locate the **part C** and **part D cabinet sides** and insert three **part 1 cam bolts** into each, six cam bolts total.

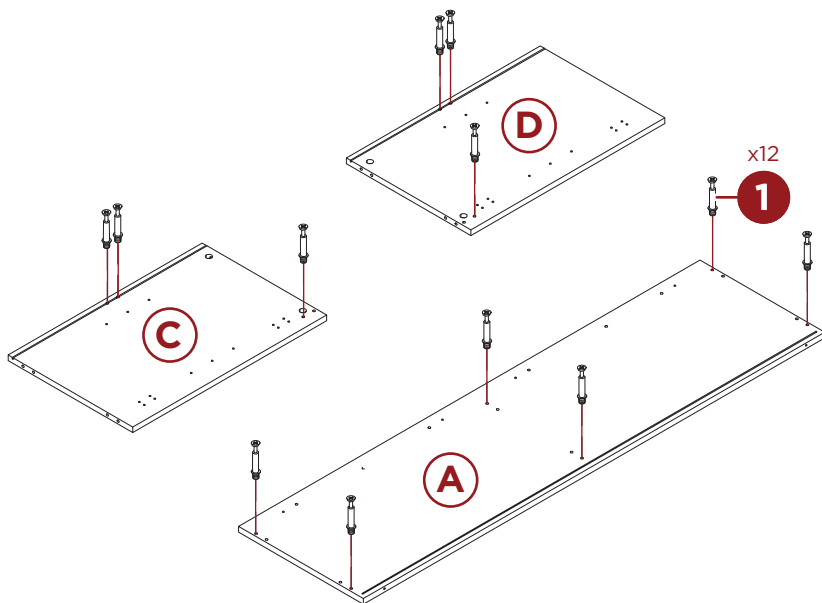

Locate the **part E cabinet central panel** and insert three **part 1 cam bolts** into each side of the panel, six cam bolts total.

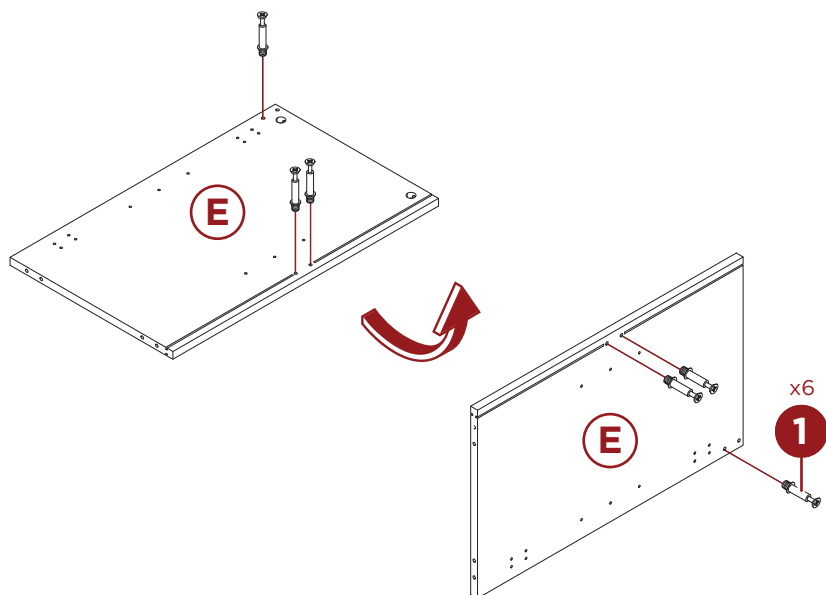

PRODUCT ASSEMBLY

3

Insert two **part 2 cam locks** into one **part P back divider**, then attach the divider to the **part D cabinet left side**. Turn the cam locks to secure.

Insert one **part 2 cam lock** and one **part 3 dowel** into the **part O top frame connector**, then attach the frame connector to the **part D cabinet left side**. Turn the cam locks to secure.

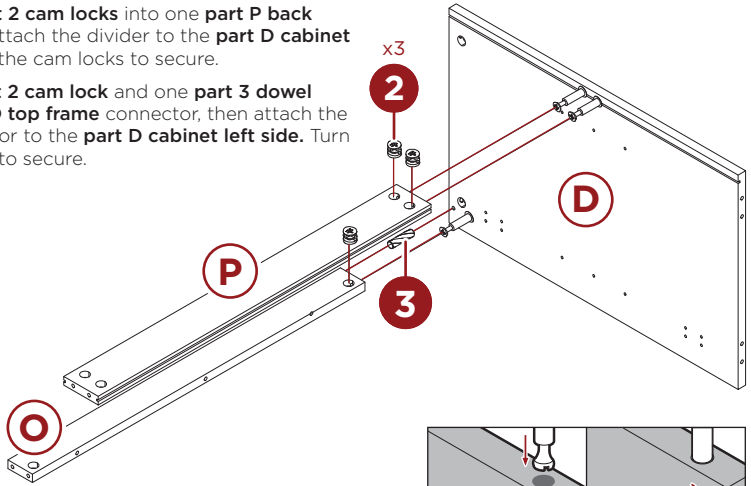

4

Insert two **part 2 cam locks** into the **part P back divider**, then attach the divider to the **part E cabinet central panel**.

Insert one **part 2 cam lock** and one **part 18 long dowel** into the **part O top frame connector**, then attach the frame connector to the **part E cabinet central panel**. Turn the cam locks to secure.

NOTE: The dowel will pass through the **part E cabinet central panel** for later installation.

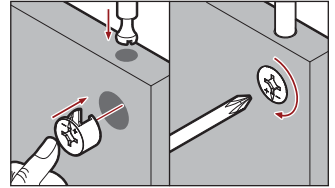

Use a screwdriver to turn the cam lock to secure the cam bolt.

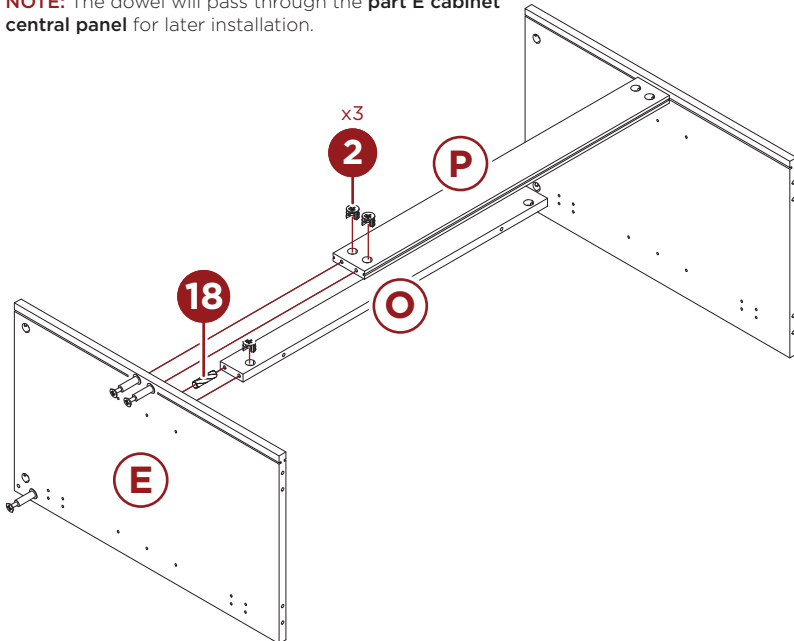

PRODUCT ASSEMBLY

5

Insert two **part 2 cam locks** into one **part P back divider**, then attach the divider to the **part E cabinet central panel**. Turn the cam locks to secure.

Insert one **part 2 cam lock** into the **part O top frame connector**, then attach the frame connector to the **part E cabinet central panel**. Turn the cam locks to secure.

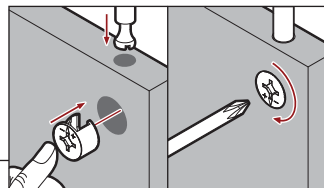
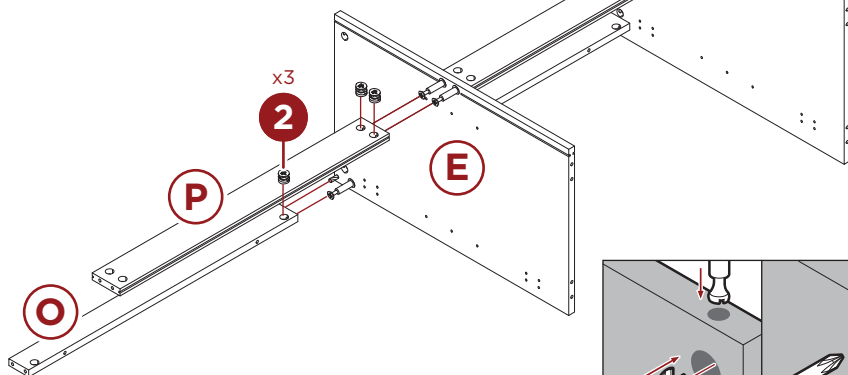

6

Insert two **part 2 cam locks** into one **part P back divider**, then attach the divider to the **part C cabinet right side**.

Insert one **part 2 cam lock** and one **part 3 dowel** into the **part O top frame connector**, then attach the frame connector to the **part C cabinet right side**. Turn the cam locks to secure.

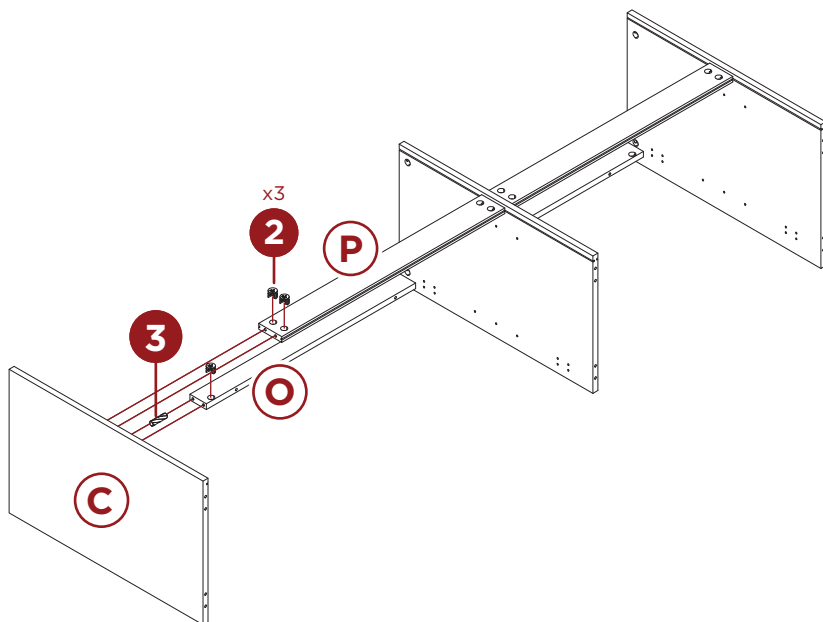

Use a screwdriver to turn the cam lock to secure the cam bolt.

PRODUCT ASSEMBLY

7

Slide two **part N** back boards into the designated slots between the **part E** cabinet central panel and the **part D** and **part C** cabinet sides.

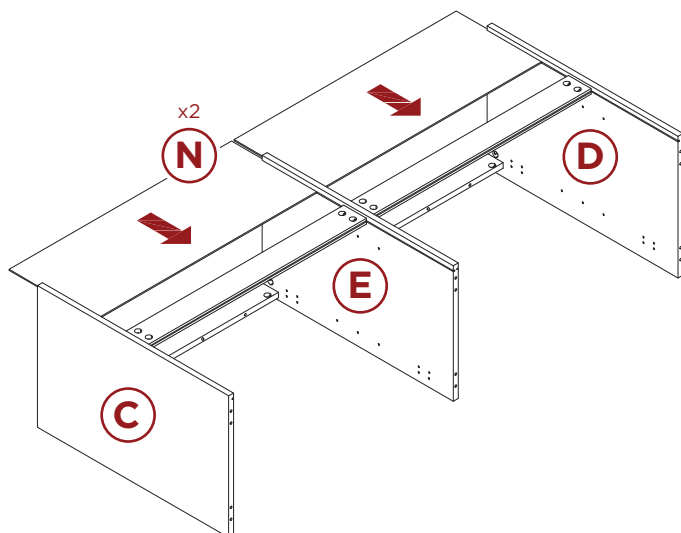

8

Insert two **part 3** dowels each into the **part D** cabinet left side, **part C** cabinet right side, **part E** cabinet central panel, and both the **part O** top frame connectors, ten dowels total.

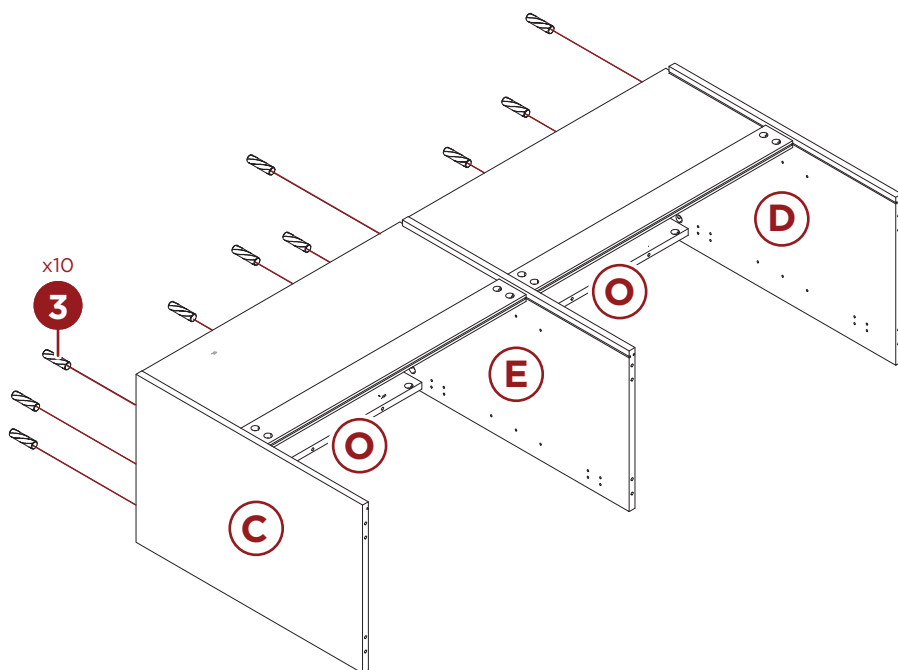

PRODUCT ASSEMBLY

9

Insert six **part 2** cam locks into the **part D** and **part C** cabinet sides and the **part E** cabinet central panel, two cam locks per side.

Attach the **part A** cabinet top to the **part D** and **part C** cabinet sides, and **part E** cabinet central panel, then turn the cam locks to secure.

Attach the **part A** cabinet top to the **part O** top frame connectors with six **part 17** screws, three screws per frame connector.

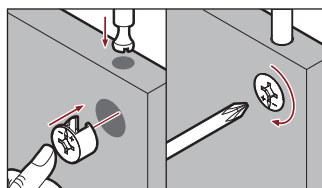
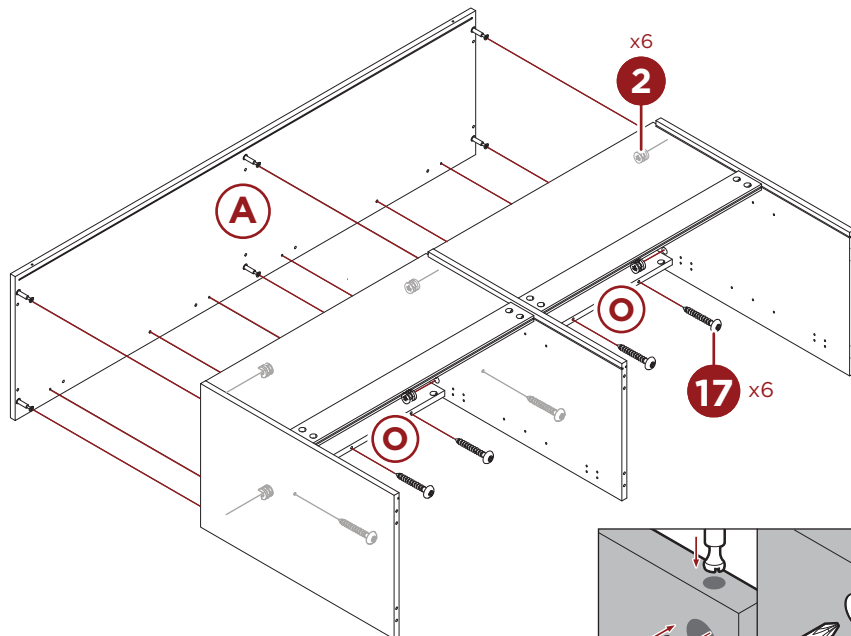

Use a screwdriver to turn the cam lock to secure the cam bolt.

10

Slide two **part N** back boards into the designated slots between the **part E** cabinet central panel and the **part D** and **part C** cabinet sides.

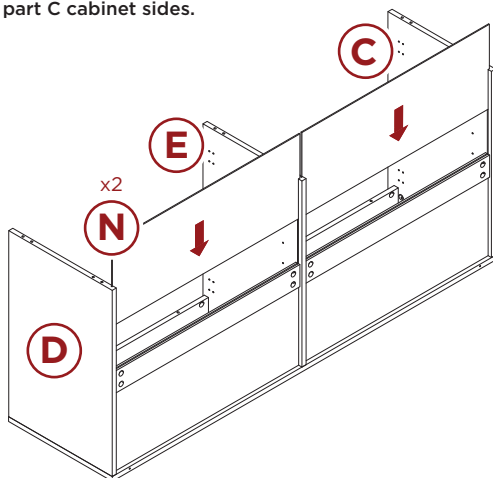

PRODUCT ASSEMBLY

11

Locate the **part L** and **part M** legs and insert two **part 1** cam bolts each, eight cam bolts total.
Locate the **part B** cabinet bottom and insert twelve **part 1** cam bolts.

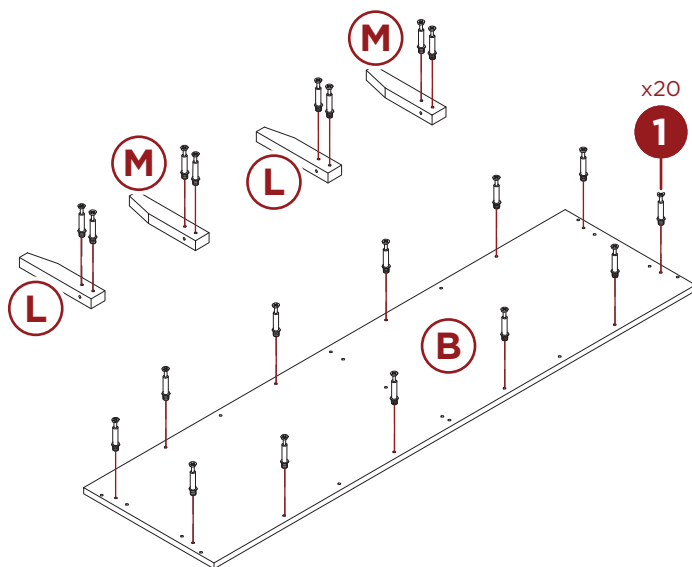

12

Locate the **part Q** central leg, then screw the **part 13** central leg foot into the bottom.
Attach the **part Q** central leg to the **part B** cabinet bottom with two **part 11** screws.

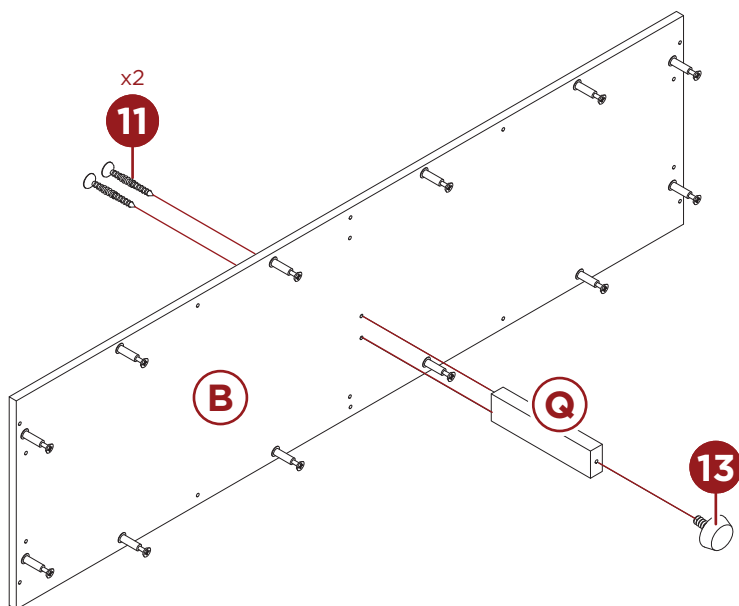

PRODUCT ASSEMBLY

13

Flip the assembly upside down, then insert two **part 3** dowels each into the **part D** and **part C** cabinet sides, and the **part E** cabinet central panel, six dowels total.

Attach the **part B** cabinet bottom to the **part D** and **C** cabinet sides and the **part E** cabinet central panel with six **part 4** screws.

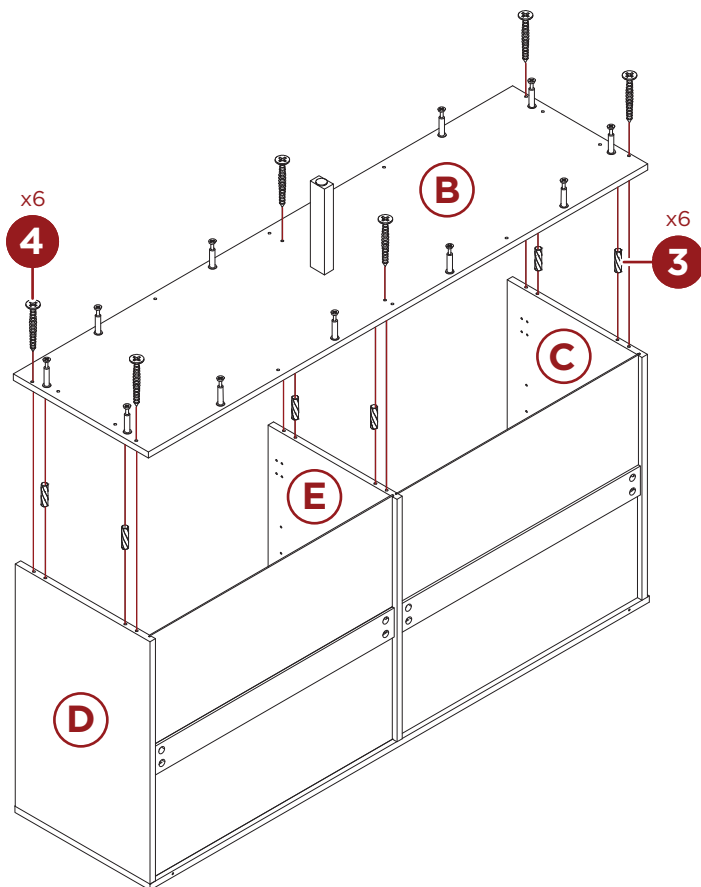

14

Insert four **part 2** cam locks into one **part J** base side frame, then attach one **part L** and one **part M** leg. Turn the cam locks to secure, then repeat to assemble a second leg set.

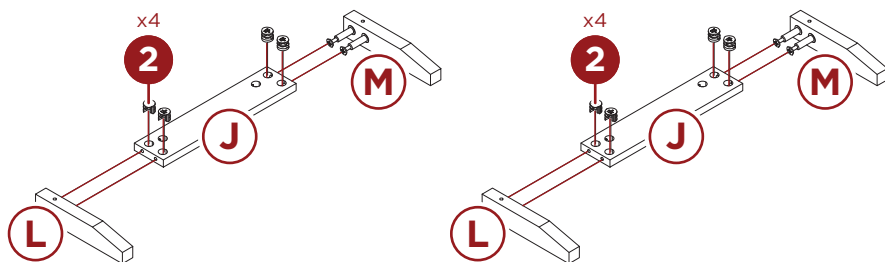

PRODUCT ASSEMBLY

15

Locate the two **part K base frame connectors** then insert four **part 9 barrel nuts**, two nuts per connector, taking care to align the fastener hole with the predrilled holes in the sides of the frame connector.

Attach the **part L** and **part M legs** to the **part K base frame connectors** with four **part 9 barrel bolts**. Cover each barrel bolt with one **part 19 barrel bolt covers**.

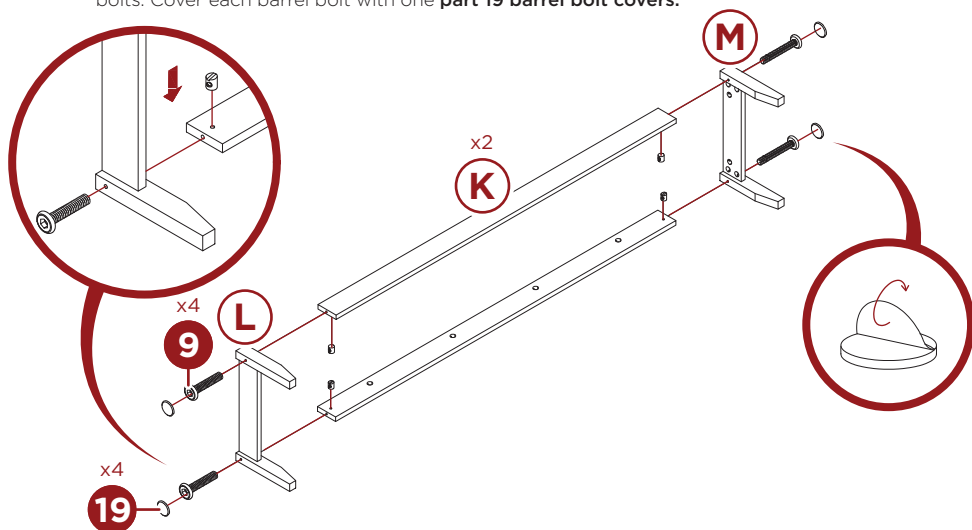

16

Insert ten **part 3 dowels** into the **part B cabinet bottom**.

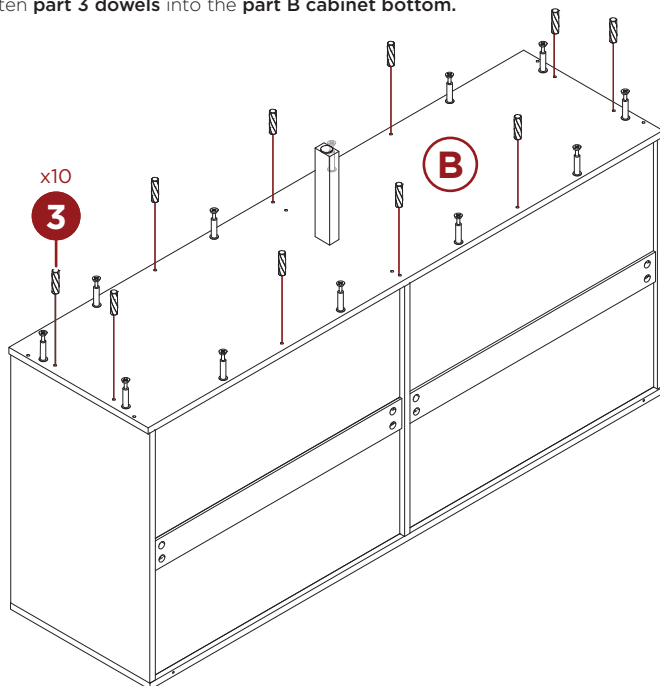

PRODUCT ASSEMBLY

17

Insert four **part 2 cam locks** each into the **part K base frame connectors**, eight cam locks total.
Insert two **part 2 cam locks** each into the **part J base side frames**, four cam locks total.
Attach the base frame assembly to the **part B cabinet bottom**, then turn the cam locks to secure.
Place four **part 16 foot sliders** onto the bottom of the **part L & M legs**.

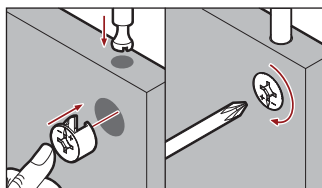
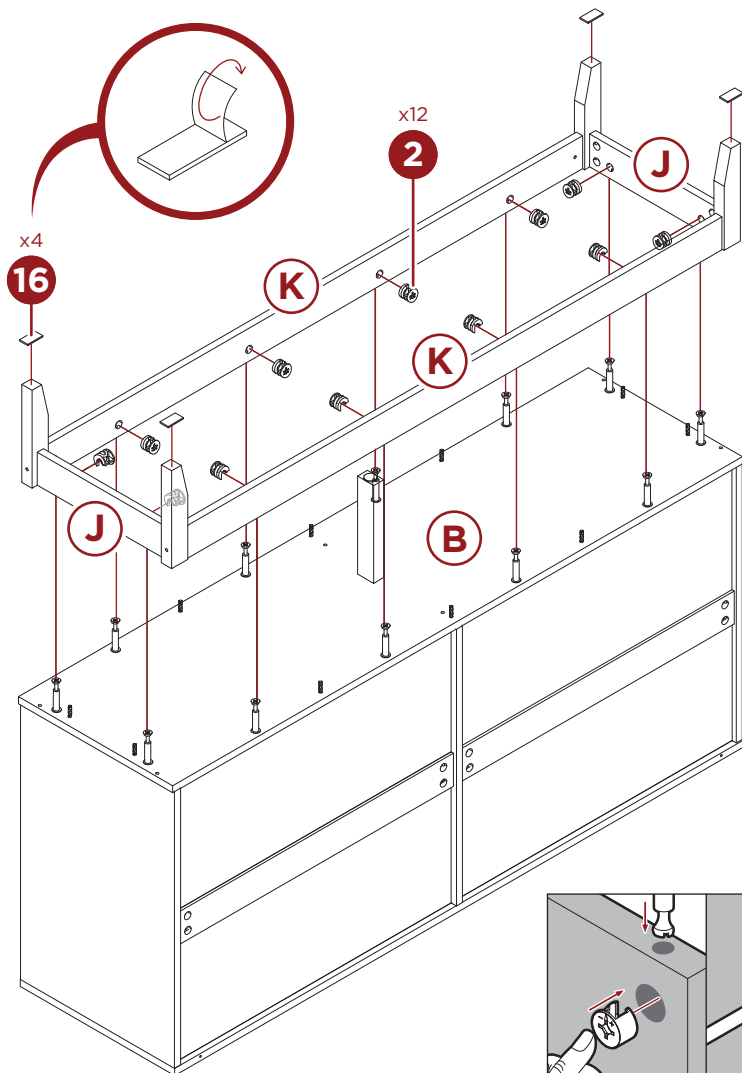

Use a screwdriver
to turn the cam lock to
secure the cam bolt.

PRODUCT ASSEMBLY

18

Locate the **part F & I doors**, then attach two **part 15 door handle** with four **part 6 screws**, two screws per door handle.

Attach two **part 7 hinges** to each door with eight **part 12 screws**, two screws per hinge.

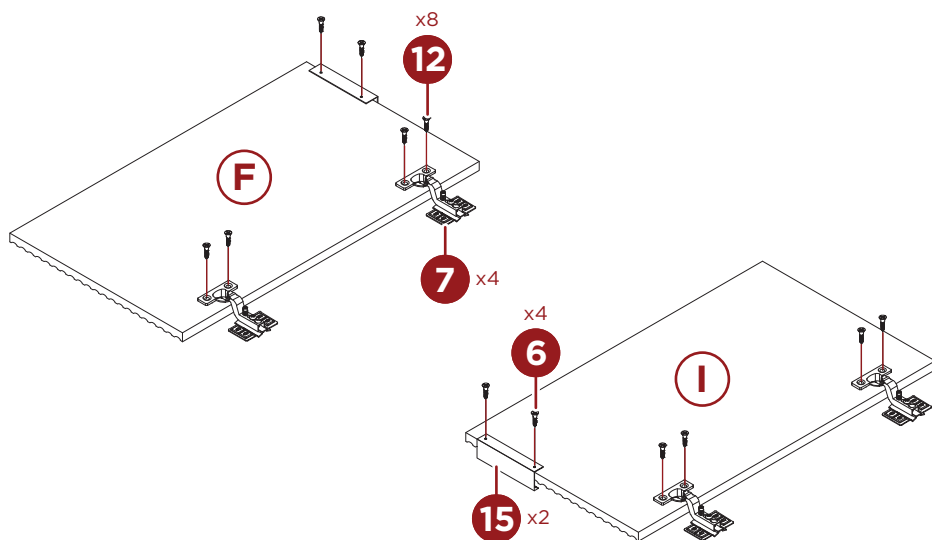

19

Locate the **part G & H doors**, then attach two **part 15 door handle** with four **part 6 screws**, two screws per door handle.

Attach two **part 8 hinges** to each door with eight **part 12 screws**, two screws per hinge.

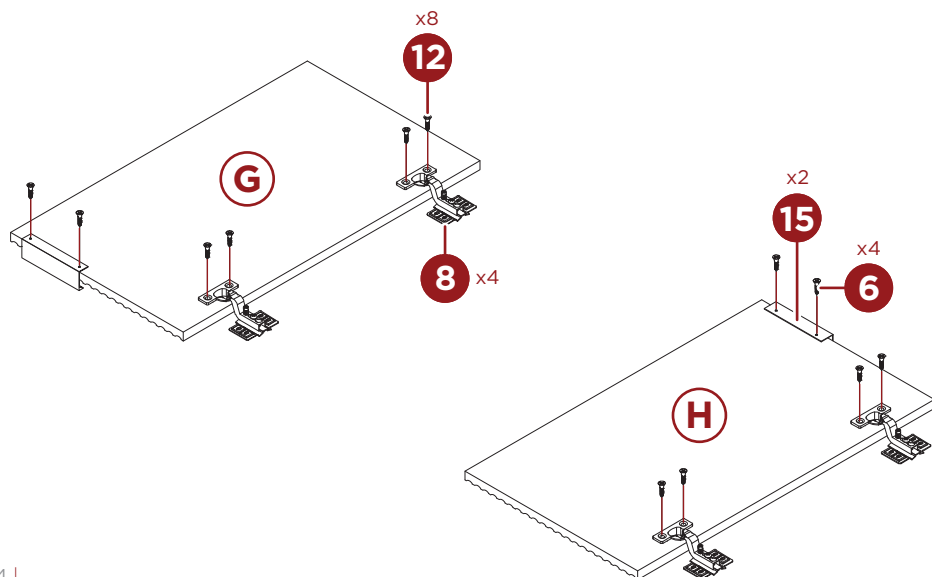

PRODUCT ASSEMBLY

20

Stand the cabinet assembly upright, then attach **part F & I doors** by securing the **part 7 hinges** to the cabinet side with sixteen **part 12 screws**, four screws per hinge. Repeat to attach the **part G & H doors**.

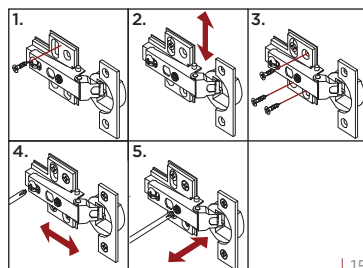
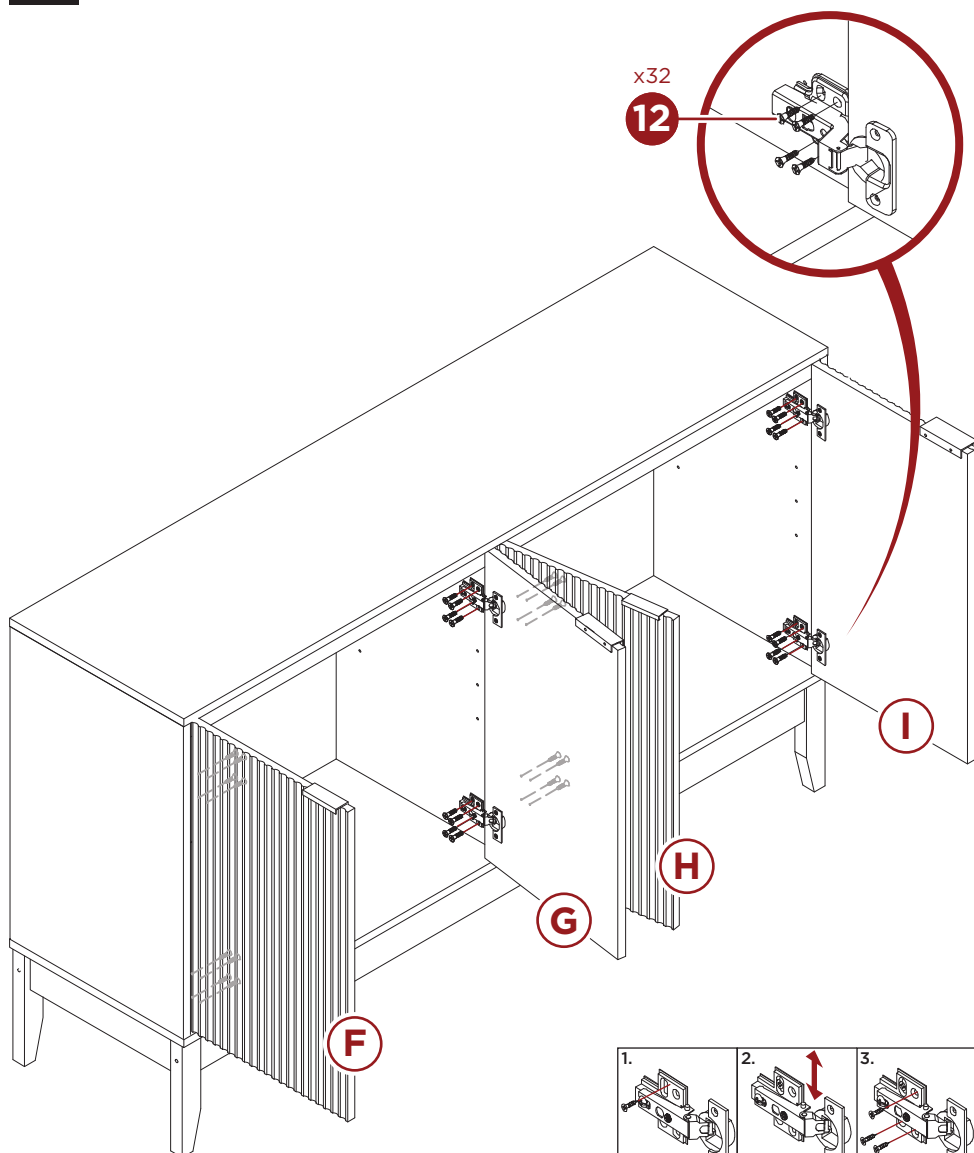

PRODUCT ASSEMBLY

21

Insert eight **part 5 shelf supports** into the **part D & part C cabinet sides** and **part E cabinet central panel** at your desired height.

NOTE: Be sure the shelf supports sit parallel to properly install the shelf.

Slide two **part R shelves** onto the **part 5 shelf supports**.

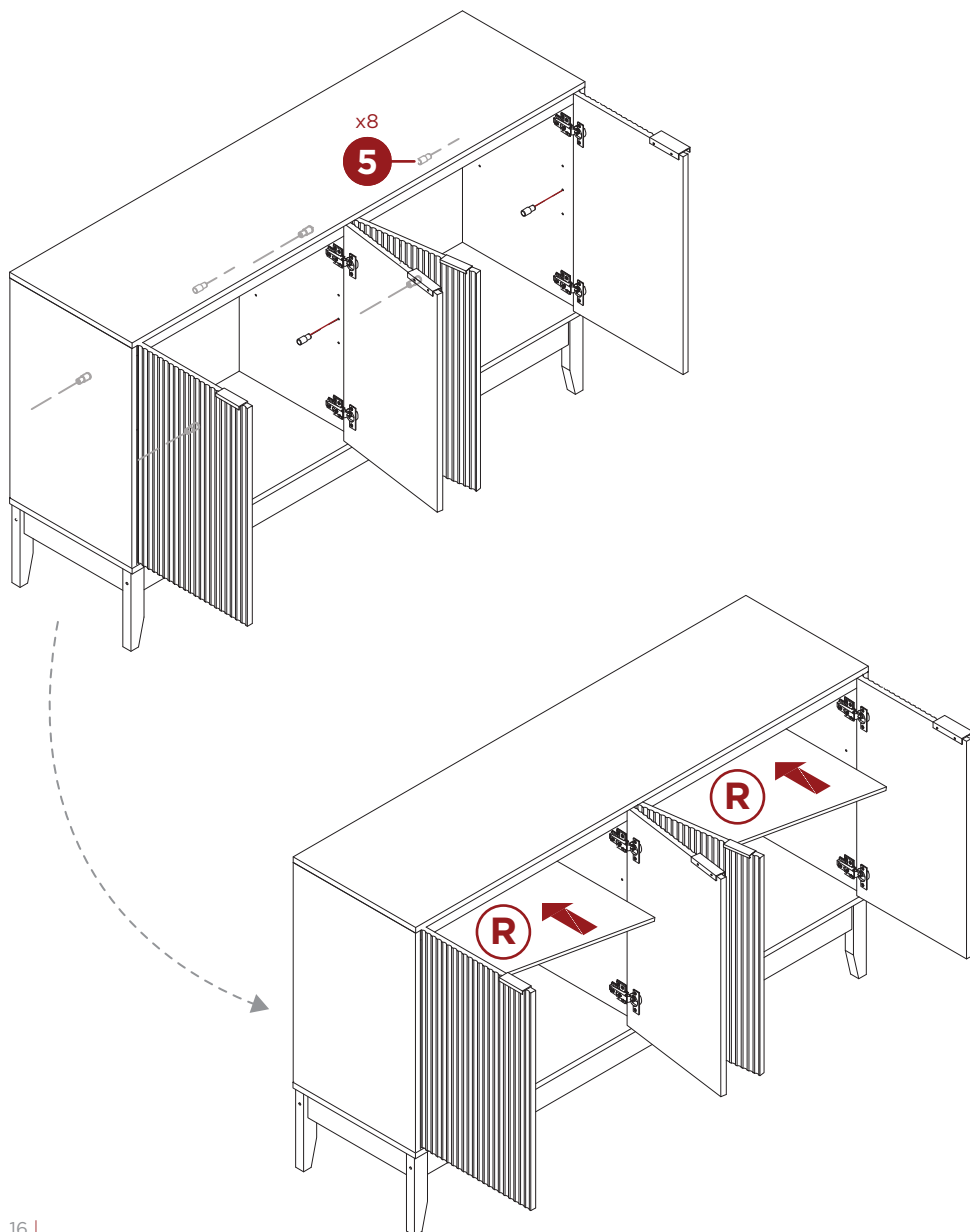

PRODUCT ASSEMBLY

22

Secure the **part N back boards** with sixteen **part 14 back screws and guides**.

Attach the **part 10 mounting straps** to the **part A cabinet top** with the included mounting screw.

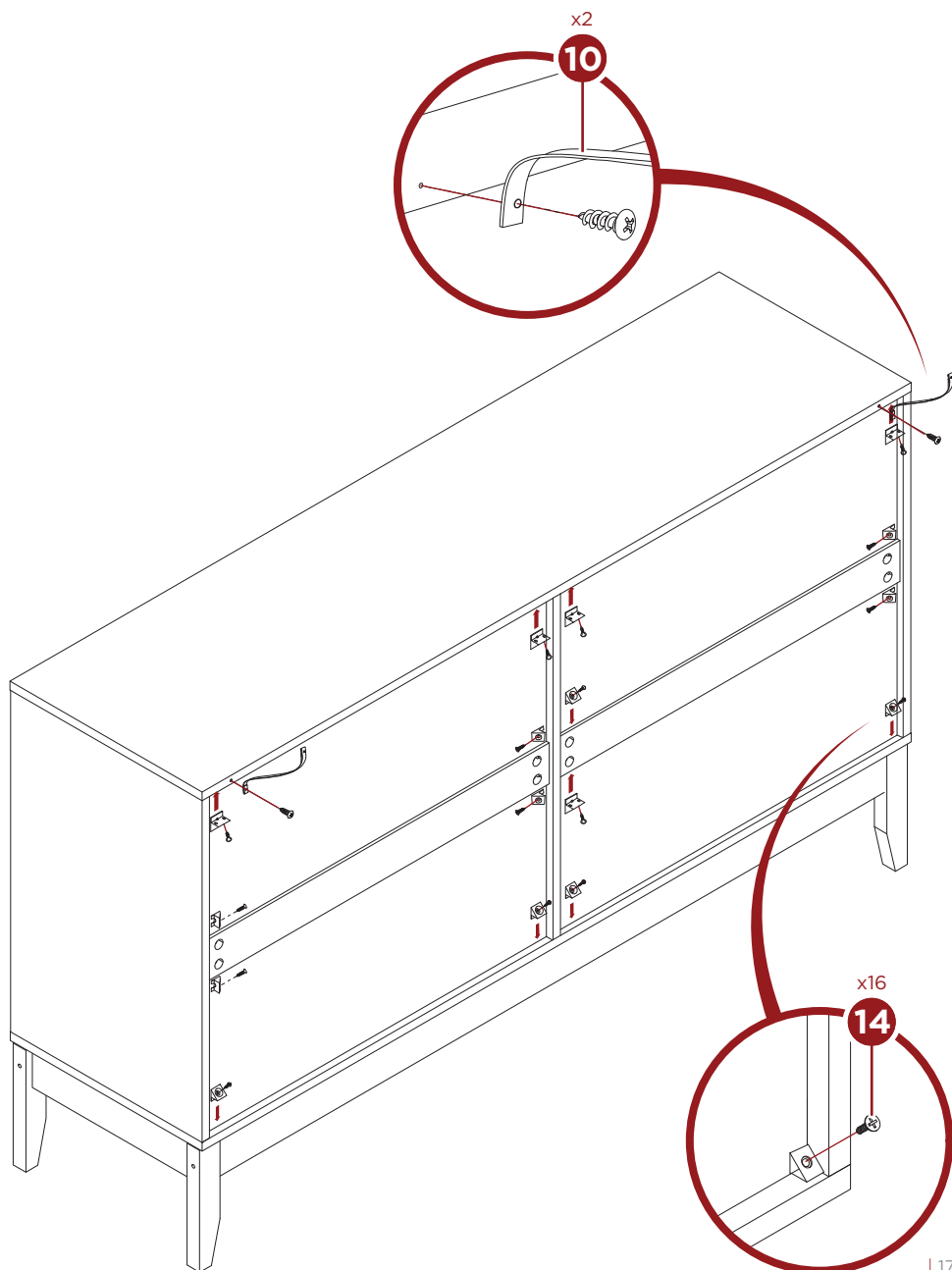

WALL MOUNTING

1. Select an appropriate location, then mark two spaces on the wall using the **part 10 mounting straps** as guides. Use a drill on the marked spaces.
2. Insert two included wall anchors into the new holes in the wall. Overlap the holes with the mounting straps, then attach the cabinet to the wall by drilling two **part 4 wood screws** through the **part 10 mounting straps** and into the wall anchors.

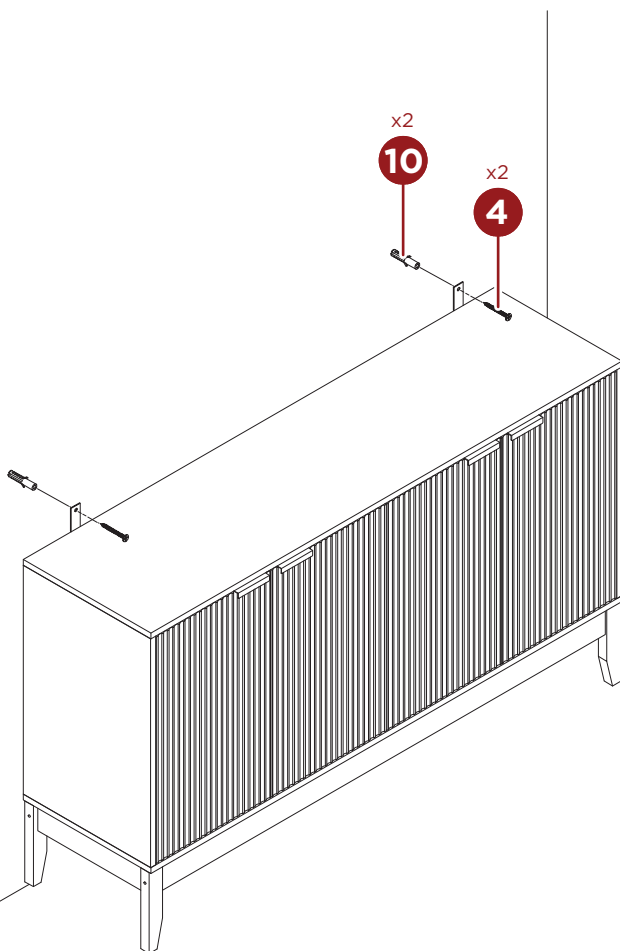
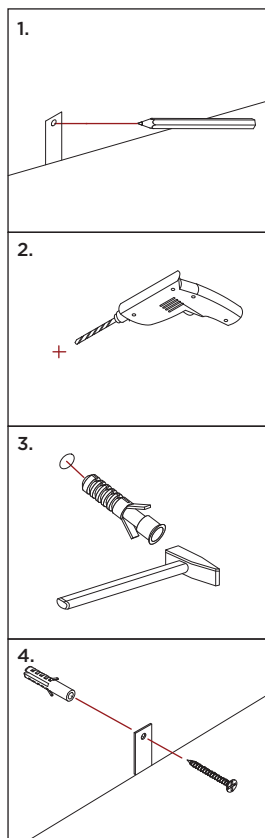

DOOR ALIGNMENT

If your door is too low or too high...

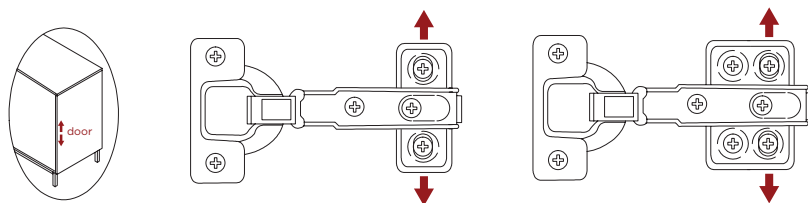

Loosen the height screws, then move the door up or down to make it level.

If you need to adjust the depth of the doors...

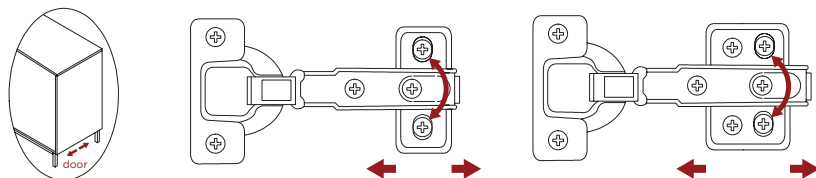

Adjust the in-and-out screws until the door is aligned with the side of cabinet.

If the space between your doors is off...

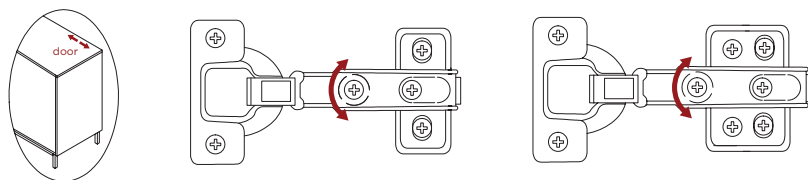

Loosen the side-to-side screws, then screw counter-clockwise to make the gap wider or clockwise to close any gaps.



HELP CENTER



Question about your product? We're here to help. Visit us at:

help.bestchoiceproducts.com



Chat Support



Product Inquiry



Orders FAQ



Product Assembly



Returns & Refunds

PRODUCT WARRANTY INFORMATION

All items can be returned for any reason within 60 days of the receipt and will receive a full refund as long as the item is returned in its original product packaging and all accessories from its original shipment are included. All returned items will receive a full refund back to the original payment method. All returned items will not be charged a re-stocking fee.

All returned items require an RA (Return Authorization) number, which can only be provided by a Best Choice Products Customer Service Representative when the return request is submitted. Items received without an RA may not be accepted or may increase your return processing time. Once an item has been received by Best Choice Products, refunds or replacements will be processed within 5 business days.

All returns must be shipped back to the Best Choice Products Return Center at the customer's expense. If the reason for return is a result of an error by Best Choice Products then Best Choice Products will provide a pre-paid shipping label via email. Boxes for return shipping will not be provided by Best Choice Products, and is the customer's responsibility to either use the original shipping boxes or purchase new boxes.

Pictures may be required for some returns to ensure an item is not damaged prior to its return. Items returned are not considered undamaged until they are received by Best Choice Products and verified as such. All damages to items are the customer's responsibility until the item has been received by and acknowledge by Best Choice Products as undamaged.

© Best Choice Products, Inc. All rights reserved. Distributed by Best Choice Products, Inc. Newport Beach, CA 92660



WARNING

Manufacturer and seller expressly disclaim any and all liability for personal injury, property damage or loss, whether direct, indirect, or incidental, resulting from the incorrect attachment, improper use, inadequate maintenance, unapproved modification, or neglect of this product.