

# How to use slide adjusters/ adjustable slide buckles

**What is a slide adjuster/buckle?** They adjust straps—straps for bags and totes—even suspenders and belts! Just as the name sounds, slide adjusters/buckles help you to adjust your straps for a better fit. They offer versatility by enabling you to convert shoulder straps to cross-body straps. The strap simply slides through the adjuster/buckle to shorten or lengthen.

They are designed to match the width of the strapping or belting, so a 1" slide adjuster/buckle is used with 1"-wide strapping. Some slide adjusters have teeth on one side to grip the strap; some do not.

Strap adjusters have a fixed center bar, while slide buckles have a movable center bar that slides to tighten the strap. The movable bar allows more room to insert a bulky or thicker strap. However, the technique for applying both styles is the same.

### You will need:

- Strapping/Belting
- 1 slide adjuster/adjustable slide buckle per strap
- 1 swivel hook, buckle or D-ring for each end. Project determines which you will need.
- Straight pins
- Scissors
- Fray Check®
- Sewing machine

### Slide adjusters:



Top side

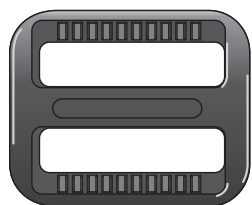

Bottom side

Item #455 has teeth on the bottom side.



Item 474 is the same on both sides

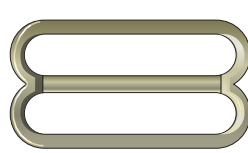

Item 457-38 is the same on both sides

### Adjustable slide buckles:

Both sizes have a movable center bar.



Item 726 is designed for 1" wide straps

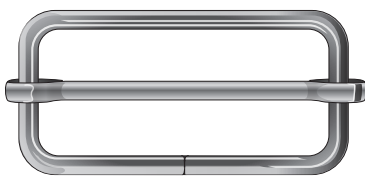

Item 780 is designed for 1-1/2" wide straps



## Connecting strapping to a slide adjuster/ adjustable slide buckle:

1. Slide the strapping through one center opening of the adjuster from the bottom to the top. Pass strapping over the center bar and then down through the opposite side opening.

2. Extend the working end about 3" under the adjuster. Fold the cut end of the strapping under 5/8" to 1" and pin. Keep in mind that your sewing machine must be able to stitch the strapping hem, so be sure you have allowed enough for the presser foot to be able to stitch without hitting the adjuster.

3. Stitch the hemmed strapping with a square; then stitch an 'X' through the square.

4. Pass the working end of the strap up through the opening of one swivel hook (buckle or D-ring), and then back toward the adjuster.

5. Continue the strapping up through the adjuster bottom to top, over the hemmed strapping and back through to the underside of the adjuster.

Always use Fray Check® on the cut end of the strapping before handling. Allow the Fray Check to dry before stitching.

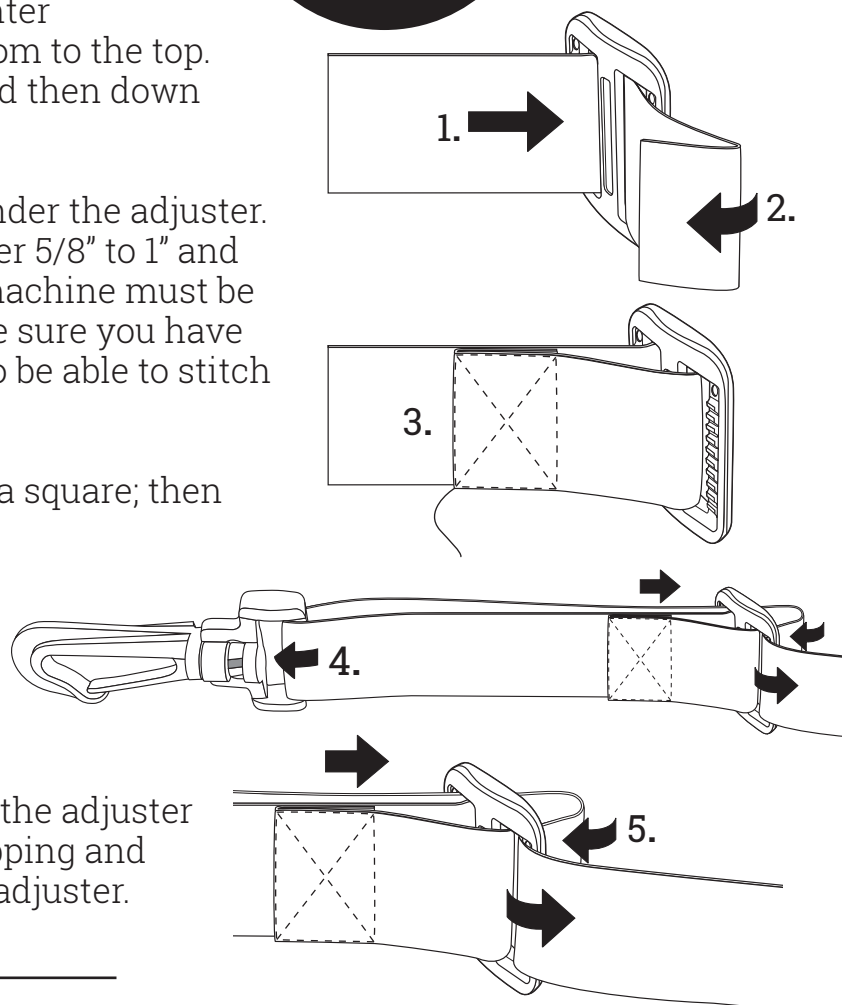

### UNDERSTANDING THE BIG PICTURE

The strap must connect to your project in two spots. One end is looped so it can slide to lengthen or shorten. The other end is stitched into the project or to a connecting device—either a buckle or a swivel hook. Be creative! Adding a combination of buckles and swivel hooks gives you lots of options and a great hardware panache! Our drawing shows swivel hooks being attached to the strapping at both ends. These swivel hooks would then attach to D-rings connected to the project. Swivel hooks, adjusters and D-rings are available in different shapes and coordinating finishes. We have drawn just one such option.

Illustrations show only the slide adjuster. However, the technique for applying the slide adjuster and the adjustable slide buckle is the same.



### Attaching the strap to a swivel hook:

6. Pass the strapping up through the second swivel hook (or buckle). Examine your strap to make sure the hem is on the same side as the one for the adjuster. Repeat step 1–3 to hem the strapping.

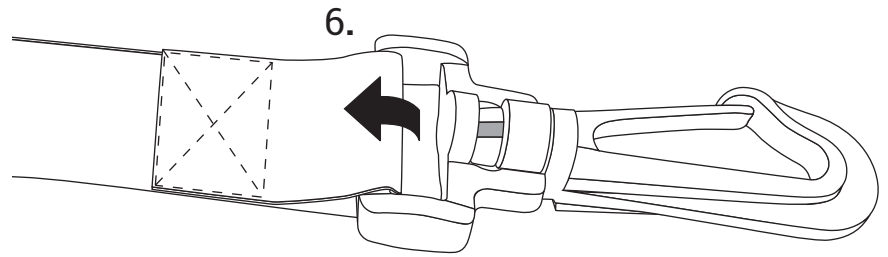

7. Attach the completed strap to the corresponding hardware on your project. A D-ring is shown.

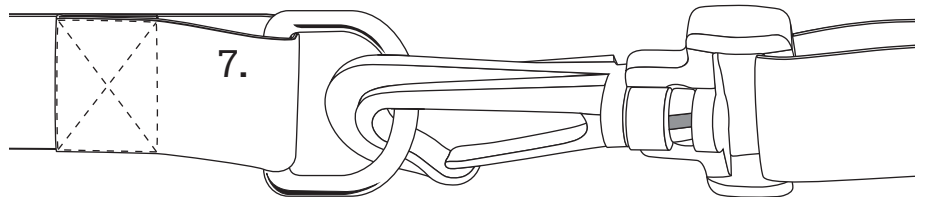

Attaching swivel hook to D-ring on project

