

hardware resources®

Slide and Hinge Installation Tool

Installation Instructions for the Multi-Tool

IMPORTANT:

Before you begin, make sure you familiarize yourself with all the parts and fully read the instructions.

CUSTOMER SERVICE:

Toll-free customer help line available weekdays between 7:00am and 6:00pm Central Time at 800-463-0660.

TOOLS NECESSARY:

Screw gun and drill bits. NOTE: If screw gun has a clutch, set to lowest setting so as not to over tighten and/or strip screws during installation.

PARTS IDENTIFICATION:

A	Mounting Jig	1 pcs
B	7mm Drill Bit	1 pcs
C	Drill Bit Depth Collar	1 pcs
D	Allen Wrench	1 pcs
E	2.5mm Drill Bit	1 pcs

Setting the drill bit depth for rear hook on slide

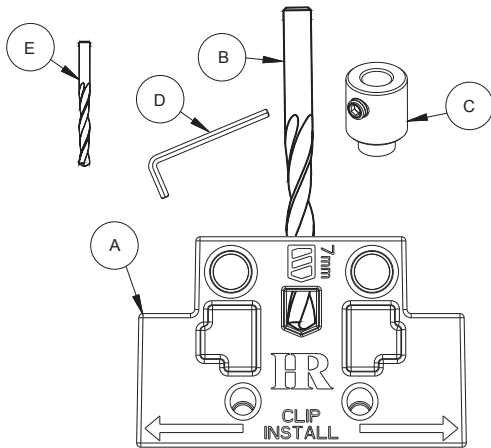

Place 7mm Drill Bit in set hold of jig as illustrated. Slide Drill Bit Depth Collar on Drill Bit and adjust it to set on the jig. Tighten allen set screw to secure collar.

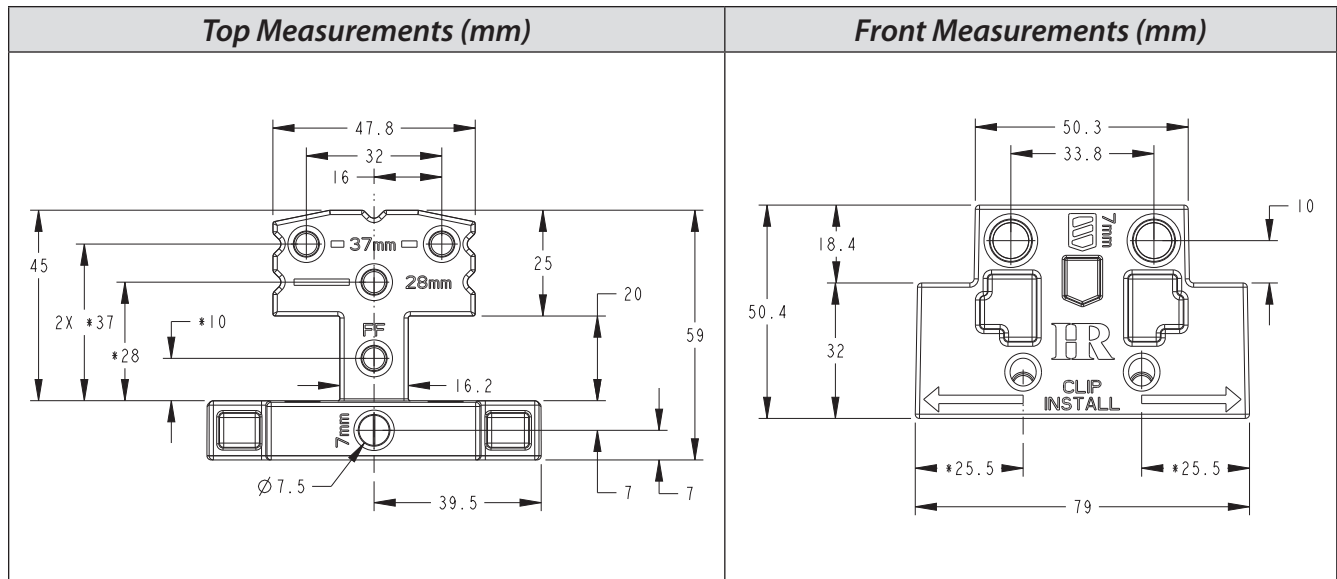

Drilling location for rear hook hole on drawer box; Left and Right

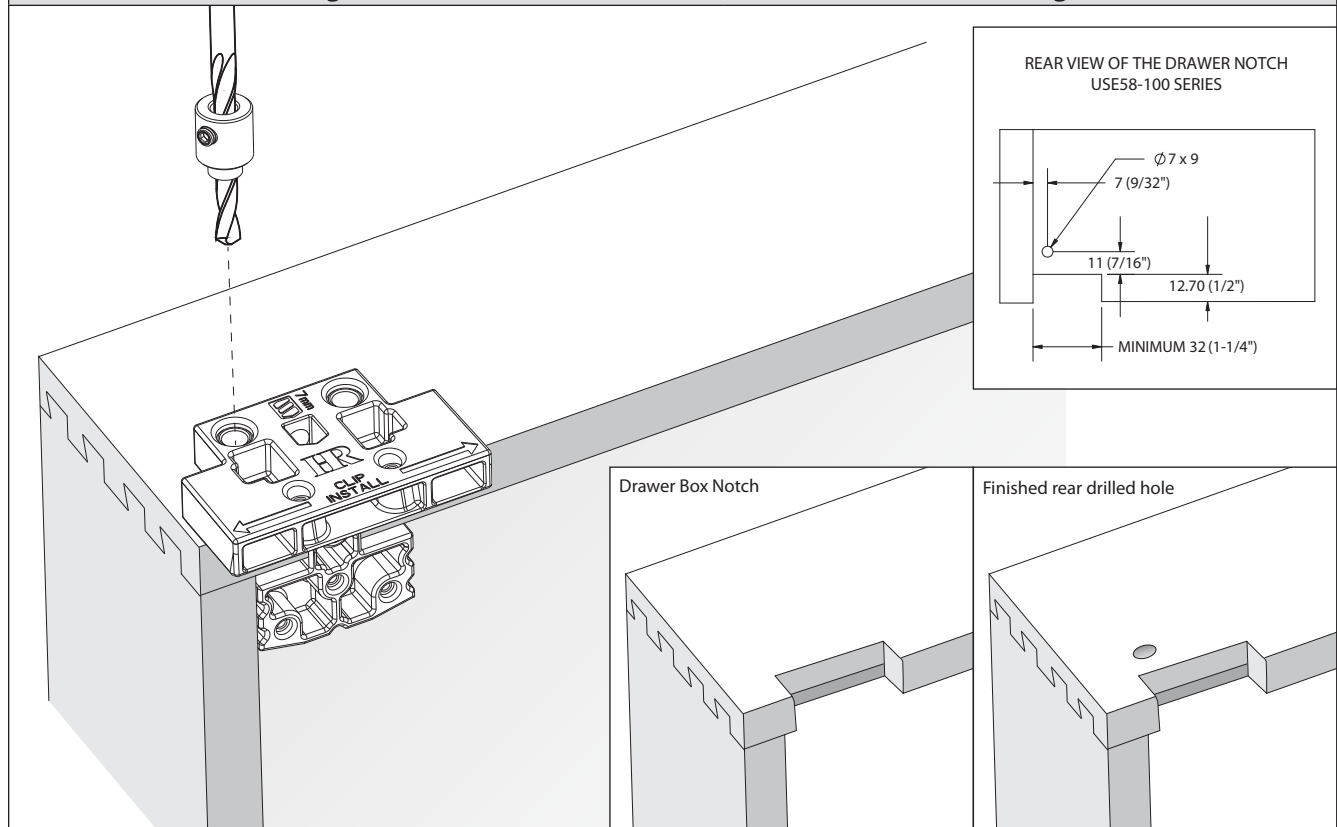

Place Mounting Jig in left or right drawer box notch as illustrated. Using the 7mm Drill Bit with collar set to depth, drill the slide rear hook hole. Repeat on opposite side.

Drilling Location for Hardware Resources Undermount Slide Clip

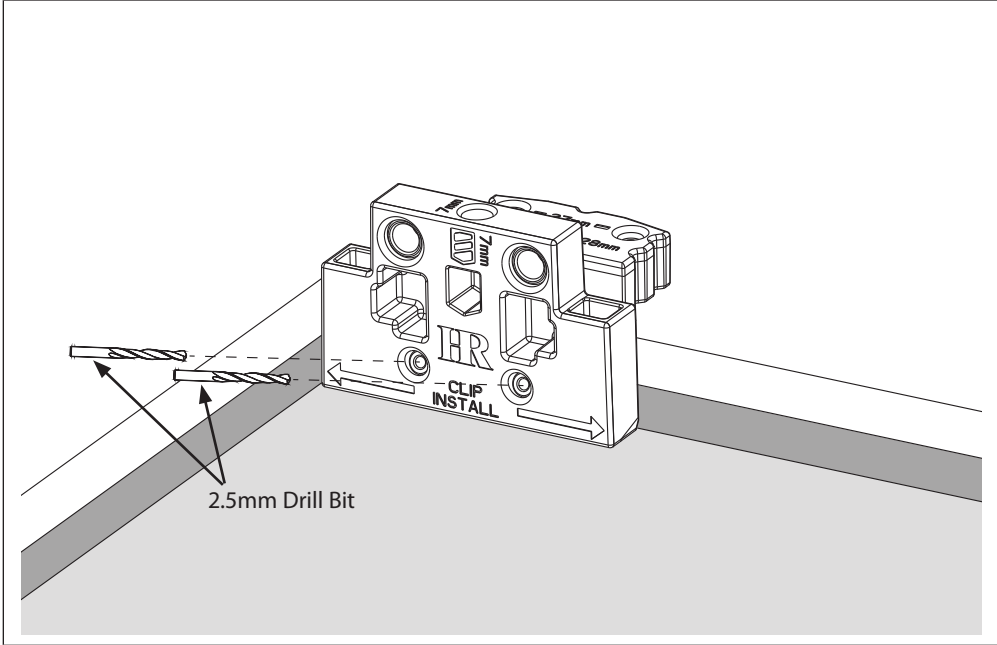

Drill Locations for Compact Hinge on Face Frame Cabinets

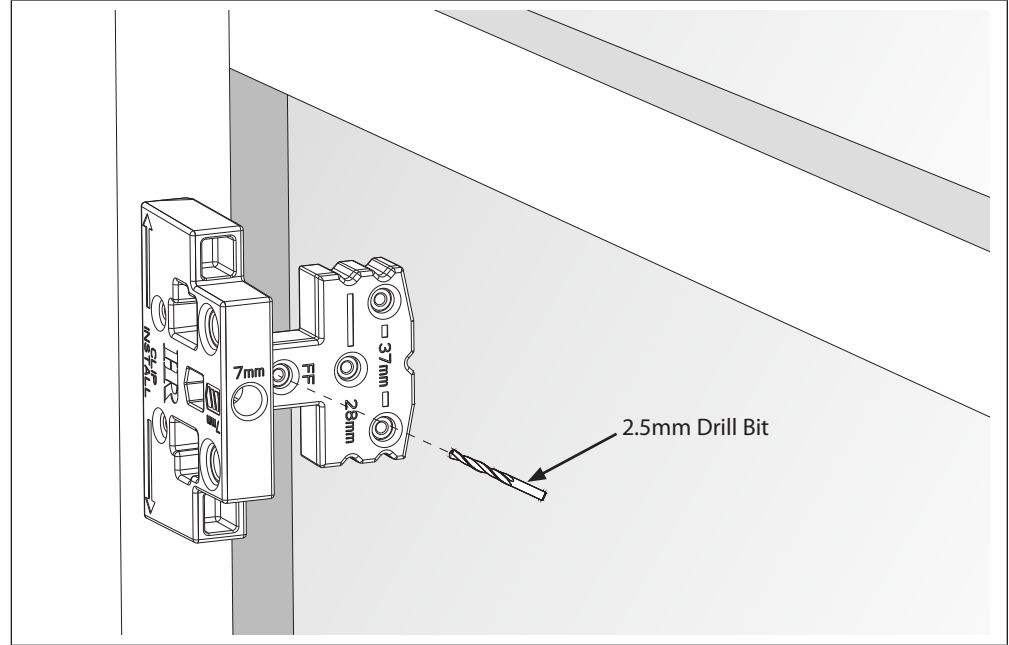

"V" Notches to Frameless Hinge Plate Holes at 28mm and 37mm Setback

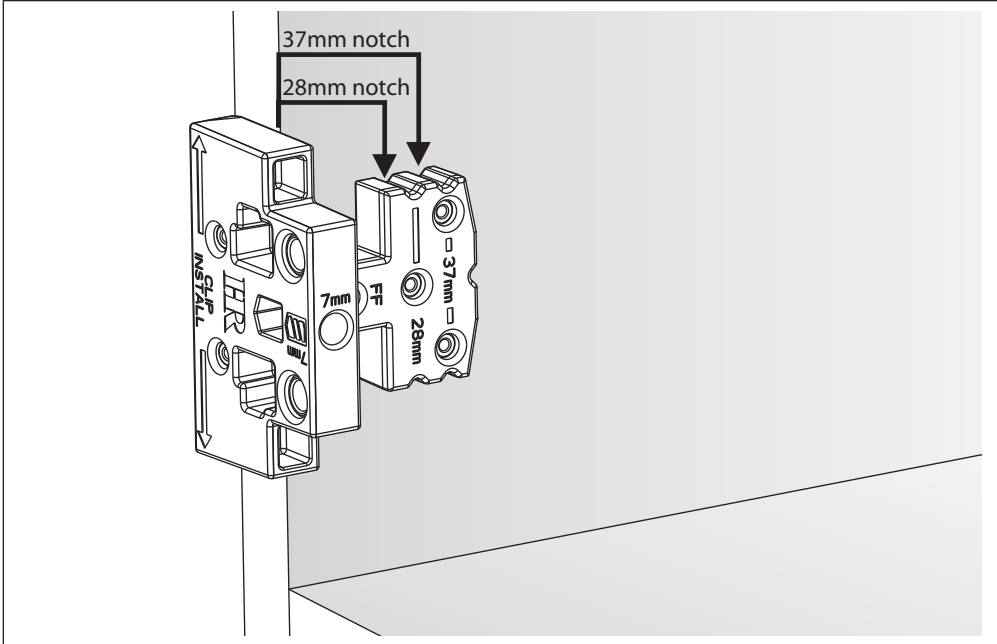

Drill Locations for Hinge Plates in Frameless Cabinets with 37mm Seback

