

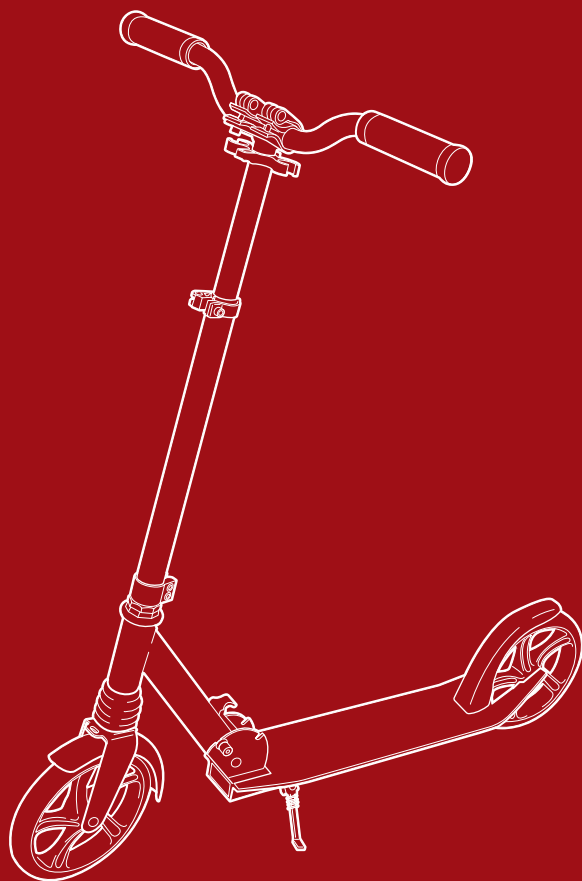

BEST CHOICE  
PRODUCTS



# INSTRUCTION MANUAL

---

Child's Folding Scooter



**BEST CHOICE  
PRODUCTS**

---

As shoppers, we're always trying to find the perfect balance between quality & value. At BCP, we believe we've achieved that. Our diverse catalog of everyday essentials is tailored especially to our customers & guaranteed to hit that sweet spot of high quality & low price.

— Always. —

## TOOLS REQUIRED



ALLEN WRENCH  
(PROVIDED)



AGE RANGE:  
8 YEARS OLD & UP



220 LBS  
CAPACITY



1 PERSON  
ASSEMBLY



UP TO 5 MIN.  
ASSEMBLY

## ! NOTICE

Please retain these instructions for future reference.

- Please read all instructions before attempting to assemble this item.
- This product contains small parts for assembly. Keep small children and pets away during assembly.
- Please do not exceed the weight limitations of this item.
- Do not stand on or use any part of this item as a step ladder.
- Firmly secure all bolts, screws, and knobs before use.
- Reconfirm that all bolts, screws, and knobs are secure every 90 days.
- Fasten screws loosely during initial assembly. Do not firmly tighten the screws until the item is completely assembled.
- Do not use or store this item in the proximity of open flame or flammable/combustible chemicals.
- Be aware that some parts are heavy and have sharp edges.
- If any parts are missing, broken, damaged, or worn, stop using this product until repairs are made and/or factory replacement parts are installed.
- Do not use this item in a way inconsistent with the manufacturer's instructions as this could void the product warranty.
- This product is intended for residential use only.

## ! WARNING

- Do not allow children to operate this scooter without first confirming it is in working order.
- This product is intended for manual movement, therefore falls or loss of control are possible.
- Do not allow children to ride this scooter too quickly, as this may result in personal injury or death.
- Do not use this item without the appropriate footwear; avoid open-toed sandals, high-heels, or slippers.
- Do not ride on unsafe roads; avoid sharp bumps, drainage, grates, and sudden surface changes, or the scooter may suddenly stop.
- Do not ride on surfaces with water, sand, gravel, dirt, leaves, and other debris.
- Do not ride this scooter at night.
- Do not ride this scooter in inclement weather such as rain or snow.
- Do not allow children to ride this scooter without proper safety equipment such as a helmet, kneepads, and elbow pads.
- Do not ride this scooter in traffic.
- Do not ride this scooter downhill on slopes as the brake does will not functional at high speeds.
- Do not brake for an extended period of time.
- The brake will get hot during use. Do not touch the brake directly after use.

## PRODUCT ASSEMBLY

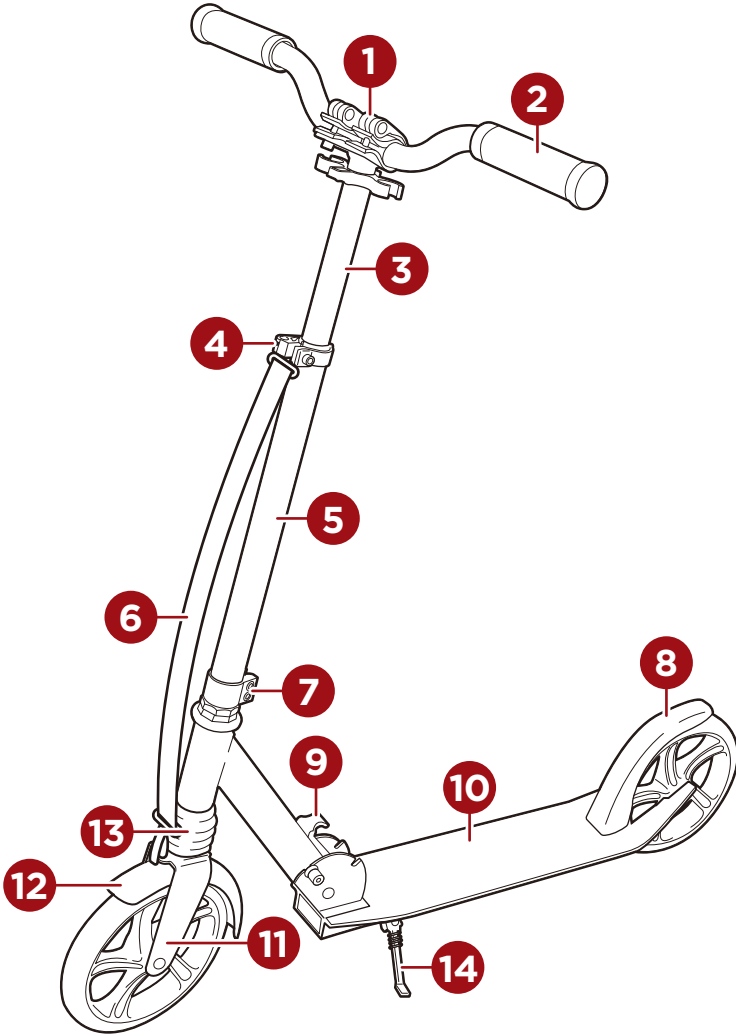

1. Handlebar Lock

2. Handlebar

3. T-Tube

4. Steering Tube Release Lever

5. Steering Tube

6. Carrying Strap

7. Collar Clamp

8. Rear Fender/Brake

9. Joint Lever

10. Deck

11. Front Fork

12. Front Fender

13. Suspension

14. Kickstand

## BEFORE ASSEMBLY

To ensure proper assembly, be sure to remove all packing materials. Locate and remove the wedge from the handlebar lock before assembly.

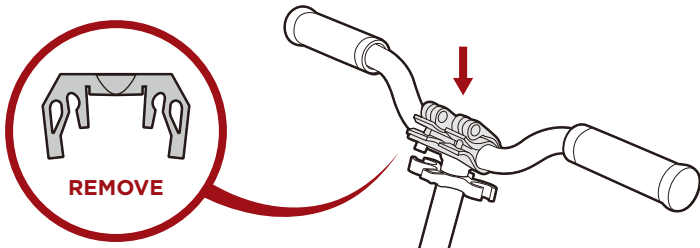

## PRODUCT ASSEMBLY

1

Hold the **part 3 T-tube** with one hand, then raise the **part 9 joint lever** and the secondary latch to release the **part 10 deck**. Pull the deck and t-tube apart until you hear an audible click. Replace the secondary latch to set the lock. The scooter is now in the upright position.

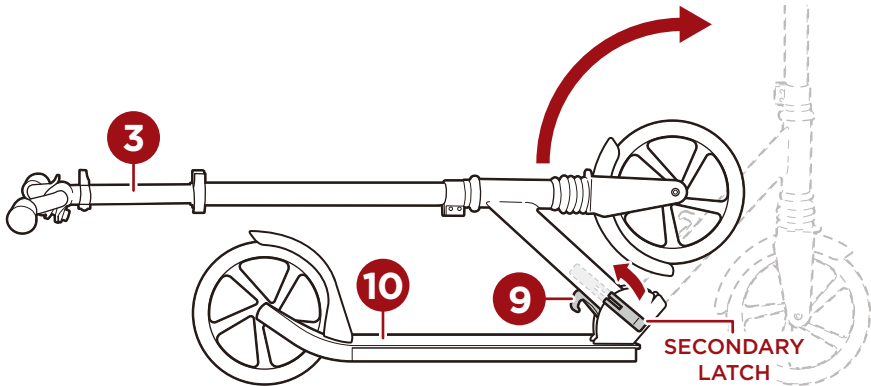

2

Lift the **part 1 handlebar lock**, then press down on the spring-loaded buttons on the **part 2 handlebars**. Insert the handlebars into the **part 3 T-tube** and allow the buttons to engage the openings on the T-tube. Press the **part 1 handlebar lock** back down to secure the handlebars.

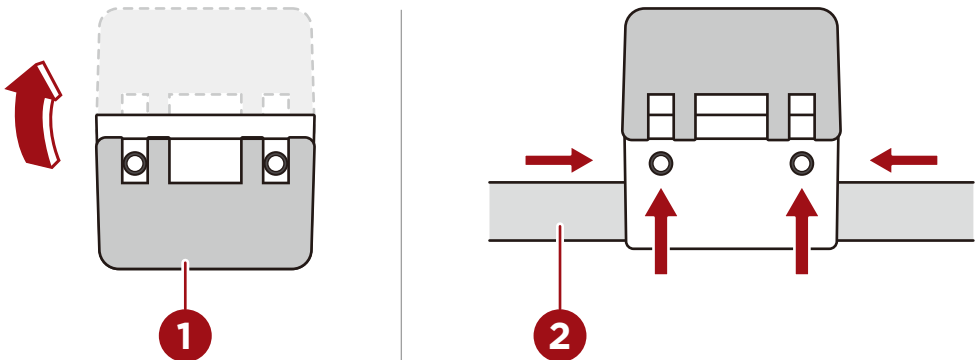

## PRODUCT ASSEMBLY

3

Unlatch the **part 4 steering tube release lever** then press down the spring-loaded button. Slide the **part 5 steering column** up or down to suit your child's height. Relatch the lever to lock the steering tube in place, tighten with the adjacent bolt if necessary.

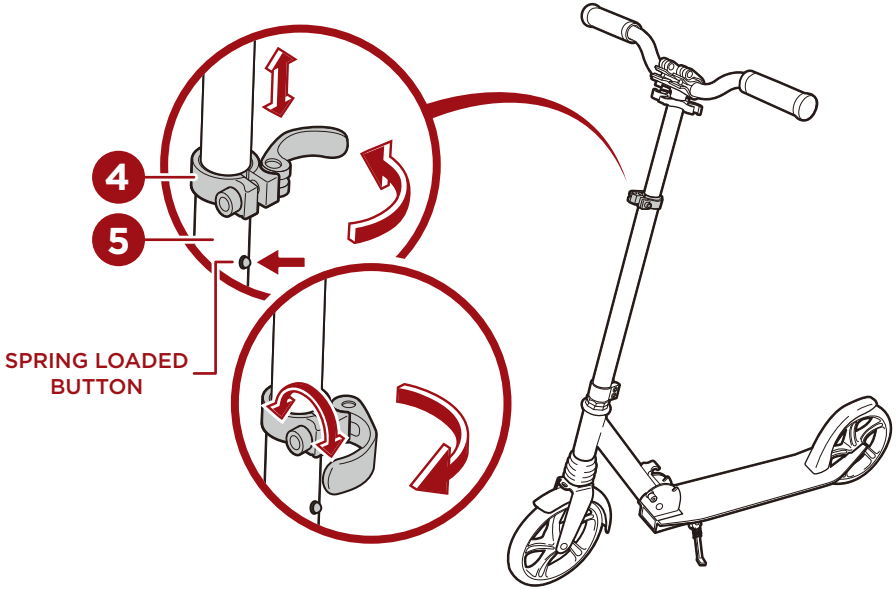

4

Check that the **part 7 collar clamp** is secure, tighten if necessary. Attach the **part 6 carrying strap** to the **part 11 front fork** and handlebar holder.

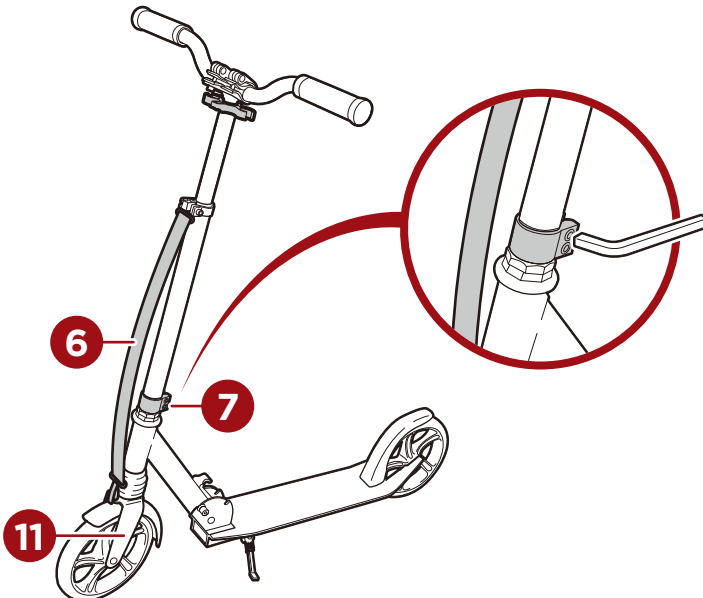

Earn points while you shop. Join today!

bestchoiceproducts  
**rewards**

Join | Earn | Redeem

Give your friends 15% off their first order! For each successful referral you'll receive 100 points.

[bestchoiceproducts.com](https://bestchoiceproducts.com)



# HELP CENTER



Question about your product? We're here to help. Visit us at:

[help.bestchoiceproducts.com](http://help.bestchoiceproducts.com)



Chat Support



Product Inquiry



Orders FAQ



Product Assembly



Returns & Refunds

## PRODUCT WARRANTY INFORMATION

All items can be returned for any reason within 60 days of the receipt and will receive a full refund as long as the item is returned in its original product packaging and all accessories from its original shipment are included. All returned items will receive a full refund back to the original payment method. All returned items will not be charged a re-stocking fee.

All returned items require an RA (Return Authorization) number, which can only be provided by a Best Choice Products Customer Service Representative when the return request is submitted. Items received without an RA may not be accepted or may increase your return processing time. Once an item has been received by Best Choice Products, refunds or replacements will be processed within 5 business days.

All returns must be shipped back to the Best Choice Products Return Center at the customer's expense. If the reason for return is a result of an error by Best Choice Products then Best Choice Products will provide a pre-paid shipping label via email. Boxes for return shipping will not be provided by Best Choice Products, and is the customer's responsibility to either use the original shipping boxes or purchase new boxes.

Pictures may be required for some returns to ensure an item is not damaged prior to its return. Items returned are not considered undamaged until they are received by Best Choice Products and verified as such. All damages to items are the customer's responsibility until the item has been received by and acknowledge by Best Choice Products as undamaged.

## WARNING

Manufacturer and seller expressly disclaim any and all liability for personal injury, property damage or loss, whether direct, indirect, or incidental, resulting from the incorrect attachment, improper use, inadequate maintenance, unapproved modification, or neglect of this product.