

# 2600CC – EVERYDAY BATHS

60 x 60 x 22 inches

SOAKER MODEL #2600CC

WHIRLPOOL MODEL #2600CCWP



## FEATURES

- Corner bath
- Integral arm rests
- Ergonomic backrest
- Integral tiling flange (2T)
- Molded toiletry shelf
- Slip-resistant textured bottom
- Center drain
- AcrylX™ applied acrylic surface
- Lifetime limited warranty

### Whirlpool Features:

- 4 directional hydrotherapy jets
- Available in White and Biscuit/Linen only
- Color matched trim
- Pneumatic on/off control
- Advanced safety suction system

## OPTIONS

- Designer drain, waste & overflow

## AQUATIC ADVANTAGE

- National distribution
- 7 manufacturing facilities
- Private fleet
- Centralized customer service
- Field support

## COLOR OPTIONS

Stock	Upgraded	Premium
White	Almond Biscuit/Linen Bone	Black Mexican Sand Sand Bar Sterling Silver



# 2600CC

60 x 60 x 22 inches

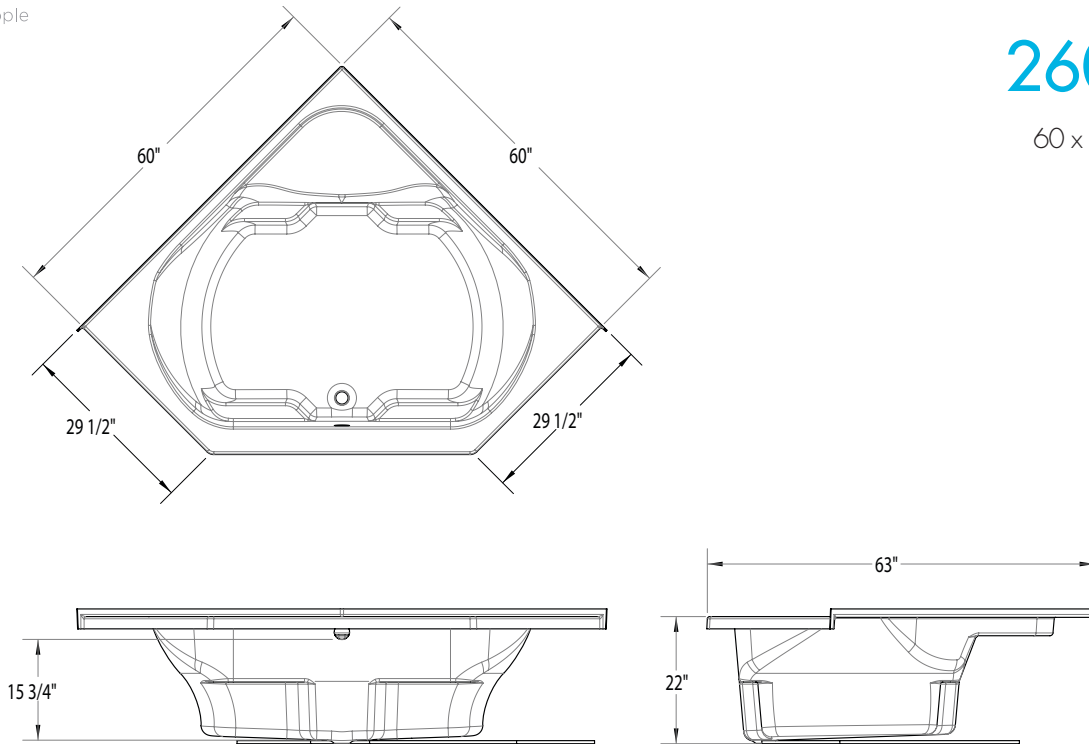

**FEATURES** lbs      Dimensional Tolerance  $\pm \frac{3}{16}$ ". Dimensions needed for site preparation should be measured from the unit. Aquatic assumes no responsibility for preparatory work.

Model #	Material	Jets	Motor	Controls	Drain	Net Wt.	Pkg. Wt.
Soaker #2600CC	AcrylX™	0	-	-	Center Front	95	100
Whirlpool #2600CCWP	AcrylX™	4	63 GPM	Pneumatic	Center Front	145	150

## DIMENSIONS

Specifications	inches
Width: Overall / Net	60
Depth: Overall / Net	28
Height: Overall / Net	23 ¼ / 22
Enclosure Opening	-
Skirt Height	22
Drain Rough-In (from Back Wall)	42 5/16
Drain Rough-In (from Side Wall)	42 5/16
Drain: Diameter / Clearance	2 / 1 ¼

## FRAMING DIMENSIONS inches

Type	D Depth	W Width	H Height	A	B	C
Alcove	27 ½	58 ½	21 ¾	Box Out	42 5/16	42 5/16

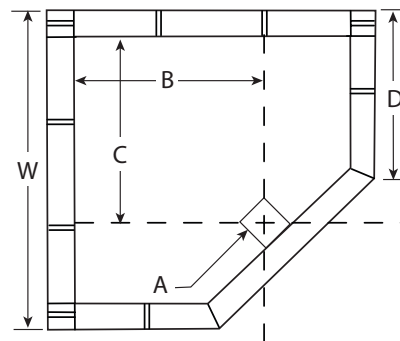

## SUMP DATA

Top of Drain to Bottom of Overflow	Capacity to Overflow gal	Min. Operating Capacity gal	WIDTH @ centerline		DEPTH @ centerline	
			Top	Bottom	Top	Bottom
15 ¾	90	50	63	44 ¾	37	33