

Power Reclining Sofa with Power Headrest & Lumbar

IMPORTANT NOTE

Read these instructions carefully, and familiarize yourself with each procedure before assembling the furniture. Check that you have all the component parts, and familiarize yourself with each part before proceeding.

Take all the fittings out of the plastic bag and separate them into groups. Ensure you have enough space to lay out all the parts before assembly. To prevent damage to the parts, we recommend that you assemble the unit on a soft, level surface.

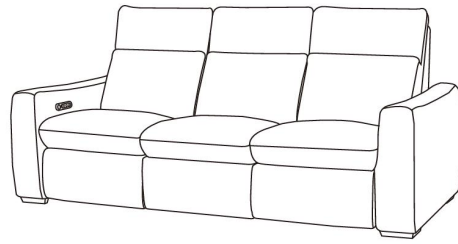

Part List

A. Back
3 pieces



B. Seat
1 piece

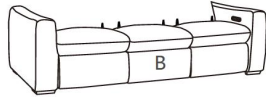

C. Transformer
1 piece



Assembly Instructions

STEP 1

Take out the Transformer (C) from the bottom of the Seat (B). (See Figure 1)

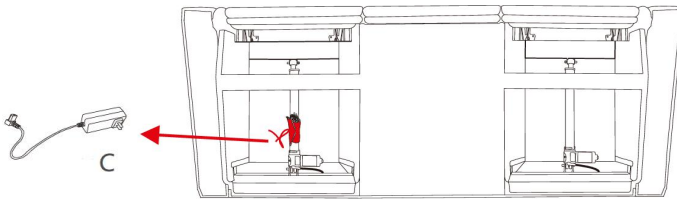

Figure 1

STEP 2

Attach the Backs (A1 A2 A3) to the Seat (B), ensure the latches fit well. (See Figure 2)

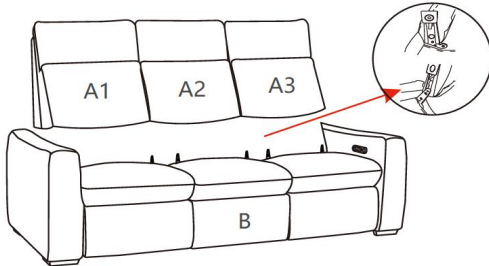

Figure 2

STEP 3

Zip the fabric on the bottom of the Backs (A1 A3) with the back of the Seat (B). (See Figure 3)

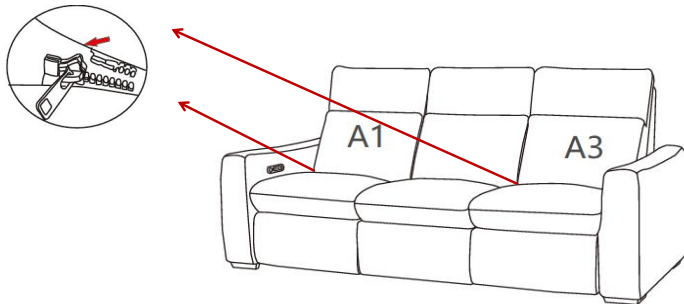

Figure 3

STEP 4

Flip up the back flaps, and remove the cables from the Left and Right Backs (A1 A3)
Connect the headrest and lumbar cables. No label for headrest and yellow for lumbar. (See Figure 4)

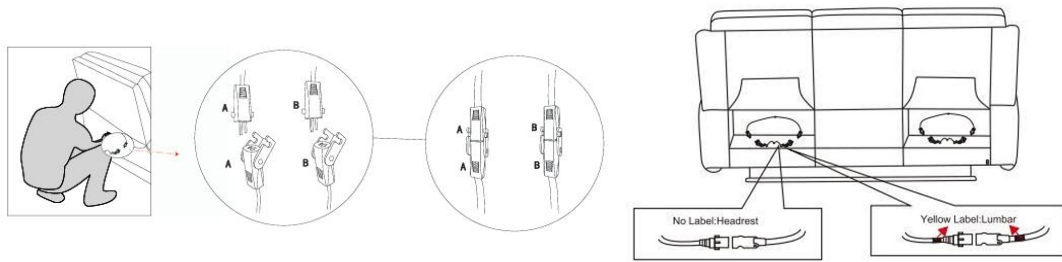

Figure 4

STEP 5

Connect the Transformer (C) into the power port on the back of the seat (B).
Plug Transformer (C) into nearby outlet, still making sure it is clear of the metal base. (See Figure 5).
Fasten the back flaps to the bottom of the furniture. (See Figure 6)

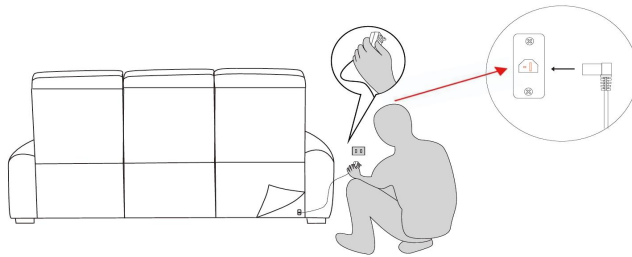

Figure 5

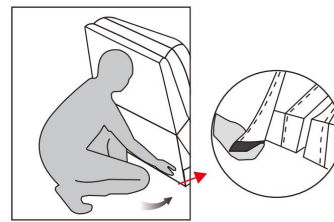

Figure 6

Disassembly Instructions

Unzip the zipper between Backs (A1 A3) and Seat (B), then disconnect all cables.
Pull up the spring leaf in bracket, then lift Backs (A1 A2 A3) up. (See Figure 7)

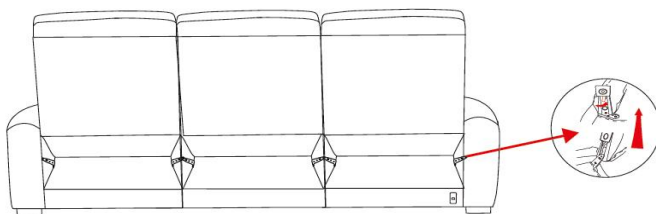

Figure 7

IMPORTANT NOTE

- To avoid any risk of suffocation to children or pets, dispose of all plastic bags
- To ensure proper performance, occasionally check for loose screws and tighten
- If the reclining functions are not working properly, check for loose cable connections before contacting the retailer.