



Text 1-812-652-2525
(US and Canada only, carrier fees may apply)



Visit www.maxicosi.com



Call 1-800-544-1108



Email support@djgusa.com



Learn More

©2024 Dorel Juvenile Group, Inc. (800) 951-4113 www.maxicosi.com. Styles, colors, and labeling may vary. Made in China. Distributed by Dorel Juvenile Group, Inc., 2525 State St., Columbus, IN 47201-7494. Dorel Juvenile Canada, 2233 Argenta Road, Suite 110, Mississauga, ON L5N 2X7. Representante exclusivo en Chile: DOREL JUVENILE CHILE S.A. Av. del Parque 4161, oficina 602 A, Huechuraba, Santiago, Chile - Fono: 56 2 24971500 - www.infanti.cl - www.dorel.cl. Importado y distribuido en Perú por: COMEXA COMERCIALIZADORA EXTRANJERA S.A. SUCURSAL DEL PERÚ - Los Libertadores 455, San Isidro, Lima 27, Lima, Perú RUC 20431062870 - Fono: 4413029 - www.infanti.com.pe. En Centro América, Caribe y Ecuador por: Best Brands Group S.A. - Av. Balboa, Bay Mall Plaza, Planta Baja, local 9, Panamá. - Fono: (507) 300 2884. En Colombia por: Baby Universe S.A.S. - Vía 40 No. 77-29, Barranquilla, Colombia - Fono: (575) 353 1110 Importador: DJGM, S.A. DE C.V. Gabriel Mancera No. 1041 Col. Del Valle, Benito Juárez C.P. 03100 México, Ciudad de México R.F.C. DJG140305GN9 Tel. (55) 67199202 03/24 4358-8521



MAXI-COSI[®]
KINDRED COLLECTION

Tana
360° Rotating
Modular Stroller

CV452

Keep these instructions for future reference.





Introducing the Maxi-Cosi Kindred Collection

Our Maxi-Cosi Kindred Collection is inspired by the ancestry, connection, and inseparable bonds of Family. When you choose to invite us into your home, you allow us to become a part of your life.

These pieces are more than furniture or baby products—they're carriers and keepers of cherished memories and family ties. Their exceptional quality and craftsmanship mean that the memories they'll make are countless. Each Maxi-Cosi Kindred Collection piece is thoughtfully created, reflects a timeless design, features special metals and EcoCare premium, recycled fabric made from plastic bottles, and is meant to be loved and shared.

The Maxi-Cosi Kindred Collection
Lineage in design.

Table of Contents

QUICK START GUIDE.....	5
WARNINGS	7
ASSEMBLY	11
Parts	12
Unfolding the Stroller	14
Rear Wheels	15
Front Wheels	15
Seat	16
Cup Holder	17
Bumper Bar	17
USE	19
Brake	20
Adjusting the Seat	20
Leg Rest	21
Canopy	21
Handlebar	21
Rotating the Seat	22
Removing the Seat	23
Restraint System	24
Adjusting the Shoulder Restraints	26
Folding the Stroller	28
Installing an Infant Car Seat	31
Removing an Infant Car Seat	33

CARE AND MAINTENANCE	34
Replaceable Parts	35
Warranty Information	35

360° Rotation Quick Start Guide

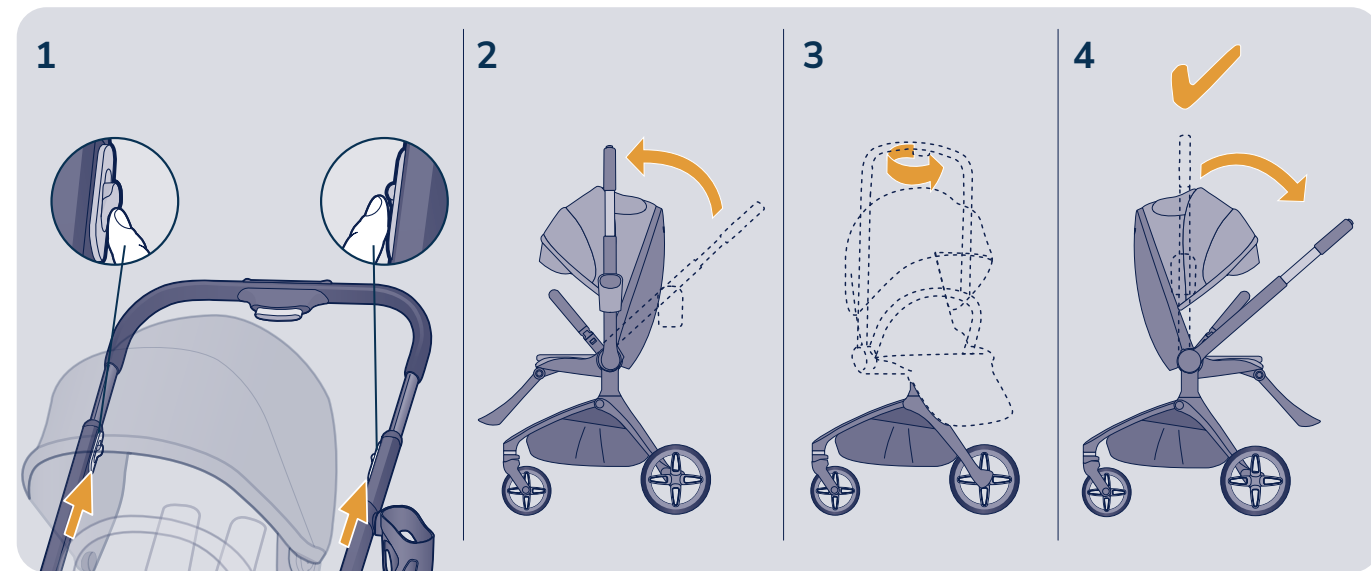

See back cover for contact information and support.

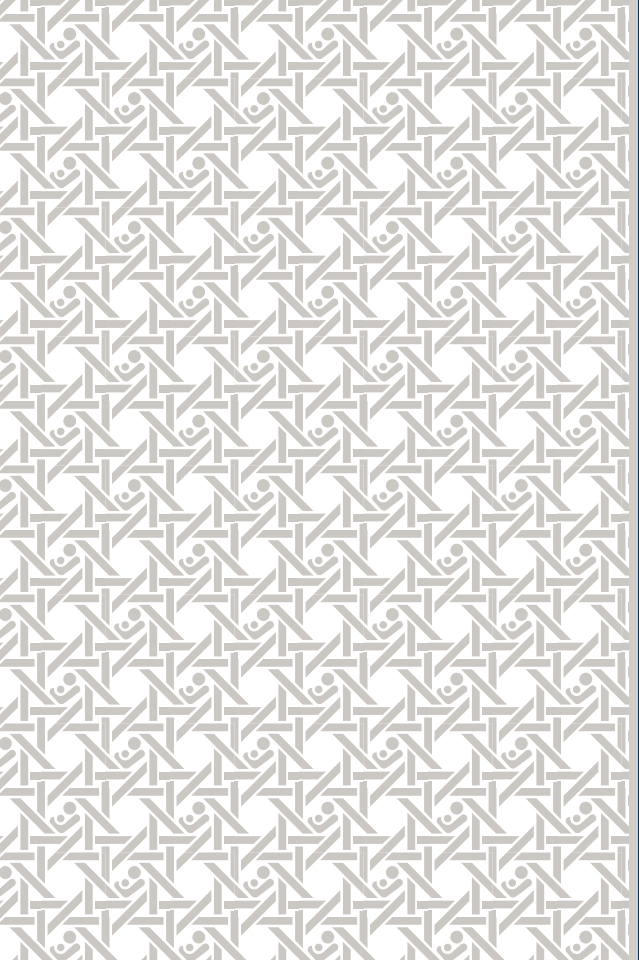

Warnings

Read all instructions before assembly and use of product. Keep instructions for future reference.

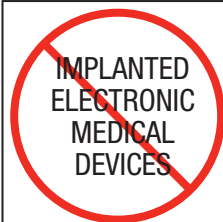

Do not use the magnetic chest clip with children who have an implanted electronic medical device. A magnet is used to help secure the chest clip locking mechanism together which may interfere with proper function of an implanted electronic medical device. Parents or caregivers who have an implanted electronic device should keep their device away from the chest clip and consult their doctor and medical device manufacturer for specific information before using the chest clip. If a parent/caregiver or child has an implanted electronic medical device, please contact Dorel Juvenile (see page 35) for a replacement (non-magnetic) chest clip free of charge.

WARNING

- **NEVER LEAVE CHILD UNATTENDED. ALWAYS** keep child in view when in stroller.
- **AVOID SERIOUS INJURY** from falling or sliding out. **ALWAYS** use the harness system. Check frequently to make sure it is secure.
- **ALWAYS** keep fingers away from moving parts, when folding, unfolding or adjusting stroller to prevent finger entrapment.
- **ALWAYS** make sure stroller is **FULLY OPEN AND LOCKED** before using.
- **ALWAYS** use the brakes when stroller is stopped.
- **ALWAYS** remove protective material and poly bags and dispose before assembly.
- **NEVER** put hot liquids in the cup holder.
- **NEVER** use stroller on stairs or escalators.

WARNING

- **NEVER** rollerblade with stroller.
- **NEVER** allow children to play with or hang onto the stroller.
- **NEVER** allow children to climb into the stroller unassisted. Stroller may tip over and injure child.
- **NEVER** place or hang parcels, bags or accessories on the product, handle or canopy. The stroller may become unstable, or tip over.
- This product may become unstable if package carrying accessories, other than recommended by the manufacturer are added.
- This product will become unstable if the manufacturer's recommended loads are exceeded.
- **NEVER** place more than 2 lbs (0.9 kg) in cup holder.
- **NEVER** place more than 10 lbs (4.5 kg) in the storage basket. If weight is exceeded, hazardous unstable conditions may exist.
- **STROLLER** mode is only for use with children who can sit up unassisted, up to 50 lbs (22.7 kg), and **WHEN SEATED**, the midpoint of the child's head is at or below the top of the stroller seat.
- **ONLY** use this stroller with **ONE** child at a time unless manufacturer recommends otherwise.
- Failure to follow the warnings and the instruction manual steps can result in death or serious injury to your child.



Assembly

Parts

- A Stroller frame
- B Telescoping handle adjust button
- C Frame turn/fold triggers
- D Fold release bar
- E Cup holder
- F Rear wheels (2)
- G Front wheels (2)

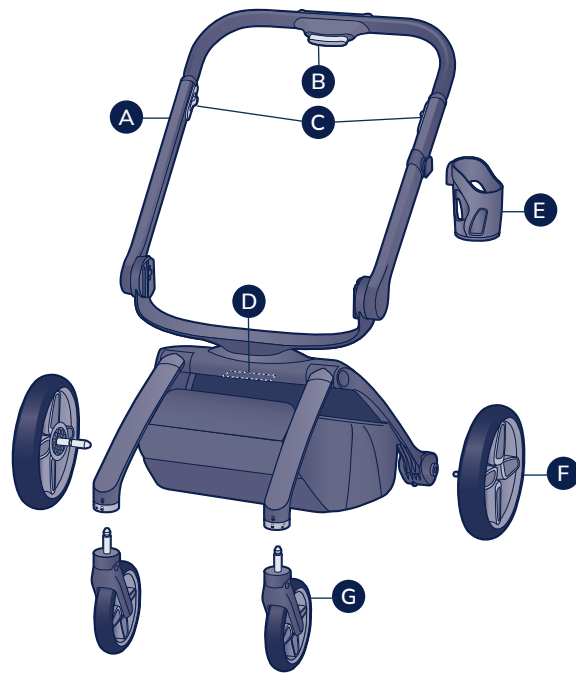

Parts

- H Seat
- I Canopy
- J Seat recline lever (on back of seat)
- K Seat release buttons (2)
- L Leg rest adjust buttons (2)
- M Carry handle (underneath seat)
- N Bumper bar
- O Infant car seat adapters (2)



No tools required.

Adult assembly required.

Assembly

Unfolding the Stroller

Squeeze the fold release bar under the frame (identified with a label) and pull the frame to open the stroller. It will click into place (Figure 1b).

Then raise the handlebar until it clicks (Figure 1c).

1a

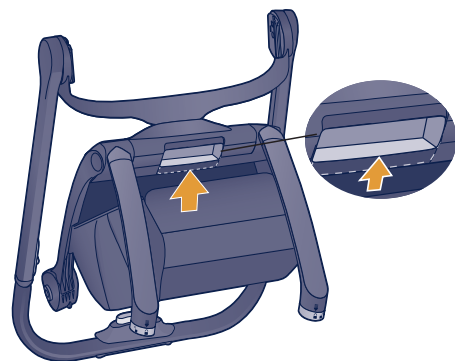

1b

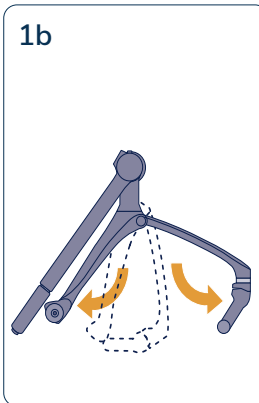

1c

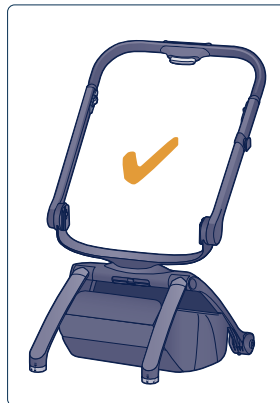
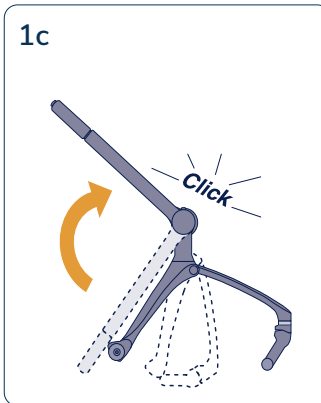

2a

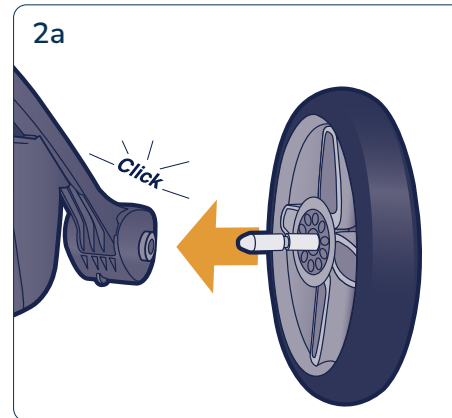

2b

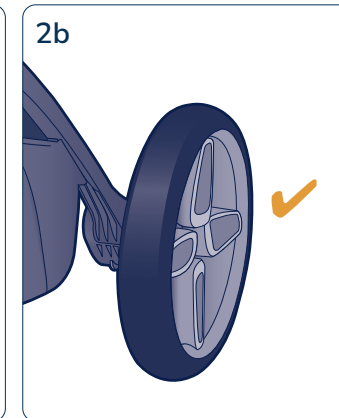

3a

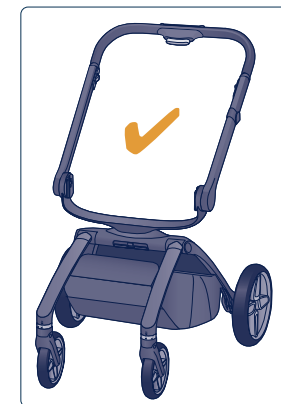
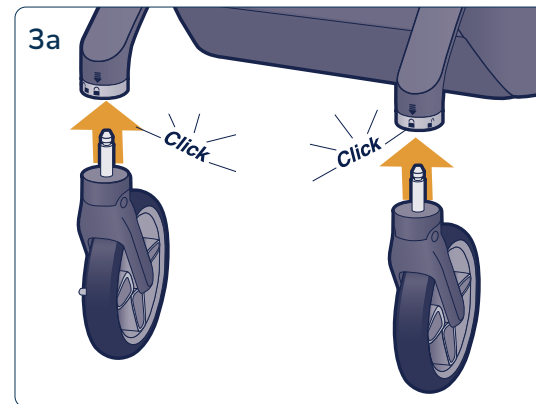

Assembly

Rear Wheels

Push the rear wheel into the rear wheel opening until it clicks (Figure 2a). Repeat with the other rear wheel. Pull on each wheel to confirm it is securely attached.

Front Wheels

Push the front wheel into the front wheel opening until it clicks (Figure 3a). Repeat with the other front wheel. Pull on each wheel to confirm it is securely attached.

Assembly

Seat

Pull the seat frame apart to open (Figure 4a).

Align the seat hub on each side to the seat mounts on the frame, matching the colored dots (Figure 4b). Push the seat downward onto the seat mounts until each side clicks into place (Figure 4c). Pull up on the seat to confirm the seat is securely installed onto the stroller frame. If it does not click into place, it is not installed correctly.

Note: Once installed, the seat can turn forward or backward.

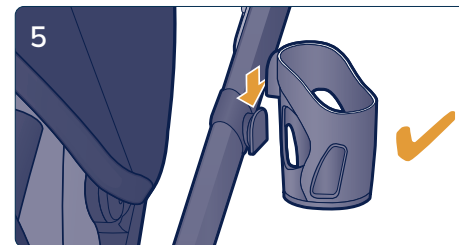
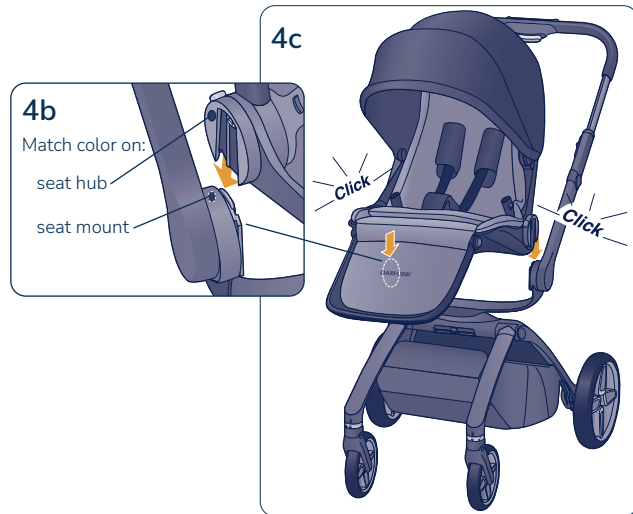
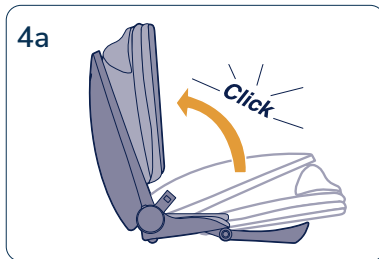
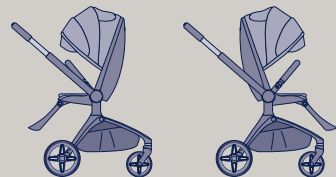

Assembly

Cup Holder

Align the cup holder with the post on the side of the stroller frame and slide it onto the post (Figure 5).

Note: This cup holder swivels to stay upright even when you rotate the stroller handle. Cup holder fits up to a 20-oz. tumbler.

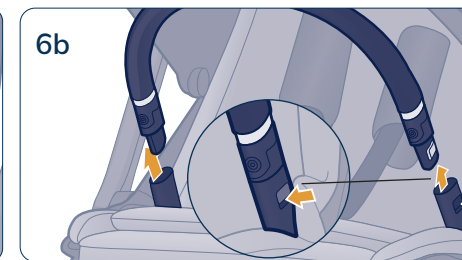

Bumper Bar

Insert the posts of the bumper bar into the bumper bar mounts until you hear each side click (Figure 6a). Pull on each side to confirm it is secure. The shiny button on the bumper bar should be facing up.

Note: Always secure your child with the restraint straps.

To remove the bumper bar, press the release buttons while lifting it off (Figure 6b).

Alternatively, you can unlock one side of the bar and pivot it to the side to take your child out of the stroller (Figure 6c).



Use

Use

Brake

The brake is located next to the rear right wheel (Figure 1a).

To lock the wheels, step on the bottom section of the brake pedal.

To unlock the wheels, step on the top section of the brake pedal.

To use the swivel locks, turn the ring above each front wheel. Align the locked image with the arrow to engage the swivel lock; align the unlocked image with the arrow to release the swivel lock (Figure 1b).

Adjusting the Seat

Pull the seat recline lever located on the back of the seat (Figure 2a) to adjust to any of the three recline positions (Figure 2b).

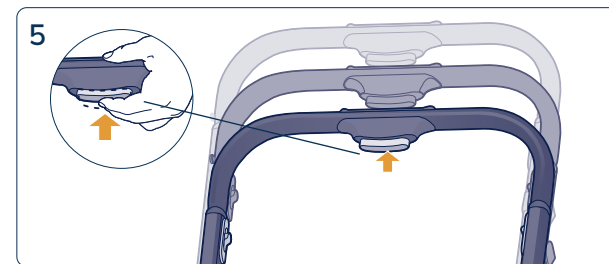
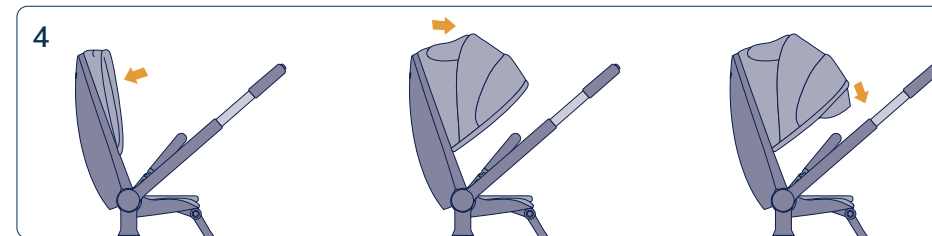
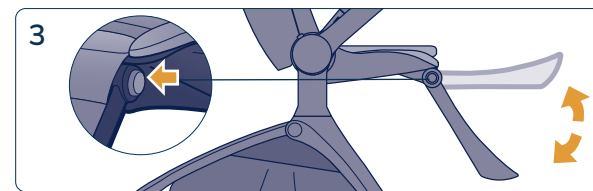
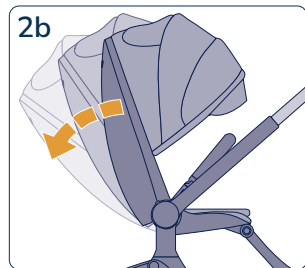
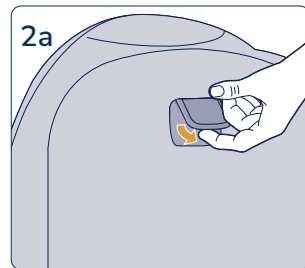
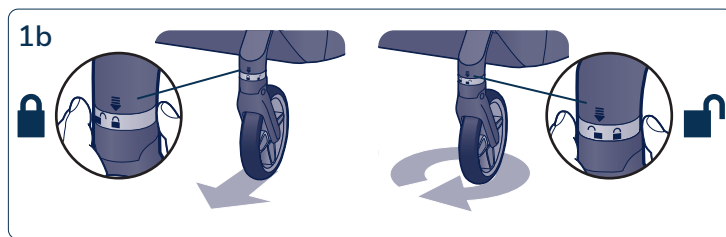
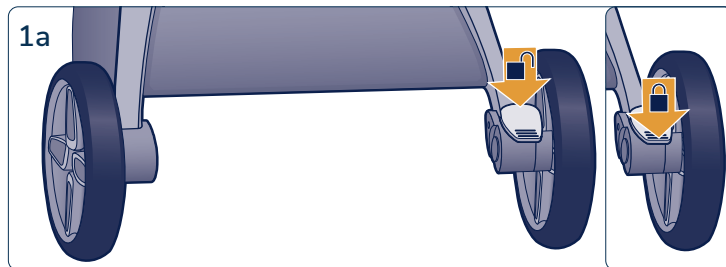

Use

Leg Rest

Press both leg rest buttons on the sides of the seat and lift the leg rest to elevate. The leg rest has two positions, lowered or elevated.

Canopy

The canopy has two positions: extended fully for UPF 50 sun protection and privacy or closed. There is also an extendable visor under the canopy for additional coverage.

Handlebar

Press the center button on the handlebar and slide the handlebar to your desired height. There are three height positions.

Use

Rotating the Seat

The handlebar does not need to be fully upright to begin rotating, but it must be close to upright.

Pull the two triggers on the side of the frame (Figure 6a) as you push the handlebar to rotate the stroller seat to face the other direction.

Once the stroller is facing your desired direction, pull the handlebar over the rear wheels to click it into the locked position.

Note: Engage the brake when rotating the seat.

Follow the same steps for rotating your infant car seat or Carriage Accessory.

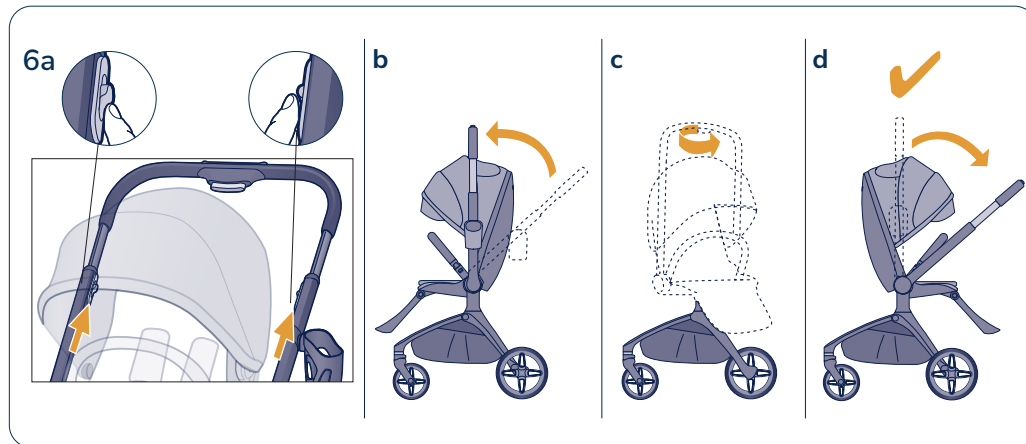

7a

seat
release
buttons

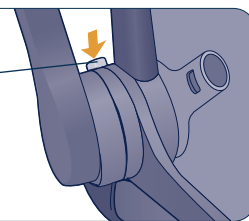

7b

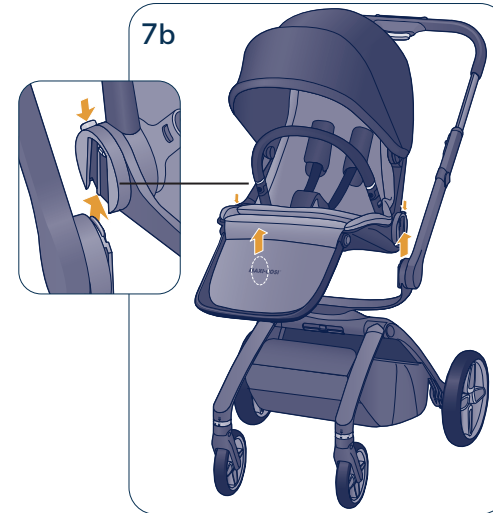

Use

Removing the Seat

Push the two seat release buttons down until they click (Figure 7a).

Once both buttons are pushed down, lift the seat off the frame (Figure 7b).

Use

Restraint System

Place your child in the seat with the buckle strap between the child's legs, and fasten both buckles.

8a

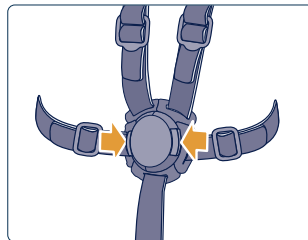

To unbuckle the restraint, press the side buttons.

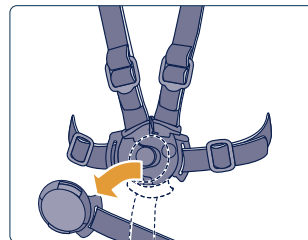

The center cover is removed.

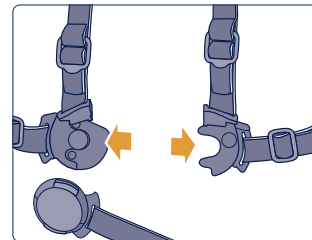

Pull the sides apart.

⚠ WARNING

- **AVOID SERIOUS INJURY** from falling or sliding out. **ALWAYS** use the harness system. Check frequently to make sure it is secure.

8a continued

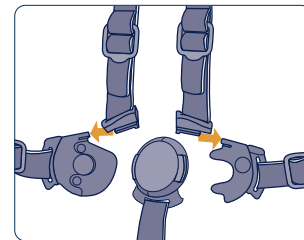

To buckle the restraint: If the shoulder straps detach, slide each buckle tongue onto the tab on top of the buckle.

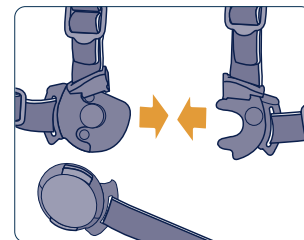

Fit each side together.

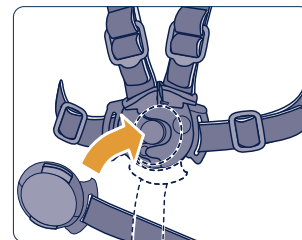

Press the center cover onto the restraint.

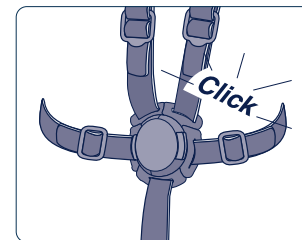

Buckled.

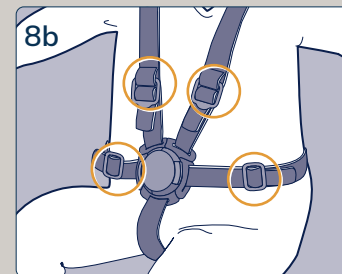

Adjust the straps (at the four buckles) to tighten snugly, such that you can comfortably slide your finger between the strap and your child (Figure 8b).

Use

Adjusting the Shoulder Restraints

Unhook the canopy from its posts (Figure 9a) and unzip it from the frame (Figure 9b).

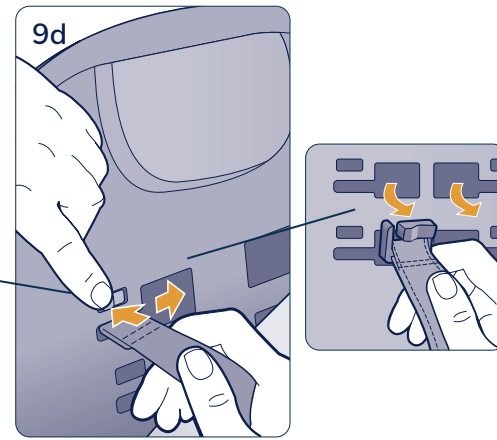
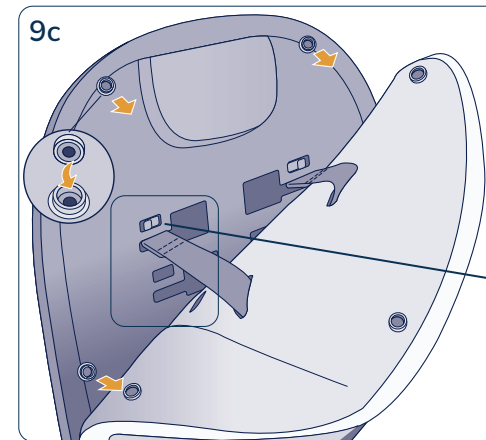
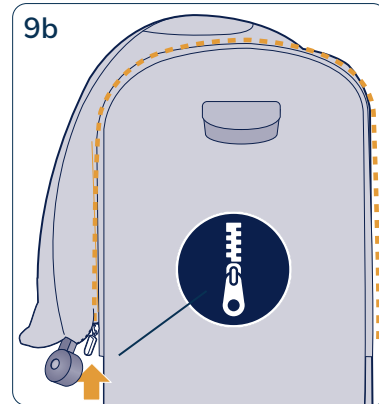

Use

Open the snaps that attach the seat pad to the frame and pull the seat pad forward to find the shoulder strap adjustments (Figure 9c).

While pushing the black button, slide the clip out of the slot (Figure 9d). Pull the strap through the seat pad and insert. Choose another slot to adjust the height of the shoulder strap. Rethread the strap through the corresponding new slot on the seat pad and insert, and then slide the clip into the new slot on the seat. Repeat on the other side.

Note: The waist straps can only be adjusted by using the buckles (see Step 8b on page 25).

Use

Folding the Stroller

The cup holder and bumper bar can remain attached while folding.

Rotate the seat to parent-facing position (see Step 6 on page 22).

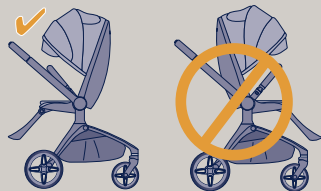

Adjust the handlebar to the lowest position (see Step 5 on page 21).

Follow these same steps for folding the stroller without the seat attached. The Maxi-Cosi logo on the frame should be right side up.

10a

Pull the triggers on the side of the stroller frame and lower the handlebar down to the rear wheels.

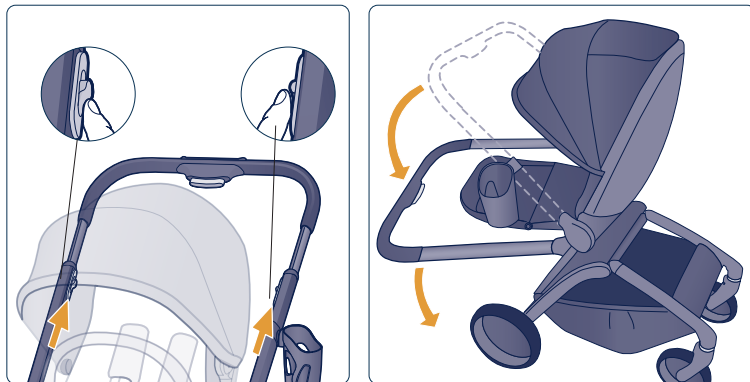

10b

Pull the seat recline lever on the back of the seat and push the seatback down between the handlebars.

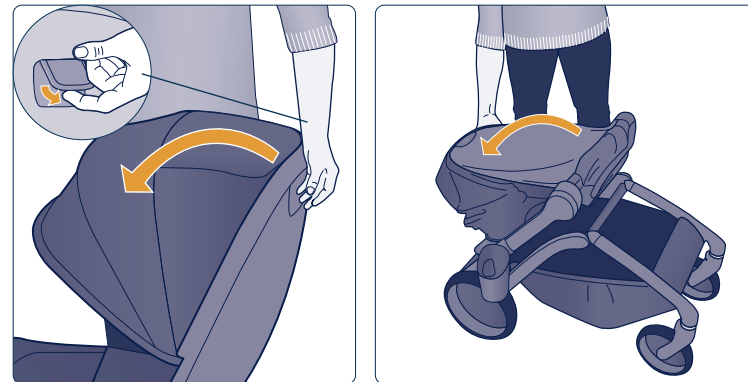

Use

Folding the Stroller

continued on the next page

Use

Folding the Stroller *continued*

Note: When the seat is unfolded, the bumper bar will lay flat on the seat. Raise it up until it clicks.

10c

Squeeze the release lever on the bottom of the frame above the basket to fold the bottom half of the stroller. The stroller will then collapse into a compact fold.

Use the carry handle to lift the stroller.

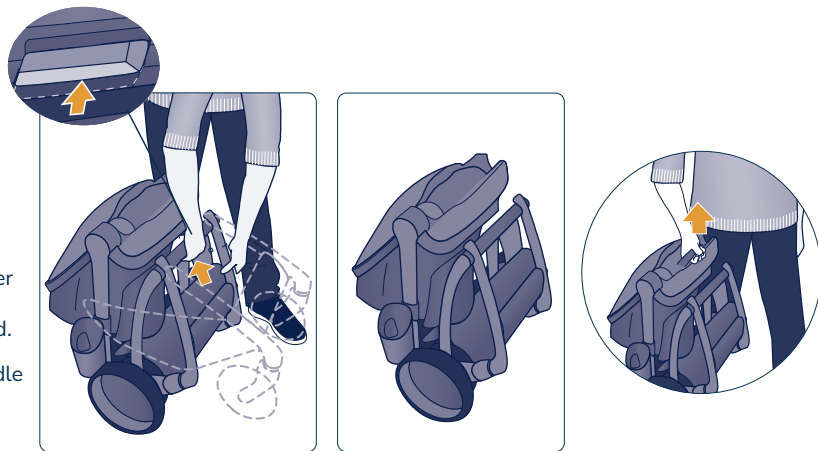

11a

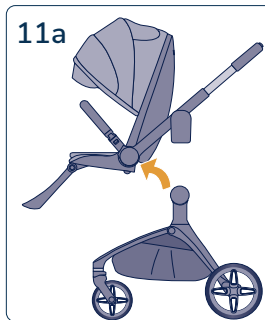

11b

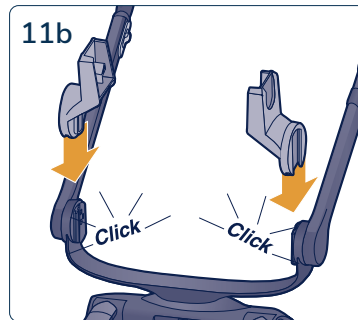

11c

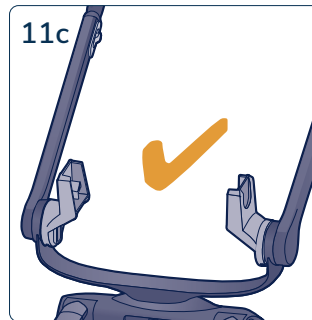

Use

Installing an Infant Car Seat

Remove the stroller seat from the stroller frame (Figure 11a). See Step 7 on page 23.

Attach the provided infant car seat adapters to the stroller frame, matching the colored dots (Figure 11b).

continued on the next page

Use

Installing an Infant Car Seat *continued*

Align the car seat to the adapters and lower the car seat until both sides click (Figure 11d). Pull up on the seat to ensure it is securely attached (Figure 11e).

The car seat can only be installed in the parent-facing position.

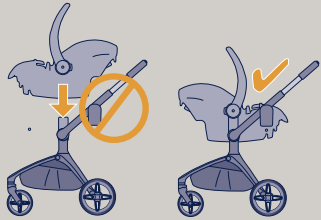

Once installed on the stroller frame, the infant car seat can rotate to be parent-facing or world-facing.

The car seat adapters are compatible with the Maxi-Cosi Peri 180° Rotating Infant Car Seat and all Mico™ Infant Car Seats.

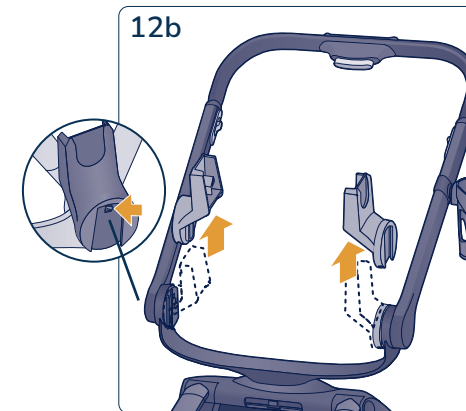
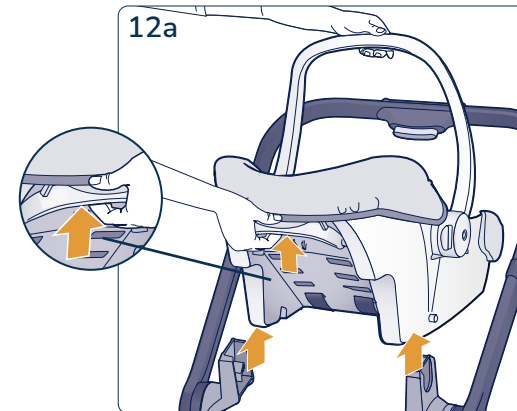
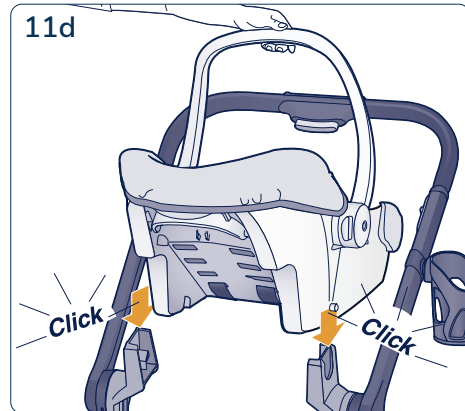

Use

Removing an Infant Car Seat

Pull the release lever on the back of the car seat and lift the car seat off (Figure 12a).

Push the buttons on the insides of the car seat adapters to release the adapters from the mounts (Figure 12b).

Care and Maintenance

Care and Maintenance

The seat pad, insert, and harness covers are machine washable with cold water on gentle cycle. Do not use bleach. Tumble dry on low heat or line dry. Spot clean only all other parts.



Scan for instructions on how to remove and reinstall the machine-washable parts.

Replaceable Parts

- Rear wheels
- Front wheels
- Bumper bar
- Cup holder

To order parts, call 1-800-544-1108. Include the model number (CV452), manufacture date (found under the front leg of the frame), and a brief description of the part.

Two-Year Limited Warranty

Dorel Juvenile Group, Inc. warrants to the original purchaser that this product (Tana) is free from material and workmanship defects when used under normal conditions for a period of two (2) years from the date of purchase. Should the product contain defects in material or workmanship Dorel Juvenile Group, Inc., will repair or replace the product, at our option, free of charge. Purchaser will be responsible for all costs associated with packaging and shipping the product to Dorel Juvenile Group Consumer Care Department at the address noted on front page and all other freight or insurance costs associated with the return. Dorel Juvenile Group will bear the cost of shipping the repaired or replaced product to the purchaser. Product should be returned in its original package accompanied by a proof of purchase, either a sales receipt or other proof that the product is within the warranty period. This warranty is void if the owner repairs or modifies the product or the product has been damaged as a result of misuse. This warranty excludes any liability other than that expressly stated previously, including but not limited to, any incidental or consequential damages.

SOME STATES DO NOT ALLOW THE EXCLUSION OR LIMITATION OF INCIDENTAL OR CONSEQUENTIAL DAMAGES, SO THE ABOVE LIMITATION OR EXCLUSION MAY NOT APPLY TO YOU. THIS WARRANTY GIVES YOU SPECIFIC LEGAL RIGHTS, AND YOU MAY ALSO HAVE OTHER RIGHTS THAT MAY VARY FROM STATE TO STATE.