

Aimpoint®

LRP mount, QRP2 / QRW2 mount and
TNP mount for CompM4™ / CompM4s™
User manual

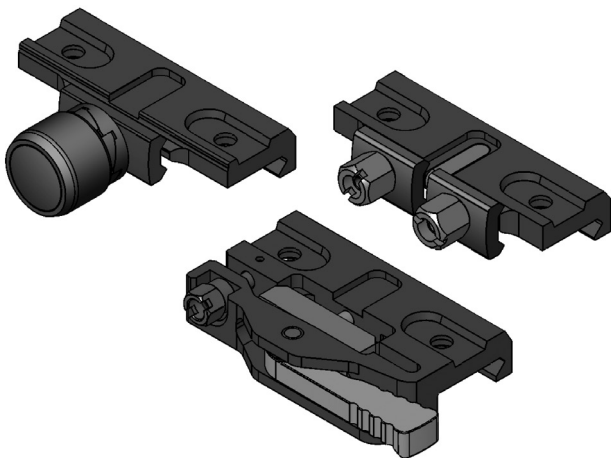

THE FUTURE IN SIGHT.

1 PRESENTATION

Aimpoint® CompM4 and CompM4s are designed to be mounted on a firearm with a MIL-STD 1913 Picatinny rail or Weaver rail. Height of optical axis can be adjusted by adding or removing a spacer to the configuration.

2 ASSEMBLE SIGHT, MOUNT AND SPACER

2.1 Sight and mount only

Assemble the sight to the mount using two short screws. Tighten firmly. It is recommended to use thread sealer on the screw threads. Height of the optical axis (from the top of the rail) when **not** using a spacer is 30 mm (1.2") for CompM4 and CompM4s.

2.2 Sight, mount and spacer

Assemble the sight to the mount and spacer using two long screws. Tighten firmly. It is recommended to use thread sealer on the screw threads. Height of the optical axis (from the top of the rail) when using a standard spacer is 39 mm (1.5") for CompM4 and CompM4s.

2.3 Sight, mount and extension spacer

Assemble the sight to the mount and extension spacer using four short screws. Tighten firmly. It is recommended to use thread sealer on the screw threads. Height of the optical axis (from the top of the rail) when using an extension spacer is 39 mm (1.5") for CompM4 and CompM4s.

3 AIMPOINT® MOUNTS

3.1 LRP mount for CompM4™ / CompM4s™

The LRP mount is a quick detach mount for mounting on a MIL-STD 1913 Picatinny rail.

Technical specification

Weight	75 g / 2.7 oz
Height of optical axis (no spacer)	30 mm / 1.2"
Length	79 mm / 3.1"
Width	47 mm / 1.9"

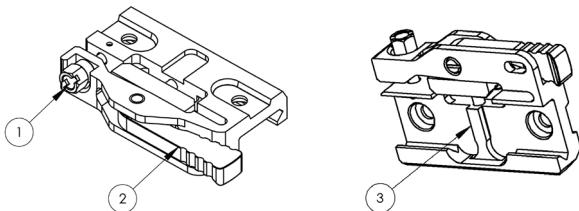

Mounting CompM4™ / CompM4s™ with LRP mount:

- 1 Lift the lever (2) up to release it and set to open.
- 2 Position the recoil stop (3) in a groove to be used on the rail and install the mount. See Fig. 1.

CAUTION: Ensure that the groove to be used is clean and free from dirt.

- 3 With the recoil stop (3) positioned in a groove of the rail, push the sight with mount forward (toward muzzle) and close the lever (2) with the hand (no tools) until it clicks into the slot of the base. See Fig. 2.

CAUTION: The lever (2) must never be forced to close by the use of pliers or any other tool.

- 4 If the lever (2) cannot be closed or the mount does not clamp with sufficient force: **set the lever (2) to open** and tighten or loosen the adjustment nut (1) before attempting to close the lever (2).

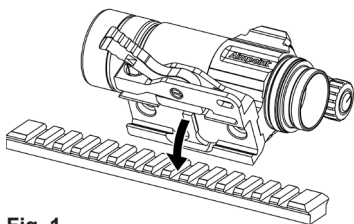

Fig. 1

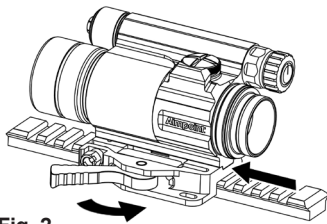
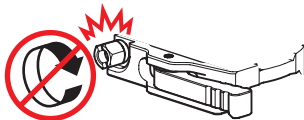

Fig. 2

CAUTION: If the locking lever is closed, the adjustment nut must never be tightened! This can cause the mount to break.



3.2 QRP2 / QRW2 mount for CompM4™ / CompM4s™

The QRP2 mount and QRW2 mount are quick detach mounts. The QRP2 is designed for mounting on a MIL-STD 1913 Picatinny rail and the QRW2 is designed for mounting on a Weaver rail.

Technical specification

Weight	70 g / 2.5 oz
Height of optical axis (no spacer)	30 mm / 1.2"
Length	70 mm / 2.8"
Width	55 mm / 2.2"

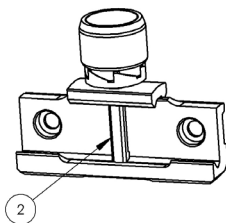
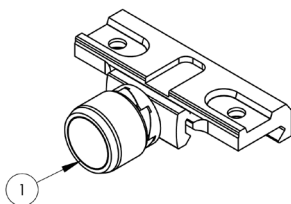

Mounting CompM4™ / CompM4s™ with QRP2 / QRW2 mount:

1 Loosen the torque knob (1) by turning it counter clockwise.

CAUTION: Ensure that the groove to be used is clean and free from dirt.

2 Position the recoil stop (2) in a groove to be used on the rail and install the mount. See Fig. 3.

3 With the recoil stop (2) positioned in a groove of the rail, push the sight with mount forward (toward muzzle) and tighten the torque knob (1) clockwise until it snaps twice. See Fig. 4. Retighten the knob after a few rounds if necessary.

CAUTION: Only grab the checkered portion of the knob to prevent pinching of fingers.

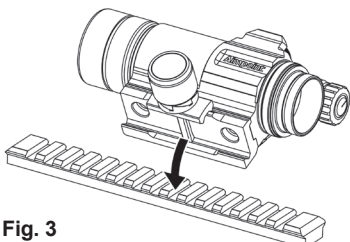

Fig. 3

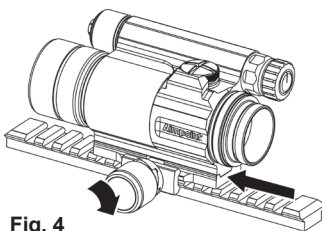

Fig. 4

3.3 TNP mount for CompM4™ / CompM4s™

The TNP mount is a fixed mount for mounting on a MIL-STD 1913 Picatinny rail.

NOTE: Always perform zeroing if the sight with TNP mount is removed and re-mounted on the Picatinny rail.

Technical specification

Weight	60 g / 2.1 oz
Height of optical axis (no spacer)	30 mm / 1.2"
Length	70 mm / 2.8"
Width	41 mm / 1.6"

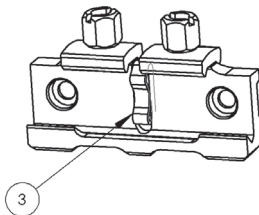
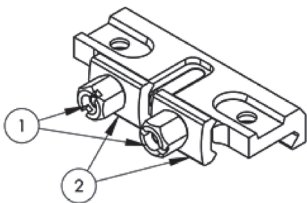

Mounting CompM4™ / CompM4s™ with TNP mount:

- 1 Loosen the torsion nuts (1) to release clamping force from the brackets (2)
- 1 Position the recoil stop (3) in a groove to be used on the rail and install the mount. See Fig. 5.

CAUTION: Ensure that the groove to be used is clean and free from dirt.

- 2 With the recoil stop (3) positioned in a groove of the rail, push the sight with mount forward (toward muzzle) and tighten the two torsion nuts by hand until resistance is encountered. Proceed to tighten using a tool another 1/4 up to 1/2 turn. See Fig. 6. Retighten the two torsion nuts after a few rounds if necessary.

CAUTION: Do not overtighten the torsion nuts.

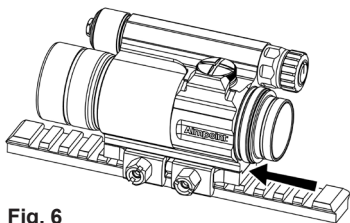
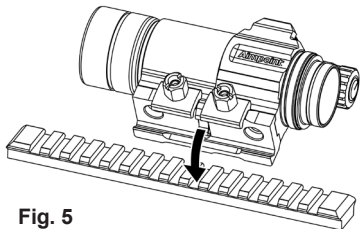

CAUTION: Always inspect the tightness of the torsion nuts before using your firearm.

4 AIMPOINT® SPACERS

4.1 Standard spacer

Height of the optical axis (from the top of the rail) when using a standard spacer is 39 mm (1.5") for CompM4 and CompM4s.

Technical specification

Weight	25 g / 0.9 oz
Height of optical axis with spacer	39 mm / 1.5"
Length	70 mm / 2.8"
Width	21 mm / 0.8"

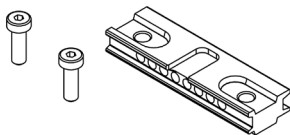

4.2 Extension spacer

Height of the optical axis (from the top of the rail) when using an extension spacer is 39 mm (1.5") for CompM4 and CompM4s. The extension spacer moves the position of the sight by 40 mm / 1.6".

Technical specification

Weight	45 g / 1.6 oz
Height of optical axis with extension spacer	39 mm / 1.5"
Length	110 mm / 4.3"
Width	21 mm / 0.8"

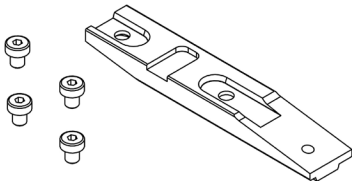

Aimpoint AB

Jägershillgatan 15

SE- 213 75 Malmö, Sweden

Phone: +46 (0)40 671 50 20

Fax: +46 (0)40 21 92 38

e-mail: info@aimpoint.se

Aimpoint Inc.

7309 Gateway Court

Manassas, VA 20109, USA

Phone: +1 703-263-9795

Fax: +1 703-263-9463

e-mail: info@aimpoint.com

WWW.AIMPOINT.COM

© 2012, 2017 Aimpoint AB. [13510-1]

