

Stonington Linear Chandelier

CC1216 1.0

VISUAL COMFORT & Co.

STUDIO COLLECTION

CAUTION - RISK OF FIRE

This product must be installed in accordance with the applicable installation code by a person familiar with the construction and operation of the product and the hazards involved.

Use minimum 90°c supply conductors.

GENERAL PRODUCT INFORMATION:

These fixtures are intended to be installed utilizing NEC compliant junction boxes.

This product is safety listed for damp locations.

Incandescent lamps may be dimmed with a standard incandescent dimmer. LED lamps may be dimmed with a LED dimmer. Consult lamp manufacturer for additional information.

This instruction shows a typical installation.

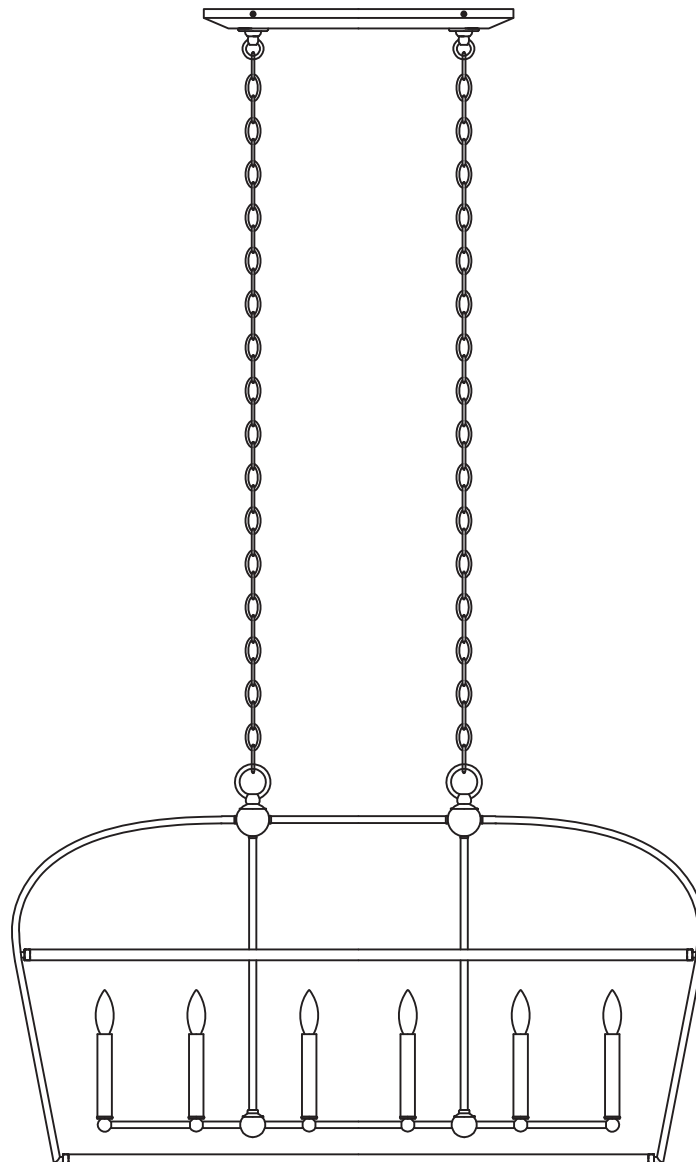

SAVE THESE INSTRUCTIONS!

Install the Fixture

IA

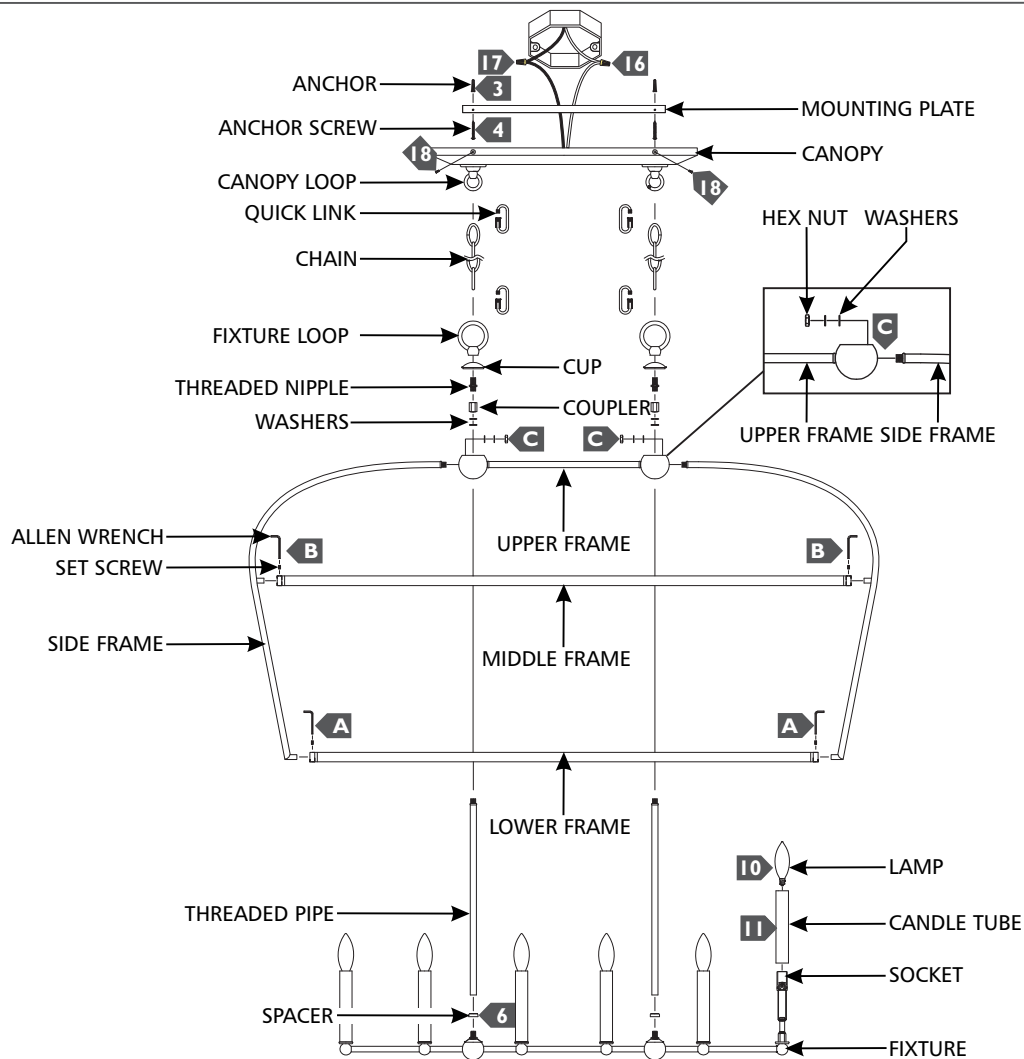

- 1 Temporarily install the mounting plate to the junction box.
- 2 Mark the anchor locations through the holes on the mounting plate, then remove the mounting plate.
- 3 Install the anchors to the marked points.
- 4 Secure the mounting plate to the junction box and screw the anchor screws into the anchors.
- 5 **Assemble the Frame:**
 - A) Install the side frames to the lower frame and secure them together using the set screws and Allen wrench.
 - B) Install the side frames to the middle frame and secure them together using the set screws and Allen wrench.
 - C) Install the side frames to the upper frame and secure them together using the washers and hex nuts.
- 6 Feed the fixture wires through the spacer and threaded pipe, then screw the threaded pipe onto the fixture. Repeat for other side.
- 7 Feed the fixture wires through the upper frame, washers, and couplers, then lower the frame onto the threaded pipes and secure together by screwing the couplers onto the pipes.
- 8 Feed the fixture wires through the shorter end of the threaded nipples, then screw them onto the couplers.
- 9 Feed the fixture wires through the cups and fixture loops, then place the cups onto the threaded nipples and secure them in place by screwing the fixture loops onto the nipples.
- 10 Install the candle tubes by sliding them over the sockets.
- 11 Screw the lamps into the sockets. Refer to the label on the lamp socket for Max Wattage information.
- 12 Determine the wanted height of the fixture and remove a portion of the chain from the bottom by opening a link with pliers.
- 13 Install a quick link onto the chain and fixture loop, then install another quick link to the other end of the chain and canopy loop. Repeat steps 12 and 13 for the other side.
- 14 Weave the cord through the chain, canopy, and out of the electrical box. Trim the cord leaving enough to make electrical connections.
- 15 Connect the fixture to a suitable ground in accordance to local electrical codes.
- 16 Connect the white fixture wire (square and/or rigid) to the neutral power line wire with a wire nut.
- 17 Connect the black fixture wire (round and/or smooth) to the hot power line wire with a wire nut.
- 18 Neatly place all the wires into the junction box, place the canopy onto the mounting plate, and secure it in place using the canopy screws.