



BEST CHOICE
PRODUCTS



INSTRUCTION MANUAL

3-Piece PVC Deer Family

! NOTICE

Please retain these instructions for future reference.

- This item is not intended for permanent installation or use.
- Assemble this product on a flat level surface near its intended display space.
- This product is not easily transported after assembly. Please avoid excessive movement and reorientation.
- If any parts are missing, broken, damaged, or worn, stop using this product until repairs are made and/or factory replacement parts are installed.
- Do not use this item in a way inconsistent with the manufacturer's instructions as this could void the product warranty.
- This set includes three figures: one buck, one doe, and one fawn. Construct the figures using the appropriately sized pieces. Do not attempt to mix the three figure assemblies.

! WARNING

- Do not use in extreme weather conditions.
- Do not lean, sit, or stand on or use any part of this item as a step ladder.
- Do not lean, sit, or stand on/in the figures or support structure.
- Keep item away from all heat sources (fireplace, stove, heater, etc.).
- Please use the provided stakes to properly secure the figure.

TOOLS REQUIRED



PHILLIPS
SCREWDRIVER

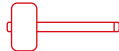

RUBBER Mallet
(RECOMMENDED)



2 PERSON
ASSEMBLY



UP TO 30 MIN.
ASSEMBLY

HARDWARE

1

SCREWS



12 PCS

2

STAKE
RETAINERS



6 PCS

3

STAKES

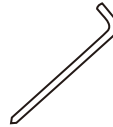

6 PCS

PARTS

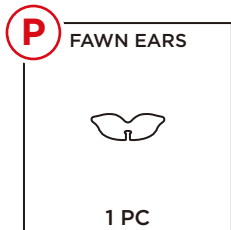
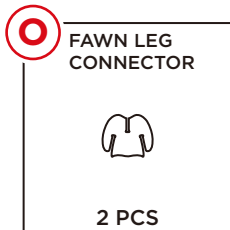
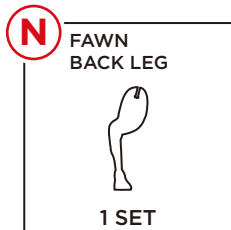
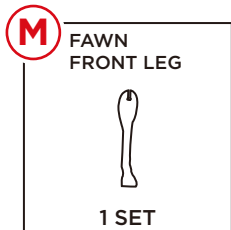
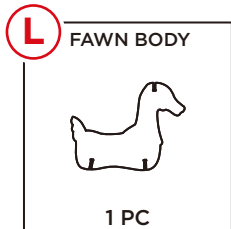
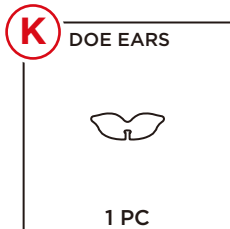
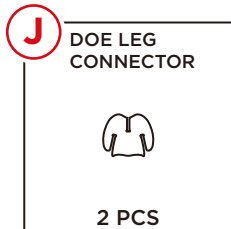
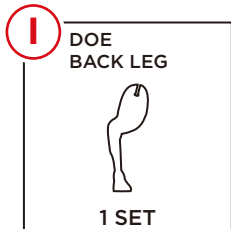
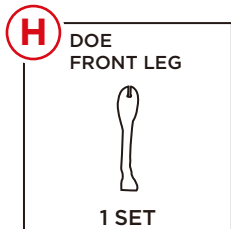
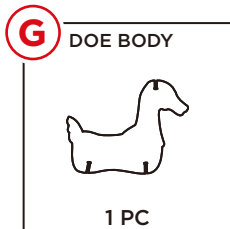
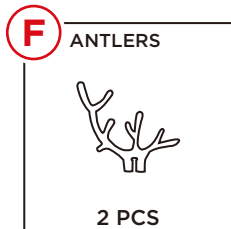
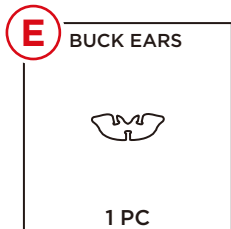
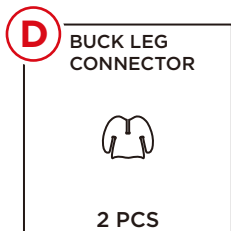
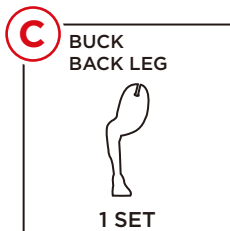
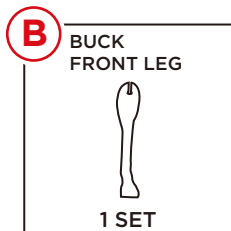
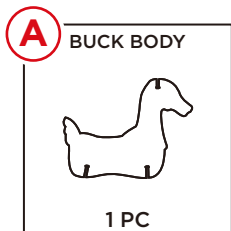

BEFORE ASSEMBLY

1

Locate the predrilled holes on one **part B buck front leg (right)** and one **part C buck back leg (left)**, then attach two **part 2 stake retainers** and two **part 3 stakes** with four **part 1 screws**.

NOTE: The stakes are oriented on the inner face of each figure piece.

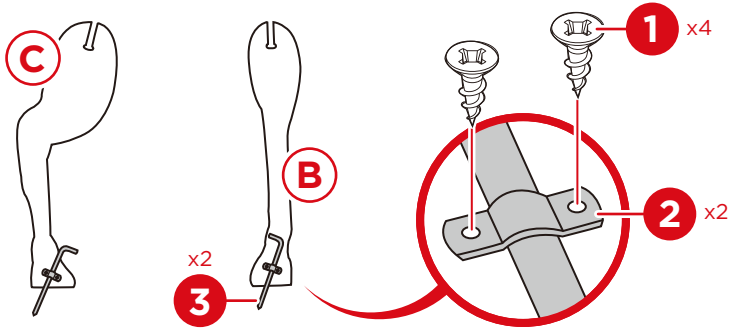

2

Locate the predrilled holes on one **part H doe front leg (right)** and one **part I doe back leg (left)**, then attach two **part 2 stake retainers** and two **part 3 stakes** with four **part 1 screws**.

NOTE: The stakes are oriented on the inner face of each figure piece.

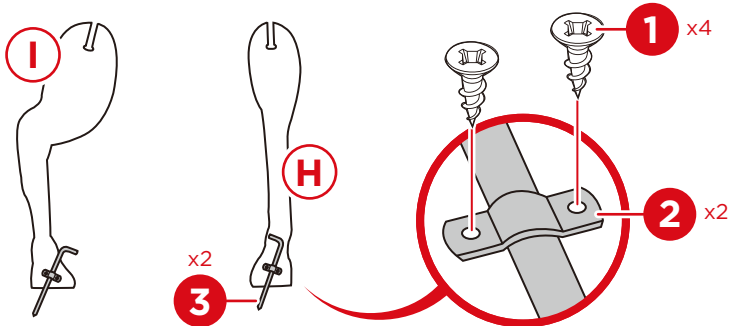

3

Locate the predrilled holes on one **part M fawn front leg (right)** and one **part N fawn back leg (left)**, then attach two **part 2 stake retainers** and two **part 3 stakes** with four **part 1 screws**.

NOTE: The stakes are oriented on the inner face of each figure piece.

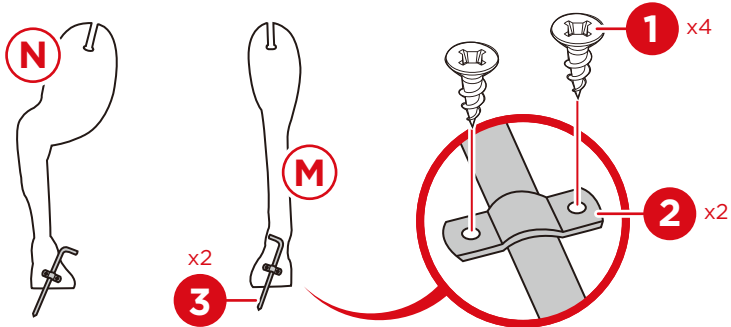

PRODUCT ASSEMBLY (BUCK)

1

Insert two **part D Buck leg connectors** into one **part A Buck body**, then attach one set of **part B Buck front legs**, and one set of **part C Buck back legs**.

TIP: Assemble the deer on their side, then flip upright to continue.

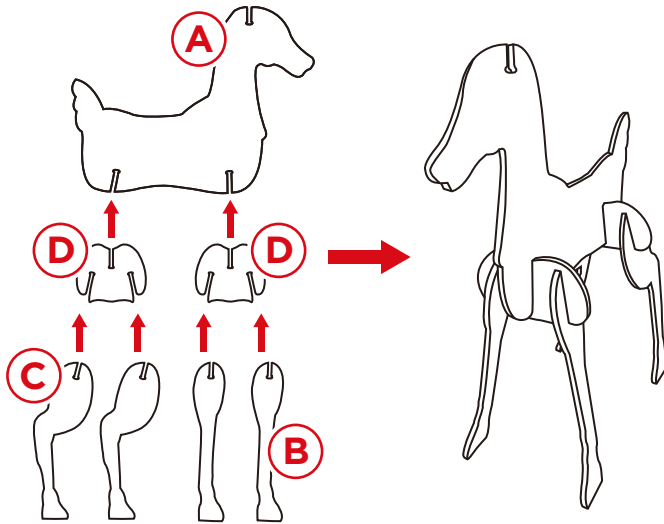

2

Attach one **part E Buck ears** to the head of the **part A Buck body**, then place two **part F antlers** to the ears.

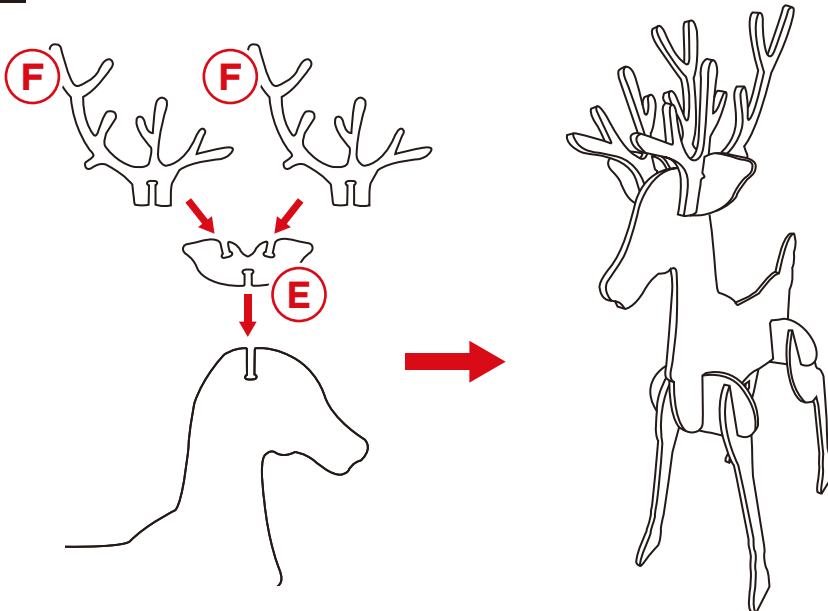

PRODUCT ASSEMBLY (DOE)

1

Insert two **part J Doe leg connectors** into one **part G Doe body**, then attach one set of **part H Doe front legs**, and one set of **part I Doe back legs**.

TIP: Assemble the deer on their side, then flip upright to continue.

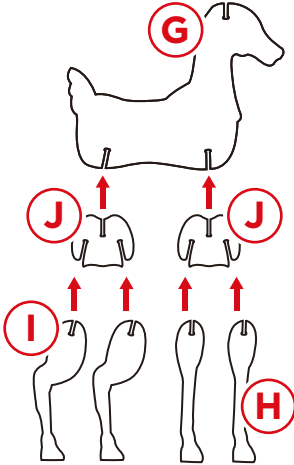

2

Attach one **part K Doe ears** to the head of the **part G Doe body**.

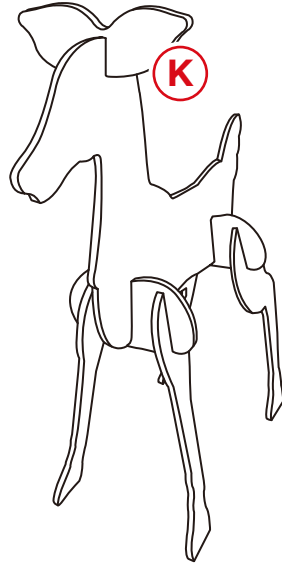

PRODUCT ASSEMBLY (FAWN)

1

Insert two **part O Fawn leg connectors** into one **part L Fawn body**, then attach one set of **part M Fawn front legs**, and one set of **part N Fawn back legs**.

TIP: Assemble the deer on their side, then flip upright to continue.

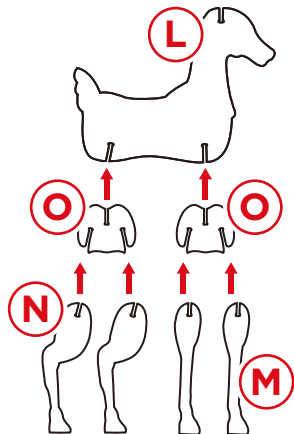

2

Attach one **part P Fawn ears** to the head of the **part L Fawn body**.

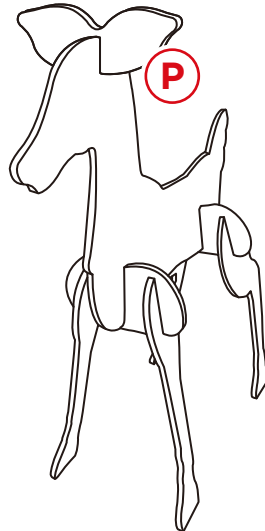

INSTALLATION

Arrange your assembled figures as desired and press down on the tops of the stakes.

If the ground is firm, use a mallet to tap the stakes into the ground.

NOTE: This product is intended for grass or dirt, do not attempt to sink the stakes into concrete.

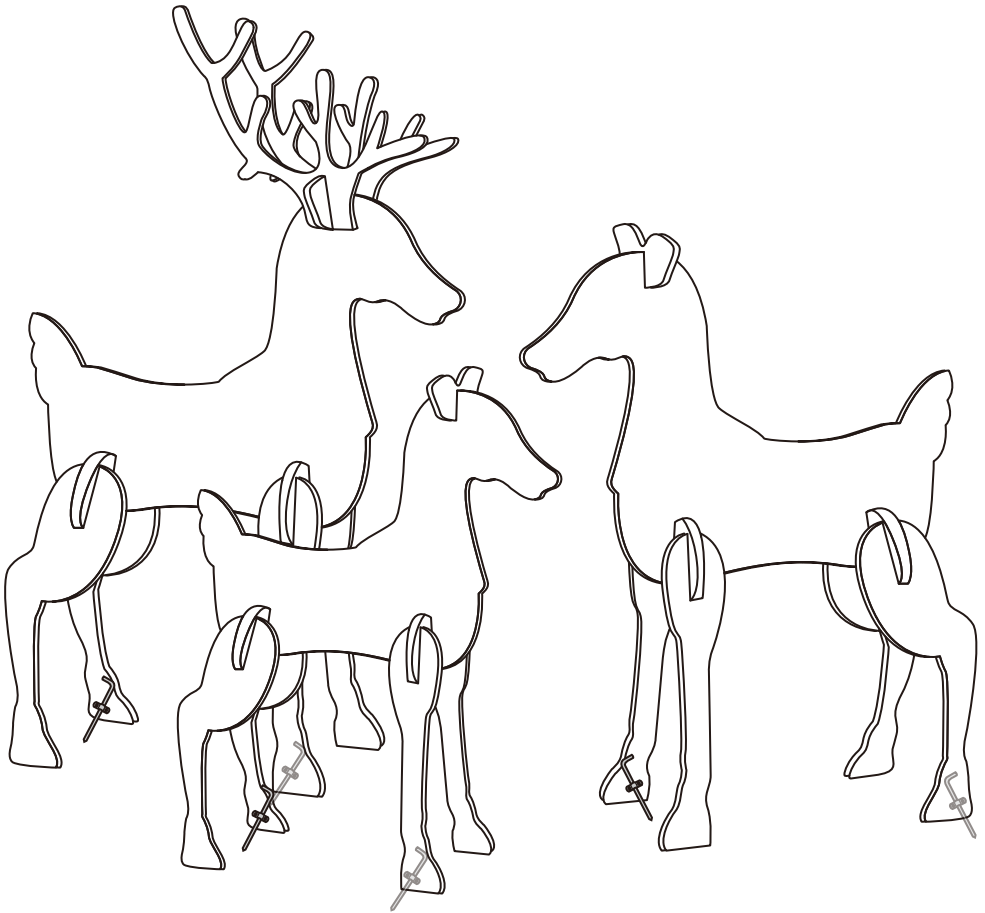



HELP CENTER



Question about your product? We're here to help. Visit us at:

help.bestchoiceproducts.com



Chat Support



Product Inquiry



Orders FAQ



Product Assembly



Returns & Refunds

PRODUCT WARRANTY INFORMATION

All items can be returned for any reason within 60 days of the receipt and will receive a full refund as long as the item is returned in its original product packaging and all accessories from its original shipment are included. All returned items will receive a full refund back to the original payment method. All returned items will not be charged a re-stocking fee.

All returned items require an RA (Return Authorization) number, which can only be provided by a Best Choice Products Customer Service Representative when the return request is submitted. Items received without an RA may not be accepted or may increase your return processing time. Once an item has been received by Best Choice Products, refunds or replacements will be processed within 5 business days.

All returns must be shipped back to the Best Choice Products Return Center at the customer's expense. If the reason for return is a result of an error by Best Choice Products then Best Choice Products will provide a pre-paid shipping label via email. Boxes for return shipping will not be provided by Best Choice Products, and is the customer's responsibility to either use the original shipping boxes or purchase new boxes.

Pictures may be required for some returns to ensure an item is not damaged prior to its return. Items returned are not considered undamaged until they are received by Best Choice Products and verified as such. All damages to items are the customer's responsibility until the item has been received by and acknowledge by Best Choice Products as undamaged.



WARNING

Manufacturer and seller expressly disclaim any and all liability for personal injury, property damage or loss, whether direct, indirect, or incidental, resulting from the incorrect attachment, improper use, inadequate maintenance, unapproved modification, or neglect of this product.