

ASSEMBLY INSTRUCTION

E670-30(N1) COFFEE TABLE

A Table Top

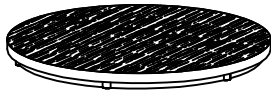

1pc

B Ring



1pc

C Upper Leg

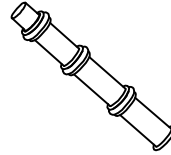

6pcs

D Lower Leg



6pcs

E Bolt
Ø1/4"x5/8"

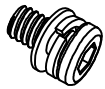

6pcs

F Allen Key
M4

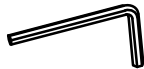

1pc

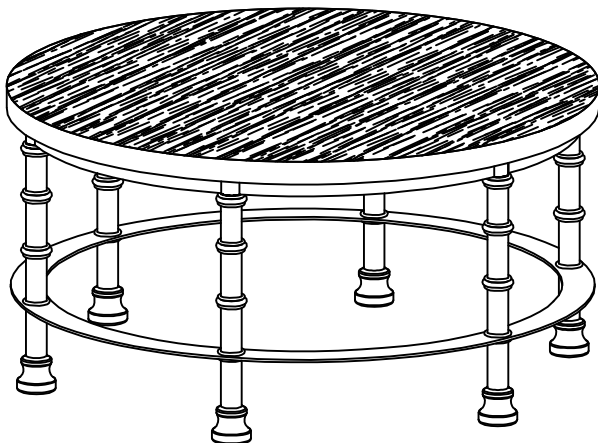

This page lists all the contents included in the box. Please take the time to identify the hardware as well as the individual components to this product. As you unpack and prepare for assembly, place the contents on a carpeted or padded area to protect them from damage.

-
- 1** Attach Upper Leg (C) to Table Top (A) with Bolt (E) by Allen Key (F).

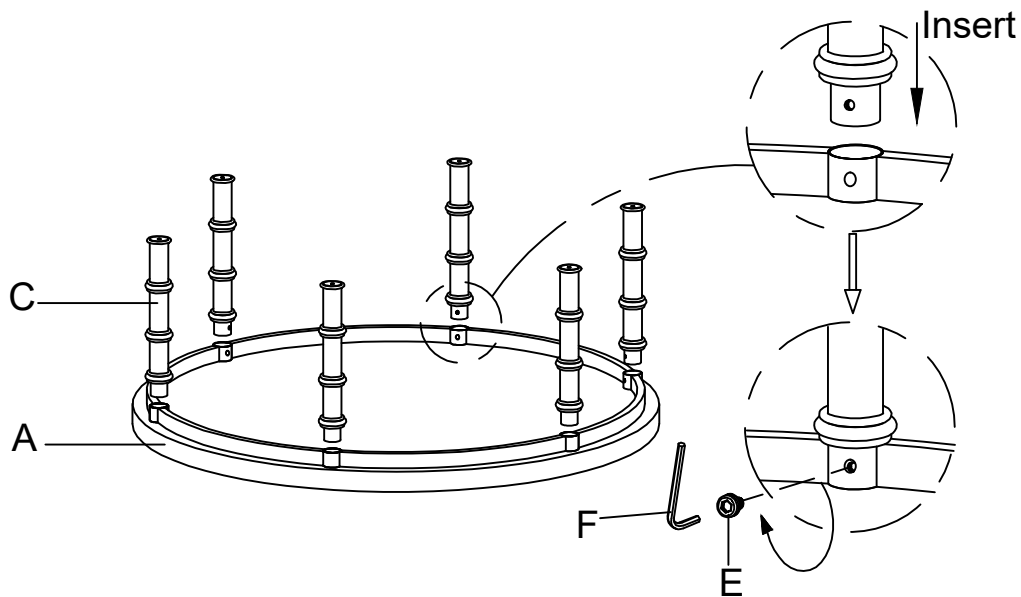

-
- 2** Attach Ring (B) to Upper Leg (C), and attach Lower Leg (D) through Ring (B) to Upper Leg (C), then rotate tightly.

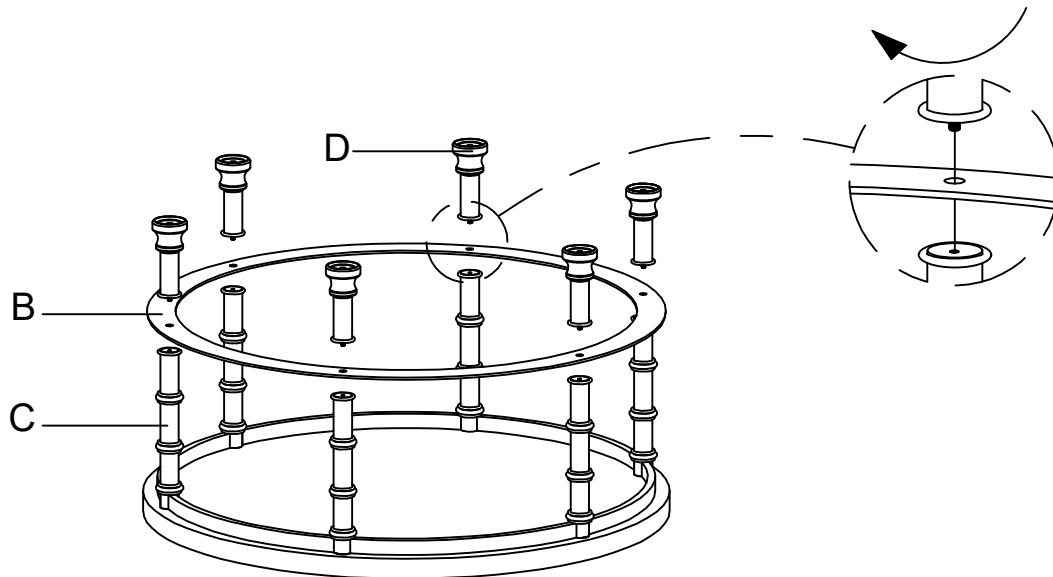

Cleaning & Care

Treat surface with care. Surface is resistant to scratches but is not scratch resistant. Clean surfaces with a dry or damp soft cloth. Do not use abrasive cleaners. Hardware may loosen over time. Periodically check that all connections are tight.