



COLDWORK™ CANVAS UTILITY



USA
(800) 222-4296

Spain
+34 93 628 22 00

Canada
(877) 278-5822

Australia
1 300-731 336

Japan
03 4590 0066

MECHANIX WEAR LLC
www.mechanix.com

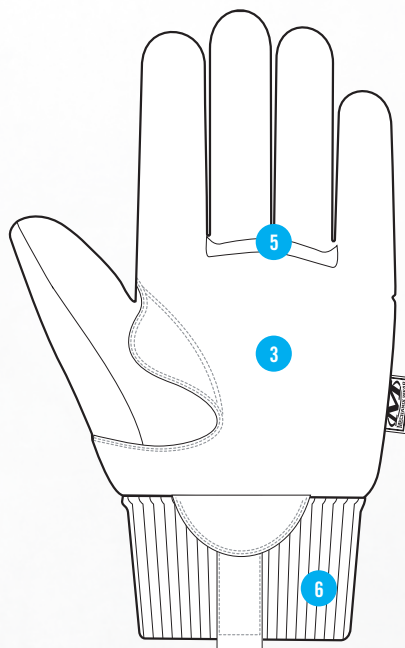
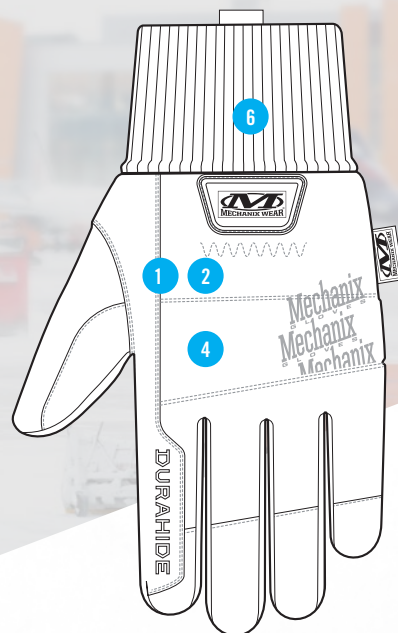

COLD WEATHER HAND PROTECTION

The cold does not back down to the work, and neither should your gloves. The ColdWork™ Canvas Utility is constructed with water resistant heavy-duty canvas back of hand and a water and abrasion resistant Durahide™ Leather Technology infused palm creating a rugged winter outer shell that stands up to both abrasion hazards and cold weather environments. 100g 3M™ Thinsulate™ insulation paired with a soft sherpa lining and a snug fitting knit cuff locks in warmth while 3mm EVA foam knuckle padding protects against mild impacts. This glove is the perfect solution for those looking for durable protection, maximum warmth, and premium comfort.

FEATURES

- 1 Water repellent heavy-duty canvas easily repels water and oils without sacrificing durability.
- 2 100g 3M™ Thinsulate™ with Soft Sherpa lining keeps hands warm and comfortable.
- 3 Water and abrasion resistant Durahide™ Leather technology infused palm and fingers.
- 4 3mm EVA foam provides optimal knuckle protection.
- 5 Gunn cut finger design repositions vulnerable seams for improved durability.
- 6 Heavy-weight tubular knit cuff secures the glove and locks in warmth.



INTENDED USES

- Maintenance & Repair
- Construction
- Agriculture
- Home Improvement
- Towing & Transportation

CERTIFICATIONS

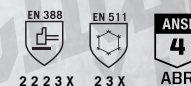

SIZE	S-008	M-009	L-010	XL-011	XXL-012
COLOR	CWKCVU-75 TAN				

COLDWORK™ CANVAS UTILITY