

# Installation Instructions for Compact Hinges with Adjustable Soft-Close – 9390ADJ Series



## Required Parts:

- 1 ea #7 X 5/8" pan washer head screw
- 1 ea #7 X 5/8" flat head screw (for hinges with no press-in dowels)

## Optional Parts:

- 85° Restrictor Clip (9390.RC)
- Replacement dowels & screws

## Tools:

- Phillips Screwdriver
- 3/16" Slotted Screwdriver
- Hinge Boring Machine (HRBORE220SP)
- Insertion Ram for Compact Hinges (LARM7390)

Scan the QR to see the benefits of soft-close adjustability in action.



Or visit [delivr.com/2q9hv](http://delivr.com/2q9hv)

Scan the QR to learn about the features and benefits of our 9390 hinges.

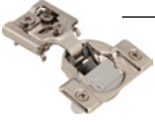

Or visit: [delivr.com/22rjp](http://delivr.com/22rjp)

9390 SERIES APPLICATION	1/2" Overlay	1-1/4" Overlay
 Soft-close No Dowels	9390ADJ 200/ctn	—
 Soft-close Press-in 8 mm Dowels	9390-2-000ADJ 200/ctn	9394-000ADJ 200/ctn



**9390ADJ Series**  
No Dowels  
Adjustable Soft-close



**9390ADJ Series**  
Press-in 8 mm Dowels  
Adjustable Soft-close

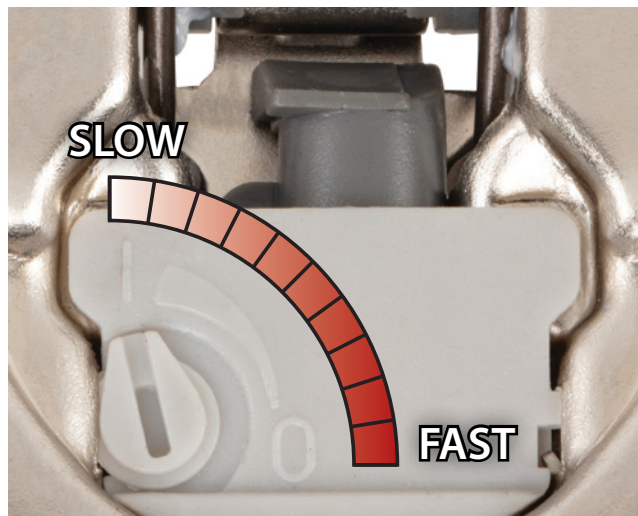

| = Strongest Soft-close; Slowest closing  
 0 = Soft-close off; Fastest closing

## Adjust the closing speed of the hinge using the soft-close dial:

Turn the dial to adjust the closing speed of the door. We recommend a 3/16" slotted screwdriver to adjust the soft-close.

There are 10 positions on the dial. The | symbol marks the strongest soft-close setting, for the slowest door closing speed. The 0 symbol indicates the soft-close off position for the fastest door closing speed.

Adjust the door hinges to the closing speed of your customer's choice.

After adjustment, cycle the door once for the new setting to take effect.

# Installation Instructions for Compact Hinges with Adjustable Soft-Close – 9390ADJ Series

## 1. Bore door(s) to accommodate hinge cup and dowels (if applicable).

- a. Determine the number of hinges that are needed for each door using the figure (below left).

### Number of Compact Hinges Needed

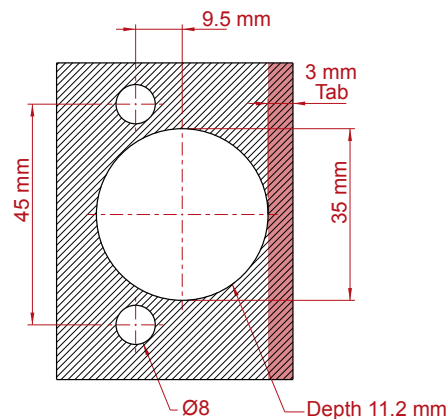
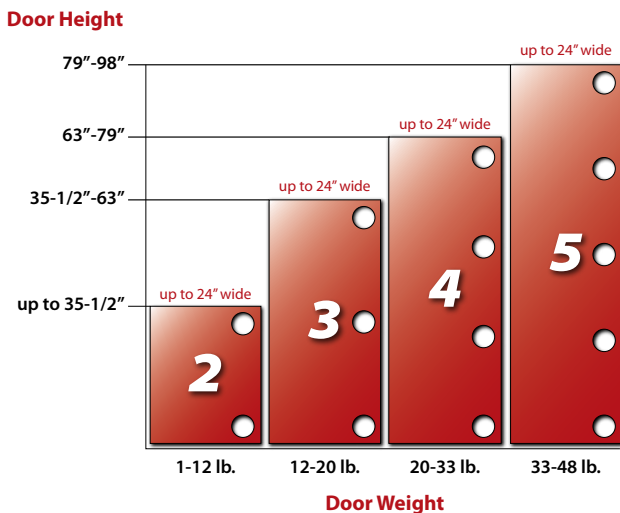

	Boring Depth	Tab
9390ADJ Series	11.2 mm	3 mm

NOTE: Avoid doors that are wider than they are tall.  
Keep hinges as close to top and bottom of door as possible.  
Attach hinges and plates using all available holes.

- b. Use the boring pattern (above right) to bore each door for each hinge to be attached.  
NOTE: A tab of 3 mm is recommended to ensure the correct overlay for all compact hinges.  
NOTE: If not using press-in dowels, skip drilling of 8 mm holes.
- c. Use the cabinet door boring machine **HRBORE220SP** (sold separately) to bore the holes.

**HRBORE220SP**  
Hinge Boring  
Machine



Learn more about our Hinge Boring Machine.

Scan QR to view the video.

<https://delivr.com/2x3gu>



## 2. Install hinges to door.

- a. For hinges with press-in dowels: Use **LARM7390** (sold separately) for pressing 9390ADJ series.
- b. For hinges with no press-in dowels: Use 1 ea #7 X 5/8" flat head screw **7X580** to attach each hinge to the cabinet.

For hinges with press-in dowels:

**LARM7390**  
Insertion Ram



For hinges with no press-in dowels:

**7X580**  
#7 x 5/8" flat head screw

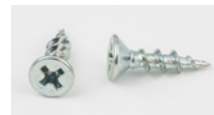

# Installation Instructions for Compact Hinges with Adjustable Soft-Close – 9390ADJ Series

## 3. Install hinges to cabinet.

- a. Use 1 ea #7 X 5/8" pan washer head screw 7X0580WCQ to attach each hinge to the cabinet.

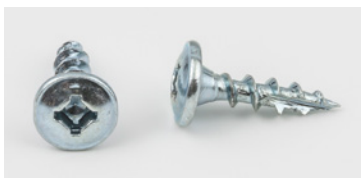

7X050WCQ  
#7 X 5/8" pan washer head screw

## 4. Adjust the hinge(s) as needed.

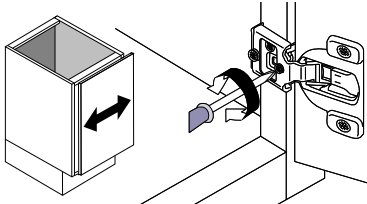
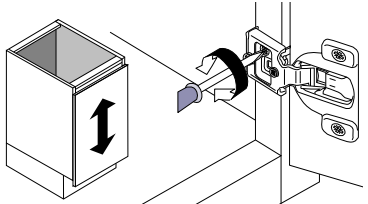
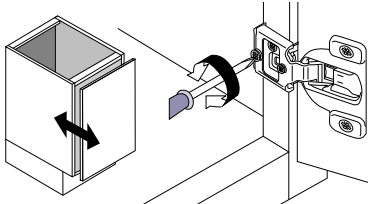
Horizontal adjustment	Vertical adjustment	Depth adjustment
Rotate front screw to increase or decrease door overlay.	Rotate center cam screw to adjust door position.	Rotate rear cam screw to adjust door position.
		

## 5. Install 85° restrictor clips as needed.

- a. Align the restrictor clip 9390.RC to the rear of the hinge cup and press in gently.



9390.RC  
85° Restrictor Clip



Scan QR to view compact hinge restrictor clip video.  
<https://delivr.com/2vmc9>

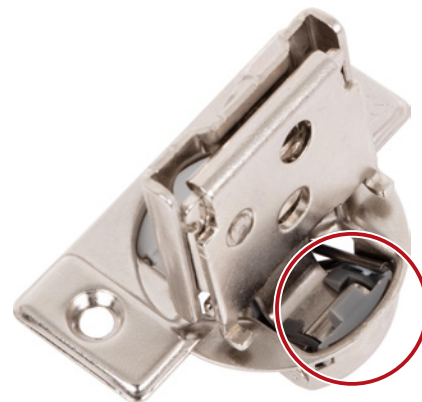
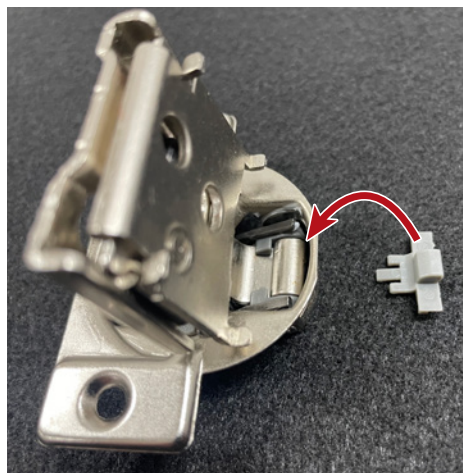

- b. Cycle the hinge 3 times to ensure the clip is properly seated and the hinge opening is now limited to 85°.

## 6. Adjust the closing speed of the hinge.

See the bottom of the first page for detailed instructions on how to adjust soft-close strength.