

READ, FOLLOW AND SAVE THESE INSTRUCTIONS

MODEL #GL40736

INDOOR - OUTDOOR STRINGLIGHT

BATTERY INSTALLATION (ill. 1)

Your stringlight requires three (3) AA alkaline 1.5V batteries (not included) to achieve maximum battery life.

Clean the battery contacts and also those of the device prior to battery installation.

1. To open battery compartment, push clip up.
2. Insert three (3) AA alkaline batteries into the compartment in the proper polarity as shown.
3. Close the battery compartment.

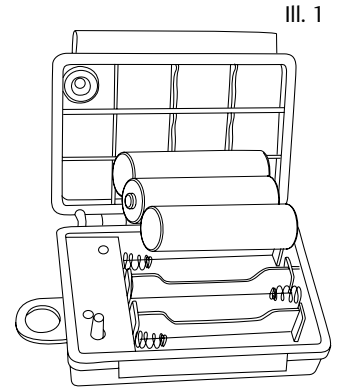

HOW TO OPERATE THE STRINGLIGHT USING BATTERY BOX (ill. 2)

Press the button on the battery box to select from 8 pre-programmed sequences.

HOW TO OPERATE THE STRINGLIGHT AND TIMER USING REMOTE CONTROL (ill. 3)

“TIMER” MODE”

Push “TIMER” button to activate the timer. The stringlight will automatically turn off after 6 hours.

If the ON or OFF button is pressed, the timer function will be reset and the lights will not turn on at the desired time. To re-start the timer function, press the timer button at the desired time to re-initiate this setting.

Note: If the “ON” or “OFF” button on either remote or battery box is pressed, the timer function will be reset and the lights will not turn on at the desired time.

“ON/OFF” MODE

1. Push the “ON” button to turn stringlight on.
2. Choose a sequence mode by pressing button 1 to 8.
3. Push the “+” or “-” button to adjust the light intensity
4. Push the “OFF” button to turn stringlight off.

FIND A LOCATION FOR THE BATTERY BOX (ill. 4)

Note: Do not place the controller directly on the ground as water could penetrate if it is soaking in water.

1. The controller is designed for outdoor use and is weather resistant.
2. Make sure that the controller can be installed in a location that will allow a direct line of sight with the remote to operate properly.
3. Any objects between the front of the control box and the remote control will reduce the range.
4. Mount the controller in the best location and do not place it close to the electrical outlet.

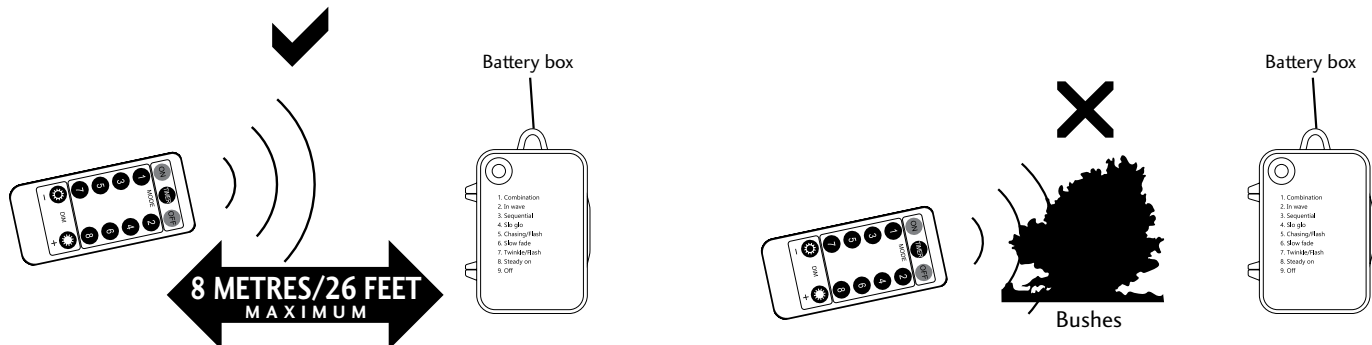
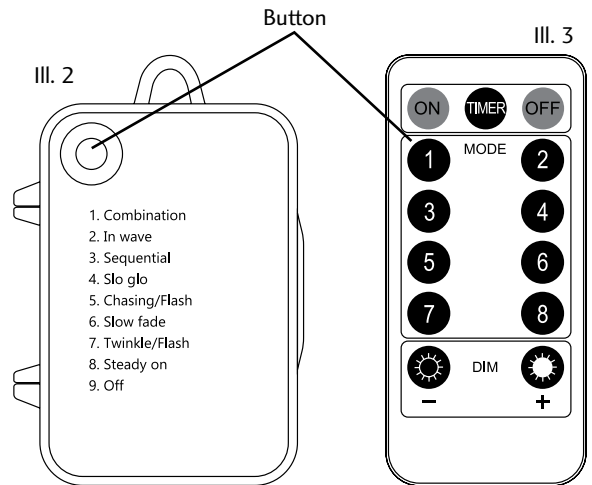

CUSTOMER SERVICE

1-888-867-6095 • customerservice@sternohome.com • www.sternohome.com

5021-GL40736-EN_120618

REMOTE CONTROL BATTERY REPLACEMENT (ill. 5)

Note: The remote control operates with one coin cell battery CR2025 (included) or CR2032.

1. Push tab while pulling out battery compartment as shown.
2. Remove used battery, clean the battery contacts and replace with either a new CR2025 or CR2032 3V Lithium battery in proper polarity as indicated.
3. Close battery door on the remote control.

Note: If the remote distance is significantly reduced, replacing the battery should improve the range.

IMPORTANT INFORMATION: Battery should be recycled as per local guidelines.

Batteries contain substances which are harmful to the environment or persons.

- Do not dispose in municipal waste.
- Recycling batteries helps preserve the environment.
- This product contains a button battery. If swallowed, it could cause severe injury or death in just 2 hours. Seek medical attention immediately.
- Remove batteries from equipment which is not to be used for an extended period.

ill. 5

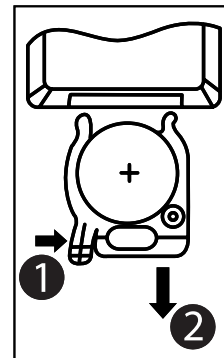

TROUBLESHOOTING

All of the lights fail to work:

- Check that the power is on.
- Change the remote battery.
- Clean the front of the controller.

MAINTENANCE

- To clean, wash with a damp soft cloth.
- Replacement parts may be ordered by using the fixture model number and the part's name.

CAUTION

- Avoid contact with standing water and protect from extreme weather.
- To increase the lifespan of your stringlight, store indoors when not in use.
- Failure to insert batteries in the correct polarity, as indicated, may shorten the battery life or may cause them to leak.
- Always replace the whole set of batteries at one time, taking care not to mix old and new ones, or batteries of different types.
- Do not mix Alkaline, Standard (Carbon-Zinc) or Rechargeable (Nickel Cadmium or Nickel Metal Hydride) batteries.
- Remove batteries if exhausted or if product is to be left unused for a long period of time.
- Do not dispose of batteries in fire.
- This is not a toy. For decorative use only.
- Batteries should be recycled or disposed of as per manufacturer's recommendations.
- Always purchase the correct size and grade of battery most suitable for the intended use. Clean the battery contacts and also those of the device prior to battery installation. Ensure the batteries are installed correctly with regard to polarity (+and -). Remove used batteries promptly.

ICES-005

- This Class B digital apparatus complies with Canadian ICES-005.
- Operation is subject to the following two conditions: (1) this device may not cause harmful interference and (2) this device must accept any interference received, including interference that may cause undesired operation.

This device complies with Part 15 of the FCC rules. Operation is subject to the following two conditions (1) This device may not cause harmful interference, and (2) this device must accept any interference received, including interference that may cause undesired operation.

Note: This equipment has been tested and found to comply with the limits for a Class B digital device, pursuant to part 15 of the FCC Rules. These limits are designed to provide reasonable protection against harmful interference in a residential installation. This equipment generates, uses and can radiate radio frequency energy and, if not installed and used in accordance with the instructions, may cause harmful interference to radio communications. However, there is no guarantee that interference will not occur in a particular installation. If this equipment does cause harmful interference to radio or television reception, which can be determined by turning the equipment off and on, the user is encouraged to try to correct the interference by one or more of the following measures:

-Reorient or relocate the receiving antenna.

-Increase the separation between the equipment and receiver.

Connect the equipment into an outlet on a circuit different from that to which the receiver is connected. Consult the dealer or an experienced radio/TV technician for help.

Warning: Any changes or modifications to this unit not expressly approved by the party responsible for compliance could void the user's authority to operate the equipment

ONE (1) YEAR LIMITED WARRANTY

This product is guaranteed to be free from defects in material and workmanship for one (1) year following the date of purchase (excluding the battery/batteries). Should a defect occur within the warranty period, please contact our customer service line at 1-888-867-6095 or at the following email address: customerservice@sternohome.com. A proof of purchase (sales receipt) will be required. If we cannot replace the defective part you require, you can return your product to the original point of purchase for a full refund or a replacement product. The consumer is responsible for the removal of and reinstallation of the product. Damage to any parts as such by accident, misuse, or improper installation is NOT covered by this warranty. Our policy does not include liability for incidental or consequential damages. Some states or provinces do not allow the exclusion or limitation of consequential damages; therefore, the above exclusion may not apply to you. This warranty gives you specific legal rights and you may also have other rights that vary from place to place.

CUSTOMER SERVICE

1-888-867-6095 • customerservice@sternohome.com • www.sternohome.com