



BEST CHOICE
PRODUCTS



INSTRUCTION MANUAL

Solar LED Rotating
Cantilever Umbrella

SKY9547 + SKY9548 + SKY9549 + SKY9550 + SKY9551 + SKY9552
SKY9553 + SKY9554 + SKY9555 + SKY9556 + SKY9557 + SKY9558



Solar panel
requires 6 to 7
hours of direct
sunlight to
fully charge.





Do not use without
umbrella base weights.

Recommended Weight:
>200 lbs.

bestchoiceproducts.com



**BEST CHOICE
PRODUCTS**

As shoppers, we're always trying to find the perfect balance between quality & value. At BCP, we believe we've achieved that. Our diverse catalog of everyday essentials is tailored especially to our customers & guaranteed to hit that sweet spot of high quality & low price.

— Always. —

! NOTICE

Please retain these instructions for future reference.

- Umbrella base weights are not included. Do not use without umbrella base weights (recommended weight: >200 lbs.)
- Place umbrella on a stable and level surface.
- Umbrella is suitable for rain showers and light wind.
- Do not use umbrella in inclement weather, such as snow, heavy rain, thunderstorms, or strong wind.
- Firmly secure all bolts, screws and knobs before use.
- This product is intended for outdoor use.
- Reconfirm that all bolts, screws, and knobs are secure every 90 days.
- Fasten screws loosely during initial assembly. Do not firmly tighten the screws until the item is completely assembled.
- Be aware that some parts are heavy and have sharp edges.
- If any parts are missing, broken, damaged, or worn, stop using this product until repairs are made and/or factory replacement parts are installed.
- Do not use this item in a way inconsistent with the manufacturer's instructions as this could void the product warranty.
- This product is intended for residential use only.

TOOLS REQUIRED



WRENCH
(PROVIDED)



2 PERSON
ASSEMBLY



UP TO 30 MIN.
ASSEMBLY

HARDWARE

1

BOLT



8 PCS

2

WASHER



8 PCS

3

TENSION
KNOB



1 PC

PARTS

A

UMBRELLA

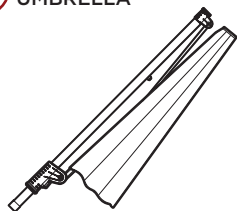

1 PC

B

CROSSBAR I

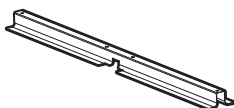

1 PC

C

CROSSBAR II

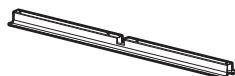

1 PC

D

POLE ADAPTER

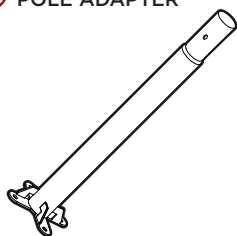

1 PC

E

ROTATOR BASE

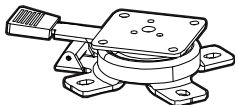

1 PC

F

ROTATOR COLLAR

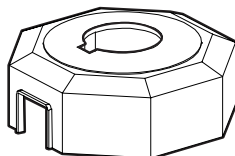

1 PC

G

SOLAR PANEL

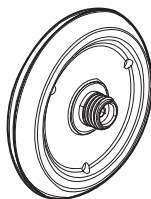

1 PC

BEFORE FIRST USE

1. Hold the **part A umbrella** upside down and shake gently to separate the umbrella ribs. If necessary, carefully pull the ribs apart to free them.
2. Squeeze the trigger release and slowly push the collar up the shaft to open the umbrella. Make sure that the ribs are not stuck together.

PRODUCT ASSEMBLY

1

Insert the **part B crossbar I** into the **part C crossbar II** and set aside.

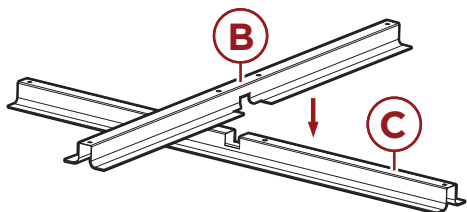

2

Locate the **part G solar panel** and attach it to the **part A umbrella**, twist until secured.

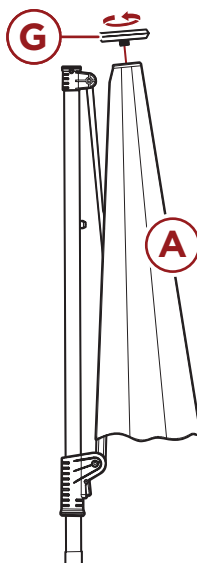

3

Locate the **part E rotator base** and press down on the pedal to rotate the base and expose the lower mounting holes. Overlay the rotator base with the crossbar assembly.

Attach the **part E rotator base** to the **part B & C crossbars** with four **part 1 bolts** and four **part 2 washers**.

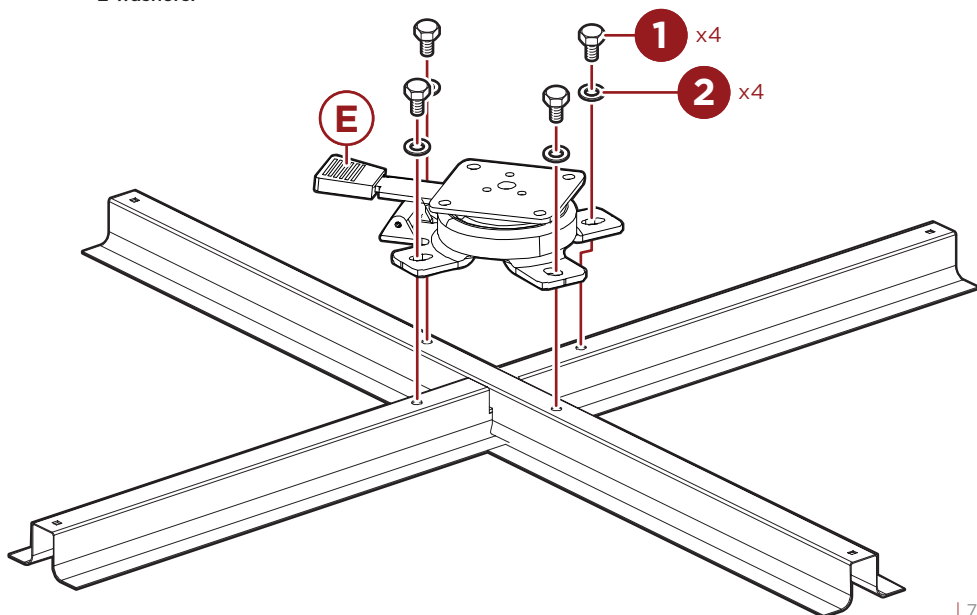

PRODUCT ASSEMBLY

4

Attach the **part D pole adapter** to the **part E rotator base** with four **part 1 screws** and four **part 2 washers**.

Slide the **part F rotator collar** onto the **part D pole adapter** and cover the rotator collar.

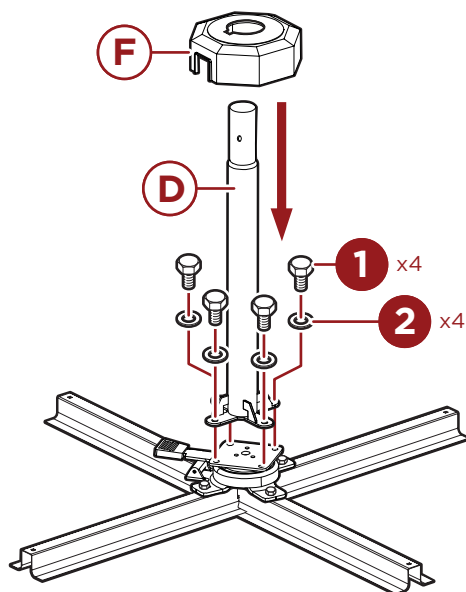

5

Attach the **part A umbrella** to the **part D pole adapter**, then secure with the **part 3 tension knob**.

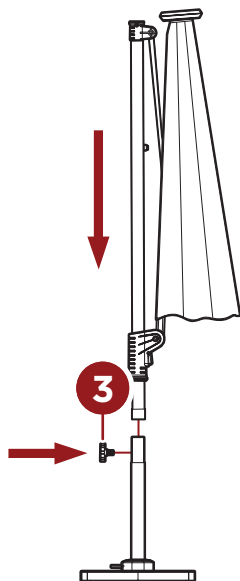

OPENING THE CANOPY

1. Grip and squeeze the handle to engage the release. Move the arm up.
2. Release the handle to lock the canopy in your desired position.

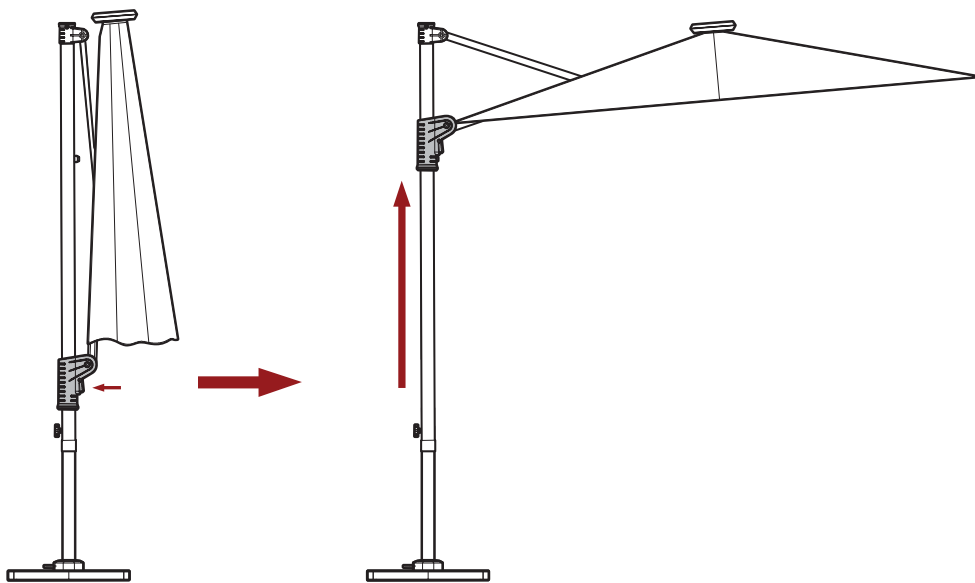

TURNING ON THE LIGHTS

Press the power switch on the canopy to turn on LED lights.

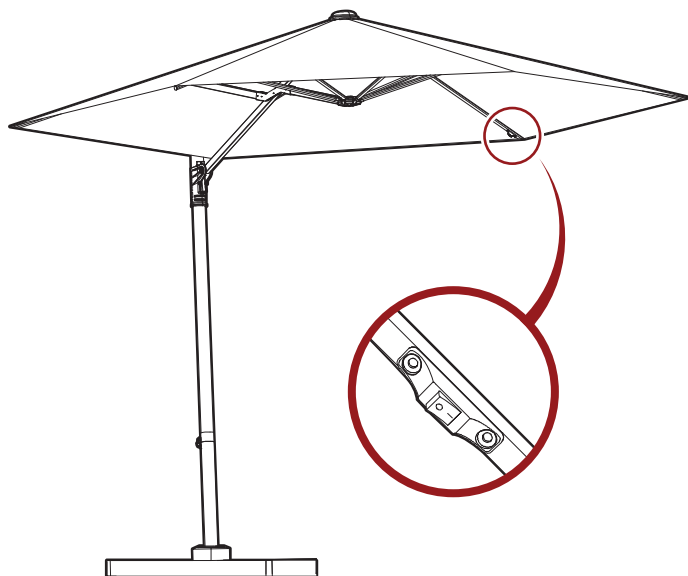

ROTATING CANOPY

Use your foot to compress the pedal on the rotating base to rotate the canopy.

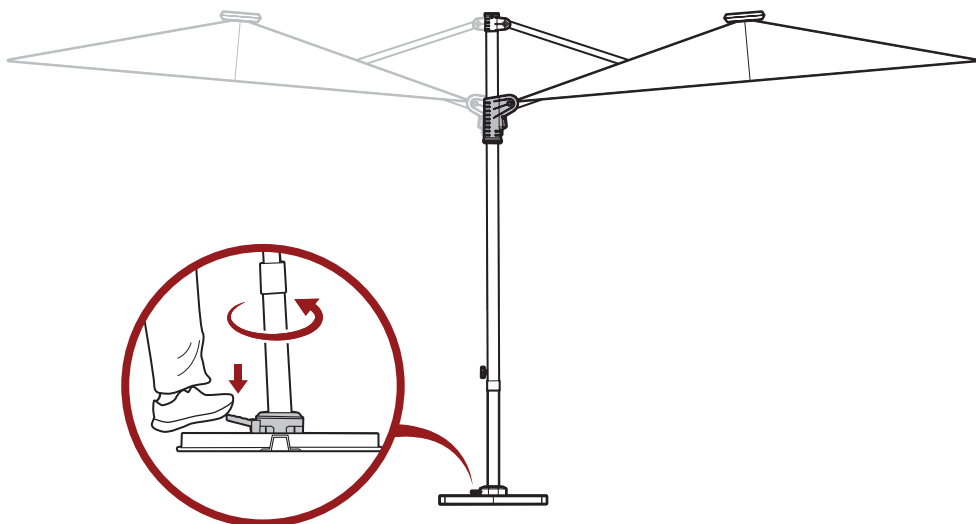

CLOSING THE CANOPY

1. Grip and squeeze the handle to engage the release. Move the arm down.
2. Release the handle when the canopy is closed.

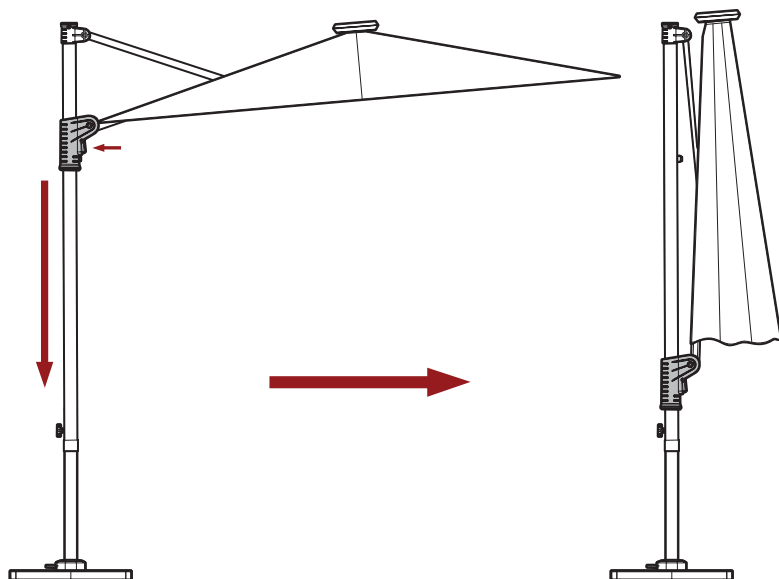

CHARGING THE LIGHTS

- Solar panel requires 6 to 7 hours of direct sunlight to fully charge.
- LED lights last for 6 to 7 hours on a single charge.
- If lights are not working, fully charge the solar panel and try again.

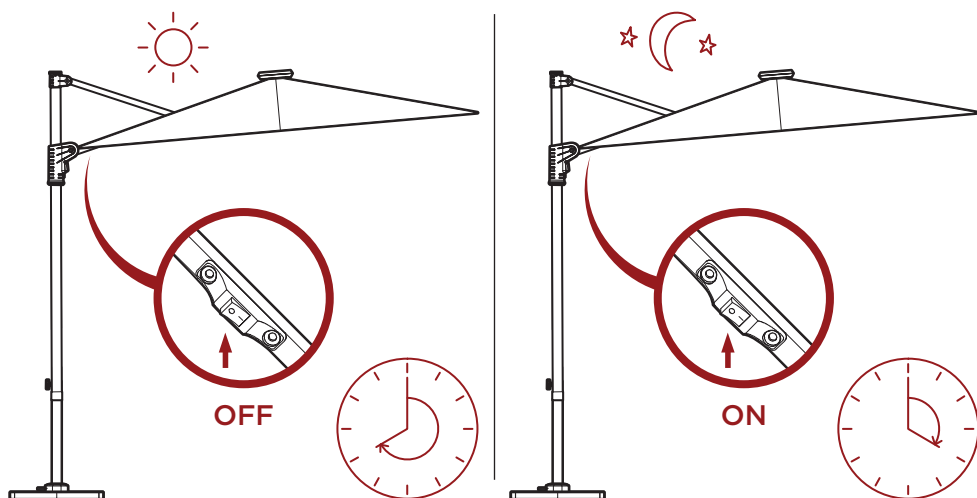

STORAGE

- Close the canopy when umbrella is not in use.
- Grip the handle and move the arm all the way down, then secure the umbrella with the attached touch fastener.
- Store in a dry area shielded from the weather.

CLEANING

- Wipe clean with mild detergent, warm water, and a soft cloth.
- Do not use abrasive materials or cleaners.



HELP CENTER



Question about your product? We're here to help. Visit us at:

help.bestchoiceproducts.com



Chat Support



Product Inquiry



Orders FAQ



Product Assembly



Returns & Refunds

PRODUCT WARRANTY INFORMATION

All items can be returned for any reason within 60 days of the receipt and will receive a full refund as long as the item is returned in its original product packaging and all accessories from its original shipment are included. All returned items will receive a full refund back to the original payment method. All returned items will not be charged a re-stocking fee.

All returned items require an RA (Return Authorization) number, which can only be provided by a Best Choice Products Customer Service Representative when the return request is submitted. Items received without an RA may not be accepted or may increase your return processing time. Once an item has been received by Best Choice Products, refunds or replacements will be processed within 5 business days.

All returns must be shipped back to the Best Choice Products Return Center at the customer's expense. If the reason for return is a result of an error by Best Choice Products then Best Choice Products will provide a pre-paid shipping label via email. Boxes for return shipping will not be provided by Best Choice Products, and is the customer's responsibility to either use the original shipping boxes or purchase new boxes.

Pictures may be required for some returns to ensure an item is not damaged prior to its return. Items returned are not considered undamaged until they are received by Best Choice Products and verified as such. All damages to items are the customer's responsibility until the item has been received by and acknowledge by Best Choice Products as undamaged.

© Best Choice Products, Inc. All rights reserved. Distributed by Best Choice Products, Inc. Newport Beach, CA 92660



WARNING

Manufacturer and seller expressly disclaim any and all liability for personal injury, property damage or loss, whether direct, indirect, or incidental, resulting from the incorrect attachment, improper use, inadequate maintenance, unapproved modification, or neglect of this product.