



**Size: 19.685" x 17.5"**

**Please Read and Save this Use and Care Book**

## IMPORTANT SAFEGUARDS

When using electrical appliances, basic safety precautions should always be followed, including the following:

- Read all instructions.
- To protect against a risk of electric shock, do not immerse mixer, cord, plug, or base unit in water or other liquid.
- Close supervision is necessary when any appliance is used by or near children.
- Unplug from outlet when not in use, before putting on or taking off parts, and before cleaning. Turn off before inserting or removing parts.
- Avoid contacting moving parts.
- Do not operate any appliance with a damaged cord or plug or after the appliance malfunctions or is dropped or damaged in any manner. Return the appliance to the nearest authorized service facility for examination, repair, or electrical or mechanical adjustment. Or, call the appropriate toll-free number listed on the cover of this manual.
- The use of attachments not recommended or sold by the appliance manufacturer may cause fire, electric shock, or injury.
- Do not use outdoors.
- Keep hands, hair, clothing, as well as handheld spatulas and other utensils away from beaters/whisks during operation to reduce the risk of injury to persons and/or damage to the mixer.
- Do not let cord hang over the edge of table or counter.
- Do not let cord touch hot surfaces including the stove.
- Remove beaters/whisks and dough hooks from mixer before washing.
- Do not use appliance for other than intended use.

**CAUTION - This stand is designed for use only with the Black and Decker® Model MX900 5-speed mixer. Use of other appliances may result in instability causing possible injury.**

## SAVE THESE INSTRUCTIONS.

**This product is for household use only.**

### POLARIZED PLUG (120V Models Only)

This appliance has a polarized plug (one blade is wider than the other). To reduce the risk of electric shock, this plug is intended to fit into a polarized outlet only one way. If the plug does not fit fully into the outlet, reverse the plug. If it still does not fit, contact a qualified electrician. Do not attempt to modify the plug in any way.

### TAMPER-RESISTANT SCREW

**Warning: This appliance is equipped with a tamper-resistant screw to prevent removal of the outer cover. To reduce the risk of fire or electric shock, do not attempt to remove the outer cover. There are no user-serviceable parts inside. Repair should be done only by authorized service personnel.**

### ELECTRICAL CORD

- a) A short power-supply cord (or detachable power-supply cord) is to be provided to reduce the risk resulting from becoming entangled in or tripping over a longer cord.
- b) Longer detachable power-supply cords or extension cords are available and may be used if care is exercised in their use.
- c) If a long detachable power-supply cord or extension cord is used,
  1. The marked electrical rating of the detachable power-supply cord or extension cord should be at least as great as the electrical rating of the appliance,
  2. If the appliance is of the grounded type, the extension cord should be a grounding-type 3-wire cord, and
  3. The longer cord should be arranged so that it will not drape over the countertop or tabletop where it can be pulled on by children or tripped over.

**Note:** If the power supply cord is damaged, it should be replaced by qualified personnel or in Latin America by an authorized service center.

**Product may vary slightly from what is illustrated.**

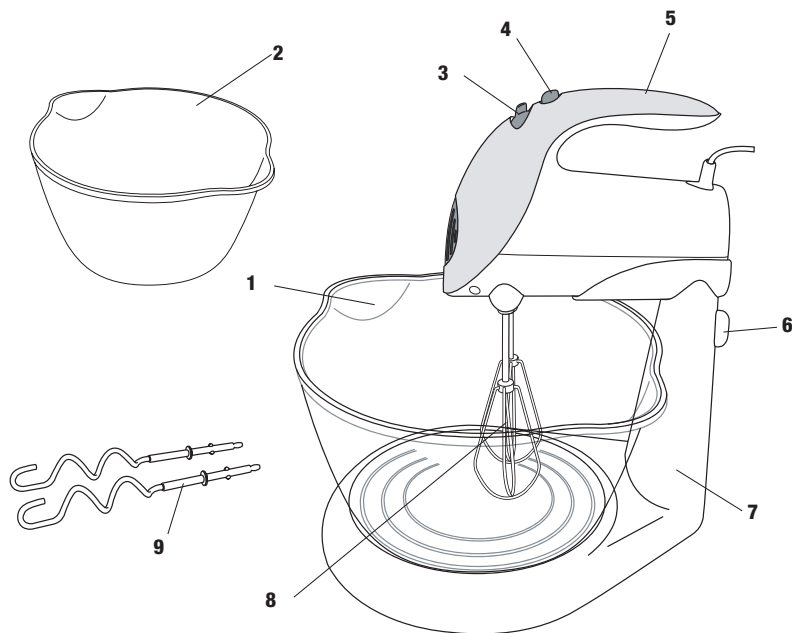

- 1. 3.7L glass bowl with spout-shaped handles**
- 2. 4.2L plastic bowl with spout-shaped handles**
- 3. 5-speed switch**
- 4. Eject (▲) button**
- 5. Handle**
- 6. Release (botón de liberación) button**
- 7. Stand**
- 8. Wire beaters (2)**
- 9. Dough hooks (2)**

## How to Use

This product is for household use only.

1. After unpacking, before first use, remove all stickers, packing material, and literature. Wash all parts as instructed in the Care and Cleaning section.
2. Make sure speed switch is in the off (0) position and unplugged before inserting or removing attachments.

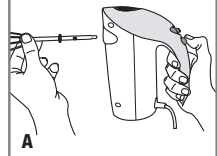

- **To insert wire beaters:** Match beater with the collar near its stem end to the illustration located near the opening (A). Push in beater, rotating slightly if necessary, until it locks into place. Insert other beater into the second hole, also rotating it if necessary, until it locks into place.

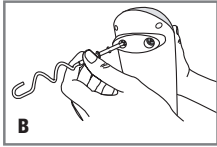

- **To insert dough hook:** Match dough hook into either opening of the mixer. Gently push in each dough hook, rotating it slightly if necessary, until it locks into place (B).

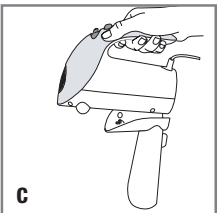

3. Place ingredients to be mixed in a bowl.
4. Plug cord into an outlet.
5. If mixing on stand, place mixer on the stand and click into place (C). Place bowl in bowl rest beneath mixer.
6. If mixing by handheld method, remove mixer from stand by pressing the release button (D) conveniently located on the stand. Insert beaters or dough hooks into center of food in bowl, holding the mixer by the handle.

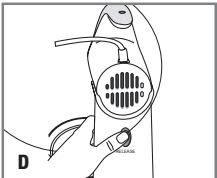

7. Use the mixing guide below to select the correct speed (E) for the food you are mixing. Generally, it is best to start on the lowest speed (1), then increase speed with beaters or dough hooks immersed in the food.

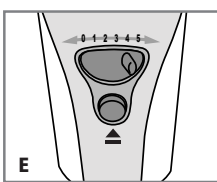

**Note:** The bowls cannot rotate 360 degrees because of the spout/handles.

8. Guide beaters or dough hooks continuously through the mixture for uniform mixing. We recommend using a spatula to scrape away buildup from sides or bottom of the bowl and blend ingredients back into beaters. Be sure to turn speed switch off (0). Place mixer on stand so that batter will drip back into bowl. Hold mixer by handle with beaters or dough hooks facing forward.

9. To remove beaters, push (▲) button.

**Caution: Be careful when ejecting the beaters or dough hooks since they come out of the mixer quickly. You may want to eject them into bowl or into a sink.**

Mixing Guide		
Use the following guide for speed selections. Note: Start mixing at the lowest speed and gradually increase as needed. For best results, use wire beaters to whip light, fluffy mixtures, heavy cream, or eggs, at speed #5.		
SPEED FUNCTION USE		
<b>1 (Low) Blend</b>	To blend flour/dry ingredients, and liquids for batters and cookie doughs. To blend nuts, chips, raisins into cookie doughs.	
<b>2 (Low/Med) Stir</b>	To prepare sauces, puddings, muffins, and quick breads. To stir thin batters.	
<b>3 (Medium) Mix</b>	To prepare batters and cake mixes. To cream butter and sugar or mix eggs into batters.	
<b>4 (Med/High) Beat</b>	To beat whole eggs, frozen desserts, frostings. To mix light batters like popovers.	
<b>5 (High) Whip</b>	To whip fluffy mixtures, whipped cream, egg whites, and mashed potatoes.	

### Mixing Tips

For best results when whipping cream, chill the cream, beaters, and bowl. Start with the lowest setting and gradually increase to whip (#5) as the cream begins to thicken.

**Note:** For best volume when whipping cream, do not use a spatula.

We recommend using the mixer for 3 minutes of continuous use for 1 off for all functions or speeds.

Speed	MX900(120V) RPMs	MX900(220V) RPMs
1	1000 +/- 250	940 +/- 250
2	1100 +/- 250	1020 +/- 250
3	1180 +/- 250	1080 +/- 250
4	1250 +/- 250	1150 +/- 250
5	1320 +/- 250	1250 +/- 250

## Care and Cleaning

This product contains no user serviceable parts. Refer service to qualified service personnel.

### CLEANING

1. Make sure speed switch is in off (0) position and cord is unplugged before cleaning any part of mixer. Press (▲) button to remove beaters or dough hooks.
2. The beaters and dough hooks may be washed in warm, sudsy water or in a dishwasher. Dry all parts thoroughly before storing.
3. Clean the mixer, stand or cord with a damp cloth. To remove stubborn spots, wipe surfaces with a cloth dampened in sudsy water or a mild, non-abrasive cleaner. Follow with a clean, damp cloth. Do not use abrasive cleaners on any part of mixer as they can damage the finish.

### Storing the Mixer and Stand

- To prolong the life of the unit, avoid jerking the power cord or straining it at the plug connection.
- To store, coil cord in loops and secure it with attached cord tie. Do not wrap cord around mixer.

### NEED HELP?

For service, repair or any questions regarding your appliance, call the appropriate 800 number on cover of this book. Please DO NOT return the product to the place of purchase. Also, please DO NOT mail product back to manufacturer, nor bring it to a service center. You may also want to consult the website listed on the cover of this manual.

### TWO-YEAR LIMITED WARRANTY

(Applies only in the United States and Canada)

#### What does it cover?

- Any defect in material or workmanship provided; however, liability will not exceed the purchase price of product.

#### For how long?

- Two years from the date of original purchase with proof of such purchase.

#### What will we do to help you?

- Provide you with a reasonably similar replacement product that is either new or factory refurbished.

#### How do you get service?

- Save your receipt as proof of date of sale.
- Visit the online service website at [www.prodprotect.com/applica](http://www.prodprotect.com/applica), or call toll-free 1-800-231-9786, for general warranty service
- If you need parts or accessories, please call 1-800-738-0245.
- **What does your warranty not cover?**
- Damage from commercial use
- Damage from misuse, abuse or neglect
- Products that have been modified in any way
- Products used or serviced outside the country of purchase
- Glass parts and other accessory items that are packed with the unit
- Shipping and handling costs associated with the replacement of the unit

- Consequential or incidental damages (Please note, however, that some states do not allow the exclusion or limitation of consequential or incidental damages, so this limitation may not apply to you.)

#### How does state law relate to this warranty?

- This warranty gives you specific legal rights. You may also have other rights that vary from state to state or province to province.
- This warranty shall not be valid where it is contrary to U.S. and other applicable laws, or where the warranty would be prohibited under any economic sanctions, export control laws, embargos, or other restrictive trade measures enforced by the United States or other applicable jurisdictions. This includes, without limitation, any warranty claims implicating parties from, or otherwise located in, Cuba, Iran, North Korea, Syria, and the disputed Crimea region.

## PÓLIZA DE GARANTÍA

(Válida sólo para México)

### DURACIÓN

Spectrum Brands de México, SA de CV garantiza este producto por 2 años a partir de la fecha original de compra.

#### ¿Qué cubre esta garantía?

- Esta Garantía cubre cualquier defecto que presenten las piezas, componentes y la mano de obra contenidas en este producto.
- Requisitos para hacer válida la garantía
- Para reclamar su Garantía deberá presentar al Centro de Servicio Autorizado la póliza sellada por el establecimiento en donde adquirió el producto. Si no la tiene, podrá presentar el comprobante de compra original.

#### ¿Dónde hago válida la garantía?

- Llame sin costo al teléfono 01 800 714 2503, para ubicar el Centro de Servicio Autorizado más cercano a su domicilio en donde usted podrá encontrar partes, componentes, consumibles y accesorios.

#### Procedimiento para hacer válida la garantía

Acuda al Centro de Servicio Autorizado con el producto con la póliza de Garantía sellada o el comprobante de compra original, ahí se reemplazará cualquier pieza o componente defectuoso sin cargo alguno para el usuario final. Esta Garantía incluye los gastos de transportación que se deriven de su cumplimiento.

#### Excepciones

Esta Garantía no será válida cuando el producto:

- A) Se hubiese utilizado en condiciones distintas a las normales.
- B) No hubiese sido operado de acuerdo con el instructivo de uso que le acompaña.
- C) Cuando el producto hubiese sido alterado o reparado por personas no autorizadas por Spectrum Brands de México, SA de CV.

**Nota:** Usted podrá encontrar partes, componentes, consumibles y accesorios en los centros de servicios autorizados. Esta garantía incluyen los gastos de transportación que se deriven de sus cumplimiento dentro de sus red de servicio.

Esta garantía no será válida cuando sea contraria a las leyes de EE. UU. Y otras leyes aplicables, o donde la garantía esté prohibida bajo cualquier sanción económica, leyes de control de exportaciones, embargos u otras medidas comerciales restrictivas impuestas por los Estados Unidos u otras jurisdicciones aplicables. Esto incluye, sin limitación, cualquier reclamo de garantía que implique a partes de, o de otra manera ubicadas en, Cuba, Irán, Corea del Norte, Siria y la disputada región de Crimea.

Por favor llame al número correspondiente que aparece en la lista a continuación para solicitar que se haga efectiva la garantía y donde Ud. puede solicitar servicio, reparaciones o partes en el país donde el producto fue comprado.	
<b>Argentina</b> Atención al consumidor 0800 444 7296 Horario de atención Lunes a viernes de 9 a 13 hs y de 14.30 a 17 hs Mail: <a href="mailto:postventa@spectrumbrands.com">postventa@spectrumbrands.com</a>	comercial Novicentro, Local 37 - Ciudad Guatemala Tel. (502)-2476-736
<b>Bolivia</b> Atención al consumidor La Paz: c. Villalobos N°100 esq. Busch. Miraflores. Tel. (02) 2224924 Santa Cruz: Av. Paraguá C. Socoris N°2415 (03) 3602002 Cochabamba: c. Uruguay N°211 esq. Nataníel Aguirre (04) 4501894	<b>Honduras</b> Serviteca San Pedro Sula, B Los Andes, 2 calle-entre 11-12 Avenida Honduras Tel. (504) 2550-1074
<b>Chile</b> Atención al consumidor Inversiones la Mundial Ltda. Dirección: Libertad 790, Santiago de Chile. Teléfonos: +56 226820217 - 226810032	<b>México</b> Artículo 123 # 95 Local 109 y 112 Col. Centro, Cuauhtemoc, México, D.F. Tel. 01 800 714 2503
<b>Colombia</b> Spectrum Brands Corp, S.A.S. Transversal 23 #97-73 Oficinas 403-404-405, Bogotá, Colombia Línea Servicio al Cliente: 018000510012	<b>Nicaragua</b> LRM ELECTRONICA Managua - Sinsa Altamira 1.5 kilómetros al norte Nicaragua Tel. (505) 2270-2684
<b>Costa Rica</b> Aplicaciones Electromecánicas Calle 22 y 24 en Avenida 3 BLV de la torre Mercedes Benz 200 mts norte y 50 mts este San José, Costa Rica Tel. (506) 2257-5716	<b>Panamá</b> Supermarcas Centro comercial El dorado, Plaza Dorado, Local 2. Panama Tel. (507) 392-6231
<b>Ecuador</b> Servicio Master Dirección: Capitán Rafael Ramos OE 1-85 y Galo plaza Iasso. Tel (593) 2281-3882 / 2240-9870	<b>Perú</b> Servicio Central Fast Service Av. Angamos Este 2431 San Borja, Lima Perú Tel. (511) 2251 388
<b>El Salvador</b> Sedeblack Calle San Antonio Abad, Colonia Lisboa No 2936 San Salvador, Depto. de San Salvador Tel. (503) 2284-8374	<b>Puerto Rico</b> Buckeye Service Jesús P. Piñero #1013 Puerto Nuevo, SJ PR 00920 Tel.: (787) 782-6175
<b>Guatemala</b> Kinal 17 avenida 26-75, zona 11 Centro	<b>Republica Dominicana</b> Prolongación Av. Rómulo Betancourt Zona Industrial de Herrera Santo Domingo, República Dominicana Tel.: (809) 530-5409
	<b>Venezuela</b> Inversiones BDR CA Av. Casanova C.C. City Market Nivel Plaza Local 153 Diagonal Hotel Melia, Caracas. Tel. (582) 324-0969