

REVISIONS				
ECN	REV.	DESCRIPTION	DATE	APPROVED
	A	RELEASE FOR PRODUCTION	07-31-17	
18002	B	UPDATED MID-HIGH HOUSING, PLANTER BOX, AND HOUSING	01-10-18	
	C	GRILLE CHANGED TO BACKPLATE FLANGE STYLE	06-20-18	
19033	D	MID/HIGH HOUSING AND PLANTER SHROUD REDESIGN	12-04-19	
24001	E	ADDED GLAND ADAPTOR PLATE	03-28-24	

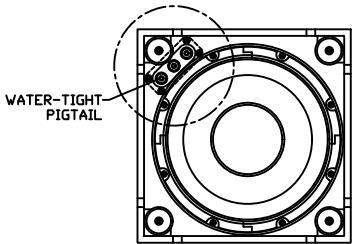

STEREO BI-AMP

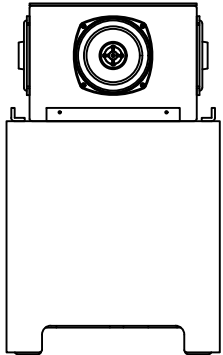
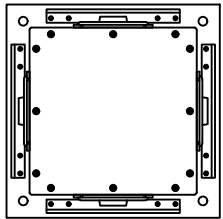
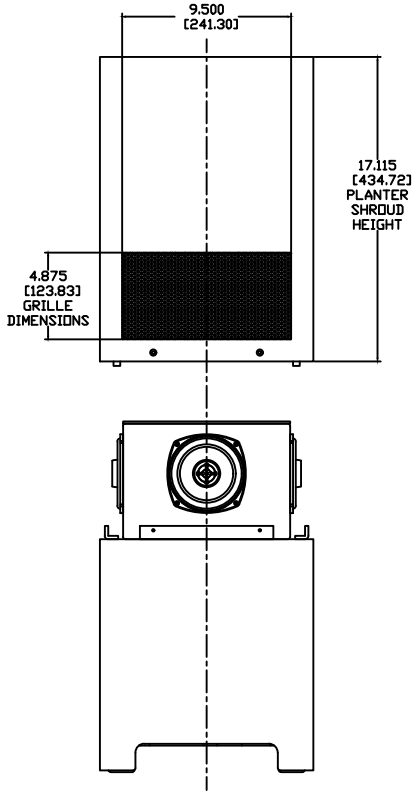
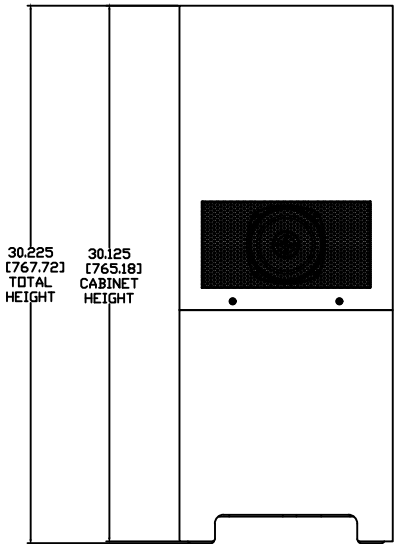
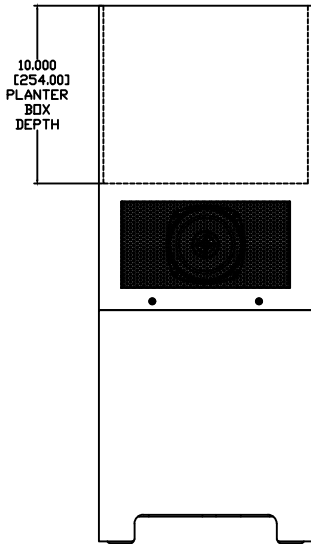
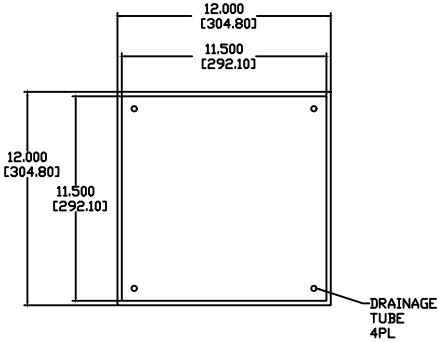
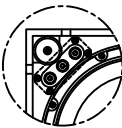

MONO BI-AMP



FULL RANGE

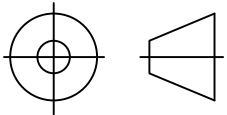

"THIRD ANGLE" PROJECTION

NOTES:

- 1: MATERIAL – 5052 ALUMINUM
UNLESS OTHERWISE SPECIFIED
- 2: FINISH – TBD
- 3: MARINE GRADE
- 4: OMNI PLANTER SHROUD INTERCHANGEABLE WITH STANDARD VERSION

PROPRIETARY INFORMATION THE DESIGNS, INFORMATION, AND DATA CONTAINED HEREIN ARE PROPRIETARY AND ARE SUBMITTED IN CONFIDENCE, AND SHALL NOT BE DISCLOSED, USED OR DUPLICATED IN WHOLE OR IN PART, FOR ANY PURPOSES WHATSOEVER, WITHOUT THE PRIOR WRITTEN PERMISSION OF JAMES LOUDSPEAKER LLC, 2185 PARK PL, MINDEN, NV 89423. THIS LEGEND SHALL BE MARKED ON ANY REPRODUCTIONS HEREOF IN WHOLE OR IN PART. RECEIPT OF THIS DOCUMENT SHALL BE DEEMED TO BE AN ACCEPTANCE OF THE CONDITIONS SPECIFIED HEREIN.		<i>JAMES LOUDSPEAKER</i>	
		<i>OMNI109-P</i>	
		EXTERNAL DIMENSIONS	
		P/N: -	
		DWR #: 170731-N200	
		REVISED BY: G. TAYLOR	
		DRAWN BY: C. NEWMAN	
		DATE: 07-31-17	
		APPROVED:	
		DRAFTING APPROVED:	
		SCALE:	
		TOLERANCES: ANG: ± = .5° FRACT. ± = 1/32	
		DECIMALS: .XX ± = .01 .XXX ± = .005	
		<i>REVISION: E</i>	
		SHEET 1 OF 1	