

# Installation Guide

## Whirlpool Trim Kit

K-9694

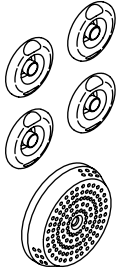

K-9695

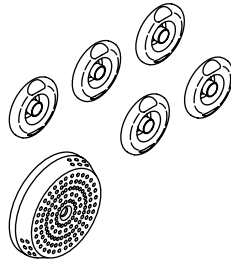

K-9696

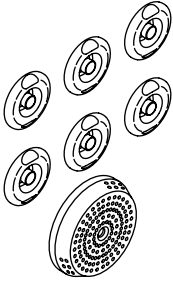

K-9697

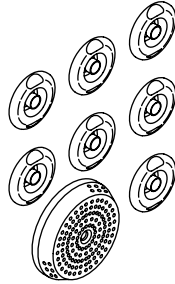

K-9698

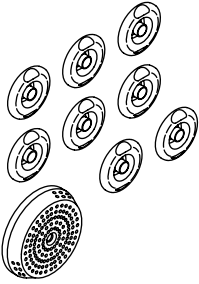

Français, page "Français-1"  
Español, página "Español-1"

1025430-2-B

THE BOLD LOOK  
OF **KOHLER**®

## Thank You For Choosing Kohler Company

We appreciate your commitment to Kohler quality. Please take a few minutes to review this manual before you start installation. If you encounter any installation or performance problems please don't hesitate to contact us. Our phone numbers and web site are listed on the back cover. Thanks again for choosing Kohler Company.

## Tools and Materials

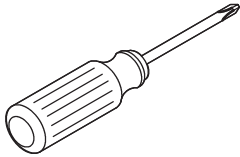

Screwdriver

### Plus:

- Silicone Lubricant (Supplied)
- Jet Removal Tool (Supplied)

## Before You Begin



**WARNING: Risk of personal injury or death.** Never operate the whirlpool bath without the suction cover in place. Doing so may result in serious injury or death. If your whirlpool does not have the suction cover installed, install the necessary parts prior to using your whirlpool.

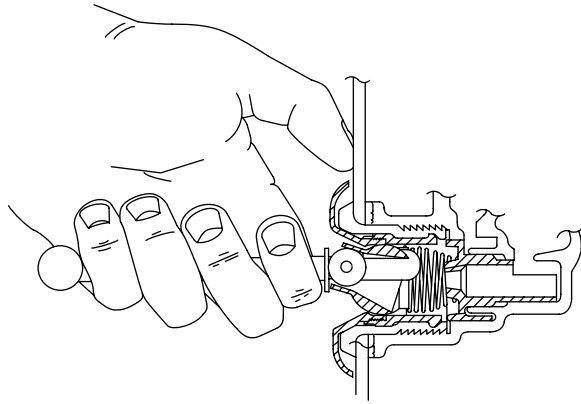

### **1. Remove the Flexjet Assembly (If Needed)**

- Grip the jet removal tool tightly in your hand.
- Turn the jet ball nozzle completely upward.
- Insert the tool with the hook end up and catch the inside top of the ball as shown.
- Press your thumb against the bath wall and firmly pull out the jet assembly.

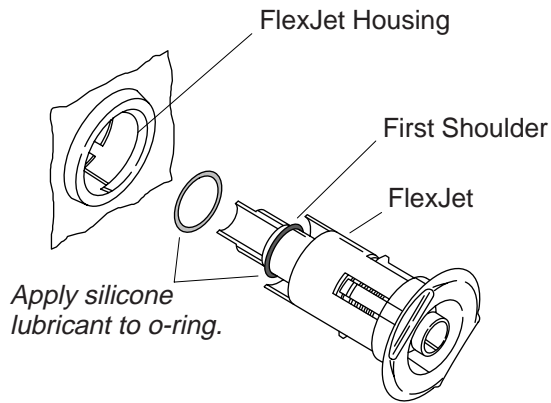

## 2. Install the FlexJet Assembly

**NOTE:** The FlexJet O-ring must be correctly positioned, must be lubricated, and must be in good condition to permit easy rotation and proper orientation of the jet.

- Lubricate the O-ring with silicone lubricant (supplied) to prevent noisy operation of the jet. Install the O-ring onto the first shoulder of the FlexJet.
- Carefully insert the jet into the housing, and lightly push and rotate the jet until it snaps into position. **Do not force the jet.**

**NOTE:** When installed correctly, the jet should turn smoothly in both directions.

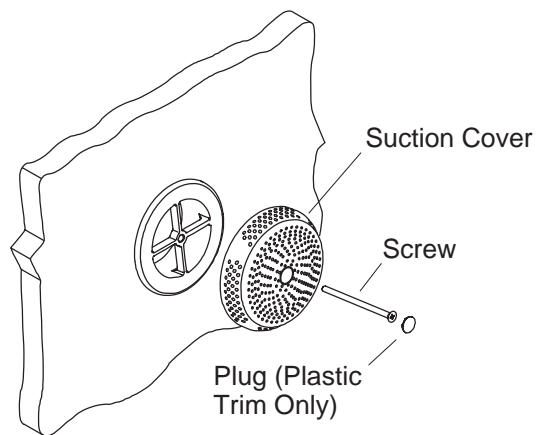

### 3. Install the Suction Cover

**⚠ WARNING: Risk of personal injury or death.** Never operate the whirlpool bath without the suction cover in place. Doing so may result in serious injury or death. If your whirlpool does not have the suction cover installed, install the necessary parts prior to using your whirlpool.

**NOTE:** The suction cover may already be installed on your whirlpool.

- ❑ Insert the screw through the suction cover and into the threaded center hole of the suction fitting on your whirlpool. Position the suction cover with the Kohler logo facing upward.
- ❑ Tighten the screw until the sides of the cover are snug against the wall of the whirlpool. **Do not overtighten.**
- ❑ Press the plug (if supplied) into the recessed hole on the cover.